

Field Notes of Andreas Bamea Grant

Beginning 1525 vs East + 530 vs South of the South west
corner of Charles Stotch Kiss 4th right - 640 ac Survey
Thence East - at 3036 vs Brook 10th w co S. 4000 vs, set post - 76
Thence South 2110 vs set post - 76, (of Tanana Bridge
Thence S 88° W on true line 369 vs set post - 76, on west bank
Thence down the Tanana Bridge 2500 vs set post - 76
Thence West - 3235 vs Brook 3 vs W - co S W at 2160 vs cor 76,
Thence North 85 vs Brook 9 vs co SW 2100 Brook 8 vs W -
co S E, at 2220 vs set post - 76
Thence East 1000 vs set post - 76,
Thence North 1066 vs Brook 10th w co west at 2390 vs
the Beginning

John Henry Sawyer

#3

File 3/58

Nacogdoches.

Rec^d Feb^y 25th/58.

Vital Records Title
4 miles East of
Nacogdoches.

Serial 32238

Feb 25/58

I have surveyed for Peter McBean a certain tract of Land known as
 Beans Plantation four miles more or less East of the Town of Nucyguia
 as follows Beginning on a Post-Cast and 2 post-Cast Pointers on the
 line of an Old Survey, Thence N 82° E on 8th line 800 rods, 5000 varas
 to a double Sycamore & Walnut - an old cor. on the south bank of a small
 creek known as White Creek, Thence down with the meanders of the same
 as follows S 74° E 220 varas with the line of Encarnacio Chirino,

S 11° E 80 " "
 S 65° E 220 " "
 S 27° E 840 " "
 S 10° E 340 " "
 S 70° E 340 " "
 East 630 " "
 S 40° E 1560 " to the Canice

Thence up the Canice North 200 " to the mouth of Red Creek which
 enters into the Canice on the East, & up the same as follows N 80° E 240 of

N 22° E 550 "
 N 45° E 590 "
 N 77° E 140 "
 S 45° E 950 "

to a Red Cast and post-Cast on the south bank of 8th Creek

Thence South 4740 varas (crossing the road to Cordova at 540 vs,
 Road to Martins at 1800 vs, Road to Benys at 3340 vs,) to a
 corner a Post-Cast & Red-Cast Thence S 65° W said to be Ignacio (Abuelo's
 line at 730 vs, pond 8 vs wide 960 Bays Canice

S 69° E 700 Red Cast. } N 34° W 230 " } S 79° W 260 "
 West 580 vs on old fence } West 620 " } N 74° W 240 " to a

Black Oak on St. Joes Thence N40W 2800 or
 N31W 240 "
 to the Beginning Wm. Rouse
 Surveyor

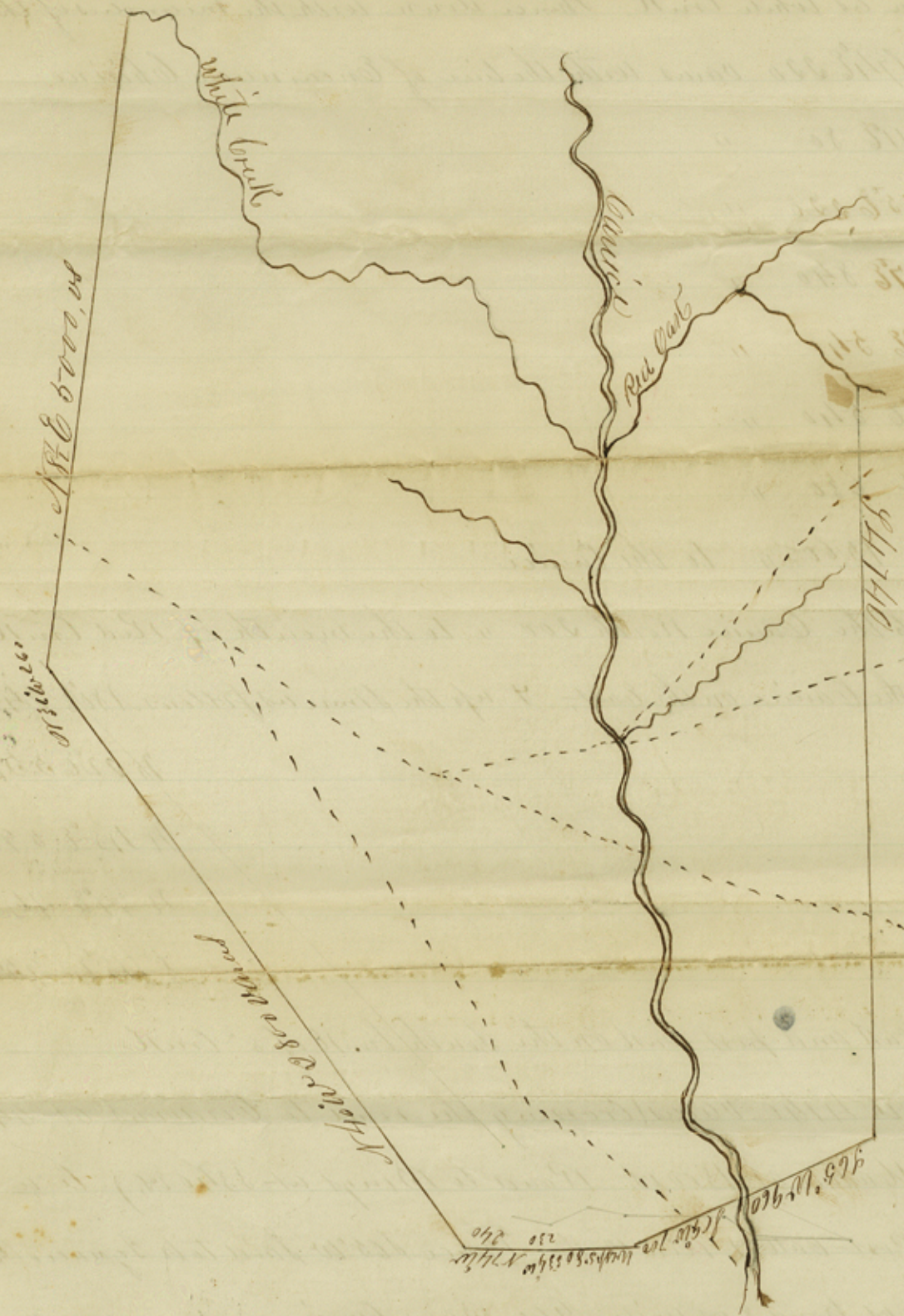

2 courses omitted in the Plot Scale 1000 yards for Inch

Wm. Rouse Surveyor