

File 1

Nueces County

On Olmos Creek  
on Map.

Doval Co.

corner.

see 23 in Nueces Co.  
Sketch Files

counter 32497

7/23/47

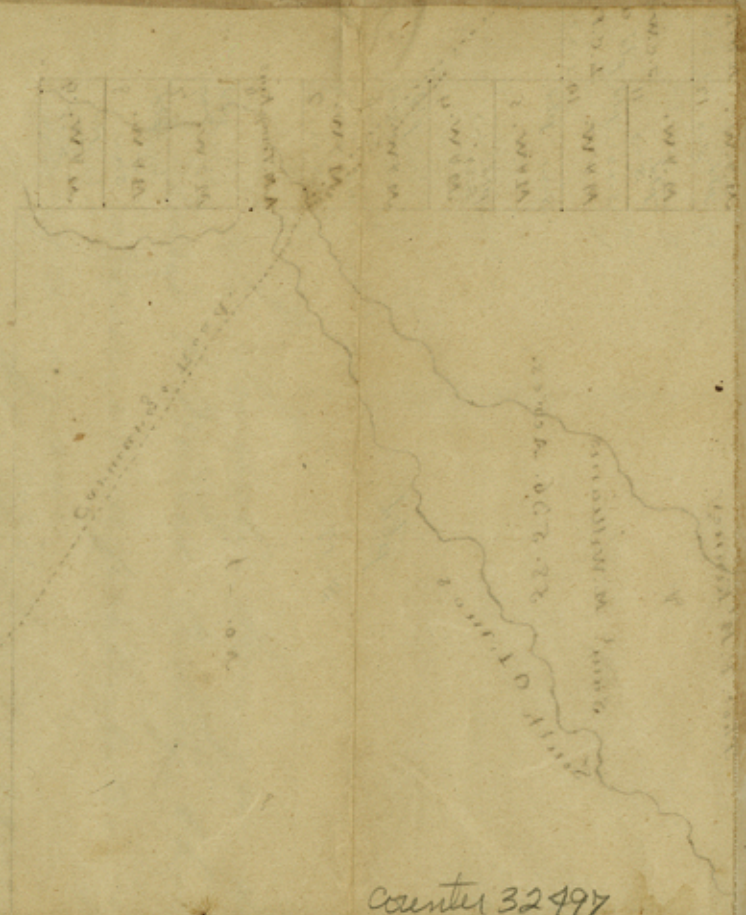

Heirs of  
G. Dowell



I J. Simeely Surveyor Dist. of San  
Patricio & Nueces. Certify, that the above  
is a correct representation of the survey  
made by me.  
Corpus Christi. July 23rd 1847  
J. Simeely  
Sur. Dist. S.P. & N.

*1816*  
*St. Patricio*  
*Almos Cr.*



*Plotted on map*

*counter 32499*

*Faint handwritten notes, possibly a list or account, written vertically on the right side of the page.*