



Texas General Land Office
Asset Management Division

September 10, 1991

Mr. George M. Pyle
Urban Engineering
P. O. Box 6355
Corpus Christi, Texas 78466-6355

Re: Survey of 181.74 acres in two tracts in Section 31 and Section A, Laureles Farm Tracts, adjacent to Cayo del Oso State Tract G, Nueces County

Dear Mr. Pyle:

The above referenced survey, as presented with supporting data, has been approved for filing in the records of the General Land Office.

The plat of survey and aerial photograph are filed as Nueces County Rolled Sketch 112 and the report and other support material is filed as Nueces County Sketch File 72.

If this office can be of further assistance to you, please let me know.

Sincerely,

C. B. Thomson
Director, Surveying Division

File No. Sketch File 72 County _____
Nueces
Filed Letter of acceptance
10 September 19 90
GARRY MAURO, COMMISSIONER
C.B. Thomson
By _____

Stephen F. Austin Building
1700 North Congress Avenue
Austin, Texas 78701-1495
(512) 463-5099

Garry Mauro
Commissioner

counter 33020



Job No. 8898.91.01

(512)854-3101

P.O. BOX 6355 • CORPUS CHRISTI, TEXAS 78466-6355

FAX (512)854-6001

July 31, 1991

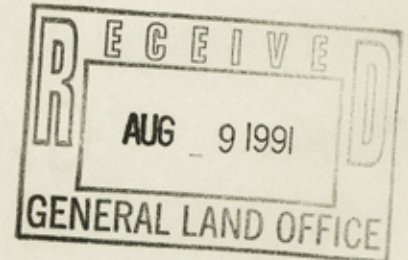

Gary Mauro, Commissioner
General Land Office
Stephen F. Austin Building
1700 North Congress
Austin, Texas 78701

ATTN: Ben Thomson, Director, Surveying Division

Survey report on the gradient boundary of 181.74 acres of land in two tracts out of Section 31 and Section A, Laureles Farm Tracts, a map of which is recorded in Book 3, Page 15, Map Records of Nueces County, Texas;

The 181.74 acres adjoins Cayo Del Oso State Tract G. on the right bank of the Creek and is directly across the Creek from a 267.49 acre tract, the gradient boundary of which, was approved by the General Land Office on October 26, 1983 and filed as Nueces County Rolled Sketch No. 94.

Reference material filed in General Land Office:

1. Rolled Sketch No. 70
2. Rolled Sketch No. 89
3. Rolled Sketch No. 93
4. Rolled Sketch No. 97 (see accompanying addendum)

Exhibits:

1. Portion of recorded plat of Laureles Farm Tracts.
2. Portion of Oso Creek NW, Texas Quadrangle 1968.
3. Lanmon Aerial Photo dated February 9, 1991 on scale of 1" = 400±'.

The shoreline of this entire tract is evidenced by a well defined almost vertical bank about 2 feet high and the gradient boundary shown on the plat is located on the face of this bank. As stated in previous reports the water elevation remains fairly constant except during floods and was at 2.2 feet N.G.V4.D. on July 30, 1991. This is a natural shoreline with no artificial fill or excavation. It is similar to the other referenced tracts but has no sloping banks as some of them do.

Signed:

George M. Pyle
George M. Pyle, R.P.L.S. - L.S.L.S.

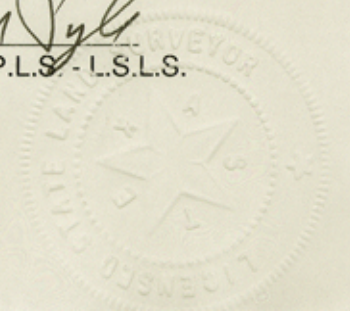

2725 SWANTNER DR. • CORPUS CHRISTI, TEXAS 78404

File No. Sketch File 72
NUECES County
Two Tr. out of Sect. 31 & Sect. A, Laureles
Form Tracts
Filed AUG. 9 19 91
By GARRY MAURO, Com'r
Douglas Howard
See Rld. Sk 112



Job No. 8898.91.01

(512)854-3101

P.O. BOX 6355 • CORPUS CHRISTI, TEXAS 78466-6355

FAX (512)854-6001

August 7, 1991

Addendum to Nueces County Rolled Sketch No. 97

In the process of surveying the 181.74 acres contained within the report herein being submitted, it was found that an error had been made in the relationship between Map North and Grid North on the original submission of Nueces County Rolled Sketch No. 97.

On sketch No. 97 I show Map North to be 0° 12' 08" clockwise from Grid North but the correct Map North is actually 0° 49' 02" counter clockwise from Grid North. As a consequence the coordinates are probably incorrect.

I am going on vacation for three weeks but I will submit corrections to Sketch No. 97 as soon as I get back.

Signed: George M. Pyle
George M. Pyle, R.P.L.S. - L.S.L.S

File No. Sketch File 72 County
NUECES County
Two Tr. out of Sect. 31 & Sect. A, Laureles Form Tracts.
Filed Aug. 9 19 91
By GARRY MAURO, Com'r
Douglas Howard





Job No. 9898.91.01

(512)854-3101

P.O. BOX 6355 • CORPUS CHRISTI, TEXAS 78466-6355

FAX (512)854-6001

July 31, 1991

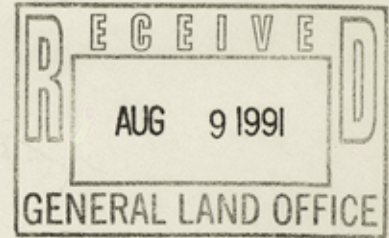

Gary Mauro, Commissioner
General Land Office
Stephen F. Austin Building
1700 North Congress Avenue
Austin, Texas 78701

ATTN: Ben Thomson, Director, Surveying Division

Dear Ben,

I am herewith transmitting a survey of 181.74 acres of land in two tracts adjoining Cayo Del Oso State tract G in Corpus Christi, Nueces County, Texas. A survey report with 3 exhibits are also included.

The owner is selling the upland to the City of Corpus Christi and the City wants the G.L.O. approval of the gradient boundary along Oso Creek.

Sincerely yours,

URBAN ENGINEERING

George M. Pyle, R.P.L.S. - L.S.L.S.

GMP/mu

Enclosure

File No. Sketch File 72 County
NUECES
Two tr. out of Seds 31 & A, Laureles Farm Tracts
Filed AUG. 8 19 91
By GARRY MAURO, Com'r
Douglas Howard
See Rid. Sk. 112



2725 SWANTNER DR. • CORPUS CHRISTI, TEXAS 78404



LAURELES FARM TRACTS

Being a portion of the
"RINCON DE CORPUS CHRISTI" GRANT

Situated in

NUECES COUNTY, TEXAS

Southwest of CORPUS CHRISTI

Surveyed by FRENCH & HABERER, CIVIL ENGINEERS AND LAND SURVEYORS

SCALE: 1 inch = 1000 YARDS

The State of Texas,)
County of Nueces, Texas, on this day personally
before me, J.A. Hillerman, a Justice
of the Peace for said County,
being by me duly sworn, upon his oath, deposes and says
that he is the owner of the South Half of Section 20, containing 320
Acres, and the North Half of Section 21, containing 320 Acres,
both in Nueces County, Texas, as surveyed and located
as the Laureles Farm Tracts and being a part of the
"Rincon de Corpus Christi" Grant, as surveyed and located
by Civil Engineers and Land Surveyors, which plan
is on file in the office of the County Clerk of said
County, and he makes a part of this affidavit, for the purpose of
said above described tracts of land.

Given to and subscribed before me this 14th day of
March, 1914.

The State of Texas,)
County of Nueces, Texas, on this day personally
before me, J.A. Hillerman, a Justice
of the Peace for said County,
being by me duly sworn, upon his oath, deposes and says
that he is the owner of the South Half of Section 20, containing 320
Acres, and the North Half of Section 21, containing 320 Acres,
both in Nueces County, Texas, as surveyed and located
as the Laureles Farm Tracts and being a part of the
"Rincon de Corpus Christi" Grant, as surveyed and located
by Civil Engineers and Land Surveyors, which plan
is on file in the office of the County Clerk of said
County, and he makes a part of this affidavit, for the purpose of
said above described tracts of land.

File No. Sketch File 72
NUECES County
2 trs. out of Sects 31 & A, Laureles Farm Tracts
Filed Aug. 8, 1991
By GARRY MAURO, Com'r
Douglas Howard
See Rld Sk. 112

FILED FOR RECORD
At 9:35 A.M. A.D. 1914
MAY 2 1914
H. E. Luter
County Clerk of Nueces County
By Bartha Kaler deputy

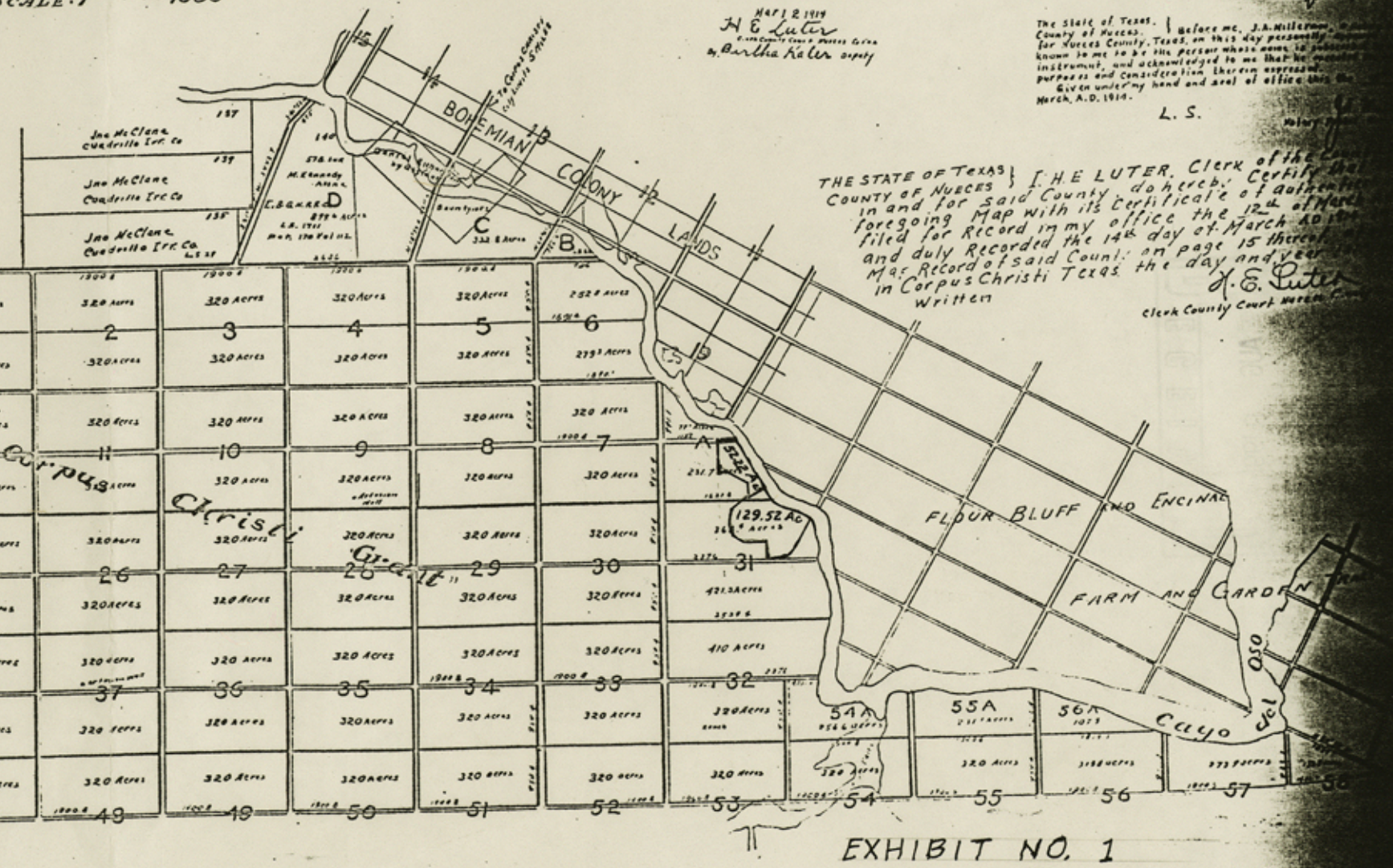

THE STATE OF TEXAS,) I, H. E. LUTER, Clerk of the
County of Nueces do hereby Certify that
in and for said County, the
foregoing Map with its Certificate of authentication
is on file in my office the 12th day of March 1914
and duly Recorded in my office the 14th day of March 1914
and duly Recorded in said County on page 15 thereof
in the Record of said County the day and year
written
H. E. Luter
Clerk County Court Nueces Co.

356.4	320 Acres	320 Acres	320 Acres	320 Acres	320 Acres	320 Acres	320 Acres	320 Acres	320 Acres	252.8 Acres	182.4	320 Acres	275.2 Acres	187.2
19	18	15	14	1	2	3	4	5	6	7	8	9	10	11
350.4 Acres	320 Acres	320 Acres	320 Acres	320 Acres	320 Acres	320 Acres	320 Acres	320 Acres	320 Acres	320 Acres	320 Acres	320 Acres	320 Acres	320 Acres
20	17	16	13	12	11	10	9	8	7	6	5	4	3	2
348.8 Acres	320 Acres	320 Acres	320 Acres	320 Acres	320 Acres	320 Acres	320 Acres	320 Acres	320 Acres	320 Acres	320 Acres	320 Acres	320 Acres	320 Acres
21	20	19	18	17	16	15	14	13	12	11	10	9	8	7
348.8 Acres	320 Acres	320 Acres	320 Acres	320 Acres	320 Acres	320 Acres	320 Acres	320 Acres	320 Acres	320 Acres	320 Acres	320 Acres	320 Acres	320 Acres
22	21	20	19	18	17	16	15	14	13	12	11	10	9	8
347.2 Acres	320 Acres	320 Acres	320 Acres	320 Acres	320 Acres	320 Acres	320 Acres	320 Acres	320 Acres	320 Acres	320 Acres	320 Acres	320 Acres	320 Acres
23	22	21	20	19	18	17	16	15	14	13	12	11	10	9
342.4 Acres	320 Acres	320 Acres	320 Acres	320 Acres	320 Acres	320 Acres	320 Acres	320 Acres	320 Acres	320 Acres	320 Acres	320 Acres	320 Acres	320 Acres
24	23	22	21	20	19	18	17	16	15	14	13	12	11	10
342.4 Acres	320 Acres	320 Acres	320 Acres	320 Acres	320 Acres	320 Acres	320 Acres	320 Acres	320 Acres	320 Acres	320 Acres	320 Acres	320 Acres	320 Acres
25	24	23	22	21	20	19	18	17	16	15	14	13	12	11
341.6 Acres	320 Acres	320 Acres	320 Acres	320 Acres	320 Acres	320 Acres	320 Acres	320 Acres	320 Acres	320 Acres	320 Acres	320 Acres	320 Acres	320 Acres
26	25	24	23	22	21	20	19	18	17	16	15	14	13	12
341.6 Acres	320 Acres	320 Acres	320 Acres	320 Acres	320 Acres	320 Acres	320 Acres	320 Acres	320 Acres	320 Acres	320 Acres	320 Acres	320 Acres	320 Acres
27	26	25	24	23	22	21	20	19	18	17	16	15	14	13
340.8 Acres	320 Acres	320 Acres	320 Acres	320 Acres	320 Acres	320 Acres	320 Acres	320 Acres	320 Acres	320 Acres	320 Acres	320 Acres	320 Acres	320 Acres
28	27	26	25	24	23	22	21	20	19	18	17	16	15	14
340.8 Acres	320 Acres	320 Acres	320 Acres	320 Acres	320 Acres	320 Acres	320 Acres	320 Acres	320 Acres	320 Acres	320 Acres	320 Acres	320 Acres	320 Acres
29	28	27	26	25	24	23	22	21	20	19	18	17	16	15
340.8 Acres	320 Acres	320 Acres	320 Acres	320 Acres	320 Acres	320 Acres	320 Acres	320 Acres	320 Acres	320 Acres	320 Acres	320 Acres	320 Acres	320 Acres
30	29	28	27	26	25	24	23	22	21	20	19	18	17	16
421.2 Acres	320 Acres	320 Acres	320 Acres	320 Acres	320 Acres	320 Acres	320 Acres	320 Acres	320 Acres	320 Acres	320 Acres	320 Acres	320 Acres	320 Acres
31	30	29	28	27	26	25	24	23	22	21	20	19	18	17
410 Acres	320 Acres	320 Acres	320 Acres	320 Acres	320 Acres	320 Acres	320 Acres	320 Acres	320 Acres	320 Acres	320 Acres	320 Acres	320 Acres	320 Acres
32	31	30	29	28	27	26	25	24	23	22	21	20	19	18
320 Acres	320 Acres	320 Acres	320 Acres	320 Acres	320 Acres	320 Acres	320 Acres	320 Acres	320 Acres	320 Acres	320 Acres	320 Acres	320 Acres	320 Acres
33	32	31	30	29	28	27	26	25	24	23	22	21	20	19
320 Acres	320 Acres	320 Acres	320 Acres	320 Acres	320 Acres	320 Acres	320 Acres	320 Acres	320 Acres	320 Acres	320 Acres	320 Acres	320 Acres	320 Acres
34	33	32	31	30	29	28	27	26	25	24	23	22	21	20
320 Acres	320 Acres	320 Acres	320 Acres	320 Acres	320 Acres	320 Acres	320 Acres	320 Acres	320 Acres	320 Acres	320 Acres	320 Acres	320 Acres	320 Acres
35	34	33	32	31	30	29	28	27	26	25	24	23	22	21
320 Acres	320 Acres	320 Acres	320 Acres	320 Acres	320 Acres	320 Acres	320 Acres	320 Acres	320 Acres	320 Acres	320 Acres	320 Acres	320 Acres	320 Acres
36	35	34	33	32	31	30	29	28	27	26	25	24	23	22
320 Acres	320 Acres	320 Acres	320 Acres	320 Acres	320 Acres	320 Acres	320 Acres	320 Acres	320 Acres	320 Acres	320 Acres	320 Acres	320 Acres	320 Acres
37	36	35	34	33	32	31	30	29	28	27	26	25	24	23
320 Acres	320 Acres	320 Acres	320 Acres	320 Acres	320 Acres	320 Acres	320 Acres	320 Acres	320 Acres	320 Acres	320 Acres	320 Acres	320 Acres	320 Acres
38	37	36	35	34	33	32	31	30	29	28	27	26	25	24
320 Acres	320 Acres	320 Acres	320 Acres	320 Acres	320 Acres	320 Acres	320 Acres	320 Acres	320 Acres	320 Acres	320 Acres	320 Acres	320 Acres	320 Acres
39	38	37	36	35	34	33	32	31	30	29	28	27	26	25
320 Acres	320 Acres	320 Acres	320 Acres	320 Acres	320 Acres	320 Acres	320 Acres	320 Acres	320 Acres	320 Acres	320 Acres	320 Acres	320 Acres	320 Acres
40	39	38	37	36	35	34	33	32	31	30	29	28	27	26
320 Acres	320 Acres	320 Acres	320 Acres	320 Acres	320 Acres	320 Acres	320 Acres	320 Acres	320 Acres	320 Acres	320 Acres	320 Acres	320 Acres	320 Acres
41	40	39	38	37	36	35	34	33	32	31	30	29	28	27
320 Acres	320 Acres	320 Acres	320 Acres	320 Acres	320 Acres	320 Acres	320 Acres	320 Acres	320 Acres	320 Acres	320 Acres	320 Acres	320 Acres	320 Acres
42	41	40	39	38	37	36	35	34	33	32	31	30	29	28
320 Acres	320 Acres	320 Acres	320 Acres	320 Acres	320 Acres	320 Acres	320 Acres	320 Acres	320 Acres	320 Acres	320 Acres	320 Acres	320 Acres	320 Acres
43	42	41	40	39	38	37	36	35	34	33	32	31	30	29
320 Acres	320 Acres	320 Acres	320 Acres	320 Acres	320 Acres	320 Acres	320 Acres	320 Acres	320 Acres	320 Acres	320 Acres	320 Acres	320 Acres	320 Acres

EXHIBIT NO. 1

July 31, 1991 8898 9/01

counter 33024

ELD

MILITARY RESERVATION BOUNDARY

Country Club

BR15

x17

Klepac

SARATOGA

YORKTOWN

STABLES

BOUNDARY

BLVD

3065

3064

3063

3062

40'

3061

3060

3059

3058

3057000m N

27°37'30"

97°22'30"

IPITA ISLAND

6539 111 SE

Barney Davis Dr.

52.22 Ac.

129.52 Ac.

NASA TRACKING STATION

Radio Facility

Rodd

WT

OSO CREEK

PIPELINE

Rancho Viejo Windmill

55

1"=2000'

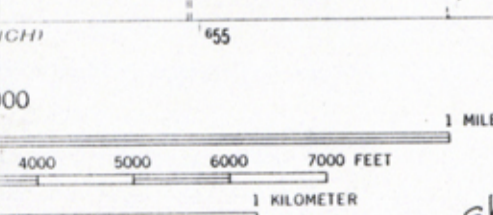

1/4" = 5 FEET
NAD DATUM OF 1929

MAP ACCURACY STANDARDS
ORADO 80225, OR RESTON, VIRGINIA 22092
SYMBOLS IS AVAILABLE ON REQUEST

File No. Sketch File 72
NUECES County
2 trs. out of Sects. 31 & A, Laureles Farm Tracts
Aug. 3
Filed GARRY MAURO, Com. 1991
By Douglas Howard QUADRANGLE LOCATION
see Pld. Sk. 112

GENERAL LAND OFFICE

ROAD CLASSIFICATION
Primary highway, hard surface
Secondary highway, hard surface
Light-duty road, hard or improved surface
Unimproved road
Interstate Route U. S. Route State Route

OSO CREEK NW, TEX.
NW/4 OSO CREEK 15' QUADRANGLE
N2737.5—W9722.5/7.5

1968
PHOTOREVISED 1975
AMS 6539 III NW—SERIES V882

EXHIBIT NO. 2

July 31, 1991

8898 9101

counter 33025