

Palo Pinto County

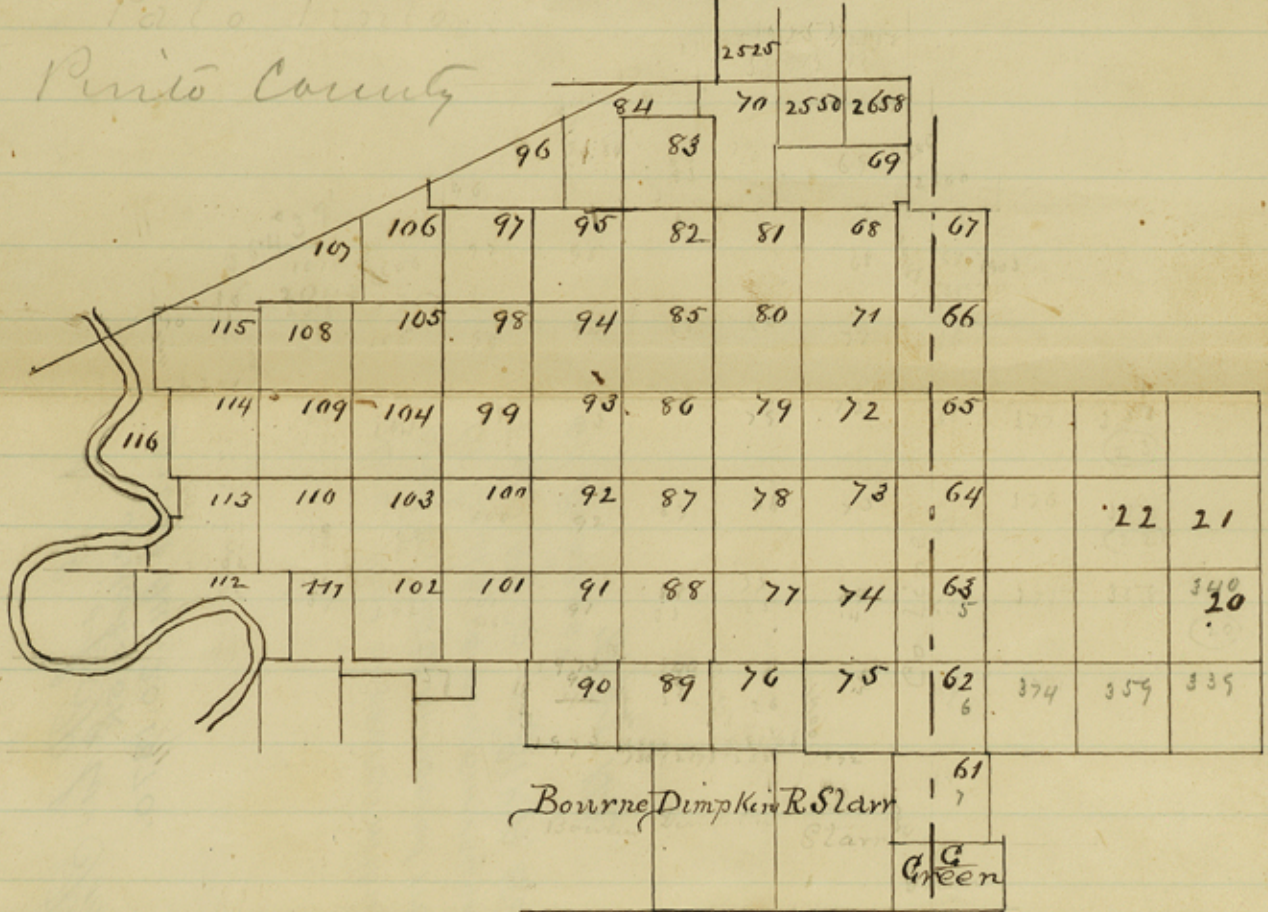

Palo Pinto County



I J P Hart District Surveyor of
 Parker District do hereby certify
 that I have examined the foregoing
 Plat and finding the same correct
 approve it
 Withupond 20th Augt 1870 J P Hart
 Dist S, Parker Dist

File # 7

Palo Pinto Co.

N. E. of Palo Pinto.

J.P. Hart's 5K.

Dated Aug. 20. 1870.

Note: Area on sketch within, covered by plots numbered from 61 to 116, is now surveyed for T & P Ry Co., as "BIKA, East of Brazos"

7/19/71. KAL.

Palo Pinto

Filed Sept. 2/70
8/20/70

county 33399