

Page 317
200

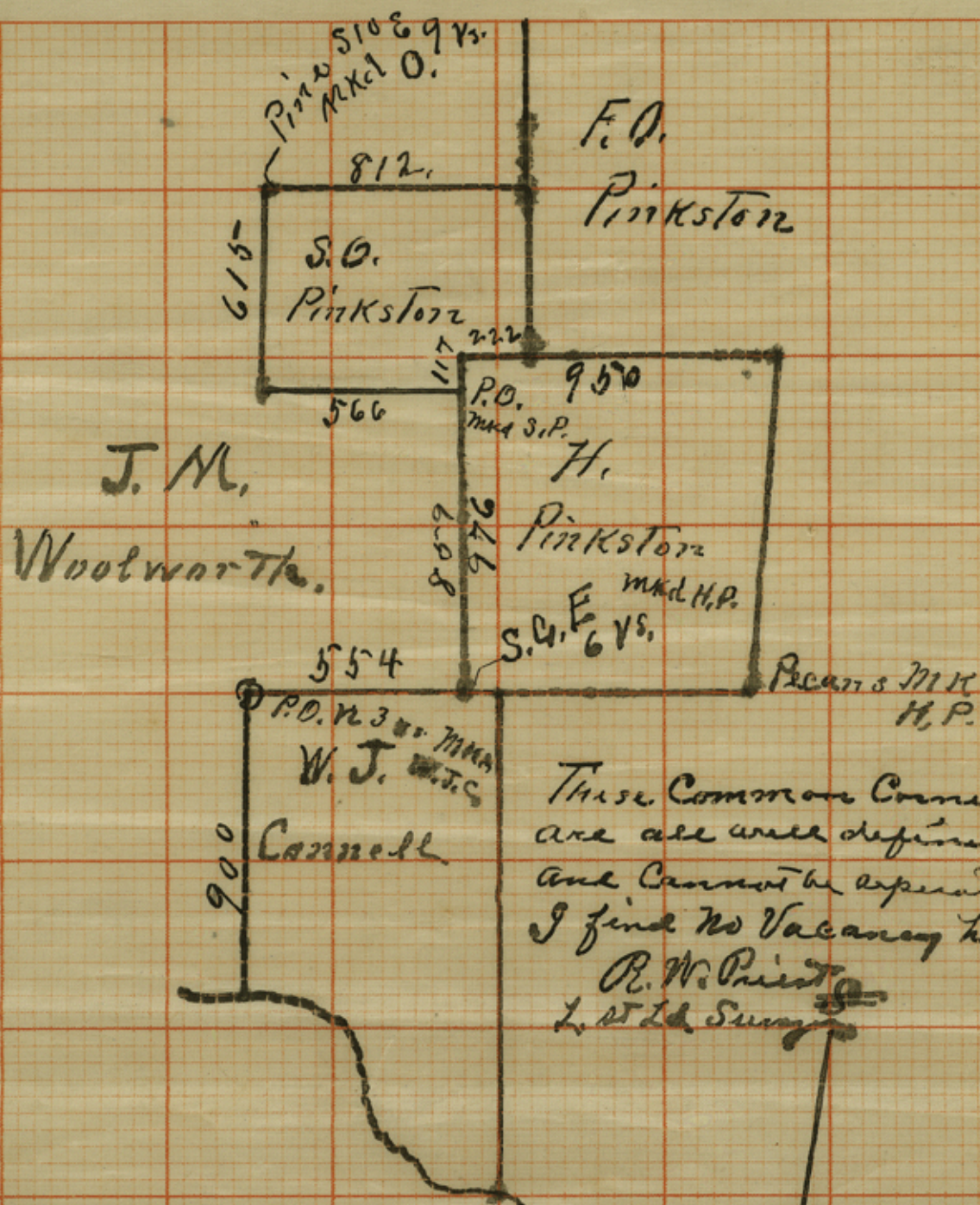

These Common Corners
 are all well defined
 and cannot be separated,
 I find no vacancy here,
 R. W. Priest
 L. St. Id. Survey

Plain 257

county 32478

Barthage, Texas, Aug. 16th 1926.
Hon. J. P. Robison,
Commissioner, Gen'l Ld. Office,
Austin, Texas.

My Dear Mr. Robison: I am enclosing Application for Survey of R. C. Lomax, and field notes of the Survey of 14 2/3 Acres, Survey No. B-11,

Also am enclosing his Application for another Survey, and my statement of Survey made, with plat showing no vacancy.

Also am enclosing Money Order for \$2⁰⁰/₁₀₀, filing fees, \$1⁰⁰/₁₀₀ with each Application,

There is no question as to the vacancy south of the John Beck and north of the McLaughlin, but I cannot find any land between J. M. Woolworth and the Pinkstons.

I have made these surveys just as soon as possible for Mr. Lomax after receiving his applications, and it was late Saturday night when I got in, and impossible to get Money Order off and letter before this morning.

I am therefore registering this and special delivery stamp as tomorrow is the last day for them to be in your Office.

Should any delay occur in the Mails, if you can favor Mr. Lomax by preventing a forfeiture, I will greatly appreciate it, as it is not his fault, neither mine, I worked all day in the rain to make this survey and get statement to you.

Very truly yours,
R. W. Priest

RECEIVED
REFERRED TO RECEIVER
AUG 17 1926
2 10
REMITTANCE CORRECT

121
161

APPLICATION FOR SURVEY

APPLICATION NO. 997

To Joe Rowe County Surveyor of Panola
County, Texas, or to ##### District Surveyor of
Land District:

By virtue of Section 7 of an Act approved April 3, 1919, I hereby apply for a survey of the following described unsurveyed land appropriated to the Public Free School Fund under Chapter 11, Act February 23, 1900, to-wit:

Situated in Panola County, Texas, about 18 miles SE

from the County site. Said tract is bounded as follows: on the East by H. Pinkston survey (Prem'n) 114, on the South by J. Connel survey; on the West by the J. M. Woolwerth survey and on the North by the S. O. Pinkston P 140

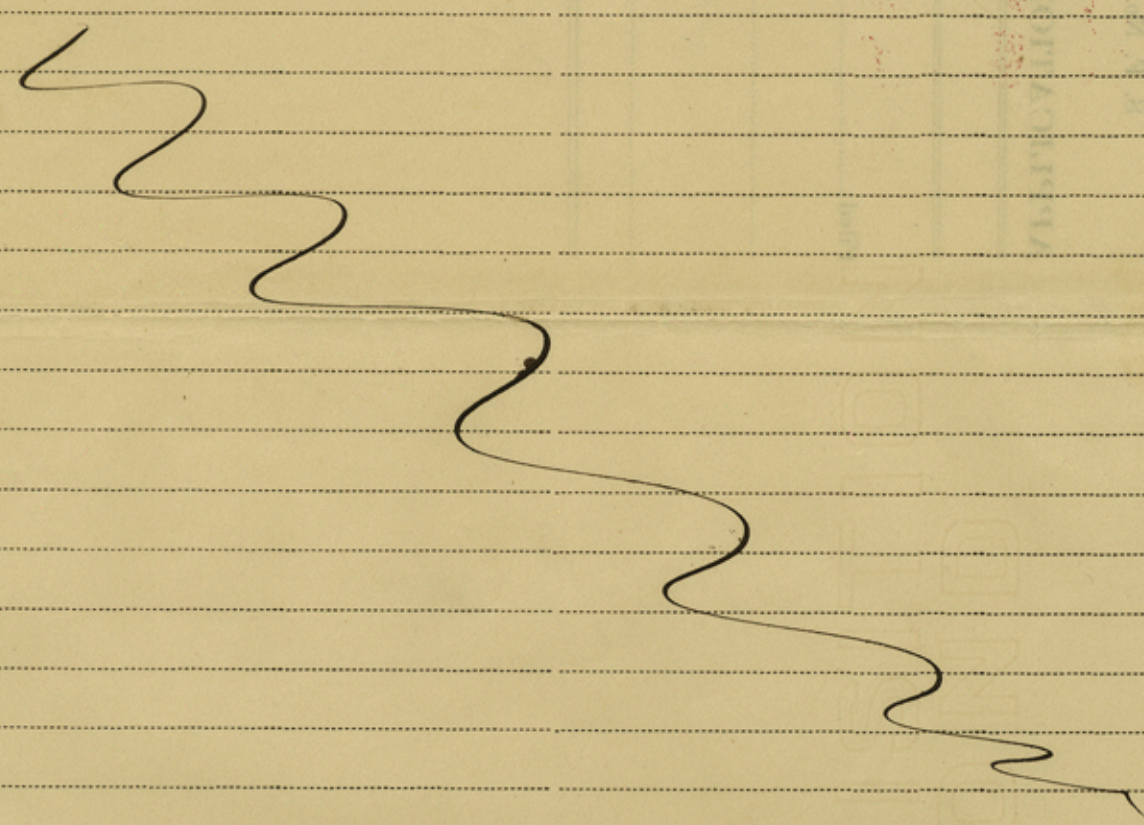

(N. B.—Write name and P. O. address Distinctly).

R. L. Lomas Applicant,

and 6/23/26

P. O. Beaumont Texas,
Chamber of Commerce

I, Joe Rowe, County Surveyor of Panola County, Texas, or Surveyor of _____ Land District, hereby certify that the above and foregoing application No. 997 was filed for record on the 17 day of May 1926, at 4 o'clock P. m., and recorded in Vol. No 4, page 139, in Surveyor's office Panola County, Texas.

Joe Rowe
County Surveyor P. O.

(3)

R. C. Lomax Survey, Continued,

Statement of Survey: In locating the S.W. Corner and S.E. Corner of John Beck Survey, I began at the N.W. Corner of Jacob Benson Survey on James Matthews South line, the same being the N.E. Corner of John Beck Survey, which corner I had located in 1911 in a survey for the Lewis Werner Saw Mill Company, and one of the original bearings now standing and marked as described in Jacob Benson field notes,

Thence South 950 Varas I find the S.W. Corner of Benson and N.W. Corner of Willis Surveys, well marked and defined, and continuing South at 1800 Varas I find the S.W. Corner of Willis and N.W. Corner of J. L. White, and the Post Oak N 27 E 4 $\frac{1}{10}$ bearing called for in Willis field notes is now standing and marked. Very old marks, I follow old line all the way. The Aus Davis heirs own the White Survey and 96 acres on the South end of John Beck, and as they have both tracts partly in cultivation and no timber, I turn at Whites N.E. Corner and run the North line of Davis 96 acres of John Beck, West, 560 Varas to a site on Beck's West line, where I find Davis' N.W. Corner of the 96 acres. Thence South with Pease following old marked line, at 1086 Varas I find the S.W. Corner of John Beck as described in field notes above. This site is 2421 Varas South of Pease's N.E. Corner, continuing South with Pease at 144 Varas from John Beck's S.W. Corner I find an old pine knot for corner, and bearings as above described. I had heretofore found this corner in 1911 surveying above mentioned, and in that survey my field notes show that Samuel Pease East line is 5219 Varas long, and M. Laury's line is 2964, as shown by above plat. The foregoing plat is made by me from field notes of actual surveys on the ground.

This August 14th 1926.

R. W. Priest.

Licensed State Land Surveyor.

The State of Texas } J. R. W. Priest Licensed State Land
Panola County. } Surveyor, do solemnly swear that the
land included within the limits of the within and foregoing
field notes is properly and currently classified as follows;
viz: hard, tight gumbo soil, such as is common in the
bottom Post Oak flats, and is dry grazing land
subject to overflows, with a scrubby Post Oak and Pin Oak
Timber, of little value. All large timber has been cut
for staves, as appears from the old stumps,
and that said land is reasonably worth \$2⁰⁰/₁₁ per acre
and the timber on said land is but little value, not
exceeding \$38⁰⁰/₁₁, altogether.

R. W. Priest

Surveyor

Sworn to and subscribed before me this 16th day of
August, 1926

Sam J. Holt.

Notary Public Panola Co. Tex.

A
1
Statement of a Survey Made for R. C. Lomax,
by Virtue of his Affidavit and Application filed
May 17th 1926 with Joe Rowe, County Surveyor,
Surveyed by me on the Ground August
14th, 1926, and also by previous surveys made by
me, I find the N.W. Corner of S. O. Pinkston to be a
Common Corner with J. M. Woolworth, both Calling
for a Pine Nkd O, which pine I have seen standing
and marked as described.

The S. S. E. Corner of S. O. Pinkston and Woolworth also is
a Common Corner.

The N.W. Corner of W. J. Cornell and E. L. Corner of J. M.
Woolworth is also a Common Corner.

The S. W. Corner of H. Pinkston and the E. S. E. Corner of J. M.
Woolworth is also a Common Corner, I have seen the
Sweet Gum Called for standing and marked as called
for. It is now gone, but other bearings I marked in years
gone by are standing. The attached plat correctly
represents said surveys as located on the ground,
and I cannot find any vacancy here, To all
which I truly Certify, the same having been by me
actually surveyed on the ground on August 14th 1926,
as well as on previous dates,

This Aug 16th 1926.

R. W. Priest.
Licensed State Surveyor.

No. 19.

Panola Co Ark files

statement and sketches by

R. W. Priest

Received 8/13/26

Blucher

counter 33484

4200

Panola Co. Ark. File # 19

25