

Wheatonford Tex July 1877

To Hon J J Lyross

Com of the Survey of the
 Leo Sear & Parker Co Tex hereby certify that
 this plat is a true plat of the Section 36
 9497472 sq m of land & that the lengths of the
 boundary lines therein are true and correct
 from actual surveys thereof and that said
 survey is not in conflict with any other

J. W. Hawkins

Leo Sear & Parker Co Tex

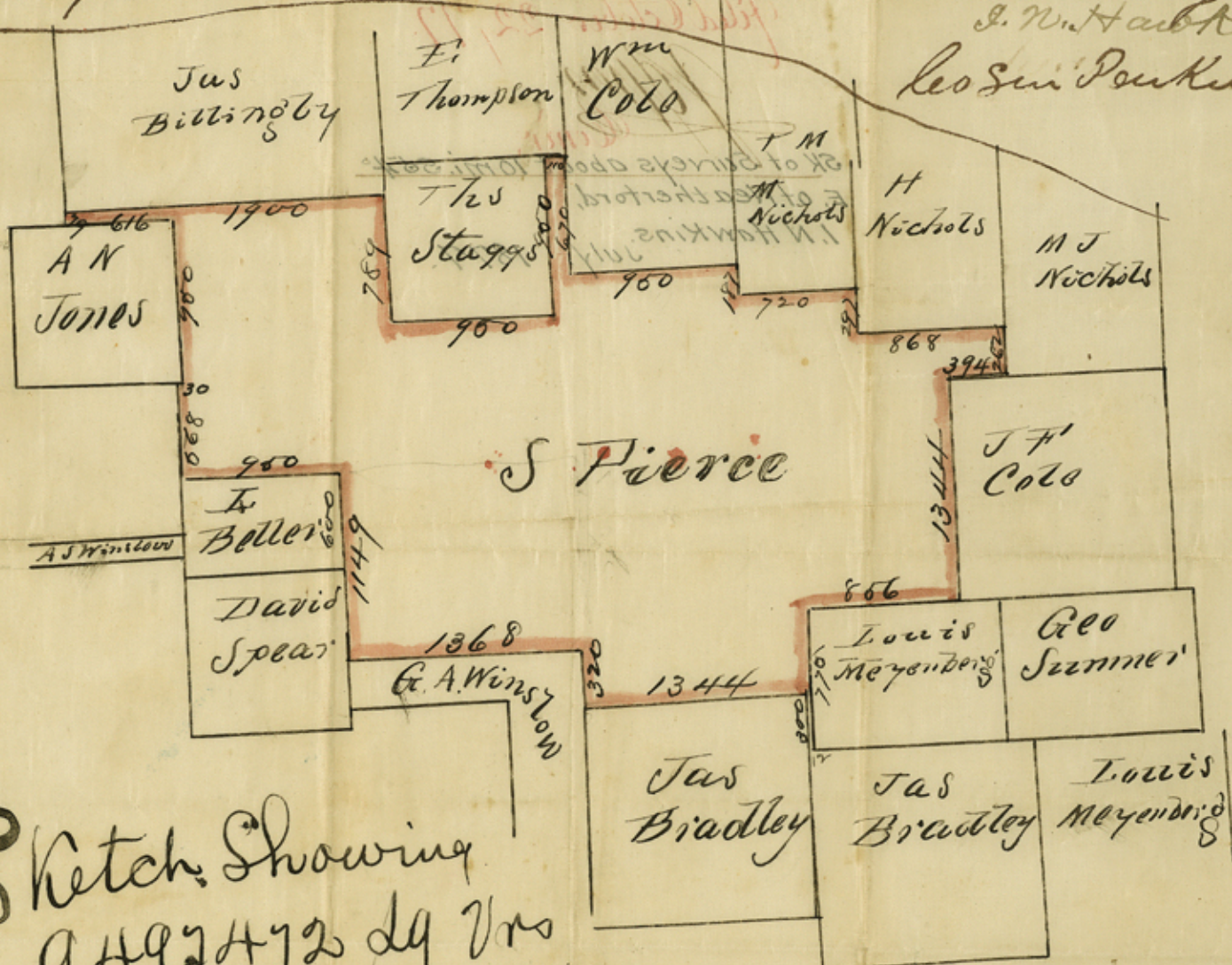

Sketch Showing
 9497472 sq m
 Parker Co
 Scale 1000 ft to an inch

