

File 84
3.

Folk Co.

East of Long King Creek

Recd Dec 22. 1848

Plotted on map

South and East of
Livingston.

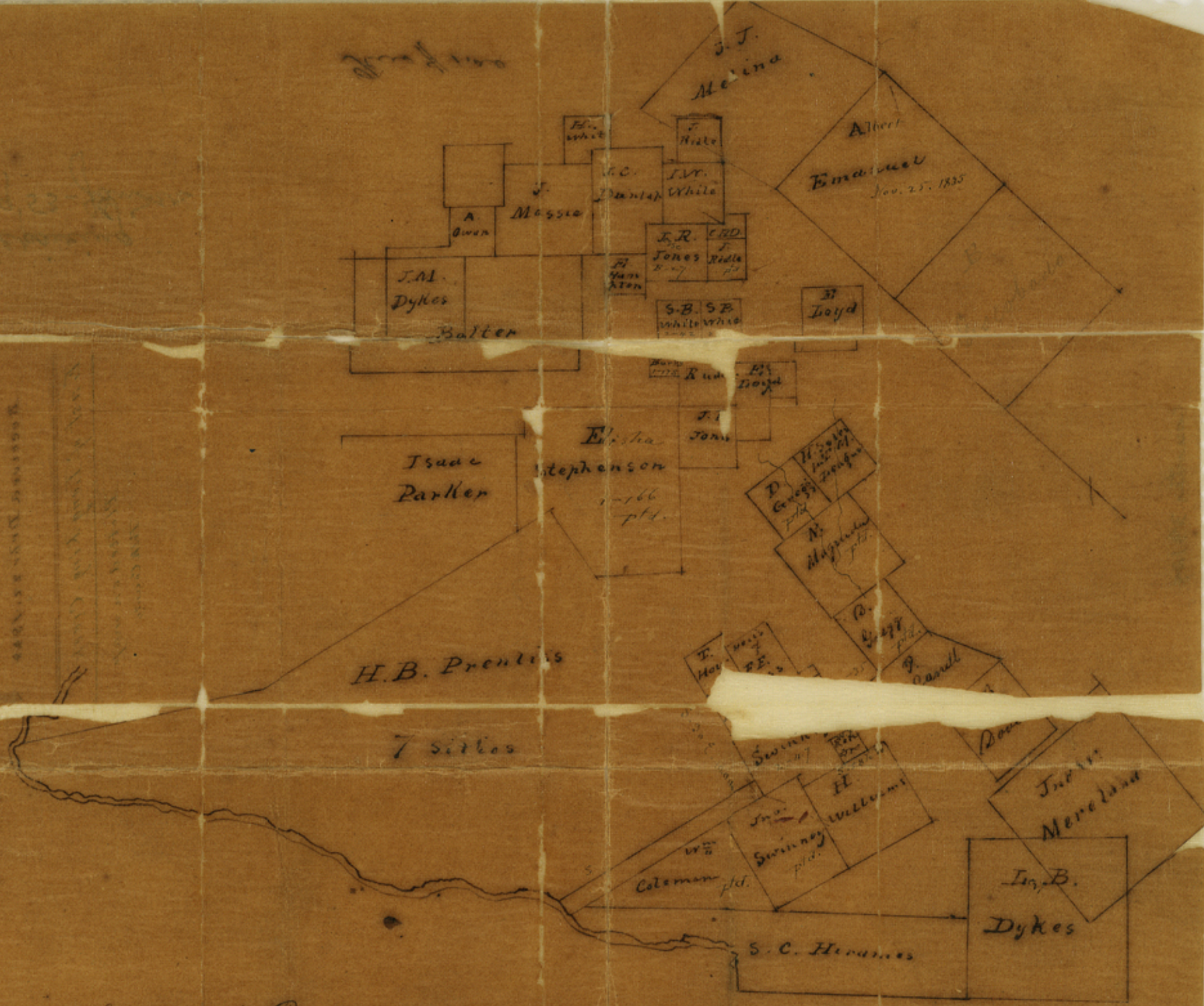

State of Texas
 Dist. of Liberty

I, J. D. Hardin Dist. Surveyor for said
 District do hereby certify that the above is a true
 sketch of the map of said District.

Given under my hand this 23rd day of
 November 1848.

J. D. Hardin
 Dist. Surveyor

Recd. Feb. 22, 1848
 F. F.

counter 39123 0

Sketch on Long King Cr.
Dated Nov. 23, 1848.

[Faint handwritten notes, possibly describing land parcels or survey details.]

File # 3
Polk County

Liberty Dist
Trinity

Received Dec 22, 1848

East of Long King Creek

Plotted on map
Polk County

2nd Reprising
Mch 19 53 - Johnson

Map 100

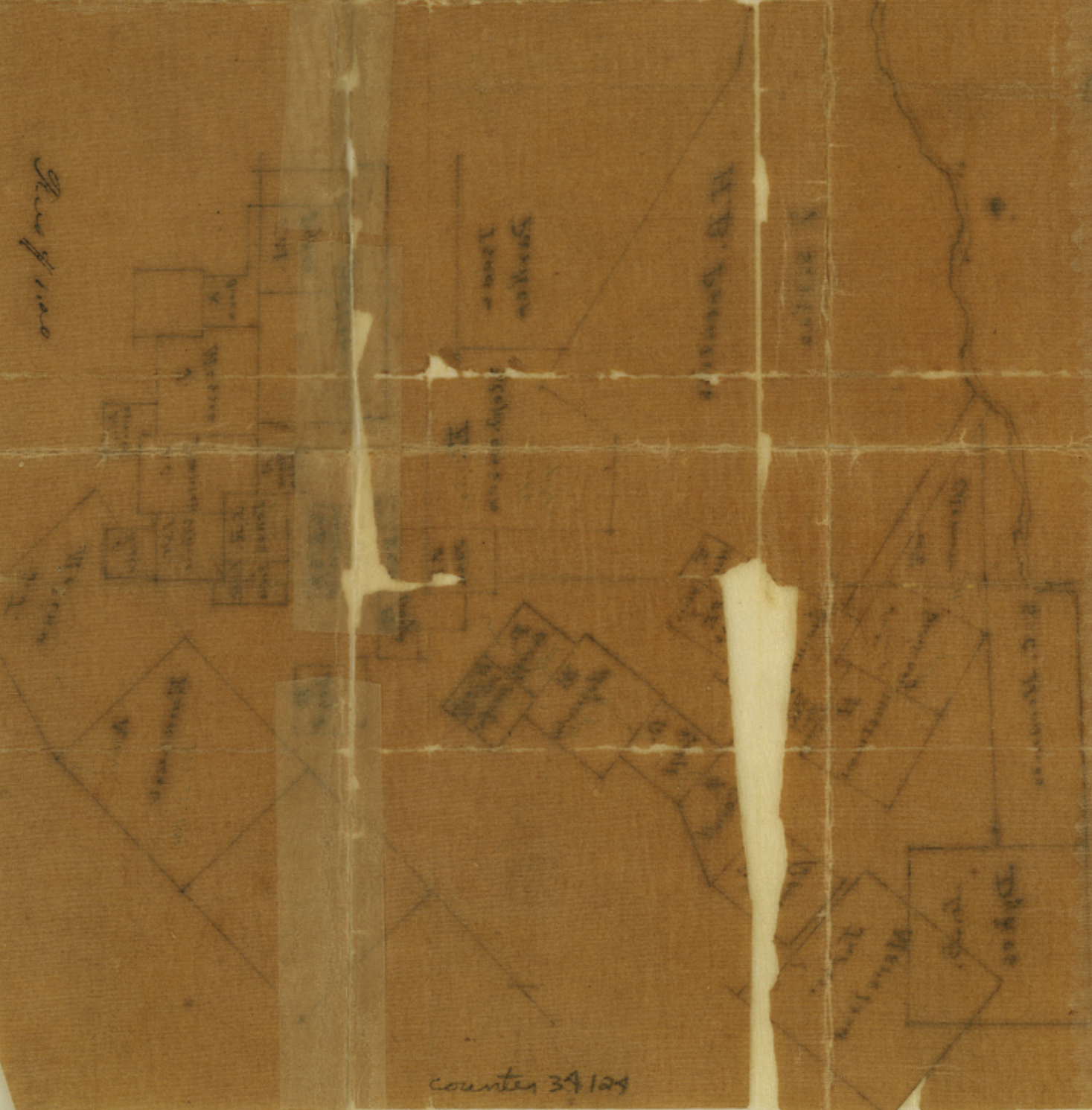

File No. SK. File 3

Polk County

Filed 12-22 49 1848

J. EARL RUDDER, Com'r.

By _____

Sk. S. E. E. of Livingston

by F. Hardin

J. EARL RUDDER
COMMISSIONER
GENERAL LAND OFFICE
AUSTIN 14, TEXAS



counter 34125