

State of Texas }  
 County of Polk } I W. V. Matthews County  
 surveyor of Polk county, Texas do hereby certify  
 that the titled league in name of Juan Simon  
 Lagarime is situated in Polk county, Texas, on  
 the waters of Big Sandy creek, about 15 miles  
 S 80° E from the town of Livingston, and  
 that said Lagarime league begins  
 N 45° E 5000 rods from the N.E. corner  
 of the F. Castaneda and the S.E. corner  
 of the Lowery J. Hampton league, and  
 that the ground now covered by the Lowery  
 J. Hampton league is identically the same  
 ground originally covered by the  
 J. A. Thouverain league, and ~~at~~ at  
 which S.E. corner the Dr. Geo. B. Browning  
 league has its beginning corner.

Now to prove and substantiate the above  
 certificate I make the following statement  
 of facts, The W. E. Watson (a lost league)  
 begins at the S.W. corner of the A. Thouverain  
 league. Thence N 45° W 5000 rods here it des-  
 cribes its N.E. cor. which is exactly the same as  
 the description of the N.W. cor. of the Lowery J.  
 Hampton league (see sketch) The Dr.  
 G. B. Browning begins at the S.E. corner of  
 the A. Thouverain, and runs thence  
 S 45° E 5000 rods. (This is now the S.E. corner  
 of the L. J. Hampton league) The F. Castaneda  
 runs from the S.E. corner of said Hampton  
 league S 45° E. The said Browning run  
 from the same point; runs the same course,  
 as the said Castaneda, these two lines  
 the N.E. line of the Castaneda and S.W. line  
 of the Browning describe the same  
 natural and artificial points along this

Feb 29 1854  
 W. V. Matthews  
 Surveyor of Polk county  
 State of Texas



line, The S.E. corner of the Costandea and the SW corner of the Browning leagues have exactly the same description, as originally made, <sup>in their field notes,</sup> (see sketch, also original field notes)

I have recently been on the ground and with sworn chain carriers carefully measured from the N.E. corner of the F. Costandea league S45°E (variation N9°15"E) and at 380 vs. I found a spring branch, at 460 vs. a spring branch, at 1055 vs. the old trail or trace from the Boshatta Indian Village to Nacogdoches (now a road) at 1300 vs a branch at 4970 vs. I found the old cor. a Black oak 12' (now about 16') br. S16½E 7½ vs. a Pine 20' br. N72W 48 vs. This oak is now standing with old scars on it but I can make out no porticula marks, this pine has fallen down, but the marked side is upward and shows an old blaze and cross marks, thus X,

From this corner I run N45°E at 2070 vs. I found a spring branch one vara wide, at 3340 another spring branch, at 5000 vs I turned N41°W and at 2110 vs. I found a branch or ravine 3 vs. wide, at 3189 vs I could not find the old ~~B~~ Indian trace because it has not been traveled any for about forty years, the road having been turned in a different direction.

These are all the points I could identify of the G. B. Browning league, The Juan Simon Rogarins league begins at the NE corner of said Browning, Thence N45°E 5000 vs. Thence S45°E 5000 vs. Thence S45°W



5000 or to the S.E. corner of said Browning.  
See the following sketch for more definite  
understanding. The black figures are the  
distances as given in the original field notes  
The red figures are the distances as I found  
them on the ground.

I W.H. Matthews county surveyor  
of Polk county do hereby certify that  
the above and foregoing certificate and  
statement of facts are true and correct  
Given under my hand at Livingston  
Texas, Oct. 6<sup>th</sup> 1891

W.H. Matthews  
Co. Sur. of Polk Co. Texas



B

Black oak 12' N 31 E 19 m. This cor. the corner for  
Watson + Hampton  
Mills oak 12' N 46 E 15 m.

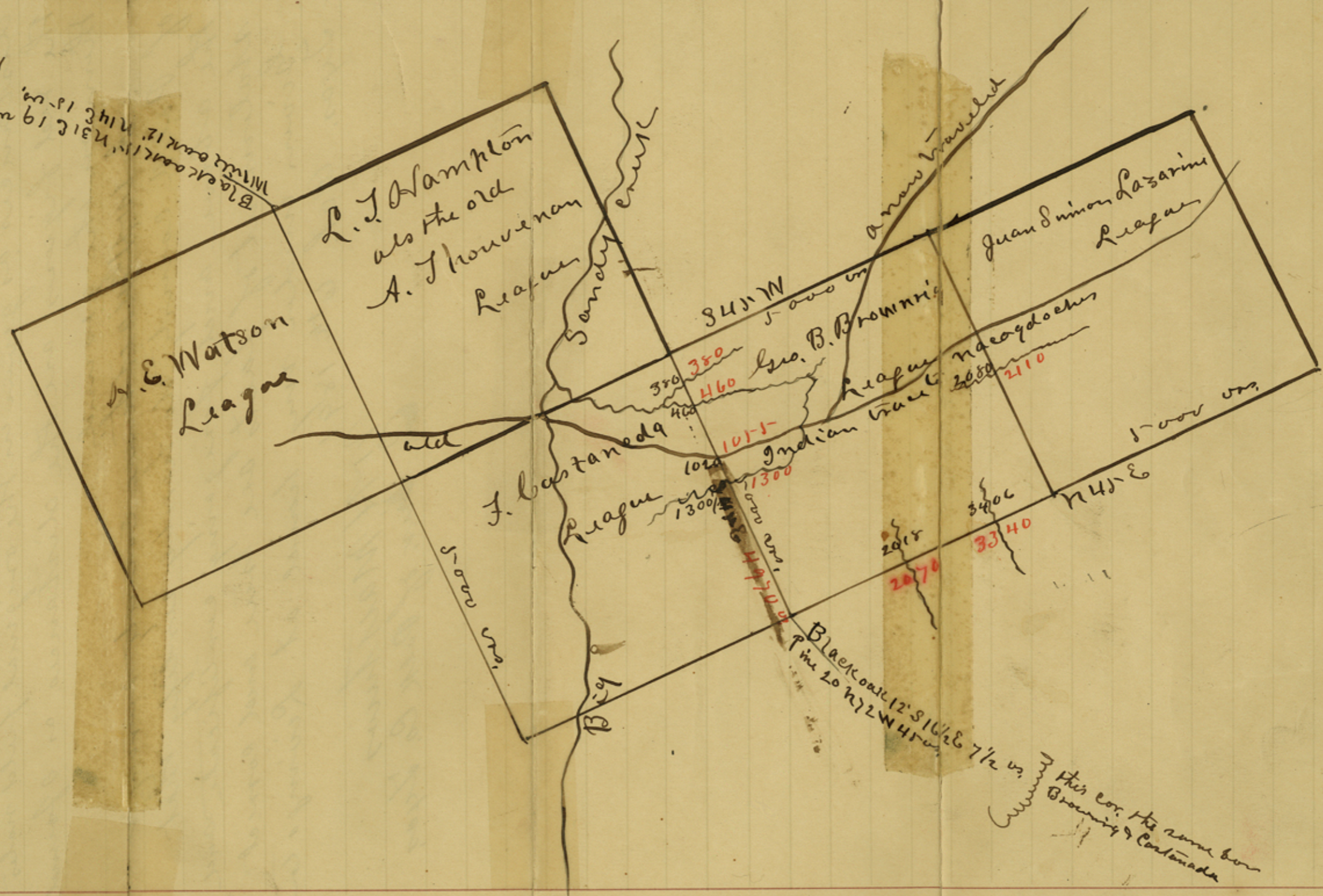

Filed in the General Land Office  
Decemb. 1/91  
Chick Clark  
Chief Clerk.