

Statement - of facts to Hon. R. M.
Hall Commissioner of the Land
Office

In reply to a letter from
him dated 22nd of March 1887,
I will state that the H. E. Watson
survey calls for its beginning at
the SW or South cor. of an
obsolete survey in name of Thowm
on ground now occupied by the
Lowery J. Hampton league, and as
the Hampton beginning corner
has no bearing trees, the bearing
trees of the Watson must
necessarily be that of the Hampton
or Thowm, as the Watson calls
for that beginning. The NW
or West cor. of Hampton and
the NE or West-northerly cor.
of Watson calls for identically
the same trees, a Black oak
or Red Oak being the same
kind of timber and a white
oak, I found the white oak
with very old marks, and a
stump hole comparing with
the call of the Red oak. The
call for a bayou at 3270

PAID 00.56. File #32
may have been an error
although there is a low snag
at about that distance and
might have been running
water in a wet season.

The call of the beginning of
Watson with Hampton
and the NW or west of
Hampton and the NE or
most-northerly cor. of Watson
being identically the same
and the old lines on the
ground intersecting each
other, and the locality of
the Watson calling for its
situation on the waters of
Big Sandy show that the
league is properly located
as to the North cor. of the
Hampton you refer to in your
letter, has no connection
with the Watson league
as shown in the inclosed plat-
and for further ^{proof} refer you to
the records of the Civil Land
Office. The facts stated
above I certify to

Livingston, Park Co. Texas
April 22nd 1887

W. H. Matthews
County Surveyor of
Park Co. Texas

Page 10

F²

Juan Falcon

Maria

Lindsey

This corner is divided by the
Watson & Stampfer

Stampfer
& Nash

St. G.
Watson

Franciscia

Castomda

1859
1860
1861
1862
1863
1864
1865
1866
1867
1868
1869
1870
1871
1872
1873
1874
1875
1876
1877
1878
1879
1880

The beginning
corner of the
Watson & Stampfer



counter 34228

F²

800000

Fs

32.

Bull Co

W.H. Matthews' 5K. & Report
about 12 M. S. 70° E. of
Livingston

Dated Apr. 22, 1887.

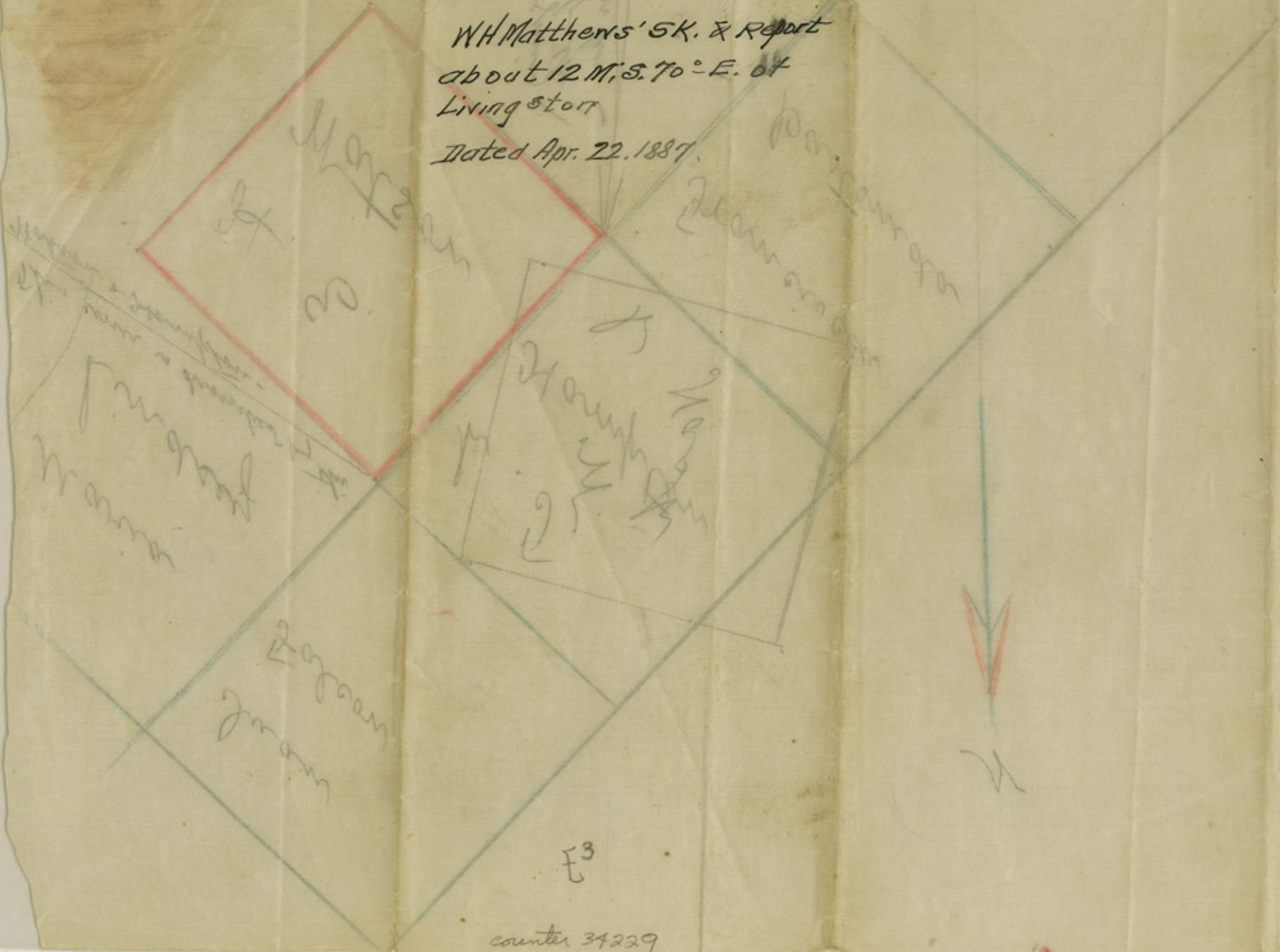

E³

counter 34229