

C O P Y

Walde, Texas,  
Jany. 13, 1921

Mr. John Humphris,  
Marfa, Texas.

Dear Sir:

Yours to hand several days ago. Not having data at hand cause of delay in answering.

Some six years ago I made a survey for Mr. William Kingston of Jeff Davis County, to locate the Hot Spring, after which he made application to lease it and the section east for the use of his brother-in-law and use by the public free for bathing.

The School records there should show the lease. I suppose it was a five year lease, as I got a letter from him last spring while in Los Angeles, Cal., wanting data regarding same.

I went to NW Cor. 34 and NE Cor. 35, Blk 2, and ran a line due west without measurement; then went to corner set by Tarver on fence E. & W., supposed north line of 78 & 95, Blk 2; ran west to W. fence of Priolla's land; struck 350 vas south of mound in forks of creeks claimed to be corner by T. Miller. Wilson said Tarver ran south from same corner I did to north. Do not know where Miller ran from. I ran from the mound in forks of creeks N 45 W, intersecting my line west; there established a mound. Then went 350 vs. west, placed another, so to be sure of position of spring. Then one mile west and one north. There set line W. and north. Found the ranch and springs on 18, while the parties on it claimed ~~XX~~ it to be on another survey.

I also made a survey of Candelaria. Found well defined corner of 12 & 13 above there; ran down and found the town on No. 9 on down to 1; found 2 contained 1280 acres. They have by some hook or crook shoved 8 over on 9. The corner of 12 & 13 is on water bluff and W. of high bluff some 20 ft. high. After getting on top and running on out about 500 varas, found a stone mound in bush. From this point the capata mtn can be seen. I put a bluff true course called for in notes. Here the variation can be gotten. From this point I ran diagonal south. Placed mds every 1344 varas. The old school teacher that took 8 was with me. I found all the surveys fit to old channel, the river has made many changes. I understand these surveys were pulled around to a variation of 17 degrees, while 9 degrees 15 minutes run them. The Hot spring is about 600 varas NW of the 350 Vs. W. md. on S. slope of ridge.

Trusting this will give what you want. I also located 38, 52, and 58.

Respectfully,

(Signed) O. H. Hector.

counter 34605



C O P Y

Office of the County Surveyor,  
Presidio County.

Marfa, Texas.,  
March 23, 1920.

REPORT OF A SURVEY MADE MARCH 22, 1920 to locate the  
position of the Hot Springs in Block 2, D. & P. Ry. Co.

Upon looking over the ground, I decided to run traverse  
from the S. W. corn. of Sec. 44, as this cor. is well established  
and well known by reliable people who live in this neighbor-  
hood. This section corner was the original corner placed by  
Dan Buckley in surveying this Block. It has also been used  
by subsequent surveyors in correcting the Tex. Mex. Block No. 2  
and 5.

Our traverse located the spring 6353 varas East, 1820  
varas North of this corner (S.W. cor. Sec. 44).

We then returned to the S. W. Cor. of Sec. 44, and set up  
and ran the line East at 1900 varas we passed 15 varas S. of  
the original monument placed for the S. E. Cor. of Sec. 44  
and the S. W. cor. of Sec. 25 at 3800 varas pass ten varas  
S. of the S. E. cor. of Survey 25 and the S. W. Cor. of Sur. 26.  
At 5700 varas we looked for but could not find stone mound.  
We placed one, however, turning North at 1900 varas could not  
find the stone mound but placed one and ran East, passing No.  
of the Hot Springs 100 varas and 650 varas East of N. W. Cor.  
Sur. 27 On 1900 varas in all placed stone mound for corner.  
Thence S. 1900 varas placed a stone mound for corner. Thence  
west 1900 varas to the place of BEGINNING.

Respectfully submitted,

(Signed) F. W. Cook,

County Surveyor.

FWC:mjf

counter 34607

1357

THE TOOTLE ESTATE  
SANCT JOSEPH, MO.

RECEIVED

JAN 25 1921

Referred to Comr.

January Twenty-first  
Nineteen Twenty-one

R-76

State Surveyor,  
Austin, Texas.

Dear Sir:

We are the owners of Sec. 27, Block 2, Presidio County. We have had considerable correspondence with our agent at Marfa (J. Humphris) as to whether certain hot springs are located on this section or not, there being a party who claims that these springs are not on our lands.

On March 1, 1920, we had a survey made by F. W. Cook, County Surveyor, Presidio County. A report of his findings, together with a blue print of his survey, is attached hereto for reference. Further development shows that there have been four surveys made as to the location of these hot springs, one survey showing them located on Sec. 18, one on Sec. 27, one on Sec. 17, and one on Sec. 41.

We desire to definitely locate these hot springs, and would thank you to advise us the approximate cost of having a survey made under your jurisdiction, which should definitely settle the matter.

Very truly yours,

THE TOOTLE ESTATE,

BY *Frederic Halcomb*  
Secretary.

FMH:JAB

P.S. We are enclosing herewith statement of a Surveyor by the name of O. H. Hector, who ran a survey in regard to the location of these hot springs several years ago.

counter 34608

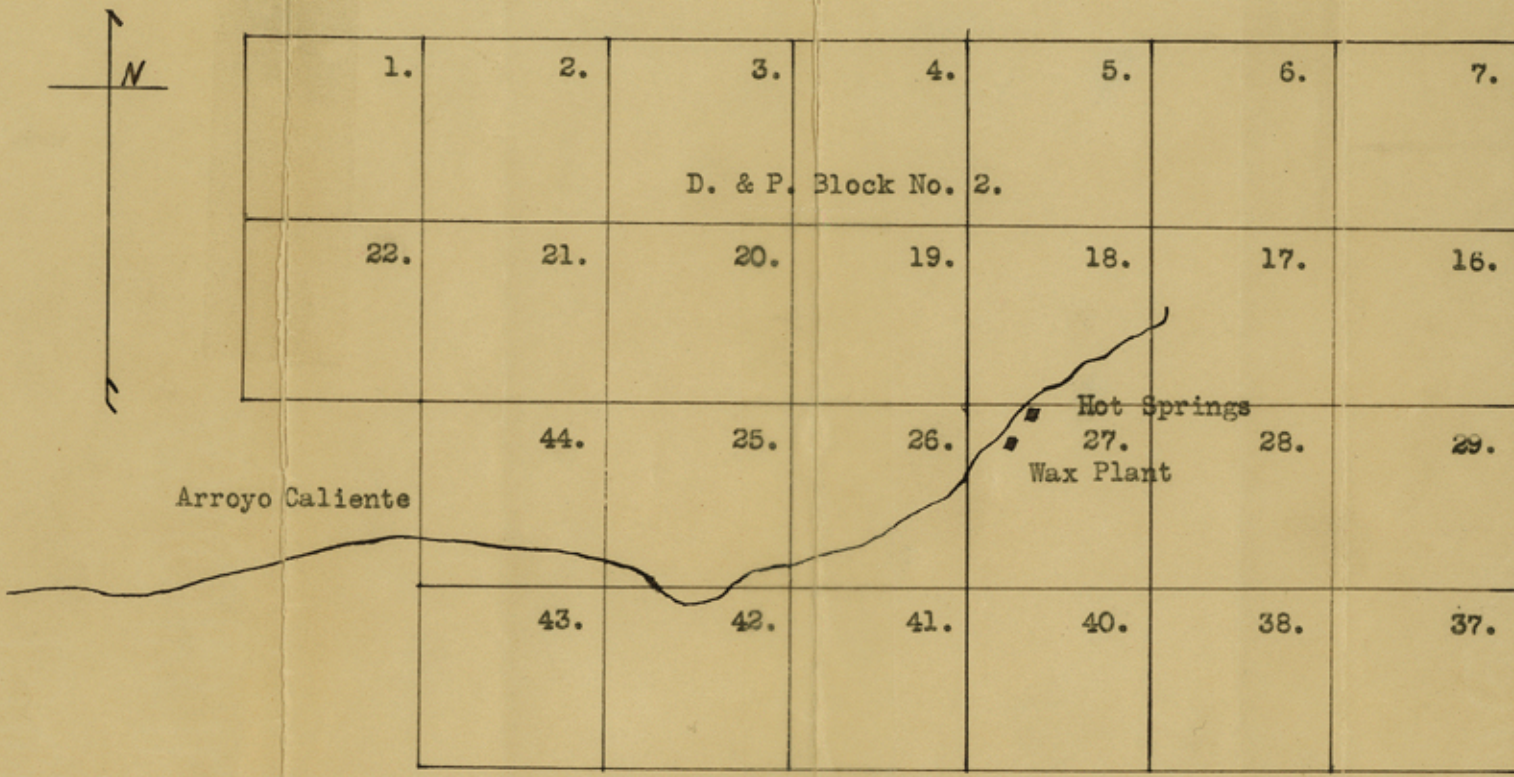

Plat of Certain Sections of Block No. 2,  
 D. & P. Ry. Co., showing location of  
 Hot Springs and the Wax Plant.  
 Surveyed March, 1920, by F. W. Cook,  
 County Surveyor of Presidio County, Texas.

counter 34609