

No. 59.

Presidio County
Sketch Files

Calculations
for
Area

Jan 9-1935

GENERAL LAND OFFICE
AUSTIN, TEXAS

counter 34637

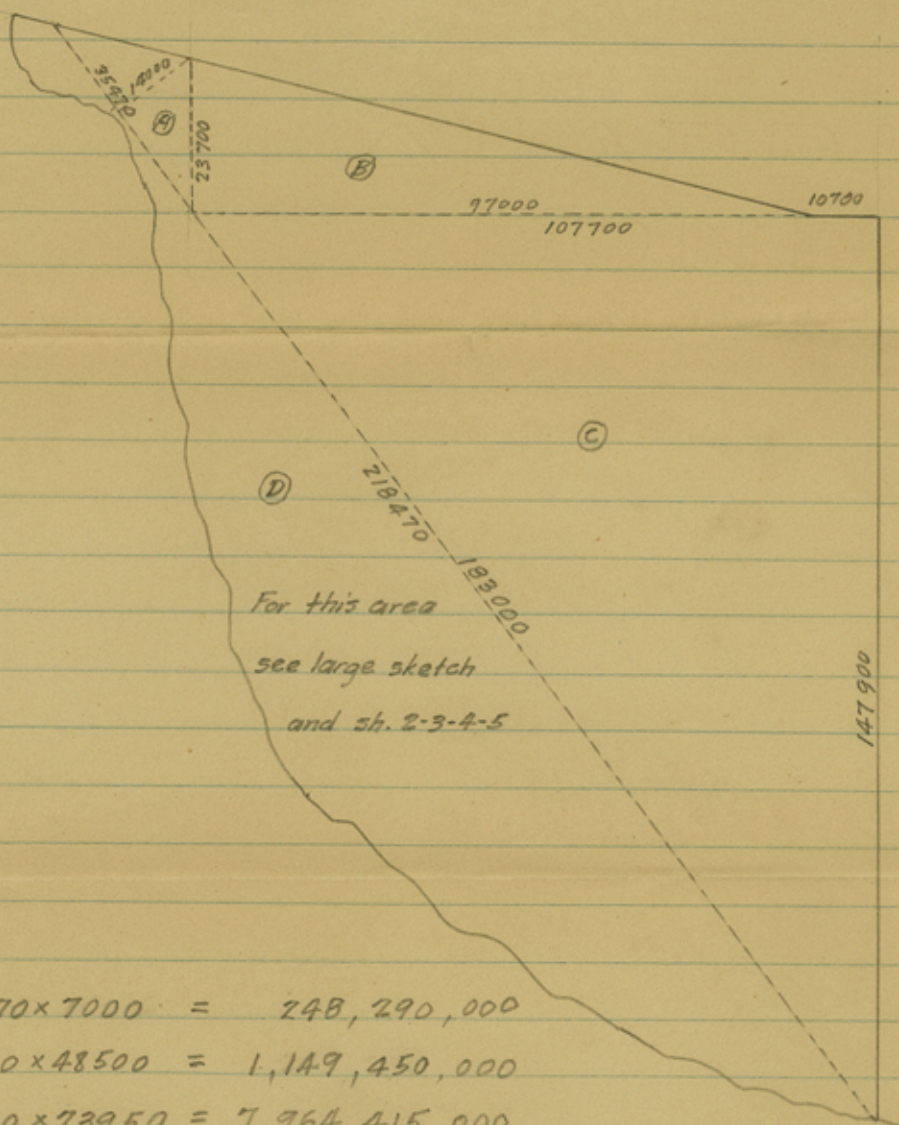

- (A) $35470 \times 7000 = 248,290,000$
- (B) $23700 \times 48500 = 1,149,450,000$
- (C) $107700 \times 73950 = 7,964,415,000$
- (D) Sh. 2-3-4-5 = 4,316,987,000

$13,679,142,000$ sq. vs.
 $2,423,060$ Acres
 $3,786$ sq. mi.

1-4-35
J. P. Barrow

Presidio County

Sh. 2 of 5

0	0			32	4200	4075 × 1000 = 4 075 000
1	2000	1000 × 1000 = 1,000,000		33	4900	4550 =
2	1750	1875 =		34	5550	5225 =
3	2400	2075 =		34	550	0 =
4	3400	2900 =		35	1450	1000 =
5	3600	3500 =		36	2000	1725 =
6	4400	4000 =		37	2400	2200 =
7	5500	4950 =		38	3350	2875 =
7	500	x		39	3500	3425 =
8	1100	800 =		40	3850	3675 =
9	1800	1450 =		41	4200	4025 =
10	3000	2400 =		42	4400	4300 =
11	3800	3400 =		43	4600	4500 =
12	4850	4325 =		44	4300	4450 =
13	5000	4925 =		45	4050	4175 =
13	0	x		46	4100	4075 =
14	1150	575 =		47	4550	4325 =
15	2200	1675 =		48	4600	4575 =
16	3000	2600 =		49	4800	4700 =
17	4350	3675 =		50	4100	4450 =
18	4850	4600 =		51	3900	4000 =
19	⁵⁵⁰⁰ 500	5175 =		52	2100	3000 =
20	1100	800 =		53	4250	3175 =
21	1600	1350 =		54	3600	3925 =
22	2300	1950 =		55	3400	3500 =
23	2850	2575 =		56	3500	3450 =
24	3250	3050 =		57	3900	3700 =
25	3550	3400 =		58	4400	4150 =
26	3300	3425 =		59	4200	4300 =
27	2950	3125 =		60	5100	4650 =
28	3100	3025 =		60	100	0 =
29	3600	3350 =		61	750	425 =
30	3750	3675 =		62	1350	1050 =
31	3950	3850 = 3 850 000		63	2100	1725 = 1 725 000
counter 34639						

Presidio County

Sh. 3 of

63	2100			95	2850	2875 x 1000 = 2,875,000
64	3300	2700 x 1000 = 2,700,000		96	²⁴⁵⁰ 950	2650 =
65	5200	4250 =		97	700	825 =
65	200	0 =		98	200	450 =
66	1000	600 =		98	5200	0
67	1450	1225 =		99	4700	4950 =
68	1650	1550 =		100	4300	4500 =
69	2100	1875 =		101	3600	3950 =
70	2800	2450 =		102	3350	3475 =
71	2850	2825 =		103	3600	3475 =
72	2050	2450 =		104	3950	3775 =
73	2200	2125 =		105	2400	3175 =
74	1850	2025 =		106	2200	2300 =
75	2000	1925 =		107	2150	2175 =
76	2200	2100 =		108	2200	2175 =
77	2100	2150 =		109	2150	2175 =
78	²³⁰⁰ 4100	2200 =	< 1800 x 500 = 450,000	110	2700	2425 =
79	4600	2350 =		111	1750	2225 =
80	5100	4850 =		112	1950	1850 =
81	5100	5100 =		113	2150	2050 = 1800
82	5100	5100 =		114	1900	2025 =
82	100	0		115	1650	1775 =
83	1100	600 =		116	1150	1400 =
84	1100	1100 =		117	1250	1200 =
85	500	800 =		118	1350	1300 =
86	1550	1025 =		119	1350	1350 =
87	1000	1275 =		120	900	1125 =
88	1750	1375 =		121	900	900 =
89	2200	1975 =		122	1100	1000 =
90	2550	2375 =		123	900	1000 =
91	2900	2725 =		124	950	925 =
92	3200	3050 =		125	1250	1100 =
93	2700	2950 =		126	950	1100 =
94	2900	2800 = 2,800,000		127	1700	1325 = 1,325,000

counter 34640

Presidio County

5h.4 of 5

127	1700			156	1700	2100x1000 = 2100 000
128	1150	1425x1000 = 1,425,000		157	1300	1500 =
129	1100	1125 =		158	1200	1250 =
130	300	700 =		159	650	925 =
130	5300	X		160	500	575 =
131	⁵⁰⁰⁰ 4300	5150 =		160	5500	X
132	4450	4375 =		161	4900	5200 =
133	3350	3900 =		162	4800	4850 =
134	2400	2875 =		163	3550	4175 =
135	2100	2250 =		164	3800	3675 =
136	²⁴⁰⁰ 1600	2250 =		165	3700	3750 =
137	800	1200 =		166	3600	3650 =
138	650	725 =		167	3400	3500 =
139	0	325 =		168	4000	3700 =
139	5000	X		169	4700	4350 =
140	4700	4850 =		170	4300	4500 =
141	4800	4750 =		171	4500	4400 =
142	4200	4500 =		172	3600	4050 =
143	3300	3750 =		173	2900	3250 =
144	3350	3325 =		174	2550	2725 =
145	2450	2900 =		175	²⁶⁰⁰ 3500	2575 =
145	7450	X		176	3450	3475 =
146	4350	5900 =		177	3400	3425 =
147	4100	4225 =		178	3600	3500 =
148	2900	3500 =		179	3850	3725 =
149	2500	2700 =		180	4200	4025 =
150	1900	2200 =		181	4100	4150 =
151	2100	2000 =		182	4500	4300 =
152	1100	1600 =		183	3350	3925 =
152	4400	X		184	2400	2875 =
153	4700	4550 =		185	2200	2300 =
154	2900	3800 =		186	3600	2900 =
155	2500	2700 = 2,700,000		187	4200	3900 = 3,900,000

Counter 34641

Presidio County

5h.5 of 5

187	4300			220	2800	$2500 \times 1000 = 2,500,000$
188	4500	$4400 \times 1000 = 4,400,000$		221	2000	2400 =
189	5000	4750 =		222	900	1450 =
190	4700	4850 =				$900 \times 750 = 337,500$
191	3600	4150 =				z
192	1700	2650 =				
193	1700	1700 =				
194	1600	1650 =				
195	1600	1600 =				
196	1700	1650 =				
197	1050	1375 =				
198	450	750 =				
198	5450	X				
199	4700	5075 =				
200	4200	4450 =				
201	3200	3700 =				
202	3050	3125 =		5h. 2		202 850 000
203	2400	2725 =		3		141 350 000
204	²⁰⁰⁰ 2300	2200 =		4		190 750 000
205	2300	2300 =		5		72 037 000
206	1450	1875 =			Rectangle (a)	30 000 000
207	1600	1525 =			(b)	60 000 000
208	1300	1450 =			(c)	225 000 000
209	⁰ 300	650 =			(d)	520 000 000
210	600	450 =			(e)	125 000 000
211	250	425 =			(f)	510 000 000
212	400	325 =			(g)	560 000 000
213	350	375 =			(h)	960 000 000
214	650	500 =			(i)	225 000 000
215	550	600 =			(j)	120 000 000
216	0	275 =			(k)	105 000 000
217	700	350 =			(l)	80 000 000
218	2000	1350 =			(m)	190 000 000
219	2200	2100 = 2,100,000				<u>4,316,987,000</u> ✓

counter 34642