

I R. J. Munro County Surveyor of Presidio County Texas. Certify That I. Personally Made this survey on the ground as Shown by the plot. & Field Notes.

R. J. Munro
 County Surveyor
 Presidio County
 Texas.

SKETCH
 OF
 CERTAIN SECTIONS
 OF
 QM. & SA BLOCK 7
 SURVEYED FOR
 HENRY T. FLETCHER of MARFA TEX.
 AND
 W. LEE FISCHER of MARFA TEX.

SCALE 2 in = 1900 VARAS
 VARIATION $13^{\circ} - 00' E$

the

NAVIGATION 13-00-E
SCALE 5" = 1000' MAGS

MILIE FISHERS OF MARINA TEX
ONE
YANKEE YACHTERS OF MARINA TEX
CONVEYED FOR
CH# 20 BLOCK 1
OF
CERTAIN SECTIONS

SKETCH
FOR

File No. 65
Presidio County
Sketch in Blk 7
Filed 2-21, 19 40
BASCOM GILES, Com'r
French
File Clerk

16x02
Presidio County
County Clerk
M. J. Munn
shown by the plot & field notes
made this sketch on the ground or
from a copy of the plat & person
18. 1. House county recorder of Presidio

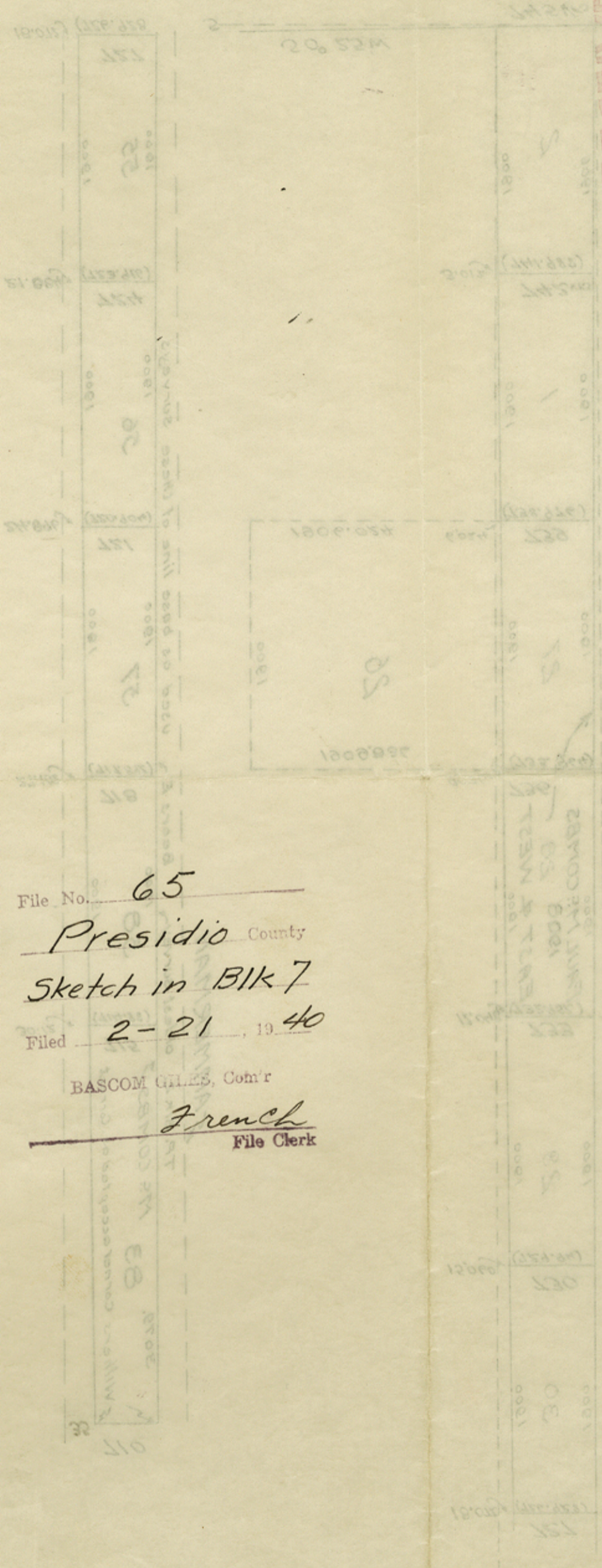

RECEIVED

FEB 21 1940

REFERRED TO MAP