

A Sketch of surveys connecting Blossom & Guest Prairies

Scale 2000 ft per inch

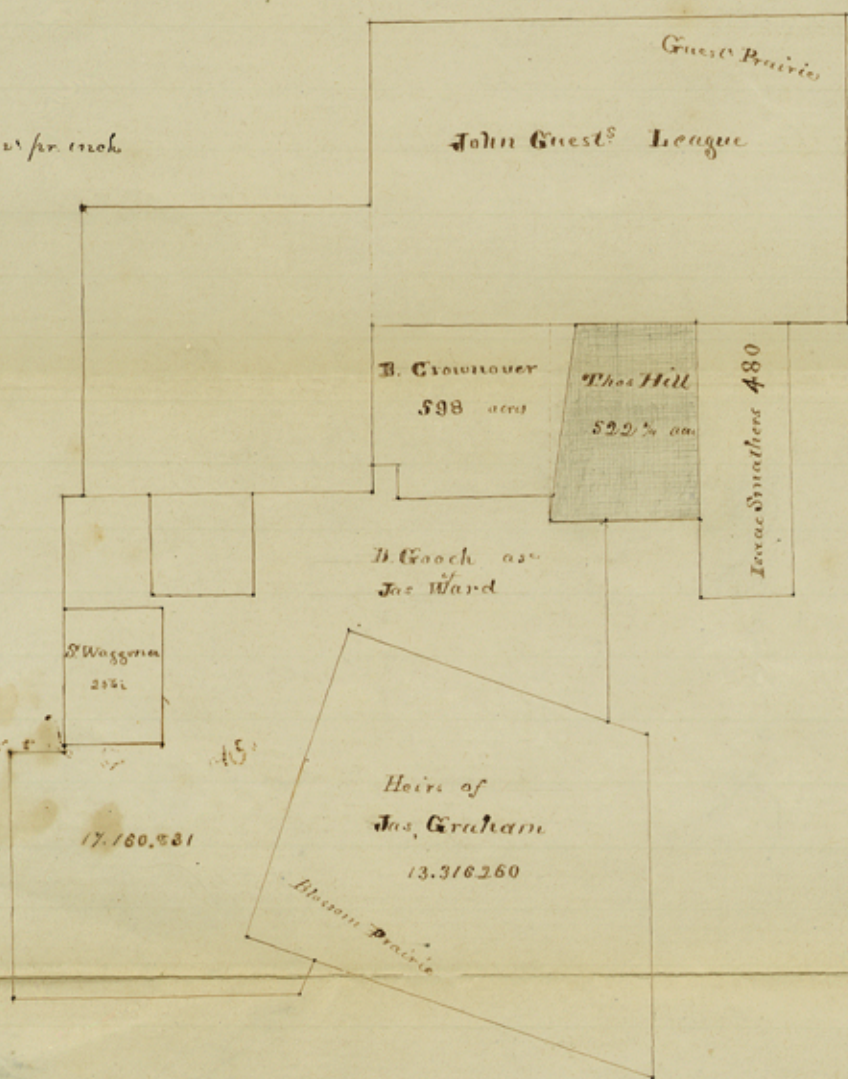

State of Texas. Red River District

I Certify that the above sketch is a true representation (and their connections) of the surveys therein mentioned drawn from recent surveys all of which appears of Record in my Office

Given under my hand this 5<sup>th</sup> day of December 1854

William D. Orr Secy Red River Dist

Primer April 24/55

File A<sup>9</sup>  
Red River Co

~~Wm~~ ~~Wm~~ ~~Wm~~ ~~Wm~~

Jno Guest Leave

Blossch

counter 35094