

1935  
 Nov 20 - 1935  
 J. H. Walker, County Clerk  
 Roberts Co. Texas  
 1935

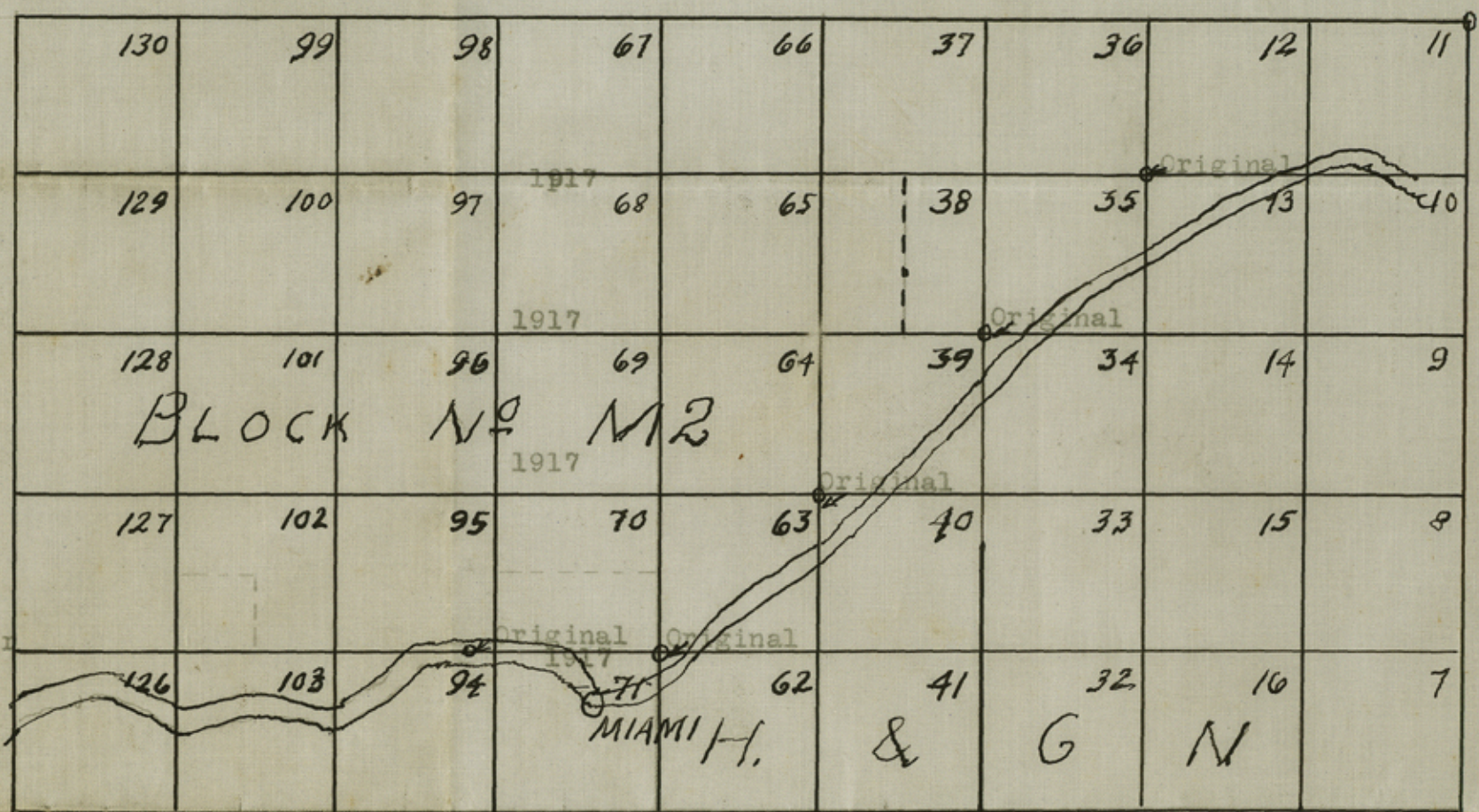

Has been recognised Old Cor  
 for 30 yrs or more do not  
 know by whom set.

I find there is 17 vrs excess in north  
 line of survey No 71 as the original  
 NE cor said 71 was marked with CW  
 bearing N.45.E .80vrs and NW corner  
 had A rock monument brs west 275 vrs  
 both of these points can still be found  
 so that will give same width to Sec No68.  
 and have corrected notes .

I D B Stribling Licensed State Land Surveyor of  
 Texas do hereby certify that the foregoing Plat  
 are true and correct and that said survey was  
 actually made on the ground.  
 This 15 day of November 1935.

I D B Stribling  
 Licensed State Land Surveyor  
 of Roberts Co. Texas.



R R Co

Sketch File No. 6<sup>H</sup>

Roberts County  
B.K. M2

*Return Sta.  
for imprint  
Survey Seal  
1-3-36  
Atlas*

Filed Jan. 30 - 1936

J. H. Walker, Commr.

Atlas  
File Clerk

Descriptive:

*9*

of Roberts Co., Texas.  
Licensed State Land Surveyor  
*Ed J. Smith*



There is a copy of November 1935.  
actually made on the ground.  
the line and correct and that said survey was  
Texas do hereby certify that the foregoing plat  
I D B. Gristling Licensed State Land Surveyor of  
and have corrected notes.  
so that will give same width to sec 30, 31,  
both of these points can still be found  
had a rock monument at west SW corner  
bearing N. 45. E. 30 yds and NW corner  
bearing N. 45. E. 30 yds and NW corner  
line of survey No. 21 as the original  
I find there is 1/4 acre excess in north  
know by whom set.  
for 30 yrs or more do not  
has been recognized Old Cor

