

~~File 10~~
File 4.
Rockwall Co.

~~Kaufman County~~

Surveyors Sketch and
Certificate

On Bois d'Arc East Fork

County 35719

Filed March 8/60
C. W. Proffers

S.W.
 May 6
 William
 Searle
 Montgomery
 O. H.
 Searle

This will certify that the John Early Survey
 of 369 acres on Cedar Creek about 15 miles
 East from the town of Kaufman is made
 on a Survey previously made in the name
 of O. H. Searle for 640 in the year 1848, by
 virtue of donation Land Certificate No. 1183, issued by
 Secretary of War November 10th 1841, as shown by the
 Records of my office, upon which I make this certifica-
 tion of notes - and that said Survey does exist as
 represented by the field notes, with it lines and
 corners marked on the ground - and the above sketch
 is a correct representation of the same

This June the 31st 1860

H. W. Searle

The L. Banks 390 @, as mentioned in your
 list, is not represented on the map of Kaufman Co.
 neither the John C. Fitzgerald. The map does
 not show any survey closing on the East bank
 my line of either of the B. S. Newmans surveys.
 neither can I find any such survey by any
 course that suits the field notes

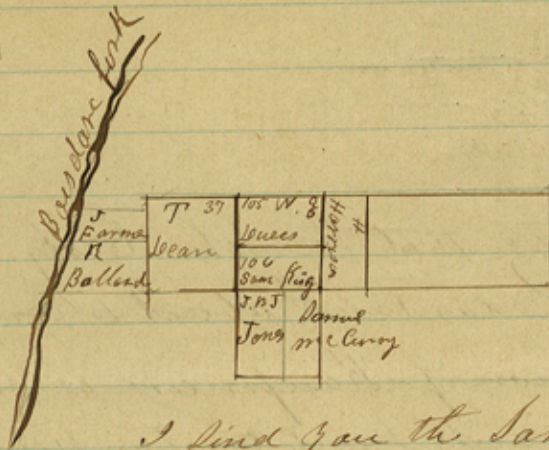

The S King Sur lies 28 miles
N15W from the Town of Raup

I find you the Samuel King Sur. 1906 with
its surrounding Survey, The N Atterberry
Survey is not on the Kaufman map, The
field notes call for it to be on the West side of
the Bridgford fork of Trinity, which leave the
Survey between as you can see in the above
Sketch,

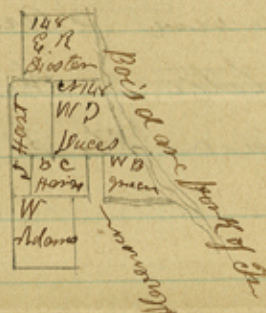

The Wm. Adams - 320 acre Survey joins B.C. Harris
the above sketch shows its surrounding Survey
as on Record, The old crook tree mentioned in your
list is the B.C. Harris 320. @, Sur being made for B.C.
Harris by virtue of old Crooktree Certificate it is shown
in the above sketch by the name B.C. Harris

all of the above sketches is made by the
Records of this office This Jan 31st 1866

H. W. Hays
Co. Surveyor, Raup



1857 1900

The State of Texas
 Kaufman County

I H. W. Byers County Surveyor of

Kaufman County do hereby certify that I have been upon the ground and surveyed the Wm W Ford tract No. 152 and find that it does not conflict with any surrounding survey, and that the above is a true sketch of the same. Given under my hand at office this the 16th day of January 1860. H. W. Byers, C. O. Sur

veyor, you will perceive that the H. K. Newell tract conflicts 100 bars on the whole length of the James Ramsey East boundary line =

This will
 of 369 acs
 East from
 on a survey
 of O. H. Sinsly
 virtue of donation
 Secretary of war
 Records of my office
 of notes - and then
 represented by the
 Cor marked on
 is a correct repr
 This

1849
 3
 1013

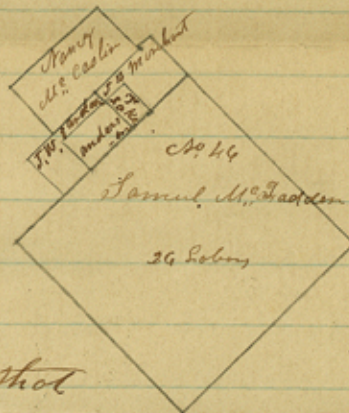

The State of Texas

Kaufman County

I, H. W. Byers County Surveyor for

Kaufman County do hereby certify that I have surveyed and found the correct locality of the Samuel M. Hadden 26 Acre Survey, No. 46 - and the Nancy M. Cashin Survey No. 205 - and find that there is space between them from the J. B. Merchant, J. W. Gardner S. Lake, and Anderson surveys, as shown in the above sketch, which is their true position on the ground. Given under my hand at office this the 18th day of January 1860 H. W. Byers (C. O. Sur

veyer
 Secy K. Co. Texas

counter 43370

The L Banks list, is not depre
 neither the John
 not show any sur
 my list of either of
 neither can I
 cause that suits

count