

17<sup>a</sup>

Puck Co

Mutilated sketches and  
parts of sketches.

counter 35522



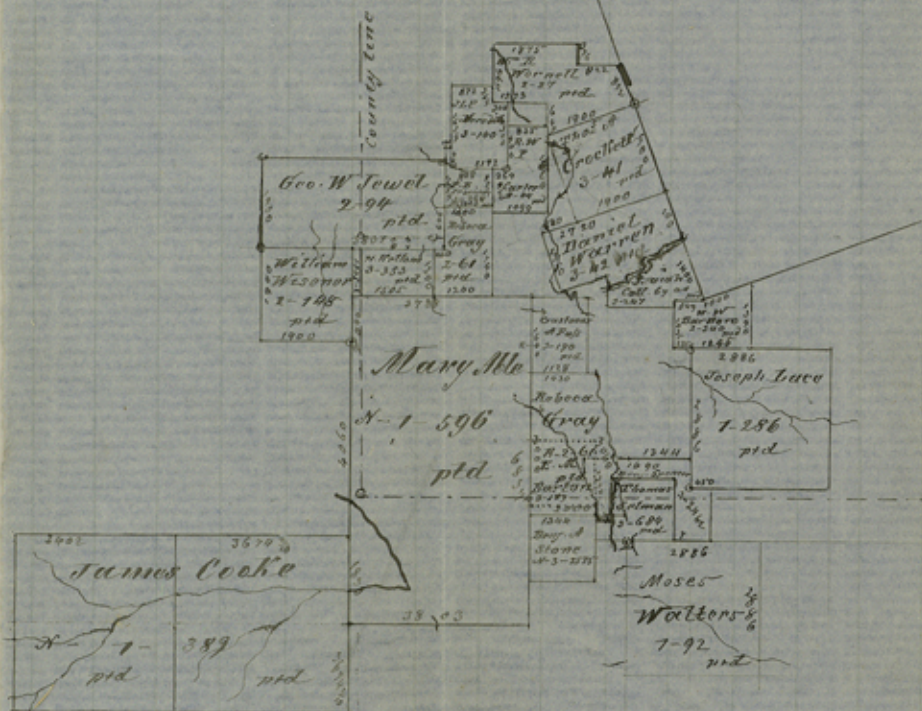

you will perceive from this sketch that  
 there is a small error in the map of  
 Pusk County near the Sabine River which  
 was occasioned by a Dept Surveyor giving  
 a wrong course in one of the lines of W J  
 McClurgs survey this mistake has since  
 been corrected  
 Jas N Brown