

Co.  
Co.

BAY

MESQUITE  
ARANSAS  
CALHOUN

Matagorda Island

S. 45° W. 7920'

W. 5280'

to the N.W. Cor  
of first league

No course or  
distant given  
to beginning point

J. W.

Hewitson

N. 45° E. 7920'

J. Power

set a post

St. Joseph Island

to point of this Island  
or distant given  
(Matagorda Is)

At Matagorda Island  
began League #1 at the Beach  
on the South Side

N. 45° E. 11,400'

Calhoun Co.  
Sketch File No. 9

Sketch of surveys in  
CALHOUN CO.

GENERAL LAND OFFICE - AUSTIN TEX.  
- Bascom Giles - Commissioner -

May - 1953, O.G.K.

See File No. 10  
Miscellaneous Box No. 12

2-19-57 RCW

Counter 35936

2

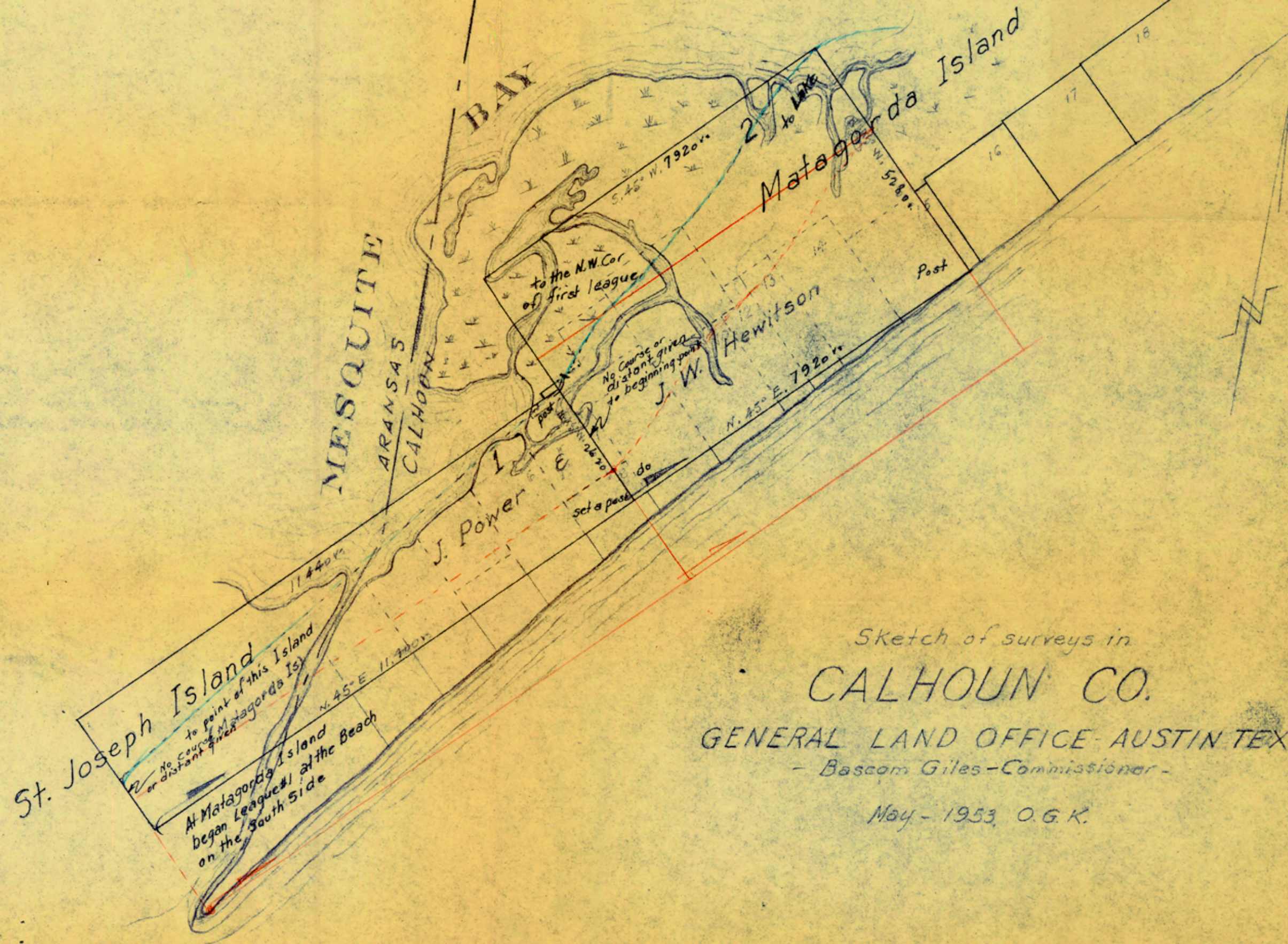

Sketch of surveys in  
**CALHOUN CO.**  
 GENERAL LAND OFFICE - AUSTIN TEX.  
 - Bascom Giles - Commissioner -  
 May - 1953, O.G.K.

sk. file (9)  
Calhoun Co.  
(Matagorda Island)

Co Co

BAY

Matagorda Island

MESQUITE

ARANSAS

CALHOUN

to the N.W. Cor  
of first league

No Course or  
distance given  
to beginning point

J.W. Hewitson

J. Power

St. Joseph Island

to point of this Island  
No Course or distance given  
to beginning point

At Matagorda Island  
began League at the Beach  
on the South Side

Sketch of surveys in

CALHOUN CO.

GENERAL LAND OFFICE - AUSTIN TEX.

- Bascom Giles - Commissioner -

May - 1953. O.G.K.

Count # 80000

789.7  
1274.6  
635.4  
2699.7

Copy of Calhoun Co.  
Sketch File No. 9

(Matagorda Island)