

FROM
KODAK & FRAME DEP'T.
TEXAS OPTICAL COMPANY

706 FANNIN
HOUSTON, TEXAS

*these pictures accompany
sketch File No. 28.
SAN PATRICKO.*



*Accompanies J. S. Boyles Report
on Chiltipin Creek - San Patricio County,
(filed 9-3-35)*

**"VELOX"
PRINTS**

MAIL ORDERS GIVEN PROMPT ATTENTION

No. _____

Name _____

Address _____

Rolls _____

Neg. _____

Size _____

Print _____

"Enlarge"

Remarks _____

To be sure of
obtaining
Velox Prints
Always let us
handle your
Photo Finishing

Dev. _____

Prints _____

Enlargements _____

Postage _____

Total _____

AUG 31 1935

28

counter 136087

KODAK AND FRAME DEPT.

Texas Optical Company
HOUSTON, TEXAS

706 Fannin St.

Fairfax 1022



counters 36088

Showing Wooden
dam in front of
Concrete and earth
dam -
facing north -

Showing dams across
Chittipin Creek - facing Westly

23

23

South abutment
facing South

23

Showing Low
Concrete dam
about $\frac{1}{2}$ Chittipin Cr.
facing West

Chittipin Creek Showing
original Creek bed - and levees
taken from top earth dam facing
West.

23

23

Showing South end of earth
dam where same has washed
out - facing West

23

counter 36089



counter 36090

Showing Cross section
of washed out South end of
dam on Chiltipin Creek - facing
North from South bank -

23

Showing Wood-Concrete and
earth dam - facing West

23

Showing area back of or west of
dam - old channel - facing East

23

Showing Wood dam and
Chiltipin Creek - Standing at
base of earth - facing east

23

(5)

Sketch File No. 28 (part 1)

San Patricio County

J. S. Bayles' Report
Chiltspin Creek

Filed September 3rd 1935

J. H. Walker, Comm.

C. F. Blucher

File Clerk

Descriptive: To determine total
area. See #28 (part 2) for
balance of report

aa'

RECEIVED

AUG 31 1935

SOFTENING
THE PRINT & SUPPLY

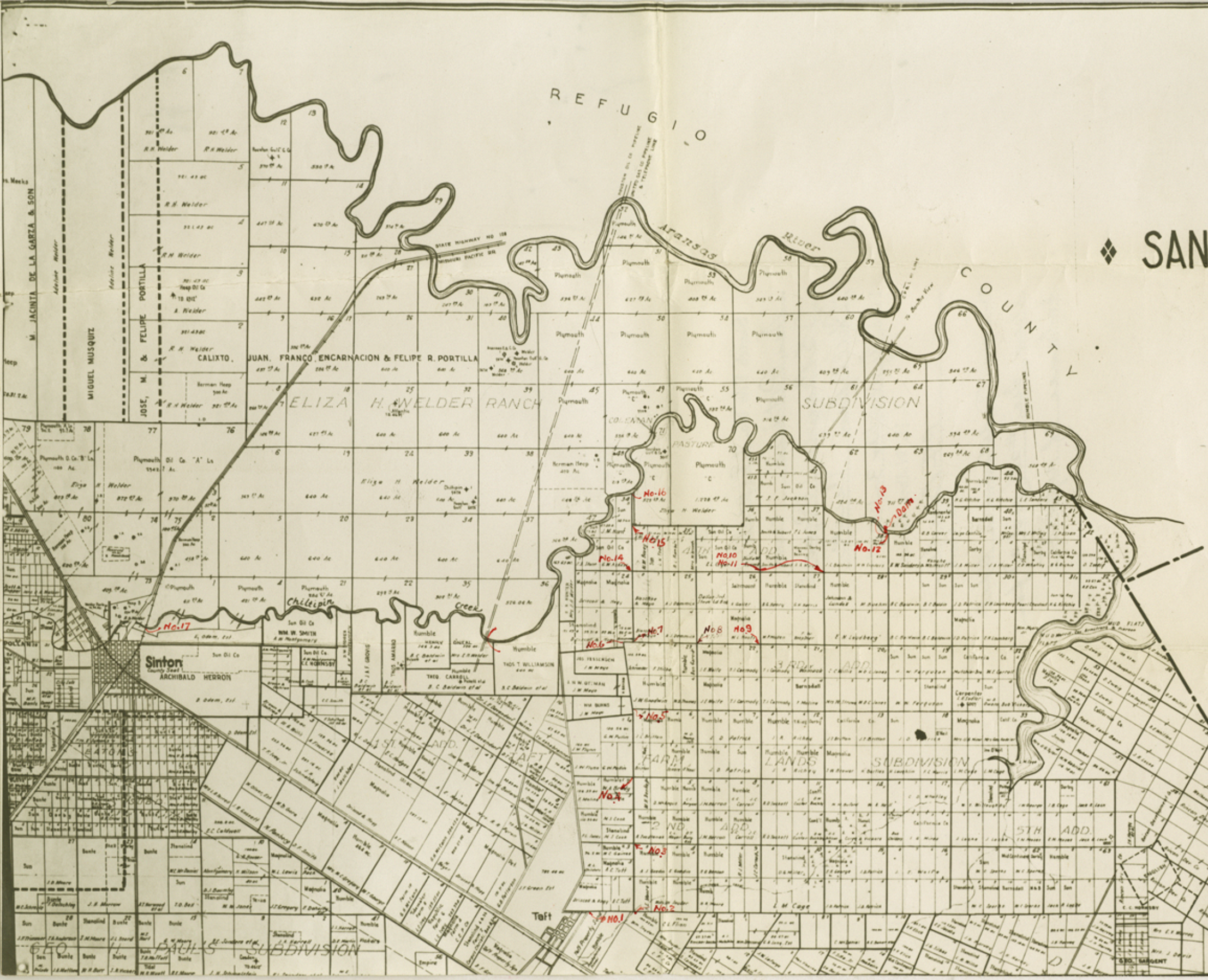

OWNERSHIP MAP
 ❖ SAN PATRICIO COUNTY ❖
 ❖ TEXAS ❖

SCALE 1 INCH = 400 FEET

Published & for sale
PORTER REGENOLD
 MAPPING AND DRAFTING
 509 SCHATZEL ST. PHONE 2432
 CORPUS CHRISTI, TEXAS

REGISTERED NO.
 COPYRIGHT 1934 BY PORTER REGENOLD
 Prices: Paper \$10.00
 Linen \$12.00



*Not-ect.
 Location B.M.S
 Don Lee
 8/31/35*

counter 36093

da

30
20
10
28
50
40
30

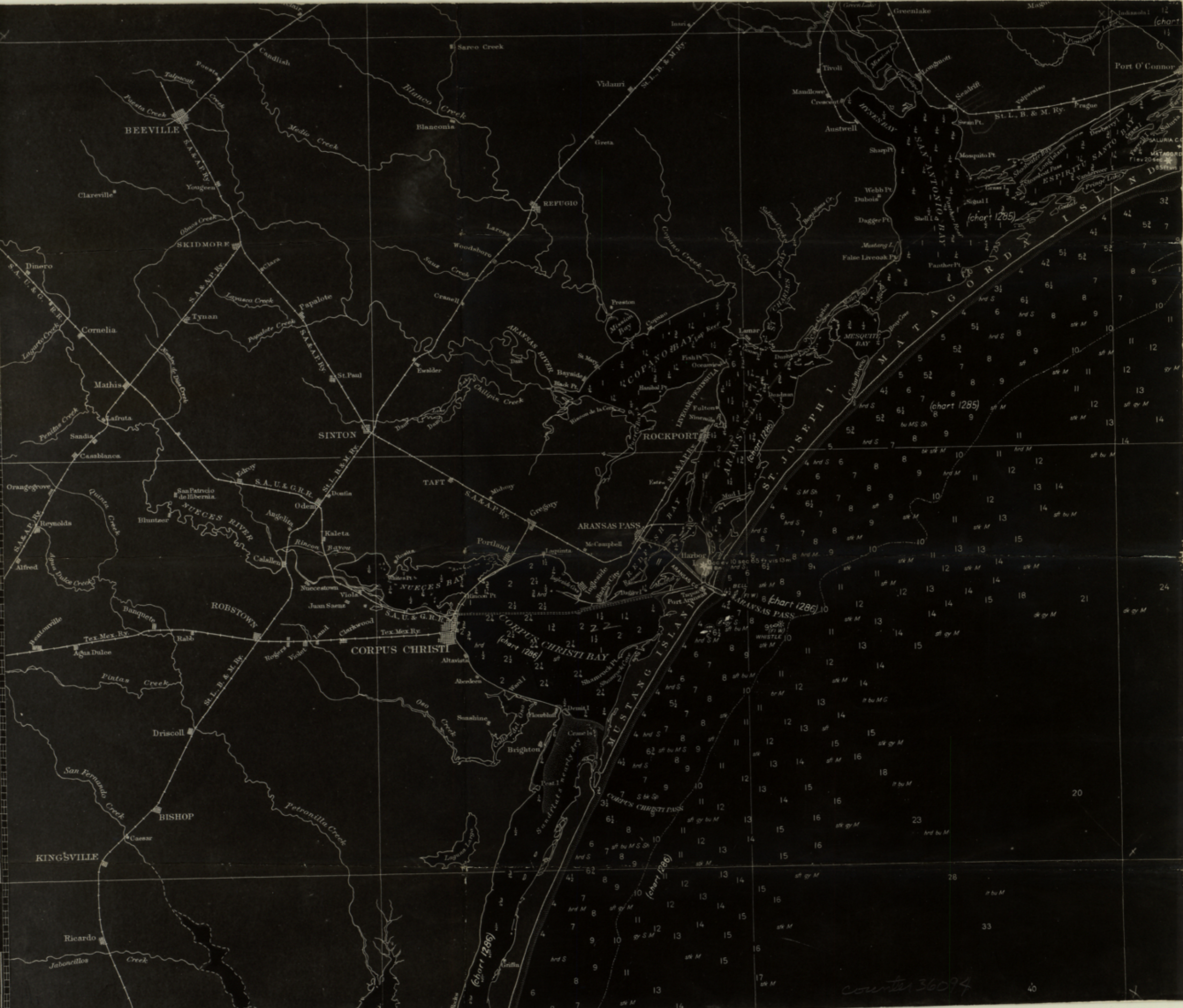

counter 36094

GUARANTEED FACSIMILE
AUG 24 1935
SOUTHERN
BLUE PRINT & SUPPLY CO
HOUSTON TEXAS

9/3/35
J. Bayles

①
Part of San Patricio
County Ak. File # 28
J. Bayles' Report on
Chittipin Creek

M¹_T



FIG. 16.—PARTS OF LINES XIV AND XVII.

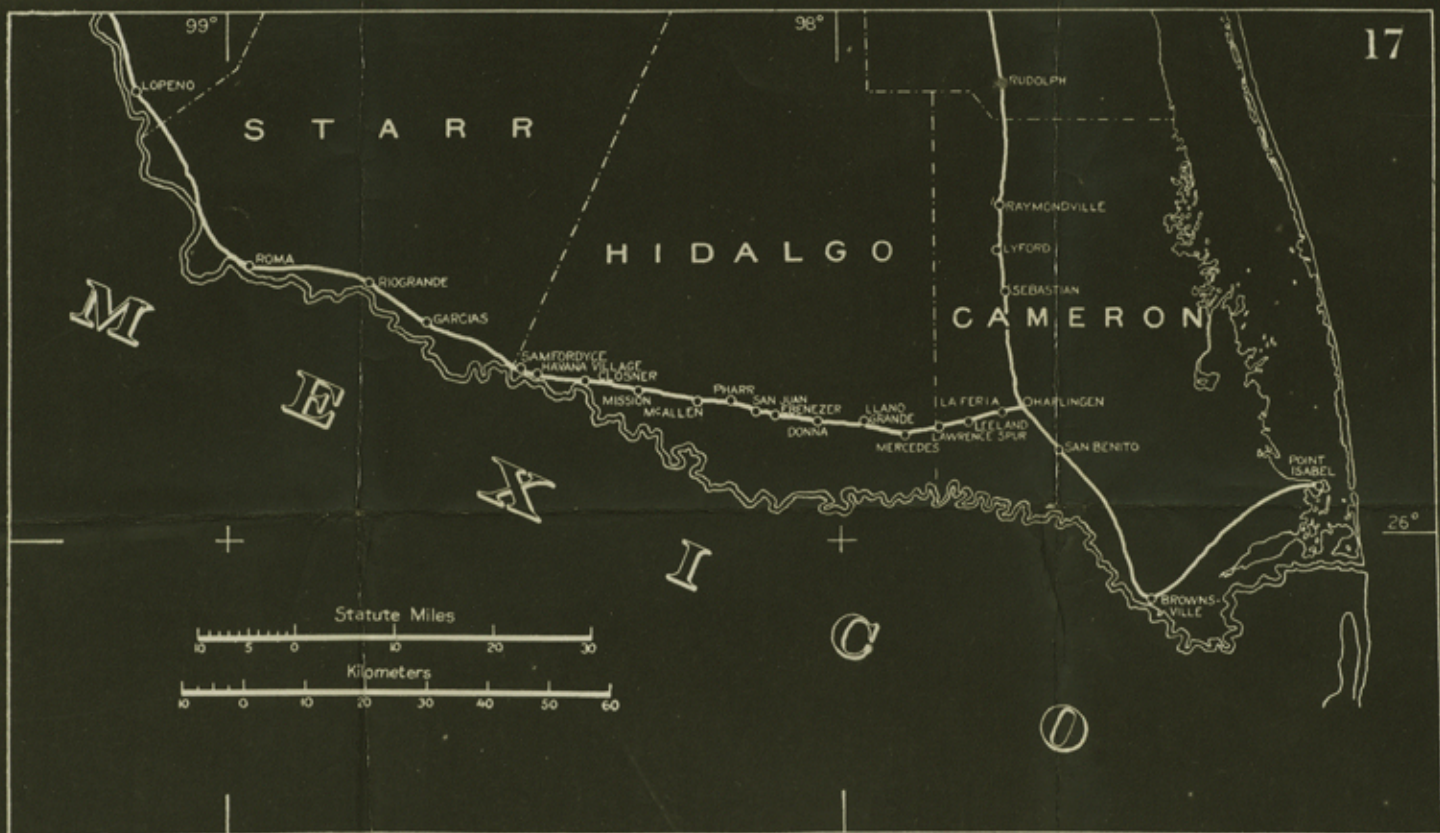

FIG. 17.—PARTS OF LINES XIV AND XVII.

counter 36096

(2)
Part of San Patricio
County Sk. File #28

J. S. Boyles' Report on
Chultipin Creek

Boyles
8/31/35

GUARANTEED FAC-SIMILE

AUG 24 1935

SOUTHERN
BLUE PRINT & SUPPLY CO.
HOUSTON, TEXAS

counter 36097

San Patricio 28

Sundry Sketches, reports, explanations, pictures etc., of J S Boyles, in locality of Chiltipin Creek.

Parts 1 & 2.

Sundry filing dates-

- ① PHOTOSTAT COPY PART U.S. COAST AND GEOD^E SURVEY AROUND SINTON.
- ② PHOTOSTAT COPY. PAGE 16^{AND} 17 U.S. COAST AND GEOD. SURVEY PRECISE LEVELING IN TEXAS. VICTORIA TO CAMERON AND STARR Co.
- ③ U.S. COAST & GEODIETIC SUR. SERIAL # 177 DESCRIPTION OF B. Ms
- ④ PHOTOS (10) SHOWING DAMS ETC. ON CHILTPIN CREEK.
- ⑤ PART 1. U.S. BOYLES REPORT. CHILTPIN CREEK.
- ⑥ PART 2. -DO- -DO-

Serial No. 177

DEPARTMENT OF COMMERCE
U.S. COAST & GEODETIC SURVEY
E. Lester Jones, Director

PRECISE LEVELING IN TEXAS

By
H. G. Avers, Mathematician

Special Publication No. 77

Map of parts of Lines XLV and XVI Fig. 16, Page 20

Page 101. Line XVI, Sinton, Tex., to New Orleans, La.

- This is the Texas portion of a line which follows the St. Louis, Brownsville & Mexico Railway from Sinton to Houston, Tex., and the Southern Pacific Railroad from Houston, Tex., to New Orleans, La. Spur lines were run from Placedo Junction to Port Lavaca, Tex., over the Galveston, Harrisburg & San Antonio Railway, from Bay City to Matagorda, Tex., over the Gulf, Colorado & Santa Fe Railway; from Angleton to Freeport, Tex., over the Houston & Brazos Valley Railway, and from Beaumont to Sabine, Tex., over the Texas & New Orleans Railroad. The field work was done by Max Steinberg, hydrographic and geodetic engineer, and C. M. Durgin, extra observer, between January 19 and September 9, 1918.

For additional bench marks at Sinton, see page 91.

R39 - About 2.9 miles north of Sinton, San Patricio County, 2 meters (7 feet) southwest of milepost 165 of the St. Louis, Brownsville & Mexico Railway and 15 meters (49 feet) northwest of the track. A concrete post with disk in top (17.676 meters or 57.992 feet.)

S39 - At Ewelder, San Patricio County, 50 meters (164 feet) southeast of milepost 169 of the St. Louis, Brownsville & Mexico Railway and 22 meters (72 feet) south of the track. A concrete post with disk in top. (15.131 meters or 49.642 feet.)

T39 - About 1 mile north of Ewelder, in Refugio County, on the top surface of the north abutment (concrete) of the bridge of the St. Louis, Brownsville & Mexico Railway over the Aransas River. A brass disk. (10.460 meters or 34.318 feet.)

U39 - At Cranell, Refugio County, 40 meters (131 feet) northwest of the tracks at station board "Cranell" of the St. Louis, Brownsville & Mexico Railway and 10 meters (33 feet) southeast of highway. A concrete post with disk in top (14.103 meters or 46.270 feet.)

V39 - About 1.5 miles north of Cranell, Refugio County, 50 meters (164 feet) northeast of milepost 175 of the St. Louis, Brownsville & Mexico Railway and 10 meters (33 feet) southeast of the track, 6 telegraph poles north of trestle 174.8. A concrete post with disk in top. (13.682 meters or 44.888 feet.)

W39 - About 2.8 miles southwest of Woodsboro, Refugio County, 15 meters (49) feet north of a county road crossing and 10 meters (33 feet) northwest of the St. Louis, Brownsville & Mexico Railway track. A concrete post with disk in top. (11.807 meters or 38.737 feet.)

X39 - At Woodsboro, Refugio County, in the southeast corner of the brick wall of the building owned by Baumgartner, 4 feet above ground. A brass disk (15.721 meters or 51.578 feet.)

*2 pages + 3 prints to accompany
J. S. Boyles' Report on Chittipin
Creek, San Patricio County.*

J. B.

counter 136099

R

②
List of Ben Shelton
1885

Y39 - At Woodsboro, Refugio County, in the firm sidewalk, 1 foot north of the end, 6 inches east of the front window of the Rooke and Swift building. A brass disk. (14.007 meters or 45.955 feet.)

Z39 - At La Rosa, Refugio County, 60 meters (197 feet) northeast of the station of the St. Louis, Brownsville & Mexico Railway and 10 meters (33 feet) east of the track. A concrete post with disk in top. (13.009 meters or 42.680 feet.)

A40- About 1.2 miles north of La Rosa, Refugio County, 1.4 miles south of the bridge of the St. Louis, Brownsville & Mexico Railway over the Mission River, on a concrete culvert 3 meters west of the track. A brass disk. (12.976 meters or 42.572 feet.)

B40 - About 1 miles south of Refugio, Refugio County, on the south abutment, on the west side of the bridge of the St. Louis, Brownsville & Mexico Railway over the Mission River. A brass disk. (12.222 meters or 40.098 feet.)

C40 - At Refugio, Refugio County, on the east side of the southeast entrance of the Refugio public school, 4 feet above ground. A brass disk. (16.833 meters or 55.226 feet.)

D40 - At Refugio, Refugio County, in the southeast corner of the brick wall of the Ben Shelton Building, 4 feet above the ground. A brass disk. (17.467 meters or 57.306 feet.)

E40 - At Refugio, Refugio County on the north side of the east entrance in the Refugio County Courthouse, 4 feet above the ground. A brass disk. (17.584 meters or 57.690 feet.)

Ben Shelton

R

OFFICE OF
J. STUART BOYLES
COUNTY SURVEYOR
HARRIS COUNTY
TEXAS

GENERAL ENGINEERING
SURVEYING
ROAD WORK
DRAINAGE
DRAFTING
CONSTRUCTING

PHONES:
OFFICE, PRESTON 1861
RESIDENCE, HADLEY 8820

NOBLE E. WICKLUND
DEPUTY

3004

HOUSTON, TEXAS

August 30th, 1935

Hon. J. H. Walker, Comm'r.,
General Land Office
Austin, Texas

San Patricio Co

Dear Sir and Friend:

Unquestionably the water in Chiltipin Creek from the dam to the mouth of the same is tide water. The levels show that the bottom of the creek at the Northwest corner of the Catherine Dougan Survey is minus 3.5 ft. below zero or substantially 4 ft. below ordinary high tide as determined from the U. S. Coast and Geodetic survey bench marks. Tide water would extend between 2 and 3 miles further West of the Northwest corner of the Dougan if this dam had not been constructed. Of course you understand that the dam itself prevents tide water extending further West that the location at which it is constructed. If the dam had not been constructed, tide water would have extended to North and beyond the present producing area of the Welder field.

X

Detailed report will be forwarded you just as soon as I can possibly assemble the facts for presentation.

With kindest personal regards, I am

Yours very truly,

J. S. Boyles

JSB:mc

RECEIVED

AUG 31 1935

REFERRED TO MINERAL

6

counter 36102

Hon. J. H. Walker

Page 2

8/31/35

The nearest U.S.C. & G. survey bench mark to the dam constructed across Chiltipin Creek is located at Taft, Texas in the parked area of the depot grounds immediately West of the depot of the S.A. & A.P. RR. It is a six inch round concrete monument with a bronze cap marked "U.S. Geological Survey in Cooperation with State of Texas Prim. Tra. S.G.A. No.2 Elevation above sea 51 Ft. F-5." The actual corrected elevation of this bench mark as obtained from the Dept. of Commerce Washington, D.C. is 51.42 ft.

In making the survey I used this bench mark and ran a line of levels, establishing temporary bench marks at convenient points, first to the dam site across Chiltipin Creek located immediately North of the Northeast corner of Section 38 of the Taft Farm Lands Subdivision. Secondly, from the same bench, I ran a line of levels to the Northwest corner of the Catherine Dagan Survey which said corner is near the center of the Welder oil field. I then went to U.S.C. & G. Survey B.M. No. R-39 located about 2.9 North of Sinton, San Patricio County 7 ft. Southwest of mile post 165 of the St. Louis, Brownsville & Mexico Railway, (now the Missouri Pacific) and 49 ft. Northwest of the track, a square concrete monument with a bronze disk in top. The correct elevation of this bench mark as obtained from the Dept. of Commerce is 57.992 ft. From this last bench I ran a line of levels to the intersection of the railroad with Chiltipin Creek.

The dam across the creek has evidently been built or rebuilt several times across the original channel. On the East side there is a line of 6x4 and 8x4 planks driven into the ground. The elevation of the top of this row of planks is 2.06. Back of this row of planks there is a concrete apron extending to a concrete dam with stone abutments on the North and South ends. The elevation of the top of the concrete dam is 4.67. On top and covering the concrete dam is an earth fill, the top of which is 10.95 ft. in elevation. On the West side of the dam levees have been constructed along the channel for some distance back, evidently to make a water hole. The plank dam is 125 ft. long. The concrete dam between abutments is 147 ft. long. The earth dam is 760 ft. long. At the South end of the earth dam high water has evidently washed out the same leaving a new channel 100 ft. wide from top of bank to top of bank.

The elevation of the top of the water in front of the dam at 5:45 P.M. 8-28-35 was 1.12 ft. The bottom of the creek in front of the dam was minus 1.0 ft. Considerable silt and sand has unquestionably been washed against the face of this dam. The surface of the water in the washed out section of the dam at its South end is minus 1.46 ft. The washed out area does not at this date connect up with the old channel of the creek East of the dam. There is a considerable area of filled up white sand which prevents this junction.

OFFICE OF
J. STUART BOYLES
 COUNTY SURVEYOR
 HARRIS COUNTY
 TEXAS

GENERAL ENGINEERING
 SURVEYING
 ROAD WORK
 DRAINAGE
 DRAFTING
 CONSTRUCTING

PHONES:
 OFFICE, PRESTON 1861
 RESIDENCE, HADLEY 8820

NOBLE E. WICKLUND
 DEPUTY

3011

HOUSTON, TEXAS

August 31st, 1935

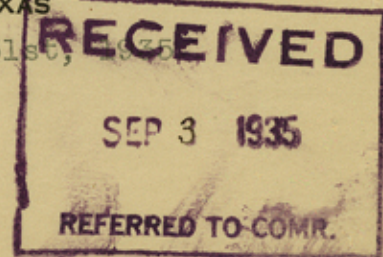

Hon. J. H. Walker, Comm'r.,
 General Land Office
 Austin, Texas

Dear Sir and Friend:

In compliance with your letter of August 22nd, 1935 relative to a survey of Chiltipin Creek in San Patricio County, Texas.

First of all it was necessary to determine the difference in elevations for zero sea level as between the United States Coast and Geological Survey and the United States Engineering Department zero. The necessity of this being, that the geological survey datum is consistent throughout the United States from the Pacific to the Atlantic and the Engineering Department datum is different in different localities, and is more or less an assumed elevation. I was fortunate in finding a bench mark on the City National Bank Building in Corpus Christi, Texas which was established by the U.S.E.D. as having an elevation of 10.55 and checked on August 21st, 1931 by the U.S.C. & G. as having an actual elevation of 9.72, thus giving a difference of 0.83 ft. in the two datums nearest the mouth of Chiltipin Creek and showing the U.S.E.D. datum to be 0.83 ft. lower than the correct datum. Mr. C. A. Ridenour, Ass't. Engineer and in charge of the Corpus Christi and Aransas Pass area very kindly assisted me in obtaining this data and also was kind enough to turn over their daily tide readings at Port Aransas.

The Port Aransas tide gauge began recording on February 11th, 1932 and has been logged up to October 5th, 1934. The recording sheets from October 5th, 1934 to date had not been transferred to usable form, although the same are available. It would take some week or ten days to check and read the charts into usable form and time being an essence of this report, the data between the last named dates was not used.

The period of observation available covered 961 actual daily readings giving a total of 1345.2 elevations above zero (U.S.E.D. datum) which in turn gives an ordinary high tide range of 1.3998 ft. (U.S.E.D. datum). As the U.S.C. & G. is 0.83 ft. above U.S.E.D. we have an ordinary high tide of 1.4 ft. U.S.E.D. or 0.6 ft. U.S.C. & G.

counter 36105

[Handwritten initials]

Back of and West of the dam the elevation of the bottom of the creek is 2.65 ft. This area for some four or five hundred feet to the West has unquestionably been filled up with silt deposited by the creek as on this date the old bed of the creek is dry for about the distance West of the dam as stated. From this last named point Chiltipin Creek is within well defined banks carrying from six to four feet of water.

At the Northwest corner of the Catherine Dougan the water level in Chiltipin Creek was 2.034 ft. at 11:20 A.M. 8-29-35. The bottom of the creek at this point is minus 3.50 ft. showing conclusively that if the dam had not been erected this area would be effected by the ebb and flow of the tide.

I was informed by Mr. Winfrey, County Surveyor of San Patricio County, that there was considerable water at the Missouri Pacific crossing of the said creek, therefore, in order to see if tide water extended to this point I went to bench mark R-39, above referred to, and ran a line of levels to the creek where I found the bottom of the same to be at an elevation of 20.397 ft. and the creek itself only a very small drainage ditch carrying about 2 inches of water and about 3 ft. wide. In fact, the total flow at the M.P. bridge is the discharge water from the Sinton sewer system. Incidentally, while it is no part of this report, the State Board of Sanitation should take steps to rectify the discharge of this sewer water into the creek without being either aerified or purified in some manner.

As previously stated, time being the essence of this report I did not have an opportunity to carry levels up the creek further than the Northwest corner of the said Dougan Survey, however, I walked up the creek for about two and a half miles and would state positively that the tide water, the dam not having been constructed, would extend to at least this distance West of the Dougan Northwest corner. Certainly, far enough to effect all of the creek bed within the limits of the present producing oil field.

Between the high banks of the creek at the dam and for considerable distance West, in my opinion was at one time in recent years tidal flats. There being, I should judge, more than a mile between the said high banks. The field notes of the surveys to the North and South would no doubt reflect the fact that the corners of the same were established on these high banks and not on the actual creek banks. This matter, I believe, should be investigated by your department for the benefit of the State. An examination of the date of the surveys in this area and along the creek show that the boundary lines of the same would be governed by ordinary high tide determination and not the high storm tides in winter as divided under the Spanish Civil Code and effecting titles prior to 1841.

3

counter 36106

J. H. Walker 3

I took a number of pictures of the dam in question. These having been properly labeled, are attached to and made a part of this report. I am also attaching photostatic copy of a part of the United States Chart covering this area, a photostatic copy of page 20 U. S. Coast & Geodetic Survey, serial No. 177, Special Publication No. 77. Copy of the bench marks nearest to this work as obtained from the same Special Publication No. 77. Photostatic copy of a part of San Patricio County showing the Welder Ranch Subdivision and the Taft Farm Lands Subdivision. This last map is attached for the purpose of identifying in your records the location of the bench marks I have established in this work and in order to save your department time in case future work is necessary.

I would suggest that additional survey be made to determine the exact Western termination of the tide water effect in Chiltipin Creek. Also, the definite tying in of this point to some survey or other permanent corner.

TEMPORARY BENCH MARKS ESTABLISHED AUGUST, 1935

- No. 1 Top of the rim on the West nipple of the first fire hydrant East of the last or most Eastern street in the town of Taft and on the South side of the Rincon Ranch Road. Elevation 50.616.
- No. 2 Three sixty penny galvanized nails in the Southeast telephone post on the South side of Rincon Ranch Road and the East side of a graded road to the North. At the Southeast corner Section 3, Southwest corner Section 4, Taft Farm Subdivision. Elevation 41.353.
- No. 3 Top of a 4x4 concrete monument on the South and on the East sides of roads the Northwest corner Section 3, also the Southwest corner Section 5, Northeast corner Section 3, Southeast corner Section 2, Taft Farm Subdivision. Elevation 48.298.
- No. 4 Three sixty penny galvanized nails in the Northeast corner post of a fence on the South and West sides of roads, the Northeast corner of Section 2, also the Southeast corner Section 1, Northwest corner Section 5, Southwest corner Section 6. Elevation 46.498.
- No. 5 Three sixty penny nails in the East side of telephone pole where the telephone lines run South and East, at the Southwest corner Section 23, Northwest corner Section 6, Taft Farm Subdivision. Elevation 42.773.

14

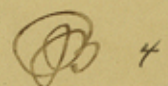
 4

- No. 6 Three sixty penny nails in the East side of telephone pole the most Northern and most Western pole at the Northwest corner of a road where the road turns to the East. The Northwest corner of Section 23, and a reentrant corner of Section 24. Taft Farm Subdivision. Elevation 42.39.
- No. 7 Three sixty penny nails in the North side of telephone pole on the North and East sides of roads, the Southwest corner of Section 25, Southeast corner of Section 24. Taft Farm Subdivision. Elevation 42.119.
- No. 8 Three sixty penny nails in the South side of the last telephone pole on the East and North sides of roads, the Southwest corner of Section 26, the Northwest corner of Section 22, the Northeast corner of Section 23, the Southeast corner of Section 25. Taft Farm Subdivision. Elevation 40.665.
- No. 9 Three sixty penny galvanized nails in the South side of a high line pole on the North and West sides of roads at the Southeast corner of Section 26, Northeast corner of Section 22, Southwest corner of Section 27, Northwest corner of Section 21. Taft Farm Subdivision. Elevation 34.631.
- No.10 Three sixty penny galvanized nails in the Southeast side of Central Light & Power Co. pole No. 22-1 at Southeast corner of Section 37, Southwest corner of Section 38, Northeast corner of Section 27, Northwest corner of Section 28. Taft Farm Subdivision. Elevation 31.255.
- No.11 Top of a 4x4 concrete monument Southeast corner Section 37, and located about 4 and 1/2 ft. Southeast of the pole described in No.10, Elevation 30.113.
- No.12 Top of a 4x4 concrete monument in a fence line and on the South side of Chiltipin Creek, the Northeast corner of Section 38 Taft Farm Subdivision. Elevation 6.576.
- No.13 The Northeast corner of the South abutment of dam across Chiltipin Creek almost due Northwest of the Northeast corner of Section 38 above. (Bench mark is on top of the second course of stone as the first course has been broken off at this point) Elevation 6.898.
- No.14 Top of a 1 1/2 inch round bar flush with the ground on the North and West sides of roads, the Southeast corner of Section 34, Northeast corner of Section 24, Northwest corner of Section 25, Southwest corner of Section 35, Taft Farm Subdivision. Elevation 39.621.

Hon. J. H. Walker,
Page 6
8/31/35

- No.15 Top of 4x4 concrete monument at Southwest corner of a fence on the East side of a road, the Southwest corner of the Catherine Dougan Survey, the Northwest corner of Section 35, Taft Farm Subdivision. Lead cap in top marked Welder R.O. R. 1935. Elevation 40.886.
- No.16 Concrete monument 4x4 in fence on the East side of road on the first bank of Chiltipin Creek about 60 ft. South of the water, monument marked H.A.S. over A.P.T. on the West side. This is at or about the Northwest corner of the Catherine Dougan Survey. Elevation 17.026.
- No.17 Top of the most Eastern bolt on the East end of the South sill on the Missouri Pacific Railroad Bridge across Chiltipin Creek. Elevation 46.042.

Respectfully yours,

Boyles

Licensed State Land Surveyor

Received and filed in General Land Office
on September 3rd, 1935.

JSB:mc
Enclosures

J.H. Walker, Commissioner
C.F. Blucher, clk

17

8/27/32
Page 2
Hon. J. H. Walker,

No. 12 Top of 4x4 concrete monument at southwest corner of a fence on the West side of a road, the Northwest corner of the centerline posted survey, the Northwest corner of Section 32, T4N R10E S14W. Elevation 40.686.

No. 13 Concrete monument at fence on the East side of road on the first bank of Chulupin Creek about 60 ft. from the West side. This is at or about the Northwest corner of the centerline posted survey. Elevation 18.026.

No. 14 All on the Missouri Pacific Railroad bridge across Chulupin Creek. Elevation 18.026.

Sketch File No. 28 (part 2) ⑥

San Patricio County

J. S. Byrnes' Report
Chulupin Creek

Filed September 3rd 1932

J. H. Walker, Comm.

C. F. Blucha
File Clerk

Descriptive: To determine tidal area. See #28 (part 1) for balance of report.

10 Kodak pictures accompany this report.

Respectfully yours,
J. S. Byrnes
Accused State Land Surveyor

San Patricio Co. Sk. File # 28