

Arkansas County



Handwritten notes and signatures on a separate piece of paper, including the name 'Sketch' and a date '20 P.M. 1866'.

San Patricio & Ft. 8031

Var. N. 9° 5'
2000 vrs. to the inc.

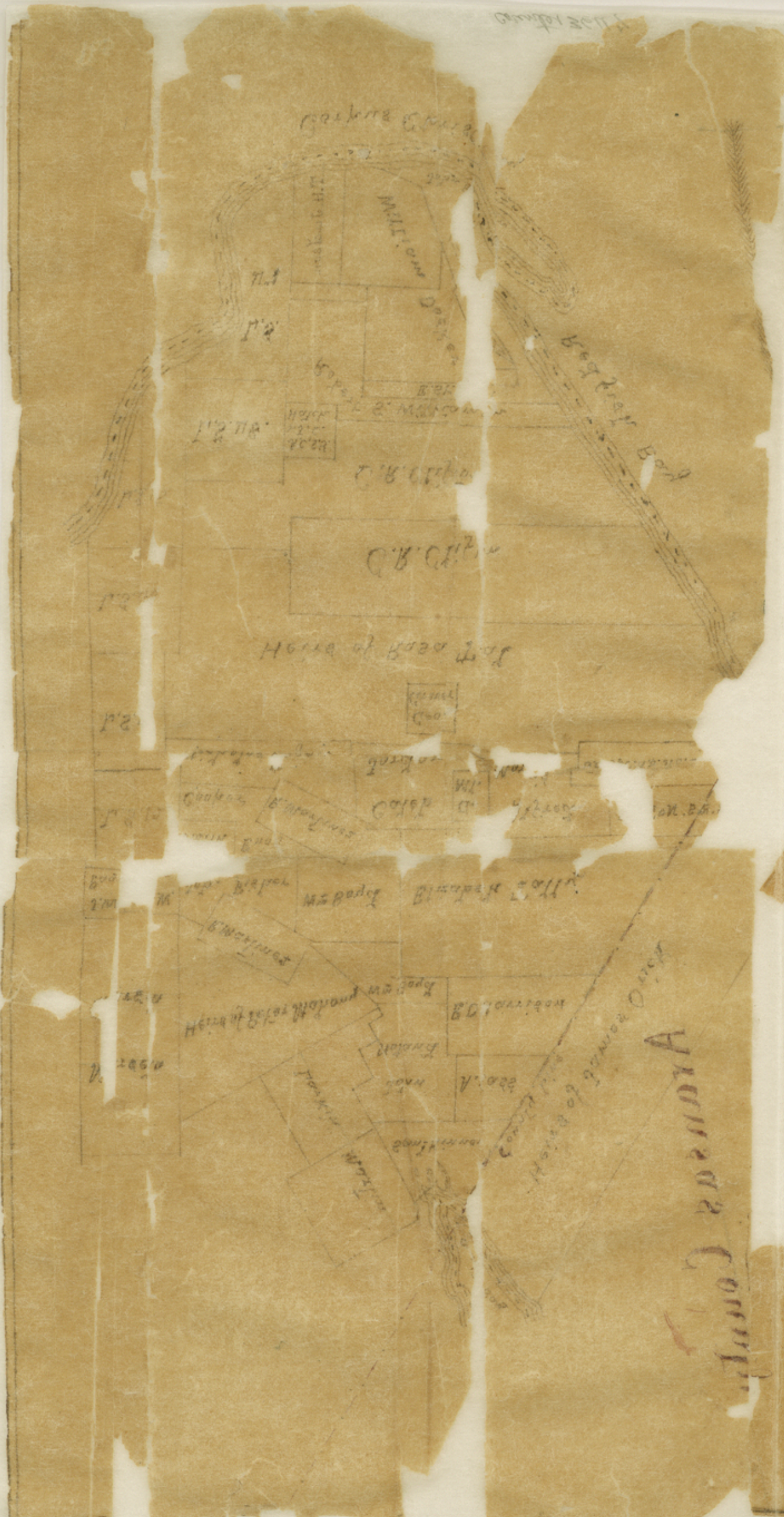

[Faint, mostly illegible handwritten notes on a vertical strip of paper.]

[Faint, mostly illegible handwritten notes on a vertical strip of paper.]

Armeda Company

counter 136118