

$$\begin{array}{r} 4468 \\ 5080116 \\ 1069726 \\ \hline 5645 \overline{) 10149842} \\ \underline{3074921} \quad 544 \frac{4}{10} \\ 28225 \\ \hline 25242 \\ 22580 \\ \hline 26621 \\ 22580 \\ \hline 40410 \end{array}$$

$$\begin{array}{r} 26453 \\ 26453 \\ 7658 \\ \hline 3779 \\ 4825783 \\ \hline 868224 \\ 5694007 \\ 1.169.532 \\ \hline 4.524475 \end{array}$$

$$\begin{array}{r} 8064 \\ 5376 \\ 8064 \\ \hline 868224 \\ 1666 \\ 702 \\ 3332 \\ \hline 1166230 \\ 1169.532 \end{array}$$

$$\begin{array}{r} 132 \\ 739 \\ 3164 \\ 2406 \\ 1694 \\ \hline 8135 \\ 7604 \\ \hline 531 \end{array}$$

$$\begin{array}{r} 1180 \\ 616 \\ \hline 1796 \end{array}$$

$$\begin{array}{r} 1936 \\ 812 \\ \hline 2748 \end{array}$$

$$\begin{array}{r} 7604 \\ 762 \\ 8306 \\ 8135 \\ \hline 171 \end{array}$$

N.	F.	E.	W.
—	—	1900	—
—	314	—	3800
—	—	1000	4800
—	827	—	5800
—	—	—	2900
—	—	—	2900
1141	—	—	0.

$$\begin{array}{r} 3800 \\ 314 \\ \hline 152 \\ 38 \\ \hline 114 \\ 1183200 \\ 4796600 \\ \hline 3777800 \\ 2989900 / 53 \\ 28225 \\ \hline 16740 \\ 16935 \end{array}$$



$$\begin{array}{r} 1945 \\ 616 \\ \hline 1329 \\ 1182 \\ \hline 167 \end{array}$$

5645

1.857.205 / 3

$$\begin{array}{r} 4468 \\ 1137 \\ \hline 31276 \\ 13404 \\ \hline 448 \end{array}$$

$$\begin{array}{r} 1402 \\ 762 \\ \hline 4206 \\ 8412 \\ 9814 \\ \hline 2726 \end{array}$$

$$\begin{array}{r} 323 \\ \hline 1600 \quad 1600 \quad 2946 \quad 2946 \end{array}$$

caente 136430

$$\begin{array}{r} 3779 \\ 2688 \\ 323 \\ \hline 5892 \end{array}$$

No 8.

San Gabu County.

Surveyors SK. of surveys around
GM & D. Surs. 1, 2, 3, 4, 5 & 6.

227

229

3-3547
3-2240
3-2552
3-3538

See S. 32481 for sketch
See S-36528 for sketch

[Signature]
counter 36431

N

S

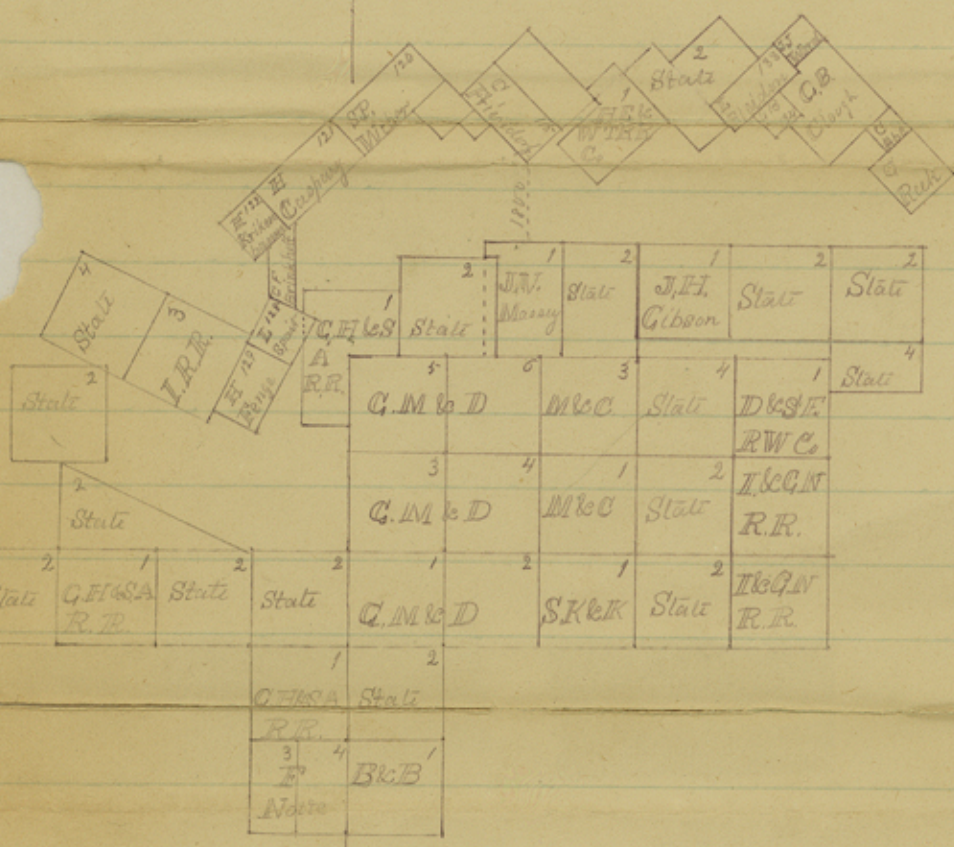

C. Harry Saw 24.6
In letter of W. L. Hayes
of date June 11/61