

Starr County

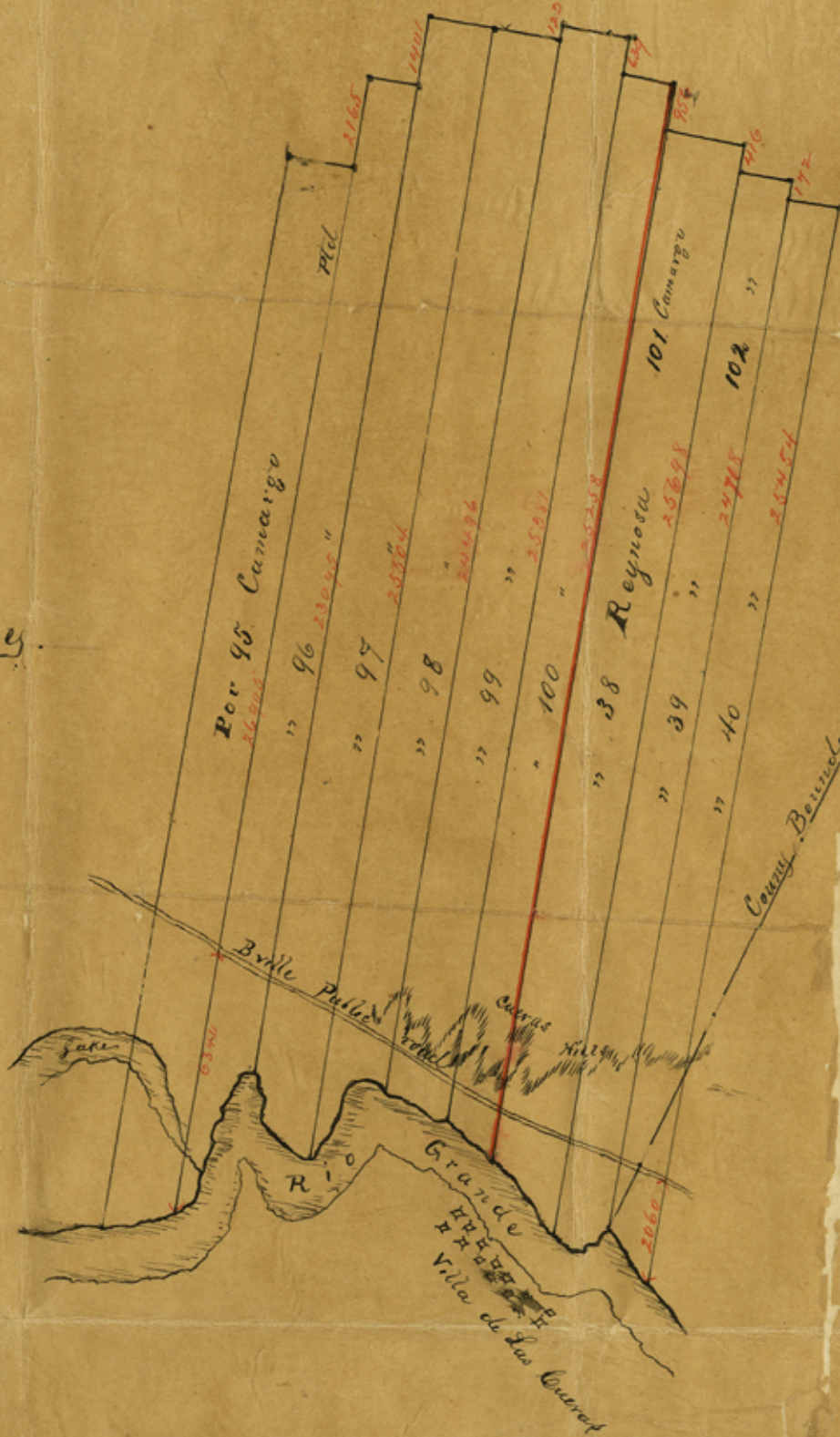

Hidalgo County

The State of Texas
{
District Starr County}

I J. C. Ewert Dist
Surveyor for Starr County do hereby
certify that the annexed Sketch of
Porciones 9.5 to 100 inclusive Camargo
and 38 to 40 inclusive Reynosa
is compiled from Surveys actually
made upon the ground ^{by me} and that
said Plan truly represents the actual
position of said porciones

In testimony whereof
I hereunto set my hand at office
on this 20th day of January AD 1880

J. C. Ewert
Dist Surveyor
Starr Co. Tex.

File: 8.

Starr County.

Filed February 10th 80.

counter 36860

T