

SCORRE NOTES

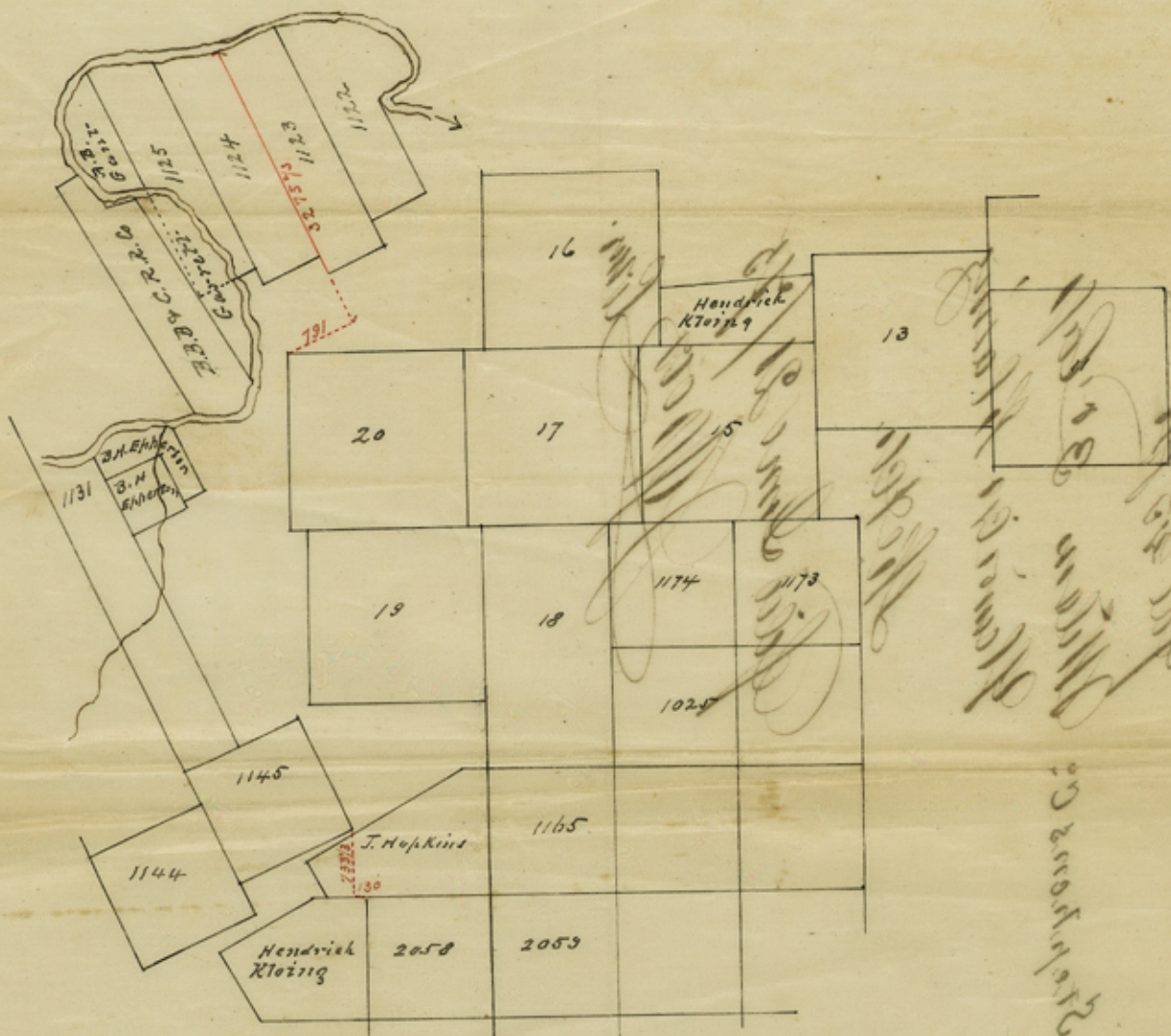

The red lines are distances actually measured on the ground, from old corners found & established from original field notes.

W.C. Pomeroy  
 Deputy Sur. P.O. Dist

count 137021

File 6

Stephens 6.

file 4371

Stephens Co

Wilson 30' lot  
Glenoid Blasing  
Sketch

file June 21/75  
J. P. Co. Ltd.

Handwritten notes on the left margin:  
The map shows the area with the  
divisions and the location of the  
mine. The mine is located in the  
southwest corner of the area.  
The mine is located in the  
southwest corner of the area.  
The mine is located in the  
southwest corner of the area.

150 Yds. distance



counter 37022