

1600 rods per in.

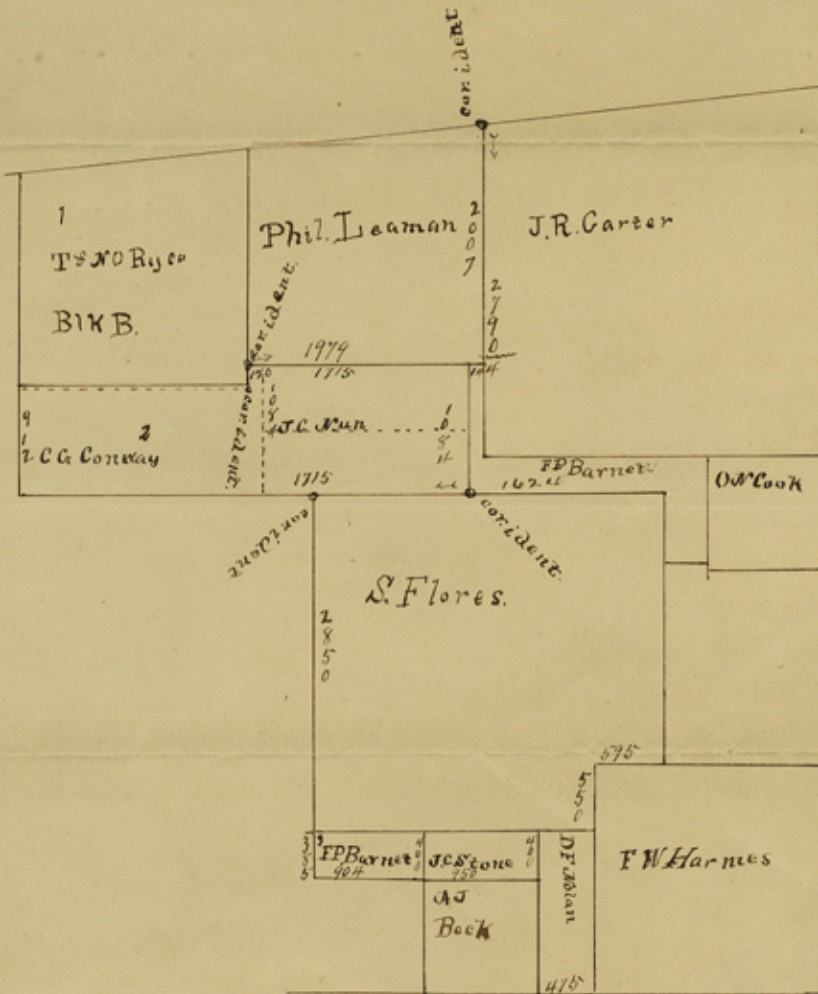

See F.W. Barnes letter filed Febr. 23/89.

THE STATE OF TEXAS,
COUNTY OF STEPHENS.

I, *F.W. Barnes* County Surveyor

of Stephens County, Texas, do hereby certify that the above is a true and correct plat of *Survey* shown therein situated in Stephens and Eastland Counties.

F.W. Barnes
Surveyor Stephens County Tex

File 13.
Sketch of TW Brown,
of
Stephens County
Surveys.

filed Febr. 23^d 1889.

R. W. Hussey

Chief Clerk.