

File 14.

Stephens Co.

SK of Surs, Surrounding
Ruthy Campbell
Also Brown's letter.

See connections
and explanatory
Plat no. 9 for
another sketch, &
letter file 263031
for Surveyor letter of
explanation accompanying
this plat
6/1/09. D. von Rosenberg
Draftsman

counter 37065

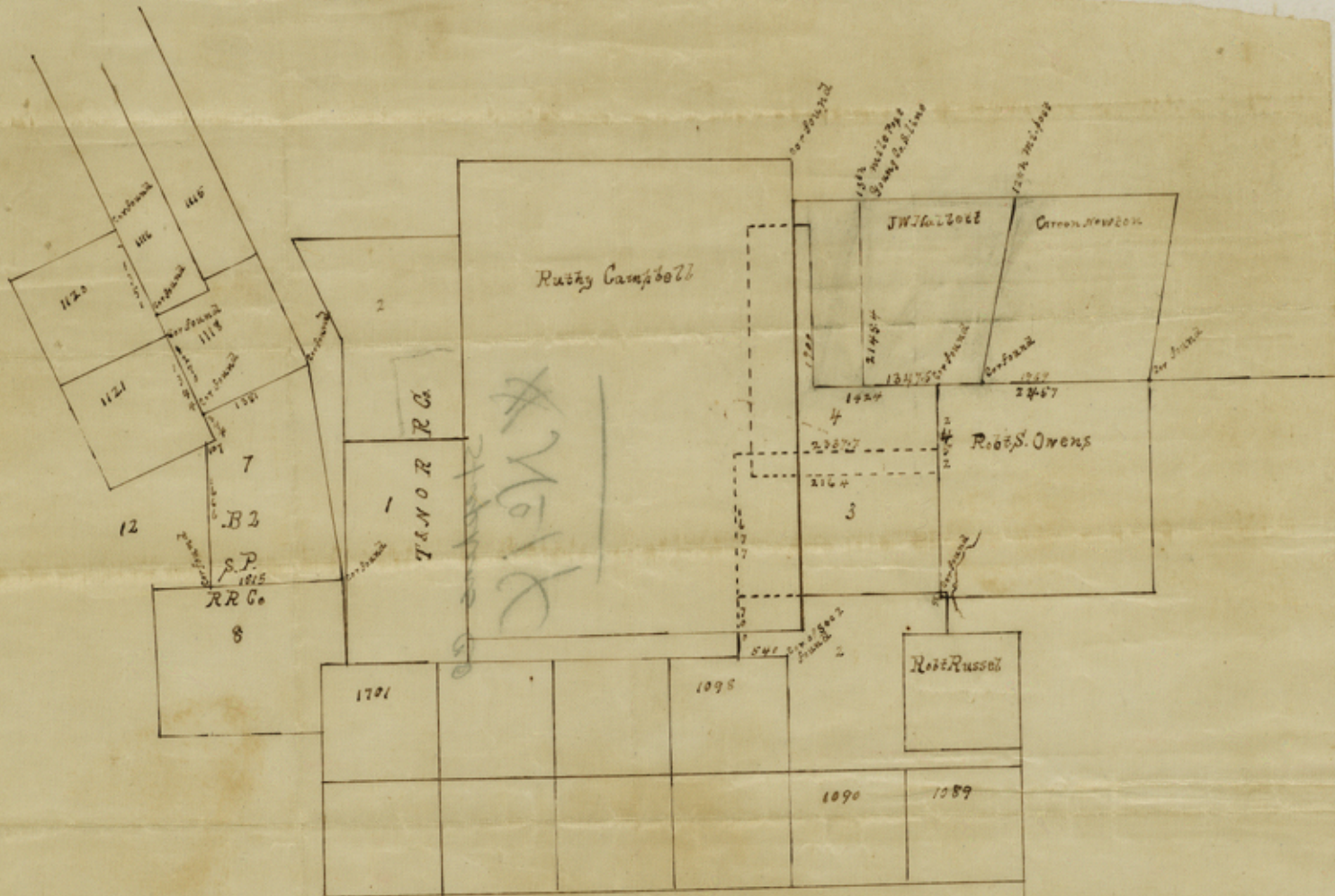

See letter file

(263031)

Sold Febr. 14/90. See Surveyor's
letter of date Febr. 12/90

J. O. Sherry
Chief Clerk.

counter 37066

(Letter Book #278 page 236)
March 5/1890

Mr. T. W. Brown
County Surveyor,

Brookewidge, Texas

Sir: Replying to yours of the 12th ult; I will state that Surveys Nos. 3 & 4 of S. P. Ry. Co. were corrected, No. 3, August 22, 1874 and No. 4 Aug. 25, 1874. Section No. 4 should be corrected to embrace the space between R. Campbell and J. W. Kallett, but the latter survey will hold the 1900 rods called for on its South line, and the West line should be made to run parallel to the East line. No. 3, being a patented survey, will be entitled to the full width of 1677 rods.

Respectfully
R. B. Shelley
S. Sec. Clk.
Acting Comor.

(c)