

7 Filed

Tarrant County

recd July 2^d 1858

North and East of
Fort Worth.

Chas. C. Lacy's SK. of SURS
North & East of Ft. Worth.
Dated June 15, 1858
Filed July 2, 1858.

counter 37684

Handwritten notes at the top left of the page, including "No. 14" and "No. 15".



I Chas. Lacy District Surveyor of D. Dist
do hereby certify that the foregoing is
a correct Sketch as delineated upon
the Map in this office

Given under my hand at Denton
this the 15th June 1856

Chas. Lacy Dis. Sur.
Denton Land District

For Hon. A. G. Walker

Counter 37685

Received July 2/58
C. W. Prosser

Handwritten notes at the top of the second page, including "File 7" and "649 Rpt. of."



Filed July 26th 58.
C. W. Prosser.

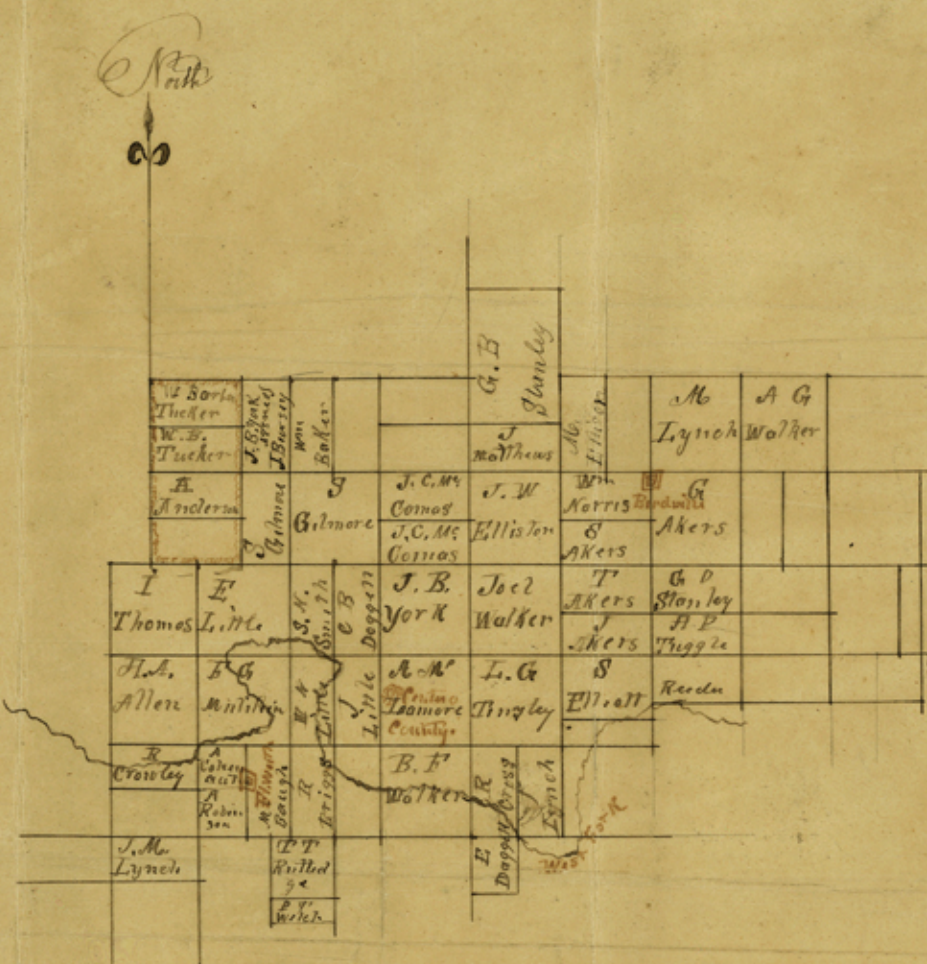

I, Cha. C. Lacy District Surveyor of Benton Land District do hereby certify that the foregoing map is a true sketch of the original Map of my office.

Given under my hand at Allen this the 18th day of December A. D. 1856 Cha. C. Lacy District Surveyor of Benton Land District