

68275

D. C.
Strickland

J. B. Little

J. H. King

B. Taylor

E. A. Wilson
W. B. Fisher

P. M. Smith

Jesse
Foster
I. B. Wilson
George

I W. S. Girty Coroner Court Surgeon
do hereby certify that the above sketch is a
true and correct representation of the
surveys in said sketch as appears both
from actual survey and from the Records
of my Office.

Given under my hand at Fort Worth
April the 10th 1860
W. S. Girty
Coroner Court Surgeon

counter 37712

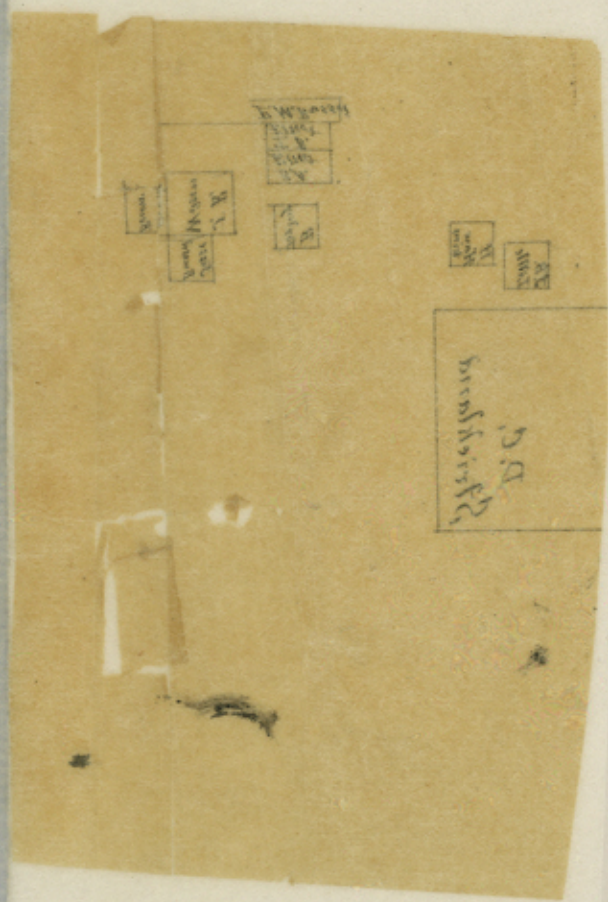

Filed April 27/60.
C.W. Pepler.

counter 37713

File 169

Tarrant County
plotted in Office Dec 18/60
25, Received April 27/60

S. E. corner.



counter 37715