

Ⓢ<sup>9</sup> sk Files  
No. - 2 - 3 -

Connecting line & sketch, fr  
Gaddes Springs to Meyers  
Springs.

Filed Aug. 21, 1882.

2 miles

counter 37879

State of Texas  
County of Pecos, } (1)

Variation 15° 45' East.

Connecting Line from the North West Corner of Survey N<sup>o</sup>. 1, in Block N<sup>o</sup>. 1, made by virtue of Certificate N<sup>o</sup>. 706 issued to The Texas Central Railway Company by the Commissioner of the General Land Office, to the mouth of Independence Creek and thence to Ladd's Spring and thence to Myers Spring.

Beginning at the North West Corner of said survey N<sup>o</sup>. 1 and the North East Corner of Survey N<sup>o</sup>. 9 in same block, said corner is a rock mound, built in a valley from whence a bush on a round top hill bears South 15° - East - thence South 45° - West 2688 varas to a stone mound, from whence a point of a mountain on the South Side of Independence Creek bears North 53° - East. Said rock mound is the South West Corner of Survey N<sup>o</sup>. 9 in said block N<sup>o</sup>. 1 made in name of the Texas Central Railway Company - thence North 45° - West 2688 varas to a mound, built on a rocky bluff above valley, the South East Corner of Survey N<sup>o</sup>. 6 University Block N<sup>o</sup>. 34, said corner is the North West Corner of Survey N<sup>o</sup>. 10 in said block N<sup>o</sup>. 1 L. C. Ry. Co. - thence North 1900 varas to a large mound of white rock

situated on a bluff West of Independence  
 Creek. Said rock mound is marked "Barlow"  
 "1879" Also is marked "Thomson" also "T.A.T.". Said  
 Corner is the North East Corner of Survey  
 No. 6 University Block No. 34 and the South  
 East Corner of Survey No. 5 in same block.  
 Thence North  $77\frac{1}{4}^{\circ}$  West 314 varas  
 to a point - Thence North  $19^{\circ}00'$  varas  
 to rock mound marked "D" on the West  
 Bank of Independence Creek - Thence  
 South  $32\frac{1}{2}^{\circ}$  East 292 varas to a rock mound  
 marked "B" on the East Bank of Inde-  
 pendence Creek. - Thence South  $53\frac{1}{4}^{\circ}$  East  
 1040 varas to a point - Thence South  $47^{\circ}$   
 East at 300 varas crossing Independence  
 Creek, 1200 varas to a large rock mound  
 the West Corner of Survey No. 319 made  
 by virtue of Land Scrip No. 11 issued Jan.  
 9<sup>th</sup> 1877 to the Lower Plains Agricultural  
 Irrigation and Mfg. Co. - Thence East  
 crossing Independence Creek, 1900 varas  
 to a point - Thence South  $45^{\circ}$  East  
 2400 varas to a small rock mound five  
 varas North of running water in In-  
 dependence Creek - Thence North 1350  
 varas to a point - Thence South  $88^{\circ}$   
 East 45 varas to a small rock mound  
 in valley - Thence South  $32^{\circ}$  East 40

P'

varas to a point — Thence North  $77^{\frac{1}{2}}$  —  
 East 720 varas to a point — Thence East  
 420 varas to a large rock mound above  
 a spring — Thence North  $48^{\frac{1}{2}}$  — East 420  
 varas to a large rock mound on a  
 branch of Independence Creek leading  
 to the North — Thence South  $12^{\frac{1}{2}}$  — East  
 620 varas to a point — Thence South  
 $82^{\frac{1}{2}}$  — East 3200 varas a small reference  
 rock mound on Northern Bank of Independ-  
 ence Creek, 5600 varas to a point —  
 Thence South  $36^{\frac{3}{4}}$  — East 1200 varas to a  
 point — Thence South  $48^{\circ}$  — East 1100 varas  
 to a rock mound marked "I" on North Bank  
 of Independence Creek — Thence South-  
 $62^{\frac{1}{2}}$  — East 1700 varas to a small reference  
 mound from whence the mouth of  
 Independence Creek is South  $50^{\frac{1}{2}}$  — East  
 80 varas ~~to a point~~ — Thence South  $29^{\circ}$  — West  
 1000 varas — Thence South  $50^{\circ}$  — West  
 2280 varas to a point — Thence South  
 $7^{\frac{3}{4}}$  — West 600 varas to a point near the  
 Pecos River — Thence South  $16^{\circ}$  — East  
 840 varas to a point — Thence South  
 $38^{\circ}$  — East 1520 varas to a point — Thence  
 South  $58^{\circ}$  — East 420 varas to a point — Thence  
 South  $74^{\frac{1}{2}}$  — East 1940 varas to a point —  
 Thence South  $44^{\frac{1}{2}}$  — East 940 varas to a  
 counter 37882

mouth of Independ-  
 ence Creek

point - Thence South  $13\frac{1}{2}^{\circ}$  - East 1820 varas  
 to a point on the bank of the Pecos River -  
 Thence S- $44\frac{1}{2}^{\circ}$  - West 80 varas to point on bank  
 of Pecos - Thence S- $11^{\circ}$  - E 54 varas to point  
 on Pecos - Thence South  $26^{\circ}$  - East 80 varas  
 to point on Pecos - Thence South  $17\frac{3}{4}^{\circ}$  - East  
 45 varas to point on Pecos - Thence South  
 $27^{\circ}$  - East 320 varas, crossing Richland Creek,  
 to small rock mound - Thence South  $49\frac{3}{4}^{\circ}$   
 West 40 varas to point - Thence South  $56\frac{1}{4}^{\circ}$   
 West 1500 varas to small rock mound  
 marked "F" - Thence South  $37\frac{1}{2}^{\circ}$  - West  
 260 varas to point - Thence South  $53^{\circ}$  - East  
 660 varas to point - Thence South  $33\frac{1}{2}^{\circ}$  - East  
 440 varas to point on bluff - Thence  
 South  $6\frac{3}{4}^{\circ}$  - West 2400 varas to point -  
 Thence South  $41^{\circ}$  - West 1040 varas to a point  
 on the bank of the Pecos River - Thence  
 North  $78\frac{1}{2}^{\circ}$  - West 260 varas to large stone  
 see on end marked "D" on bank of Pecos.  
 Thence South  $55\frac{1}{2}^{\circ}$  - West 3020 varas to point  
 20 varas West of a very large cedar on the  
 bank of the Pecos - Thence South  $33\frac{3}{4}^{\circ}$  - West  
 720 varas to a point - Thence South  $59^{\circ}$   
 East 35 varas to point on bank of Pecos. -  
 Thence South  $27\frac{3}{4}^{\circ}$  - West 1240 varas to rock  
 mound marked "C" - Thence South  $57\frac{3}{4}^{\circ}$

West 2000 varas to a point - Thence  
 South  $78\frac{3}{4}$  - West 480 varas to a point - Thence  
 North  $85\frac{1}{2}$  - West 2040 varas to a point in  
 Gaddis Canyon - Thence South  $32\frac{1}{4}$  - West  
 1400 varas to a rock mound, at side of  
 Indian Trail, marked "B" - Thence  
 North  $35^\circ$  - West 30 varas to a point - Thence  
 South  $70\frac{1}{2}$  - West 420 varas to Gaddis Spring  
 at center of Survey No. 333.

Beginning at said rock mound, <sup>marked "B"</sup> on  
 Indian Trail - Thence South  $35^\circ$  East  
 60 varas - Thence South  $6\frac{1}{2}$  - West 470  
 varas to point - Thence South  $74^\circ$  West  
 220 varas to point - Thence South  $39^\circ$   
 West 360 varas to point - Thence  
 South  $25\frac{3}{4}$  - West 300 varas to point -  
 Thence South  $54\frac{1}{2}$  - West 200 varas to  
 point - Thence South  $18\frac{3}{4}$  - West 360  
 varas to point - Thence South  $4^\circ$  West  
 180 varas to point - Thence South  $3\frac{1}{2}$  - West  
 400 varas to point - Thence South  
 $32\frac{1}{4}$  - West 1060 varas to point - Thence  
 South  $21\frac{1}{4}$  - East 400 varas to point -  
 Thence South  $2\frac{3}{4}$  - West 600 varas to  
 point - Thence South  $10\frac{3}{4}$  - West 440  
 varas to point - Thence South  $30\frac{1}{2}$  - West  
 440 varas to point - Thence South  
 $23\frac{1}{4}$  - West 1205 varas to point - Thence

161E

South  $12^{\circ}$  West 720 varas to point -  
 Thence South  $60^{\frac{3}{4}}$  West 2200 varas to  
 point - Thence South  $7^{\circ}$  West 200  
 varas to point - Thence South  $31^{\frac{3}{4}}$   
 West 380 varas to point - Thence  
 South  $51^{\circ}$  West 700 varas to point -  
 Thence South  $57^{\circ}$  West 680 varas to  
 point - Thence South  $59^{\frac{3}{4}}$  West  
 1460 varas to point - Thence South  
 $36^{\frac{3}{4}}$  West 1380 varas to point - Thence  
 South  $49^{\frac{3}{4}}$  West 500 varas to point.  
 Thence South  $35^{\circ}$  West 18800 varas  
 to point - Thence South  $76^{\frac{1}{2}}$  West  
 365 varas to point - Thence South  
 $22^{\frac{3}{4}}$  West 540 varas to point - Thence  
 South  $17^{\frac{1}{2}}$  East 300 varas to Myers  
 Spring situated at the center of  
 Survey No. 335.

I, L. H. Danell, Deputy Surveyor of  
 Pecos County, Texas do hereby certify that  
 the foregoing fieldnotes are a true and  
 correct copy of connecting line run by  
 me during the month of May A. D. 1882  
 L. H. Danell  
 Deputy Surveyor of Pecos County  
 Texas.

Filed for record August 12<sup>th</sup> 1882, at 10<sup>o</sup> Clock  
 a.m. and duly recorded in application

DS

Book No. 3 on Pages 21-22-23<sup>rd</sup> 24.

E. M. Bates

Surveyor Pease County Texas



SK. FL. 21  
Sketch file N<sup>o</sup> 10

Pecos County

TERRELL SK. FL. 2-3

Connecting line from North  
West corner of Survey N<sup>o</sup> 1  
Blk. N<sup>o</sup> 1. made by virtue of  
Cert. N<sup>o</sup> 706 issued to Texas  
Central Ry. Co. to the mouth  
of Independence Creek and  
thence to Gaddes Spring and  
thence to Meyers Spring.  
Run by L. W. Dunell  
Deputy V. Pecos County  
May 1882.

Filed in the Genl.  
Land Office Aug. 21/82  
by J. H. Raymond & Co.

Filed Aug 21  
by  
Jas H. Raymond  
1882  
JHR

335  
Myers Spring

*Handwritten notes in red ink, including "Block No. 1" and "Texas Central Ry. Co."*

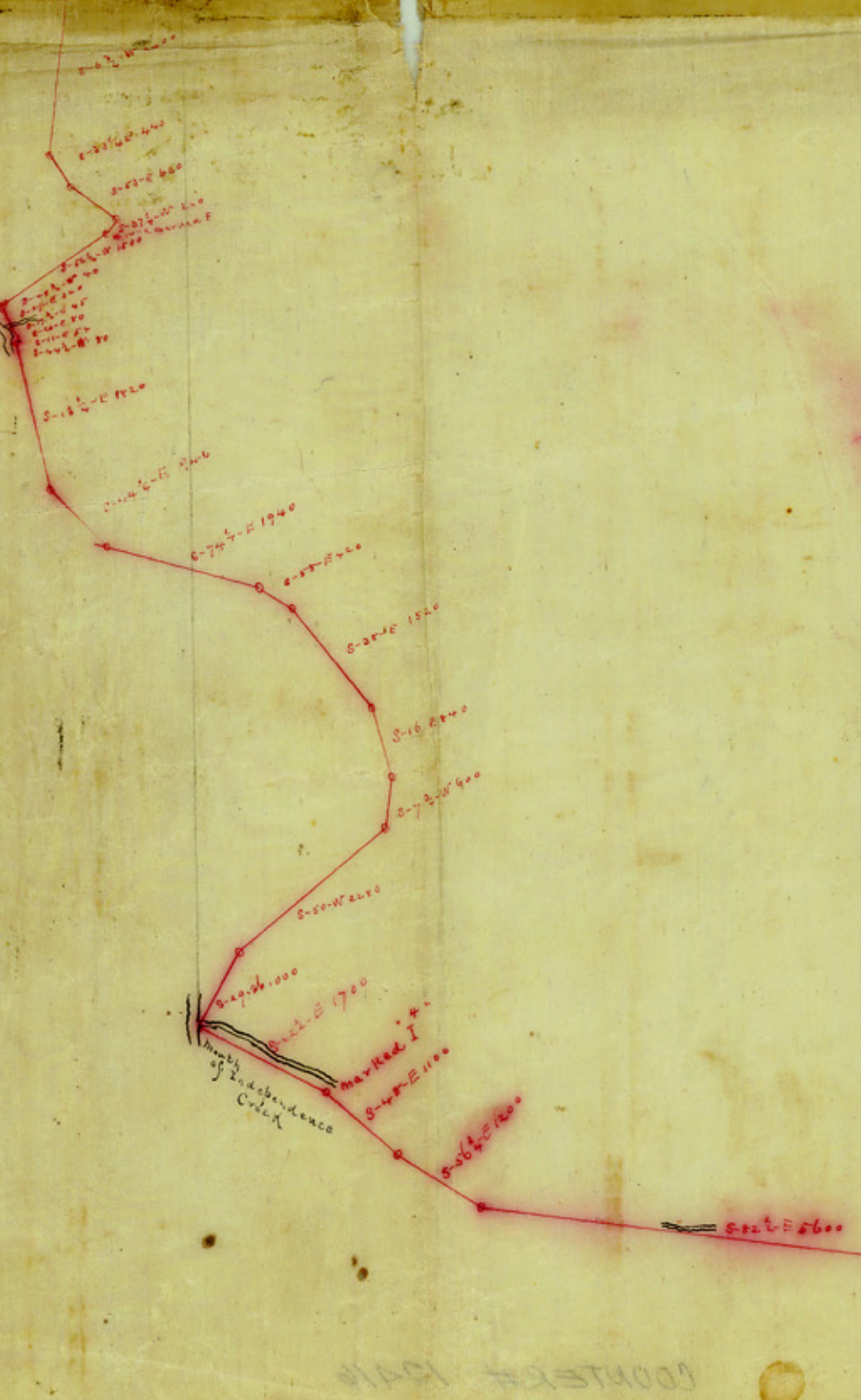
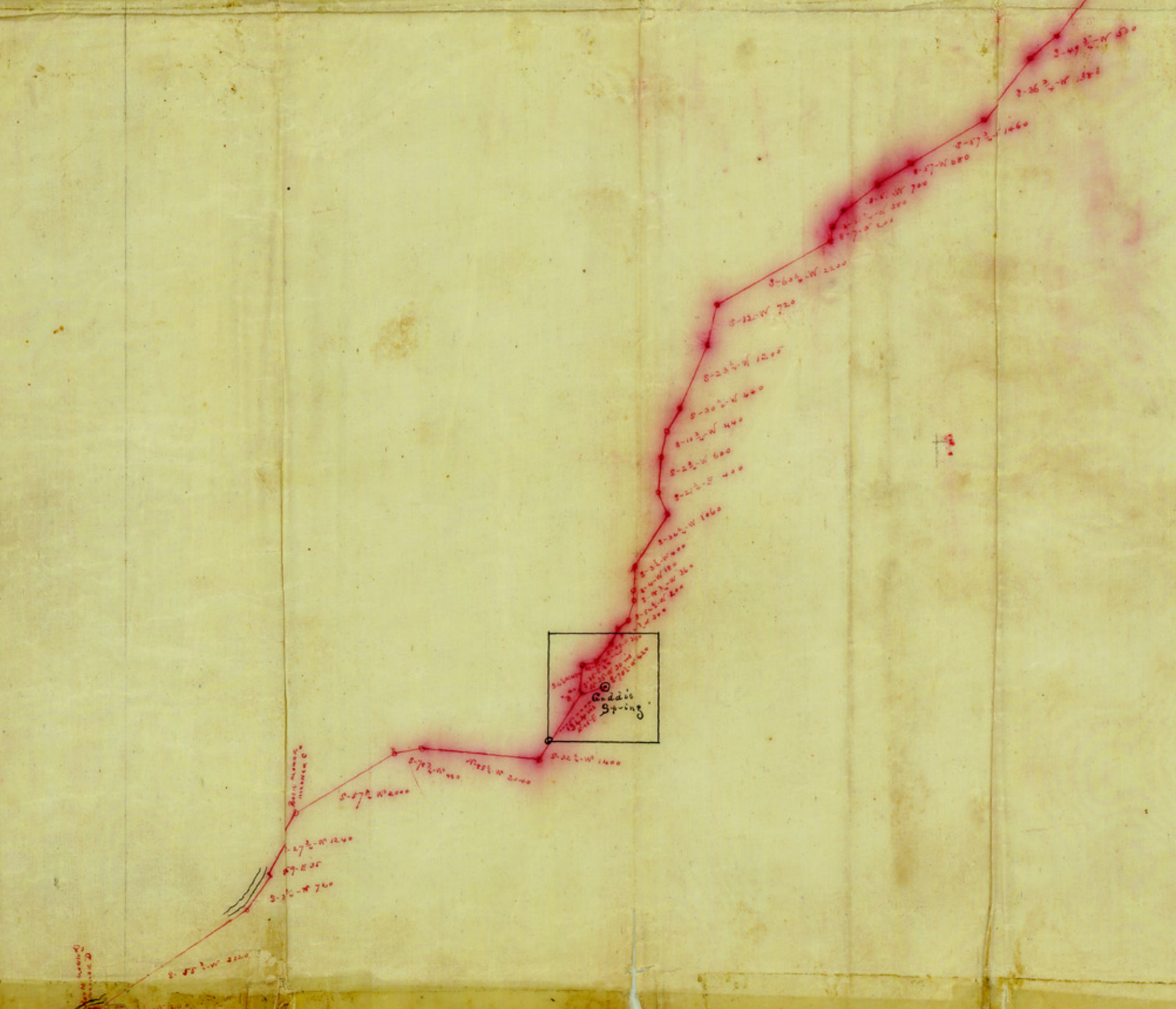

5	6	7	10	15
	Block No. 1		Texas Central Ry. Co.	
3	4	8	11	14
2	1	9	12	13

I, L. W. Durrell, Deputy Surveyor of Pecos County Texas do hereby certify that the attached plat is a true and correct copy of connecting line run by me in the month of May, A.D. 1882

L. W. Durrell  
Deputy Surveyor of Pecos County Texas

Scale 3000 feet to an inch