

A Sketch explanatory of a survey supposed to have been made (in now Titus County) for Andrew S. Young the same being again surveyed for John Binion aft of B. Marchant

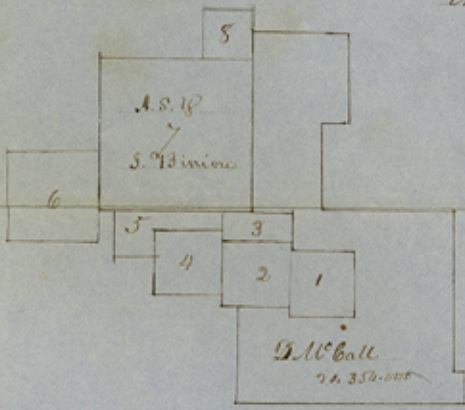

Reference

-	Large survey, corrected survey of D. McCall	
1	W. W. Jones first survey	320 acrs
2	J. W. Jones 2d. do.	320 do
3	Richard Moore Washington Gray	121 1/2 do
4	Richard Moore	320 do
5	The L. Burns open	160
6	Ambrose Ripley	640 "
7	John Binion aft of B. Marchant	10,764.000 acrs
8	William Pottle	160 acrs

The above is not in strict conformity with the real facts as it would appear on the ground but varying to meet the calls of the survey, the field notes of which call for the claim of Young. The calls of D. McCall and J. Binion carried are correctly put down. The original survey of McCall calls running to A. S. Youngs S. E. corner & with is 26 line 3160 to its S. E. corner. (by Hamilton)

The corrected survey of McCall runs west to Binions S. E. corner & north with his east boundary line &c. (by Wilson)

6 The survey of A. Ripley calls for A. Youngs S. W. corner & W. b. line

8 The survey of W. Pottle calls for Youngs S. E. corner & N. b. line

3 The survey of Washington Gray calls for Binions S. E. corner the same as Youngs

5 The Burns survey does not call for either Youngs or Binions lines nor will the line of that reach Youngs or Binions if all calls be correct

The John Binion survey covers the land, once understood to be A. S. Youngs but of Youngs claim there is no record of the survey in my Office

W. D. Orr S. S. S.

Surveyors Office Red River County Texas

I William D. Orr surveyor in and for the Red River Land District. Do certify that after diligent search, among the Record Books and files of my Office, I find no survey of land made for Andrew S. Young either upon Record or on file in this Surveyors district, that the Record of other surveys appear of Record in my office, which calls for the lines and corners of A. S. Youngs survey.

That a survey made in the name of John Binion a segment of Perry Marchant bearing date the 11th day of August 1847. is put of Record covering the same land (or nearly so) that said survey calls for a portion of the same lands, which parts in part called for the lines of said Young. — and that there is no conflict appearing of Record between the said Binions survey and those adjoining it of older & the younger surveys — nor is there any conflict appearing between Binion and a survey purporting to be A. S. Youngs, there being no showing or colour of title to A. S. Young upon the Record of my Office

Given under my hand this 23rd day of July 1853

William D. Orr S. S. S.

File 6.

Situs County

Bound Mont Pleasant

On Map

*Edwards
Bedwin*

counter 3841