

A Sketch showing the connection of surveys
with R. M. Hopkins' League - Titus County.
Laid down to a scale, to give explanations on its face

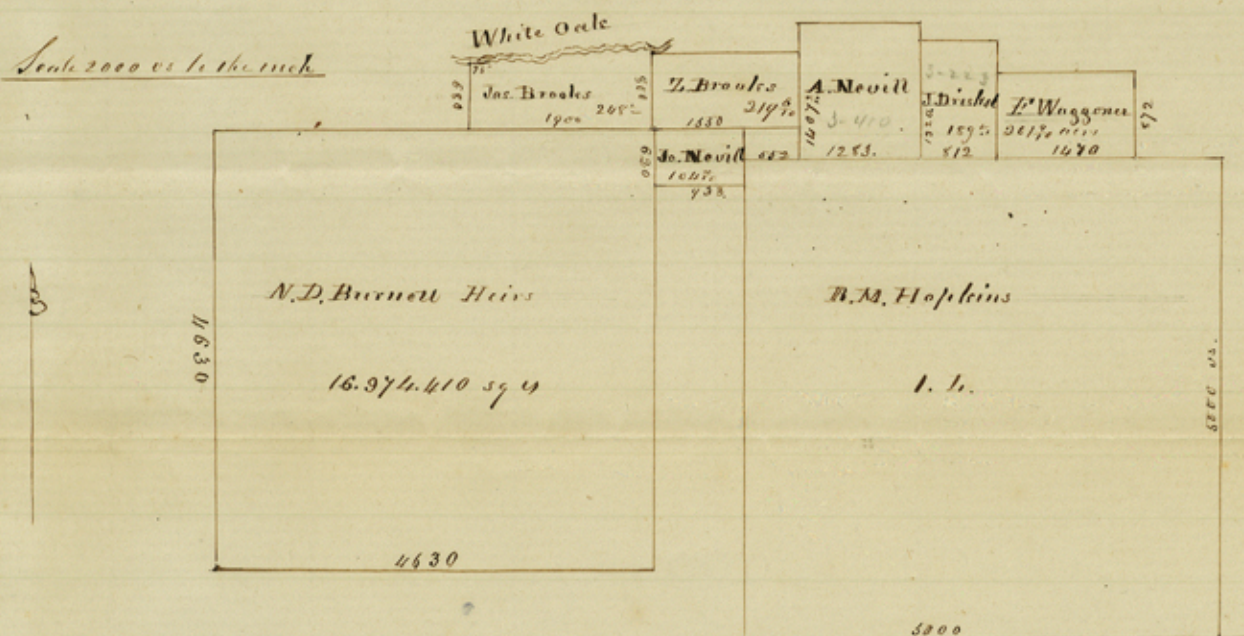

I William D. Orr District Surveyor Red River District
certify that the above and foregoing sketch is a
true and correct representation of the surveys
therein, set forth, and as appears from the Records of
my Office.

Given under my hand this 31st of May 1853
at Office Clarksville

William D. Orr District
Surveyor Red River District

Fill

Sketch

File 129

Titus County

on White oak Creek.

plotted on Map.

rec^d. Aug. 10. h. 1858

counter 38147