

38
1775
53-75

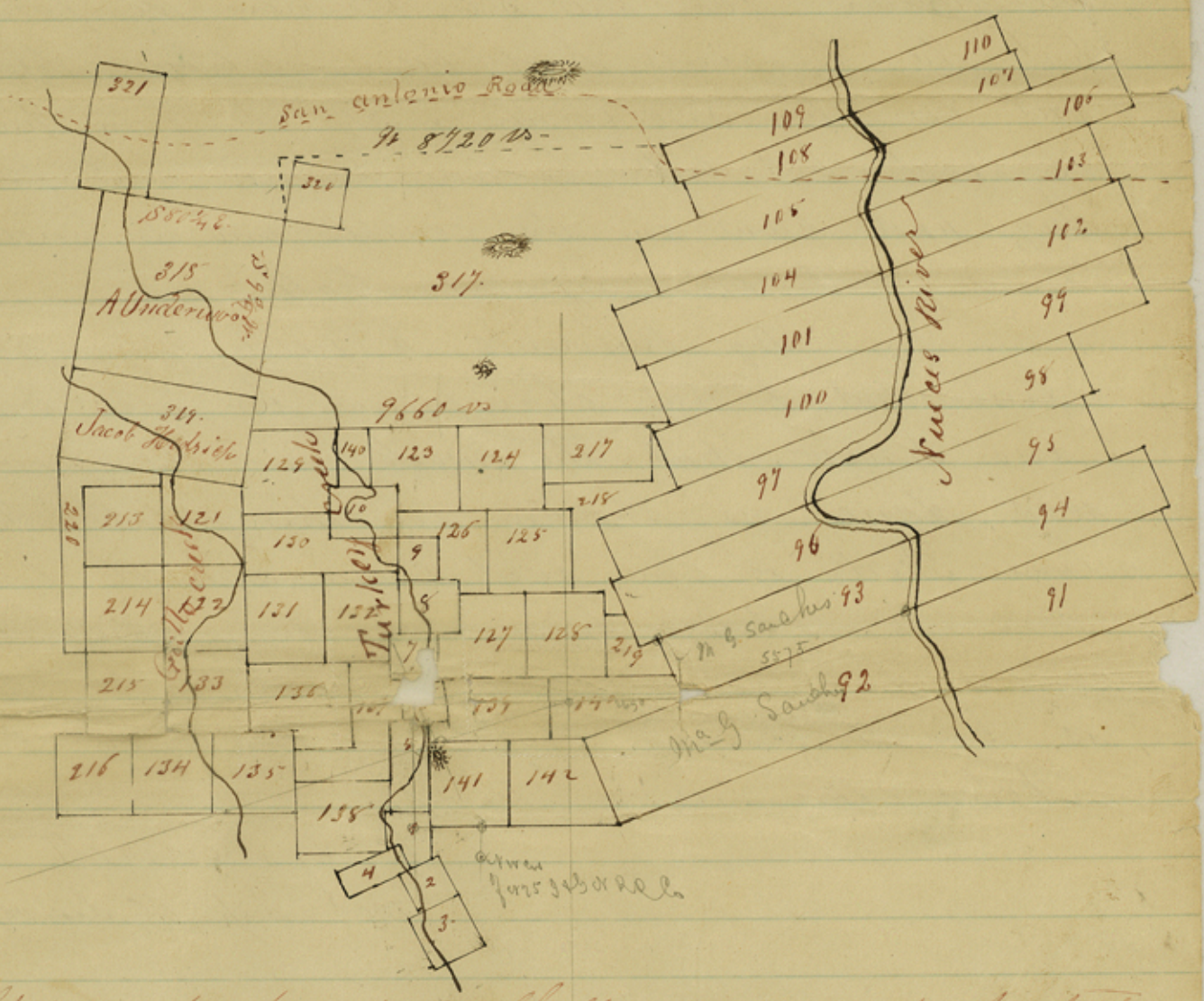

Statement for, N. S. Shelley. in regard to Turkey
 creek works done by J. M. Cummings for Burns & Co.
 Mr Cummings says that he has sent the
 Commissioner of Land office a full statement
 of how he found the work & that he will
 not send any more unless the Commissioner
 send satisfactory evidence that the certificate
 formerly sent by him has been destroyed and
 are not on file. I send you a copy of an
 original plat deposited in this office by
 J. M. Cummings and I can certify that the line
 marked S 80 1/4 E and S 1 1/4 W west are so on the
 counter 38988

ground for we Cummings and I followed them and found them marked plain found. the N.E. Corner of 318 both Bearings are plain for the S.E. Corner we found that the Bearings had been Destroyed by fire but for the S.W. corner of 317 we found his site of Rock but both bearing burned but found when they had been and the Courses and distances did agree with the original calls-

By reference to field notes you will find that I was chainman for J. M. Cummings and know that the work on the ground was done as shown in this plat the dotted line North of the foot Bend Schall land was our connecting line connecting the Success of Turkey creek work. And that the distance is greater than given in original field notes for survey no 317.

J. M. Bennett
Act Dep. Co. Surveyor & Co.

Sketch File No. 16
Uvalde Coun
J. W. Cummings Sketches
& Report
Dated March 1876
Filed 193
J. H. Walker, Comr
File Clk
Descriptive:

Shelley

said bearing, but that its South boundary line is due East and West—
And further, that I found, that the N. W. Corner of Survey
No. 10, Uvalde County School is east 1818 varas, and South 1319 varas
from the S. W. Corner as Originally made and described, of Survey
No. 317, Fort Bend County School.

And that the foregoing
Plat is a true and correct Plat of the Surveys herein mentioned
with their relative position and connections, immaterial errors
excepted, and excepted also as to the rulings for Survey No. 317—
certifying only as to its main Western boundary and its
connecting position with other Surveys.

And I further certify that I have made a careful re-
survey of the connection of the S. W. Corner of Survey No. 5, with
the most northern Corner of Survey No. 4, (both Uvalde Co. School)
on a more correct basis than the basis on which the Original
Connection was obtained, and that said S. W. Corner of Survey
No. 5, is distant from said most northern Corner of Survey No. 4,
to wit: North 843 varas and West 180 varas.

In testimony of all the foregoing I have signed my Official signa-
ture at my Office in Uvalde this the 1st day of March 1876.

J. W. Cummings Co. Sur.
Uvalde County

If the surveyor intends to controvert old surveys by a new survey it
is necessary for the surveyor to put his compass in the same variation
as the surveys are run, in this case $9^{\circ}45'$, and if he find the course
run on the ground different from the rule in the field notes, must
state the fact. The surveys 92 up to 109 are made by a varia-
tion of $9^{\circ}34'$ and are carefully surveyed, as the surveyor states
with in, but fails to state whether he found them in accord
with the field notes or not. The surveys 317 up to 322 are run
with the same variation and by a course N. E. S. W. all made
by the same surveyor and at the same time and can not be
expected that No. 322 is run by the magnetic line while the
surveyor states in the field notes by a variation of $9^{\circ}34'$.
The surveys 5 up to 10 are made by the same variation and
the same course, while the surveyor gives them on his
sketch a different course all together.

The explanation in the certificate is indefinite. Connections must
be given between established corners, and differences in

Livide Co. Sp. File #16
course and distances must be given as found on the
ground in a plain language, and by figures, without
running around the stump and not hitting the point.
June 14/76
Thielpaper

File # 16
Ulvaide Co.

Filed March 10/76
J. J. [Signature]

1-605-562
B-458

County Surveyors Office - Uvalde County, Texas
At Uvalde March 1 - 1876

J. J. Groves

Clerk of the Genl. Ld. Office - Austin

Sir

I herin enclose a more correct Plat, showing the true position of Surveys Nos. 318, 319 and 321, ^{on Turkey Creek} and relative position of other Surveys - including their connecting position with the Mueces River body of work. I have spent much time and labor in obtaining this, and can give my assurance that the allegations to the Plat by me may be relied upon - R. B. Hays, who made the first named Survey was at the time quite a young man, and possibly knew nothing about variation of the Needle & has probably had a plane Compass, without Vernier Plate, and run his lines to the Cardinal points of the Needle - at any rate, that is the way those lines are, nevertheless that his field Notes calls for variation

Of Survey No. 320 I made no investigation further than finding its S. W. corner, and I have dotted it down in red ink in position as I think it most likely is, of which of course I cannot certify - Of Survey No. 317 I have platted the position of its Main western line, and of what I believe will have to be its South boundary line - its Northern line I do not Plat, only give their the true connecting distances between the

N.W. of 109 & N.E. Corner of 318 - I think Survey No. 317, if it holds to its corners will have over $\frac{3}{4}$ of a league of Surplus Area -

This corrected Plat of Old Survey, is now forwarded because field notes of New Work ^{relating thereon} goes up by same Mail as this - Other field notes will soon follow of the same body of work

Very Respectfully
 W. L. Cummings
 County Surveyor, Uvalde County.

1 Enclosure