

Field notes of a connecting line from the
60^{1/2} mile post on 100 main. to the S.E. corner
of Sec 44 Block a 3. H & G. N. R. R. Co in
Wheeler Co

Commencing at the 60^{1/2} mile post of 100 main,
same being the East boundary line of the Paw Hand
of Texas. Said mile post is situated 2600 N of
Sweetwater creek. —

Thence West 7800 N. 1400 N. + 1780 N. + 2220 N. + 4640 N. cross
Sweetwater creek 5700 N. to stake 400 N. South of creek
for S.W. cor of sec 3 a 3.

Thence N 45° W at 2880 N. cross creek, 45° 00' cross creek 5360 N.
stone on bank of creek for S.E. cor of 26 a 3.

Thence West 40 N. cross creek 3000 N. cross creek 4020 N. cross
creek 7480 cross creek 7600 N. stake on S side of creek
for S.W. cor of 29 a 3

Thence N. 40 N. cross creek 1900 N. to N.W. cor of 29.

Thence West 2460 N. cross creek, 3240 N. cross creek 5880 N. cross
creek. 6280 N. cross creek. 7820^N cross creek. 8820^N cross creek
9330^N cross creek 10140 N. cross creek, 10840 N. cross creek
11400 N. to stake S.E. cor 35 a 4.

Thence N 45° W 1800 N. cross Sweetwater 2680 N.W.
cor 35 a 4

Thence N. 90° W cross creek, 1050 N. cross creek, 1120 N.
cross creek, ~~1600~~ cross creek 2050^N cross creek
5290 N. cross creek, 10020^N cross creek 10720^N cross creek
creek 13300 N. to stake on Hill between adobe
& Sweetwater creeks for S.E. cor of sec 44 a 3.

June 22nd 1881. —

Cham } John Lewis
Comer } Geo Moore

State of Texas I hereby certify that the foregoing
County of Wheeler field notes are correct and that the
work was done on the ground

H. B. Spiller

Sur A Co Texas

I hereby certify that the above writing is a true and
correct copy of Field notes now on file in my office
Given under my hand this 11th day of Nov 1881

H. B. Spiller

Sur W County

-3-

Wheeler County.

Sketch & connecting line.

Filed Novemb. 15/81.

H B Spiller. 11-1-81-

Charles A. Spiller,
Chf. Clerk.

Map of
Sweetwater Creek

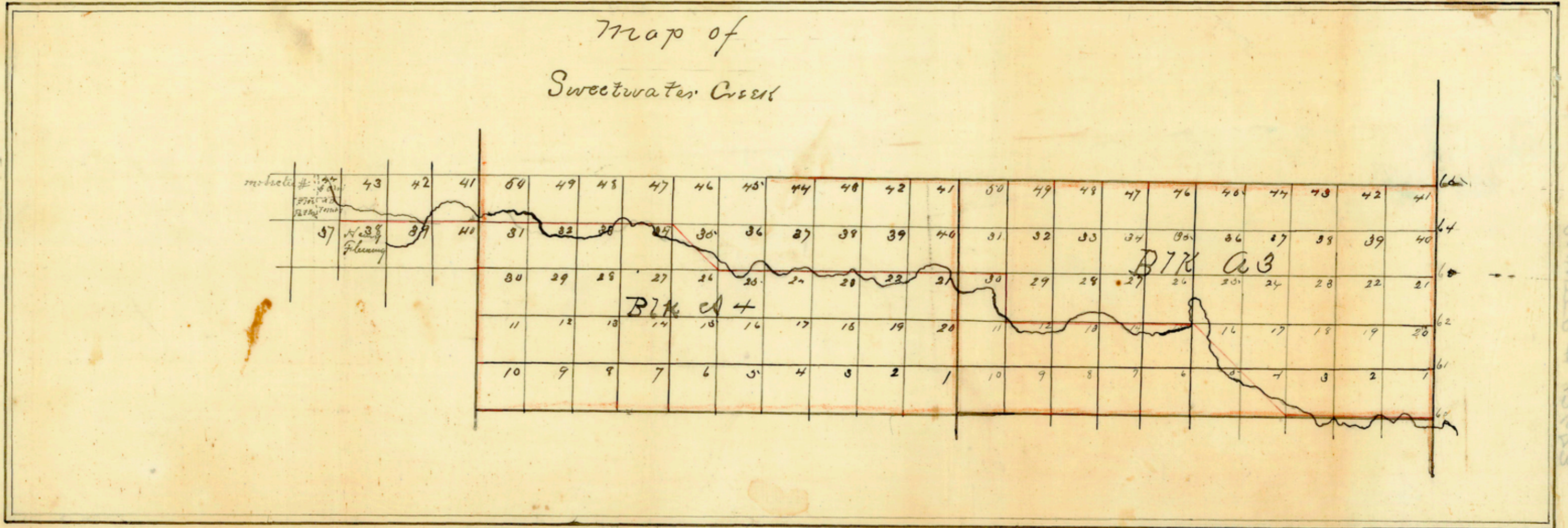

COMSER # 189223