

County and District Surveyor,

CLAY COUNTY, TEXAS.

C. B. PATTERSON
SURVEYOR.

Henrietta, _____ 18 _____

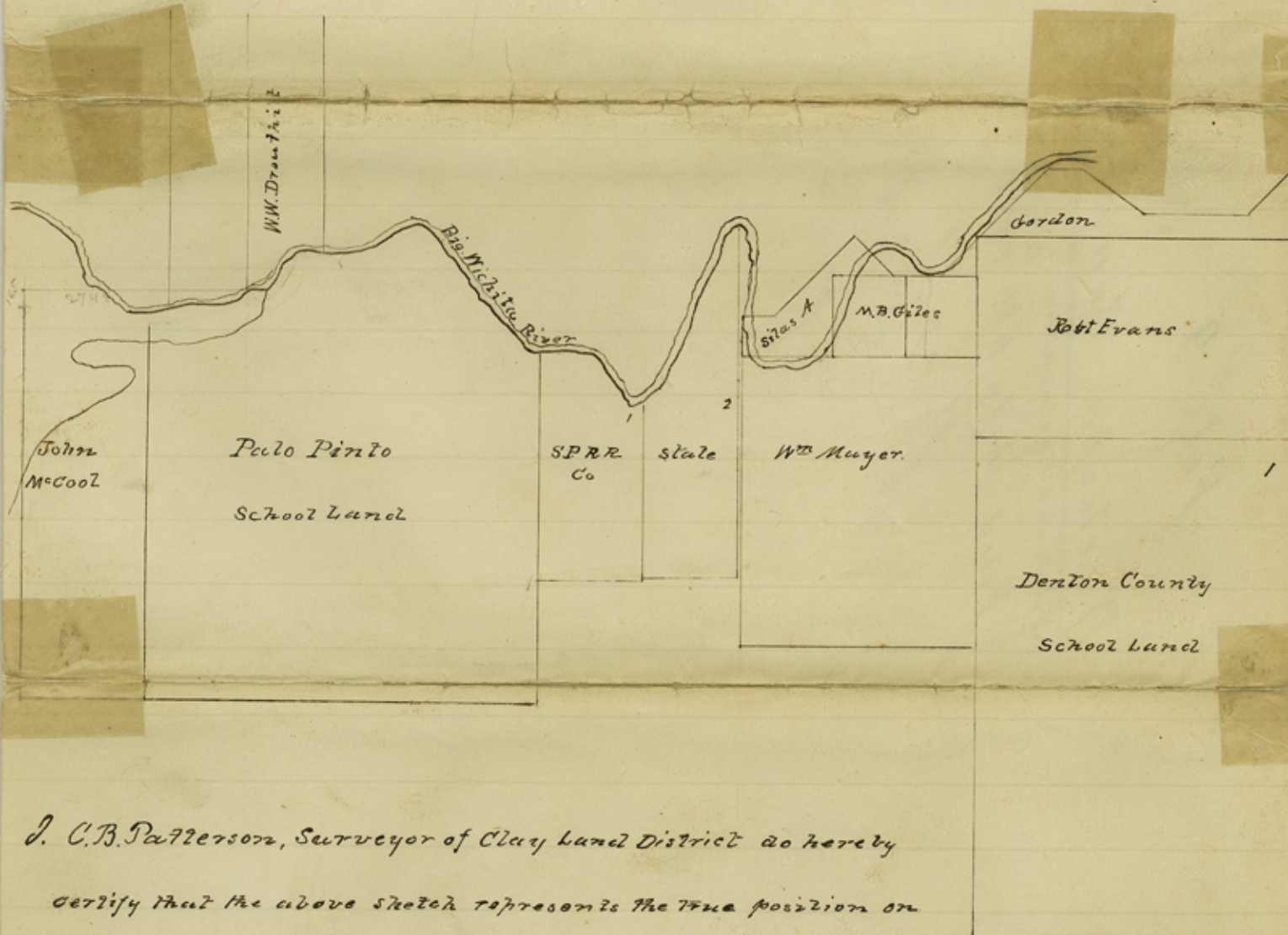

J. C. B. Patterson, Surveyor of Clay Land District do hereby
certify that the above sketch represents the true position on
the ground of the surveys shown thereon.

C. B. Patterson

Sur. Lelay Lapidus

File: 9.^d

Wichita County

Sketch and Explanation.

Filed July 6th 1880.

W. Marsh
Surveyor