

K-44

SEC 33

SEC 34

T 5 S

R 12 W

RED RIVER

Note: See 78th Dist Court Judgement 8-12-26  
N° 17821-B styled Chas Pridgen vs Joe Ward Co. Sur.  
Judgement N° 47847 Vol 5 Pg 127 78th DC Records

M. GILBERT SUR

South bank as established 4-25-25  
by the Supreme Court of the U.S.

MCFARLAND ISLAND

Channal cut in 1891

J. JOHNSON C-25/131  
377.35 AC  
Original Sur. in 1886

14" Pecan on old bank of River.  
Brs N 48° 25' E 65' J. JOHNSON

Original Meander line of  
Johnson Sur. 2  
16" Pecan

W 1440.4 (1512)

(Beg. 30.200 vs 570' W from  
mouth of Big Wichita River)  
28' Elm mk Mon W side Brs S 35' E  
202.3 vs. 36' Pecan mk. X  
Brs. 532' 13" ± 573.8 vs

N° 809  
B. BROWN C-57  
380.98 AC  
original Sur. in 1856

N° 808  
B. BROWN A-21

H. HASTIE A-98

I, Ross Corlett, a Licensed Land Surveyor of Wichita County,  
Texas, do hereby certify that the foregoing survey was made by  
me on the ground, that the limits boundaries and corners, with  
the marks natural and artificial, are truly described in the  
foregoing PLAT just as I found them on the ground.

This the 20th., day of December, 1949.

*Ross Corlett* (Ross Corlett)  
Licensed Land Surveyor of Wichita Co. Tex.

H. HASTIE A-92

RECEIVED  
DEC 30 1949  
GENERAL LAND OFFICE

SCALE 1"=400 VS

counter 40152

**RECEIVED**  
DEC 30 1949  
GENERAL LAND OFFICE

SE-A SITSAH H

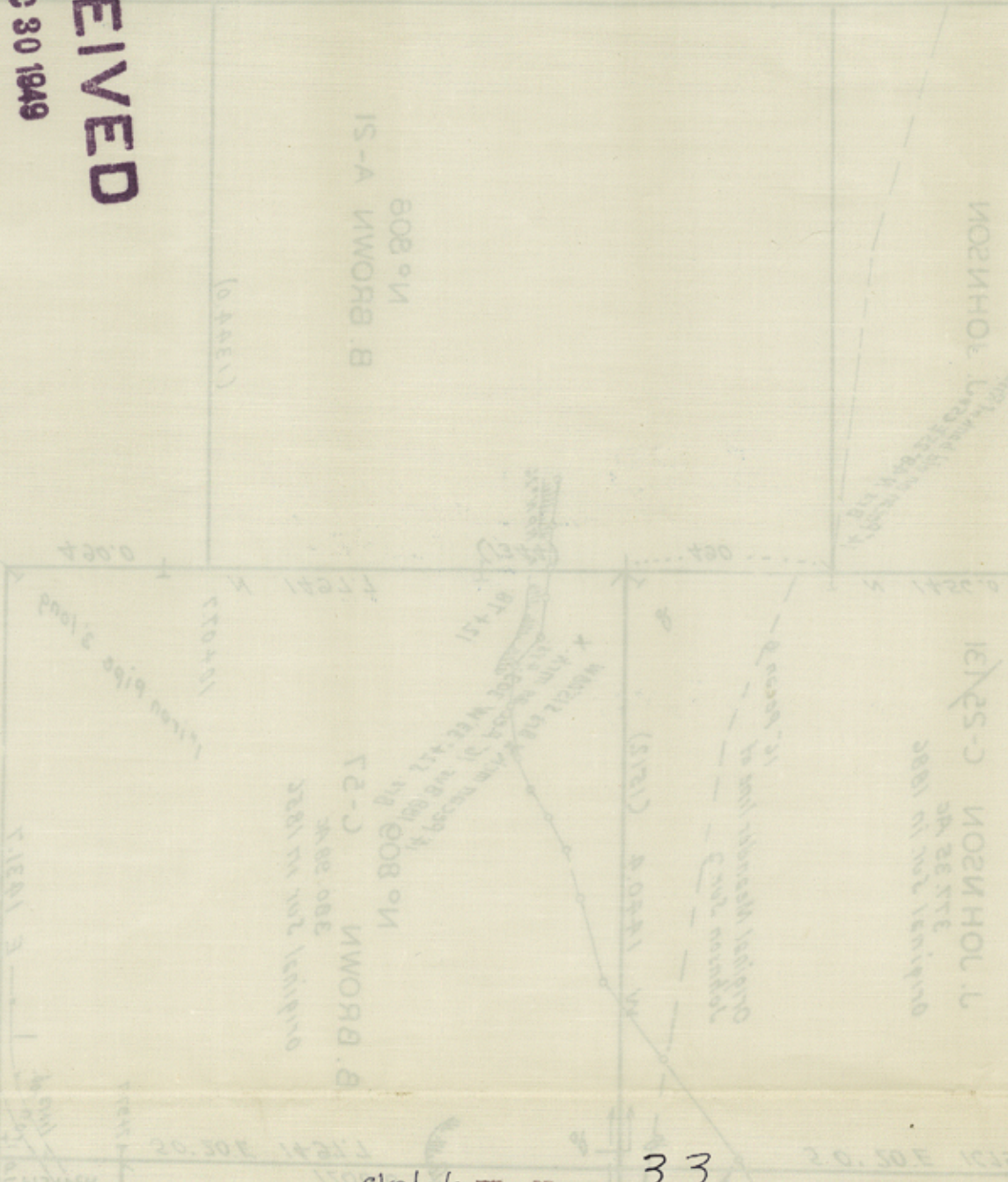

Sketch File No. 33

Wichita County

Corlett's Sketch of John Johnson  
and Bryant Brown # 809

Filed January 12, 1950

BASCOM GILES, Com'r

W. von Rosenberg  
File Clerk

Licensed Land Surveyor of Michigan Co. Inc.  
(Notary Public) (Notary Public)

BE-A SITSAH H  
I have examined the above described plat and find it correct and conforming to the laws of Michigan. I am a duly licensed land surveyor of Michigan. I am not a party to this matter. I am not a party to this matter. I am not a party to this matter.