

North



The State of Texas }  
County of Wise } I J. W. Hale County Surveyor of Wise  
County do hereby certify that the  
above sketch is a correct representation of  
the surveys represented therein  
according to the records of my office.

Given under my hand  
at office this January the  
27<sup>th</sup> 1866

J. W. Hale 6576

File 20.

Wise County

---

Oliver's Creek.

---

filed February 1<sup>st</sup> 1860.

---

---

on map.

Oliver's Creek in Wise Co  
for place

counter 40558

Wise Co 20

Three (3) No 20 sketches,  
Sundry locations, dates etc.

counter 40559

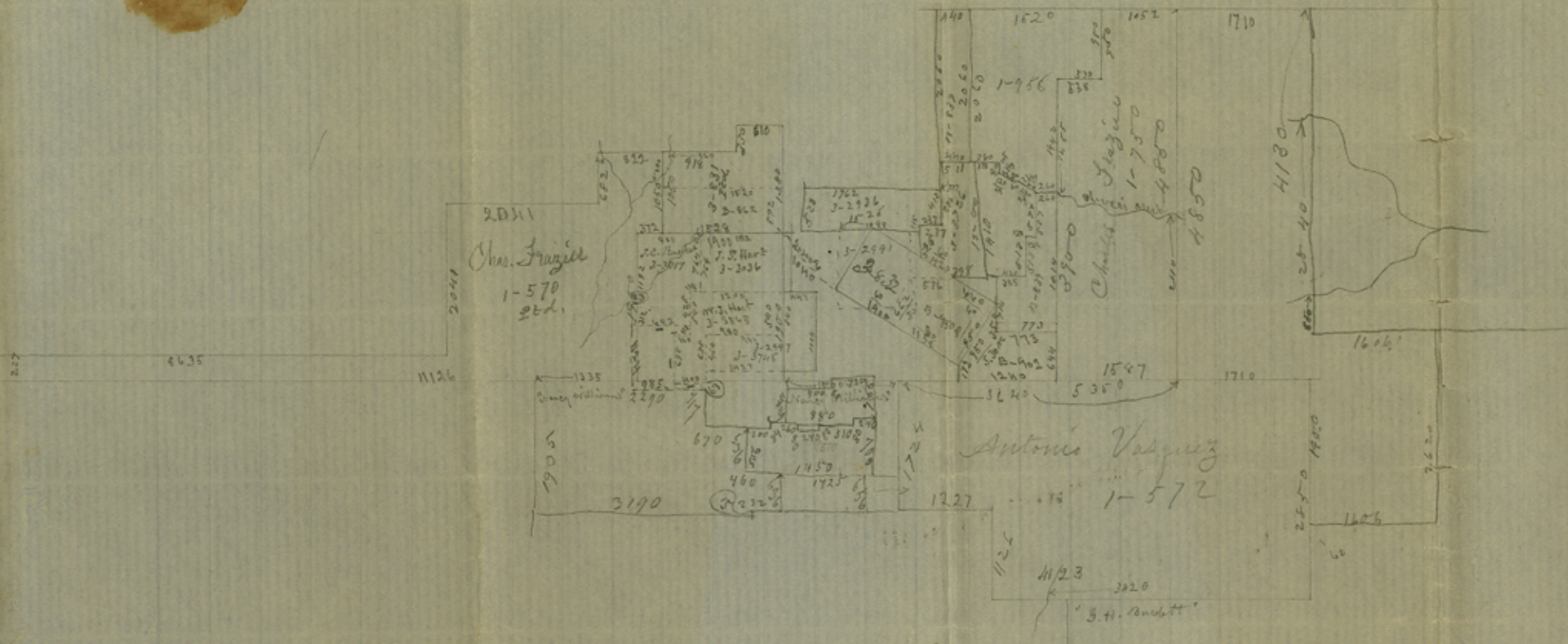

2041  
 Chas. Frugill  
 1-570  
 26d.

Antonio Vasquez  
 1-572

S. H. Bennett

counter 40560

on maps.  
wise co.  
file 20.  
Compiled in  
Office

counter 40561



File 20

Wise County

Rec<sup>d</sup> July 1860

S. E. of Decatur  
on map.

Sketch Map  
R. G. Mount

Sketch

counter 40563