

HAAS SURVEYING

Michael Haas, LSLS, RPLS

Telephone (512) 776-7007

Cellular (512) 960-7870

Route 1, Box 876 * 3370 Ave. A
Ingleside, Texas 78362

March 18, 1997

Mr. Ben Thomson
Texas General Land Office
Stephen F. Austin Building
1700 N. Congress Avenue
Austin, Texas 78701-1495

File No. Rld. SK. 123 A
Nueces County
Surveyor's Report
Filed May 14 19 97
GARRY MAURO, Com'r
By Douglas Howard

SURVEYORS REPORT

SUBJECT: Shoreline determination along a portion of the Laguna Madre in Corpus Christi, Nueces County, Texas.

LOCATION: The property surveyed is an unplatted parcel of land known as Lots 8 and 9, Block 5, Tyler Subdivision, situated near the southern city limits of Corpus Christi with approximately 155 foot frontage on Laguna Madre.

PURPOSE: This survey is being performed to obtain General Land Office approval of the shoreline boundary to satisfy the platting requirements of Corpus Christi and allow the property owner to improve his property.

PROCEDURE: A boundary survey was first completed employing the owners metes and bounds description and monumentation found on the adjoining platted lots to the north and south of this tract. These lines were then projected to the shoreline at elevation +0.81, NGVD '29 measured from benchmarks established by me in my survey at Tropic Isles and later confirmed using GPS. The perimeter boundaries were then tied to the Texas State Plane Coordinate System, South Zone, utilizing GPS equipment based on monumentation established by Corpus Christi (SQ 051). The scale factor at this site was computed to be 0.99995555 and the theta angle = 0 degrees-32 minutes-59 seconds.

On site inspections and a review and comparison of aerial photographs taken in 1948 and 1961 indicate no evidence of artificial fill having been placed along this shoreline.

The enclosed drawing compiles the information outlined above.

Respectfully submitted,

Michael Haas

Michael Haas, Licensed State Land Surveyor

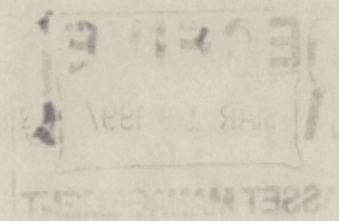

Proj No. Rd. Sk. 123 B
Nueces County
Site Map
May 14 19 97
GANNETT MAURO, CORP.
By Douglas Howard

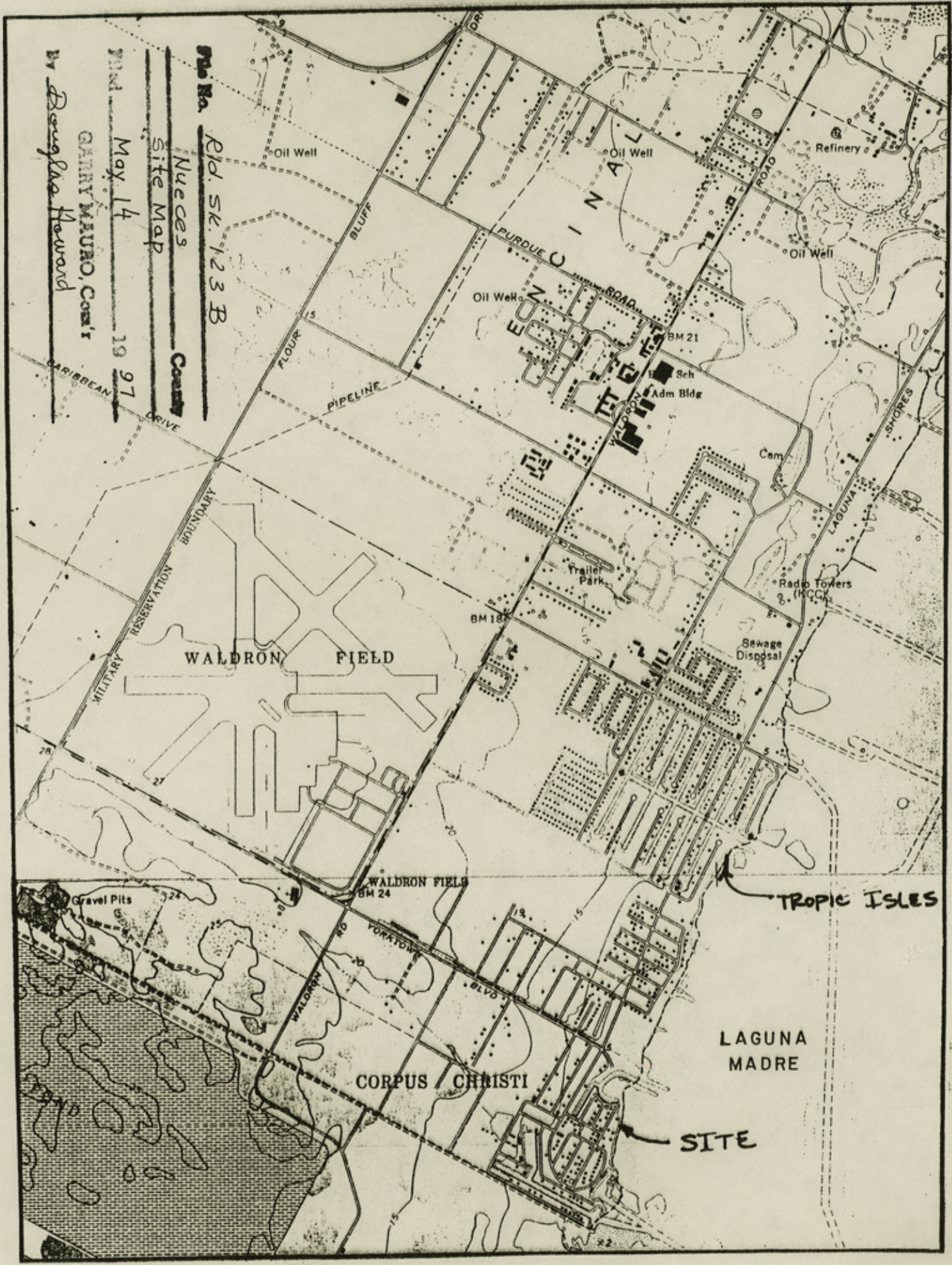

HAAS SURVEYING

Michael Haas, RPLS, LSLs

Telephone (512) 776-7007

Cellular (512) 960-7870

Route 1, Box 876 * 3370 Ave. A
Ingleside, Texas 78362

May 12, 1997

Mr. Ben Thomson
Texas General Land Office
Stephen F. Austin Building
1700 N. Congress Avenue
Austin, TX. 78701-1495

Nueces Co Rld Sk 123

RE: Shoreline Boundary on Laguna Madre Lots 8 and 9, Block 5, Tyler
Subdivision, Corpus Christi, Nueces County, Texas.

Dear Mr. Thomson:

Enclosed please find the original mylar depicting the survey I performed of the
shoreline on the above referenced property with the changes you requested. I
need a letter of acceptance at your earliest convenience.

Sincerely,

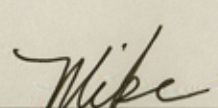

Michael Haas, L.S.L.S./R.P.L.S.

File No. Rld. Sk. 123 C
Nueces County
Correspondence: Haas to Thomson
Filed May 14 19 97
By GARRY MAURO, Com's
Douglas Howard

counter 41589



Texas General Land Office
Garry Mauro, Commissioner

Stephen F. Austin Building
1700 North Congress Avenue
Austin, Texas 78701-1495
(512) 463-5001

C. B. Thomson
Director of Surveying
Asset Management Division
(512) 463-5212
Fax (512) 463-5098

May 19, 1997

Mr. Michael Haas
Haas Surveying
Route 1, Box 876
Ingleside, Texas 78362

Dear Mr. Haas:

Your survey plat of Lots 8 and 9, Block 5, of the Tyler Subdivision, Corpus Christi, Nueces County, Texas, has been accepted for filing in the Rolled Sketch Files of the Texas General Land Office.

The plat has been filed as Nueces County Rolled Sketch No. 123.

If we can be of further assistance to you, please let us know.

Sincerely,

C. B. Thomson
Director of Surveying

CBT/jak

File No. Rld. SK. 123 D
Nueces County
Correspondence: Thomson to Haas
Filed May 19 19 97
By GARRY MAURO, Com'r
Douglas Howard