

T. & P. R. R. Co.

Motley Co

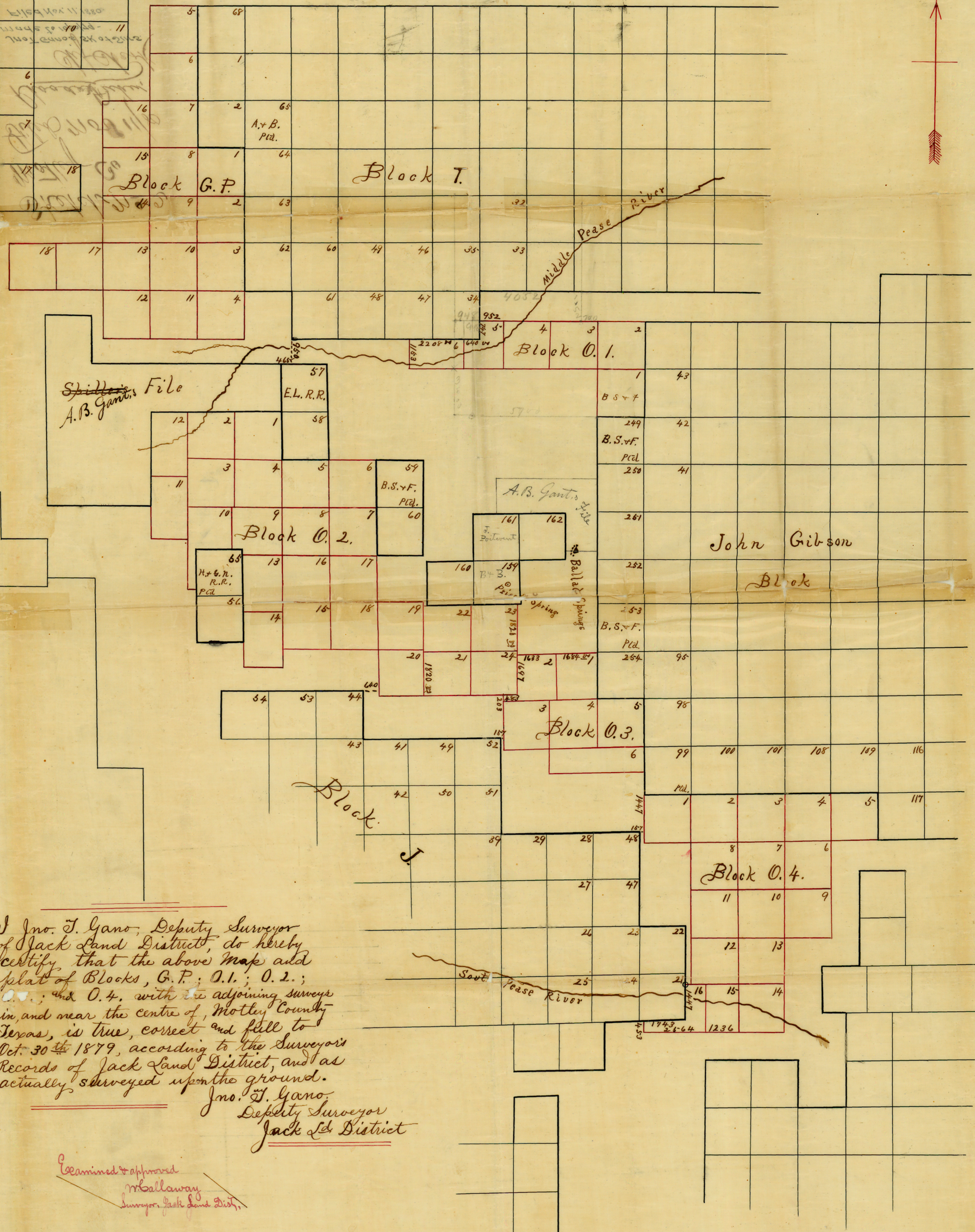
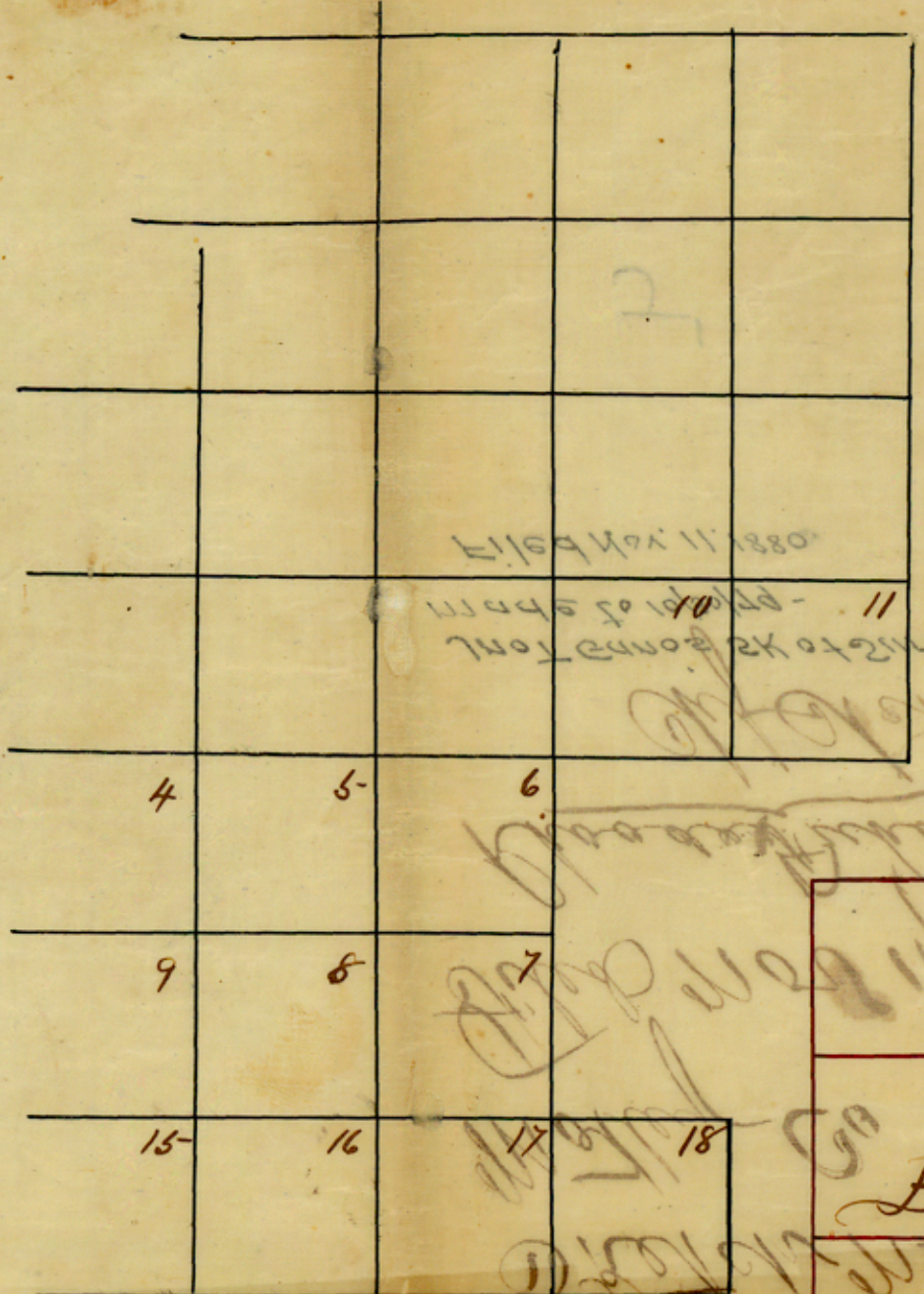

I Jno. T. Gano, Deputy Surveyor of Jack Land District, do hereby certify that the above map and plat of Blocks, G.P.; O.1.; O.2.; O.3.; and O.4. with the adjoining surveys in and near the centre of, Motley County Texas, is true, correct and full to Oct. 30th 1879, according to the Surveyors Records of Jack Land District, and as actually surveyed upon the ground.

Jno. T. Gano
Deputy Surveyor
Jack Land District

Examined & approved
Mallaway
Surveyor Jack Land Dist.

See sketch in SF 799-6022
S-17484