

Nueces 22.  
 Von Rosenbergs 2 sketches of  
 Surs. West of "Rincon del Oso"  
 grant.  
 Dated Sep 26, 27, 29, 1884.

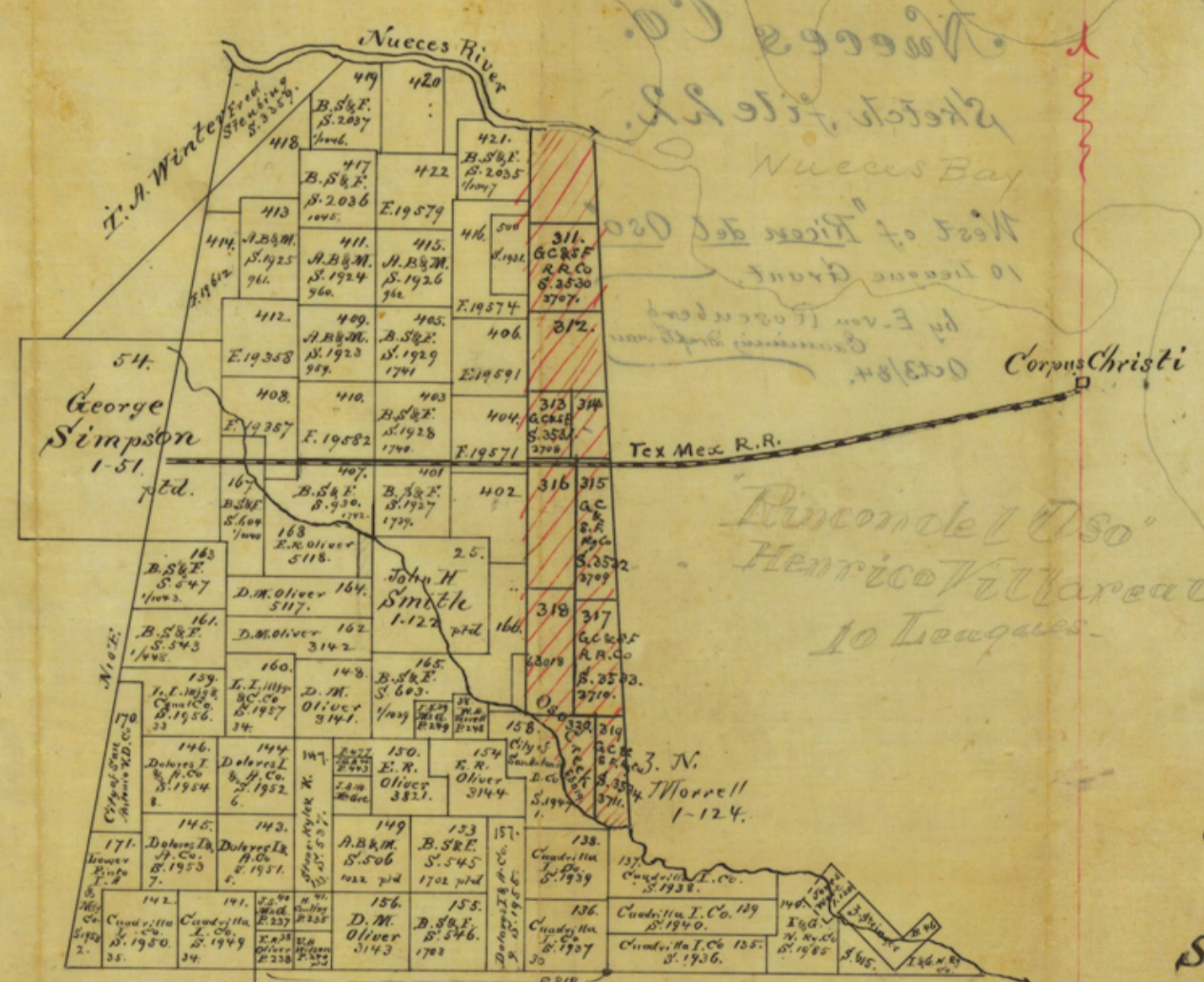

By E. von Rosenberg  
 See Decree of Court  
 in S-1927.  
 Genl Land Office  
 copied Oct. 3/84.  
 Nueces Co. Sh. file

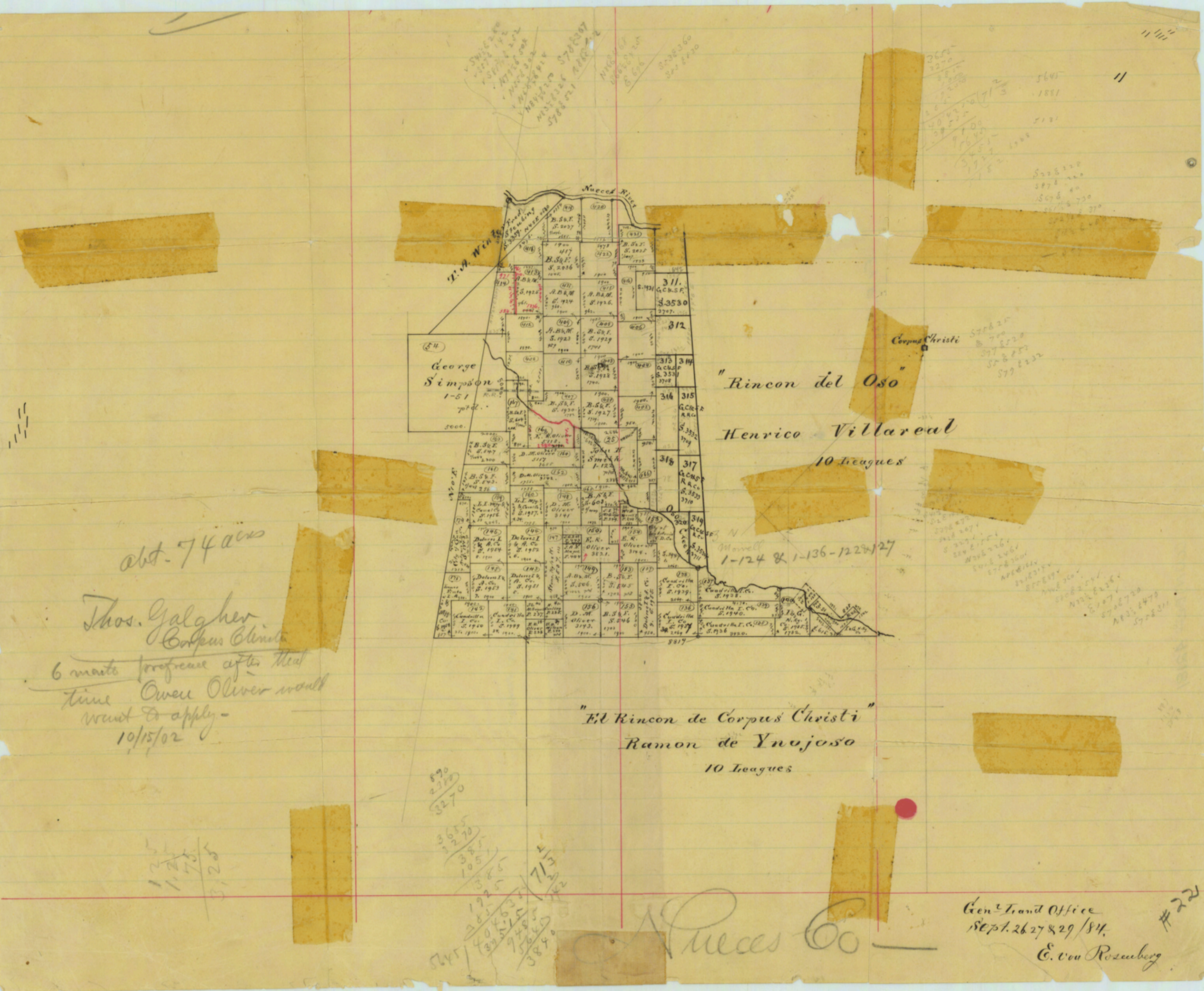

abt. 74 acres  
 Thos. Galgher  
 Corpus Christi  
 6 months before after that  
 time Owen Oliver would  
 want to apply -  
 10/15/02

Genl Land Office  
 Sept. 26, 27, 29, 1884  
 E. von Rosenberg