

Block N^o 13 T & N. O. R. R. Co. and
Part of Block N^o 43 H & T. C. R. R. Co
as resurveyed by J. L. Long, State Surveyor
August - September 1888.
Variation 11° 10' - Scale 2000 vrs = 1 inch.

State Surveyor
J. L. Long
1888
Map of
Ochiltree Co.
Blk 13 & 43

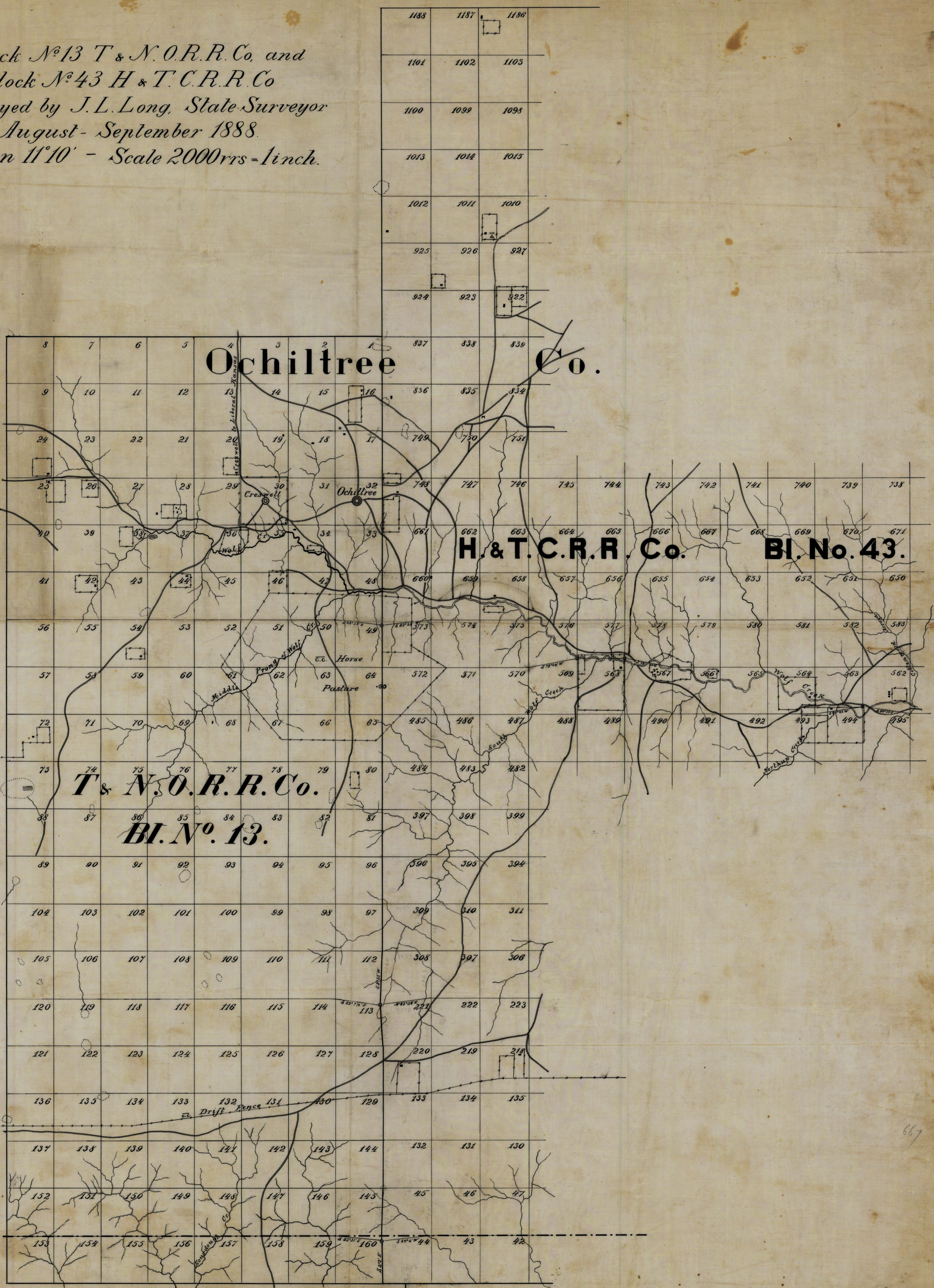

667

3.00

COMPTON # 43301