

CHAMBERS COUNTY
ROLLED SKETCH NO. 12C

Reports & Correspondance on Submerged Area Tracts

counter 43939

5738

HOWE & WISE
CIVIL ENGINEERS
MEMBERS AM. SOC. C. E.

RECEIVED

JAN 23 1936

SCANLAN BUILDING
HOUSTON, TEXAS

January 22, 1936 ATTACHED TO MAP

Please visit Howe's Triangle Area of Galveston Bay Municipal

J. H. Walker
State Land Commissioner
Austin, Texas

Re: Galveston Bay Tidal Leases

Dear Sir:

In compliance with your oral instructions we have made a study of the Galveston Bay Tidal Lease Map of December 1935 and the map of County Surveyor, Work, covering the Turtle Bay area.

We identified Work's base line and ran a traverse along the West side of Trinity Bay from his 00 plus 00 to Scherer also ran a traverse from Black Point to the mouth of Double Bayou.

We obtained from the United States Engineers' office in Galveston the United States Coast and Geodetic Survey determination of the geographical positions of the monuments surrounding Galveston Bay and have tied them to our work and to that of County Surveyor, Work's. We have calculated the location of the principal monuments with relation to each other, reduced to plane coordinates. To minimize the distortion caused by earth curvature we selected Smith Point monument as being the nearest to the center of the area and used it as the origin from the calculations of plane bearings.

In tying P2 to our work we used Work's bearings and distance from his point, 00 plus 00, to P1 and his course and distance from P1 to P2. A change of his bearing of four minutes was necessary in order to get his work onto the U. S. C. & G. Survey azimuth. In other words Work's North is four minutes West of the U. S. C. & G. Survey North.

The connecting line between Parr's Grove Monument and the Red Bluff Monument has been calculated, using the meridian through Smith's Point as basic North,

The Southwest corner of Section 216 is fixed at a point that is North $43\frac{1}{2}$ degrees East 414 varas from the Red Bluff Monument. From the Southwest corner of Section 216 the section line running toward Parr's Grove was given a course of South 57 degrees 30 minutes East. The Northwest corner of Section 248 is on this line seven miles from the Southwest corner of Section 216.

From the Northwest corner of Section 248 a line running North $32\frac{1}{2}$ degrees East nine miles plus 5,247.3 feet (on the plane coordinates system previously described) will intersect the South line of Section 2. See detail map.

All of the information referred to above is shown on the map sent under separate cover.

Superimposing the sectionized map of December 1935 on the triangulation

F

counter 73940

P'

Chamberlain 2 1912 150

Page #2

map that we have made up indicates that the former practically conforms with the latter. Our preliminary statement that there appeared to be a material shortage between Red Bluff and Parr's Grove was, as stated, based on scaling the blue line print that had evidently shrunk as no shortage is apparent in the original map on file in the Land Office.

Yours very truly,

Howe & Wise

JMH/cbw

*Received in General Land Office
January 23rd, 1936.*

C.F. Blucher

71

counter 43941

p2

2373

Chambers County Officials

County Judge—Guy C. Jackson, Jr.
 County and District Clerk—A. L. Scherer
 Sheriff and Tax Collector—W. R. Sherman
 Tax Assessor—C. G. Mendenhall
 County Treasurer—Grover C. Willcox
 County Attorney—Geo. B. Darden
 County Surveyor—W. O. Work
 Commissioner Precinct No. 1—Dale LaFour
 Commissioner Precinct No. 2—W. L. Evans
 Commissioner Precinct No. 3—E. A. Wilborn
 Commissioner Precinct No. 4—F. C. Matthews

OFFICE OF
W. O. WORK
 COUNTY SURVEYOR
 and
 Licensed State Land Surveyor
 CHAMBERS COUNTY



Anahuac, Texas
 March 27, 1935

Mr. J. H. Walker
 Commissioner, General Land Office
 Austin, Texas.

Dear Sir:

Herewith find the fieldnotes of my survey of Turtle Bay, Chambers County, showing land ties and other points.

The survey was made for the Stanolind Oil and Gas Co. of Fort Worth, Texas and by request of your office.

I am also mailing to you under separate cover a map showing in detail the results of said survey. ^{Chambers} _{Rid. Sk. 12}

I have not as yet computed the acreage until hearing farther from your office as to how you wish same divided.

Yours very truly,

W. O. Work

W. O. Work
 County Surveyor, Chambers Co.
 Licensed State Land Surveyor.

RECEIVED

APR 3 1935

REFERRED TO MAP

counter 43942

Q'

STANOLIND OIL AND GAS COMPANY

712 MAIN STREET
HOUSTON, TEXAS

August 10, 1935

The Commissioner
General Land Office
Austin, Texas

Dear Sir:

Under date of May 21st we furnished you field notes prepared by Mr. W. O. Work concerning his Turtle Bay Survey and captioned "Field Notes Showing the Location and Description of .P2."

Since corrections were found necessary in these notes and in the notes covering tract #40, we are arranging with Mr. Work for the proper recording of those corrections. In this connection, however, he has advised us that all of his records concerning this survey were destroyed with the Courthouse in recent fire and before he can make the proper reference it will be necessary for him to know book and page number in which they were recorded in his office and the date on which he certified to these notes.

If it conforms to the customs of your office, we would appreciate your early advice as to the above data on the notes mentioned in the first paragraph hereof; if not, we would appreciate certified copies of those notes so that we might furnish the necessary information to Mr. Work and complete our arrangements with him for his necessary certificate of correction.

Very truly yours,

Phil. T. Wilkinson
Phil. T. Wilkinson

PTW:rb

*4 sets F/N returned
8/15/35
Blucher*

RECEIVED

AUG 12 1935

REFERRED TO map

counter 43943

R'

Middle Ordinate Survey No 40

1380

L O FORM 25

FORM 2439A-E752-429-2M

Traverse - from line T₁ - P₂ to intersection with southwest line Tract 40.

Station	Bearing	Distance	LATITUDE		DEPARTURE		D. M. D.	DOUBLE AREAS		REMARKS
			North	South	East	West		North	South	
1	N62°56'W	83.2								
2	S80°50'W	190.1		30.3		187.7				
3	N50°45'W	52.2	33.0			40.4				
4	S80°10'W	124.9		21.3		123.1				
5	S12°20'W	81.4		79.5		17.4				
6	N45°50'W	127.1	88.6			91.2				
7	S87°10'W	206.7		10.2		206.4				
8	S75°18'W	657.0		166.7		635.5				
9	S73°44'W	280.2		78.5		269.0				
10										
11			121.6	386.5		1570.7				
12										
13	S65°E	1311.6		554.3	1188.7					
14	N25°E	903.9	819.2		382.0					Middle Ordinate
15										
16			940.8	940.8	1570.7	1570.7				
17										
18										
19										
20	25°	1570.7	1423.5	663.8						
21	25°	264.9	111.9	240.1						
22			1311.6	903.9.0K						
23										
24										
25										
26										
27										

Chambers Co R19 2K #15C

counter 43944 S'

Station	Bearing	Distance	LATITUDE		DEPARTURE		D. M. D.	DOUBLE AREAS		REMARKS
			North	South	East	West		North	South	
1	565°E	1380		583.2	1250.7					
2	N25°E	910	824.7		384.6					
3										
4			824.7	583.2	1635.3					
5										
6	N25°	1570.7								
7	25°	264.9								
8										
9										
10	565°E	1311.6		554.3	1188.7					
11	N25°E	903.9	819.2		382.0					
12		↑								
13			819.2	554.3	1570.7					
14			554.3							
15			264.9							
16										
17										
18										
19										
20										
21										
22										
23										
24										
25										
26										
27										

counter 173945 S²

West Side

Station	Bearing	Distance	LATITUDE		DEPARTURE		D. M. D.	DOUBLE AREAS		REMARKS
			North	South	East	West		North	South	
1	N 62° 56' W	83.2	37.9			74.1				
2	S 80° 50' W	190.1		30.3		187.7				
3	N 50° 45' W	52.2	33.0			40.4				
4	S 80° 10' W	124.9		21.3		123.1				
5	S 12° 20' W	81.4		79.5		17.4				
6	N 45° 50' W	127.1	88.6			91.2				
7	S 87° 10' W	206.7		10.2		206.4				
8	S 75° 18' W	657.0		166.7		635.5				
9	S 73° 44' W	607.7		170.3		583.4				
10	S 62° 21' W	781.2		362.5		692.0				
11	S 24° 34' W	224.6		204.4		93.4				
12	S 3° 45' E	357.5		356.7	23.4					
13	S 41° 56' E	432.0		321.4	288.7					
14	S 14° 25' W	295.6		286.3		73.6				
15	S 44° 13' W	106.2		76.1		74.1				
16	S 0° 06' W	132.7		132.7		0.2				
17	S 43° 12' W	501.7		365.7		343.4				
18	S 6° 50' E	252.0		250.2	30.0					
19	S 2° 28' W	211.3		211.1		9.1				
20	S 45° 54' E	105.0		73.1	75.4					
21	S 61° 40' E	108.6		51.5	95.6					
22	S 83° 14' E	145.1		17.1	144.1					
23	S 25° 40' E	176.0		158.6	76.2					
24	S 63° 48' E	182.9		80.8	164.1					
25	S 35° 11' E	67.3		55.0	38.8					
26	S 42° 11' W	61.9		45.9		41.6				
27	S 5° 27' W	82.9		82.5		7.9				
			159.5	3609.9	936.3	3294.5				

West side

Station	Bearing	Distance	LATITUDE		DEPARTURE		D. M. D.	DOUBLE AREAS		REMARKS
			North	South	East	West		North	South	
			159.5	3609.9	936.3	3294.5				
1	546°36'E	108.2		74.3	78.6					
2	533°28'E	110.8		92.4	61.1					
3	532°42'E	98.9		83.2	53.4					
4	562°11'E	166.4		77.6	147.2					
5	51°29'E	61.2		61.2	1.6					
6	539°35'E	144.9		111.7	92.3					
7	557°49'E	91.1		48.5	77.1					
8	524°08'E	55.1		50.3	22.5					
9	531°21'W	48.1		41.1		25.0				
10	533°37'E	182.4		151.9	101.0					
11	577°06'E	69.8		15.6	68.0					
12	550°50'W	988.4		624.3		766.3				
13	552°25'E	272.4		166.1	215.9					
14	541°44'E	501.1		374.0	333.6					
15	529°21'E	53.3		46.5	26.1					
16	551°46'E	68.4		42.3	53.7					
17	542°18'E	490.7		362.9	330.2					
18	541°58'E	504.0		374.7	337.0					
19	546°22'E	153.7		106.1	111.2					
20	542°17'E	128.7		95.2	86.6					
21	556°E	246.6		137.9	204.4					
22	558°36'E	347.8		181.2	296.9					
23	562°16'E	453.7		211.1	401.6					
24	566°17'W	5022.9		2020.0		4598.8				
25	N55°E	768.6	440.8		679.6					
26	N25°09'E N25°E	945.9 4506.4	8559.5 8615.7		4018.7 4017.6					
27			9159.8		8684.6					
			9216.0	9160.0	8683.5	8684.6				
			9160.0							

Scale Map
730-768 = 38
4975-5023 = 48

N25°08'30"E 9455

557 28 N 20 endman

counter 43947

Sta. A - R = 12 W

L O FORM 25

FORM 2439A-E752-429-2M

Station	Bearing	Distance	LATITUDE		DEPARTURE		D. M. D.	DOUBLE AREAS		REMARKS
			North	South	East	West		North	South	
1	N62°26'30"W	2672.4	1238.0			2372.4				Bag. Sta. A
2	N1°51'W	861.9	861.4			27.8				
3	S52°25'E	272.4		166.1	215.9					
4	S41°44'E	501.1		374.0	333.6					
5	S29°21'E	53.3		46.5	26.1					
6	S51°46'E	68.4		42.3	53.7					
7	S42°18'E	490.7		362.9	330.2					
8	S41°58'E	504.0		374.7	337.0					
9	S46°22'E	153.7		106.1	111.2					
10	S42°17'E	128.7		95.2	86.6					
11	S56°E	246.6		137.9	204.4					
12	S58°36'E	347.8		181.2	296.9					
13	S62°16'E	453.7		211.1	401.6					
14										
15			2099.4	2098.0	2397.2	2400.2				
16										
17				54.4	34.5					
18										
19										
20										
21										
22										
23										
24										
25										
26										
27										

JST + 32 NIS. (D) and (D)

counter 73948

S5

Sta. A-P-R

Station	Bearing	Distance	LATITUDE		DEPARTURE		D. M. D.	DOUBLE AREAS		REMARKS
			North	South	East	West		North	South	
1	566°17'W	5022.9		2020.0		4598.8				Bag. Sta. A
2	N34°24'E	3946.6	3256.4		2229.7					
3	562°26'30"E	2672.4		1238.0	2372.4					
4										
5			3256.4	3258.0	4602.1	4598.8				
6				3256.4	4598.8					
7				1.6	3.3					
8										
9										
10										
11										
12										
13										
14										
15										
16										
17										
18										
19										
20										
21										
22										
23										
24										
25										
26										
27										

Chambers R.R. & Co. Inc.

counter 43949 S⁶

Sta. P-X₁-Z₂-P₃-P₂

L O FORM 25

FORM 2439A-E752-429-2M

Station	Bearing	Distance	LATITUDE		DEPARTURE		D. M. D.	DOUBLE AREAS		REMARKS
			North	South	East	West		North	South	
1	N25°E	5859.7	5310.7		2476.4					Bag. of P
2	S32°42'E	12.9		10.9	7.0					
3	S62°11'E	166.4		77.6	147.2					
4	S1°29'E	61.2		61.2	1.6					
5	S39°35'E	144.9		111.7	92.3					
6	S57°47'E	91.1		48.5	77.1					
7	S24°08'E	35.7		32.6	14.6					
8	S25°W	5099.8		4622.0		2155.3				
9	N16°50'W	101.9	95.5			29.5				
10	S55°W	768.6		440.8		629.6				
11										
12			5406.2	5405.3	2816.2	2814.4				
13										
14										
15										
16										
17										
18										
19										
20										
21										
22										
23										
24										
25										
26										
27										

274.3
 289.1
 35.7
 .36
 2142
 1071
 12852

Chapman Co. Sta. #152

counter 43950 S⁷

Sta. 64-65-etc-96

L O FORM 25

FORM 2439A-E752-429-2M

Sh. 1 of 2

Station	Bearing	Distance	LATITUDE		DEPARTURE		D. M. D.	DOUBLE AREAS		REMARKS
			North	South	East	West		North	South	
1	575°18'W	657.0		166.7		635.5				Bag. at Sta. 64
2	573°44'W	607.7		170.3		583.4				
3	562°21'W	781.2		362.5		692.0				
4	524°34'W	224.6		204.4		93.4				
5	53°45'E	357.5		356.7	23.4					
6	541°56'E	432.0		321.4	288.7					
7	514°25'W	295.6		286.3		73.6				
8	544°13'W	106.2		76.1		74.1				
9	50°06'W	132.7		132.7		0.2				
10	543°12'W	501.7		365.7		343.4				
11	56°50'E	252.0		250.2	30.0					
12	52°28'W	211.3		211.1		9.1				
13	545°54'E	105.0		73.1	75.4					
14	561°40'E	108.6		51.5	75.6					
15	583°14'E	145.1		17.1	144.1					
16	525°40'E	176.0		158.6	76.2					
17	563°48'E	182.9		80.8	164.1					
18	535°11'E	67.3		55.0	38.8					
19	542°11'W	61.9		45.9		41.6				
20	55°27'W	82.9		82.5		7.9				
21	546°36'E	108.2		74.3	78.6					
22	533°28'E	110.8		92.4	61.1					
23	532°42'E	98.9		83.2	53.4					
24	562°11'E	166.4		77.6	147.2					
25	51°29'E	61.2		61.2	1.6					
26	539°35'E	144.9		111.7	92.3					
27	557°47'E	91.1		48.5	77.1					
				4017.5	1447.6	2554.2				

counter 43951

58

Sta. 64-65-etc-96

L O FORM 25

FORM 2439A-E752-429-2M

sh. 2 of 2

Station	Bearing	Distance	LATITUDE		DEPARTURE		D. M. D.	DOUBLE AREAS		REMARKS
			North	South	East	West		North	South	
1	524°08'E · 55.1			4017.5	1447.6	2554.2				
2	531°21'W · 48.1			50.3	22.5					
3	533°37'E · 182.4			41.1		25.0				
4	577°06'E · 69.8			151.9	101.0					
5	N12°24'E 4378.1		4276.0			68.0				
6					940.1					
7			4276.0	4276.4	2579.2	2579.2				
8										
9										
10										
11										
12										
13										
14										
15										
16										
17										
18										
19										
20										
21										
22										
23										
24										
25										

counter 93952

59

Chambers Co. R.R. #150

Sta. 96 to Sta. 9

Station	Bearing	Distance	LATITUDE		DEPARTURE		D. M. D.	DOUBLE AREAS		REMARKS
			North	South	East	West		North	South	
1	(N69°56'W)	3532.5	(1212.0)			(3318.1)				Beg. at Sta. 9
	N69°24'W	3526.0	1240.6			3300.6				
2	550°50'W	988.4		624.3		766.3				
3	552°25'E	272.4		166.1	215.9					
4	541°44'E	501.1		374.0	333.6					
5	529°21'E	53.3		46.5	26.1					
6	551°46'E	68.4		42.3	53.7					
7	542°18'E	490.7		362.9	330.2					
8	541°58'E	504.0		374.7	337.0					
9	546°22'E	153.7		106.1	111.2					
10	542°17'E	128.7		95.2	86.6					
11	556°E	246.6		137.9	204.4					
12	558°36'E	347.8		181.2	296.9					Sta. A
13	N45°21'E	92.9	65.3		66.1					
14	N89°51'E	396.0	1.0		396.0					
15	N88°07'E	396.0	13.0		395.8					
16	N88°18'E	464.4	13.8		464.2					
17	N1°53'W	876.2	875.7			28.8				
18	589°49'E	383.4		1.2	383.4					
19	N38°53'E	545.4	424.6		342.4					
20	N69°53'W	252.0	86.7			236.6				
21	N88°19'W	113.3	3.3			113.2				
22	N32°41'E	33.8	28.4		18.2					
23	562°16'E	453.7		211.1	401.6					
24										
25			2752.4	2723.5	4463.3	4445.5				
26			(2723.8)			(4463.0)				
27										

Chambers Co. Eng. 150

counter 43953

3480

510

Sh. 1 of 3

East Side

Traverse Point T₁ to Point P₂

Station	Bearing	Distance	LATITUDE		DEPARTURE		D. M. D.	DOUBLE AREAS		REMARKS
			North	South	East	West		North	South	
1	525°09'W 525°W	9455.9 9506.4		8559.5 8615.7		4018.7 4017.6				
2	555°W	768.6		440.8		629.6				
3	N66°17'12"E	5022.9	2020.0		4598.8					
4	N45°21'E	92.9	65.3		66.1					Sta. A
5	N89°51'E	396.0	1.0		396.0					
6	N88°07'E	396.0	13.0		395.8					
7	N88°18'E	464.4	13.8		464.2					
8	N1°53'W	876.2	875.7			28.8				
9	S89°49'E	383.4		1.2	383.4					
10	N38°53'E	545.4	424.6		342.4					
11	N69°53'W	252.0	86.7			236.6				
12	N88°19'W	113.3	3.3			113.2				
13	N32°41'E	33.8	28.4		18.2					
14	N79°20'E	58.0	10.7		57.0					
15	N49°17'E	108.0	70.4		81.8					
16	N35°06'E	65.2	53.3		37.4					
17	N26°10'E	94.0	84.4		41.4					
18	N30°26'E	175.0	150.9		88.6					
19	N24°57'E	96.8	87.8		40.8					
20	N43°09'E	129.7	94.6		88.6					
21	N35°02'E	219.2	179.5		125.8					
22	N31°35'E	81.0	69.0		42.4					
23	N28°46'E	131.4	115.2		63.2					
24	N34°14'E	77.0	63.7		43.3					
25	N36°27'E	85.0	68.4		50.5					
26	N30°44'E	223.2	191.8		114.1					
27	N33°06'E	190.8	159.8		104.2					
			4931.3	9057.7	7644.0	5025.8				
				9001.5		5026.9				

9510 42 119 of 220m 19

counter 43954

S''

East Side

Station	Bearing	Distance	LATITUDE		DEPARTURE		D. M. D.	DOUBLE AREAS		REMARKS
			North	South	East	West		North	South	
			4931.3	9057.7 9001.5	7644.0	5025.8 5026.9				
1	N20°46'E	160.2	149.8		56.8					
2	N54°02'E	88.2	51.8		71.4					
3	N33°38'E	304.9	253.9		168.9					
4	N23°56'E	83.2	76.0		33.8					
5	N25°E	244.7	221.8		103.4					
6	N7°06'E	160.9	159.7		19.9					
7	N11°42'W	242.6	237.6			49.2				
8	N23°51'E	260.3	238.1		105.2					
9	N7°54'E	335.2	332.0		46.1					
10	N3°27'W	234.7	234.3			14.1				
11	N15°15'W	310.0	299.1			81.5				
12	N34°40'W	277.9	228.6			158.1				
13	N35°45'W	363.2	294.8			212.2				
14	N47°17'W	370.1	251.1			271.9				
15	N40°51'W	177.8	134.5			116.3				
16	N53°36'W	139.3	82.7			112.1				
17	N44°03'W	101.9	73.2			70.8				
18	N63°08'W	289.9	131.0			258.6				
19	N63°59'W	115.3	50.6			103.6				
20	N61°14'W	136.8	65.8			119.9				
21	N76°29'W	119.5	27.9			116.2				
22	N66°40'W	132.5	52.5			121.7				
23	S75°07'W	169.9		43.6		164.2				
24	N6°57'E	94.3	93.6		11.4					
25	N6°36'W	116.2	115.4			13.3				
26	N4°13'W	45.0	44.9			3.3				
27	N47°09'W	86.4	58.8			63.3				
			8890.8	9101.3 9046.1	8260.9	7076.1 7077.2				

East Side

Station	Bearing	Distance	LATITUDE		DEPARTURE		D. M. D.	DOUBLE AREAS		REMARKS
			North	South	East	West		North	South	
			8890.8	9101.3 9045.1	8260.9	7076.1 7077.2				
1	575°40'W	139.0		34.4		134.7				
2	584°22'W	179.6		17.6		178.7				
3	583°05'W	146.9		17.7		145.8				
4	N78°57'W	146.5	20.1			143.8				
5	N85°15'W	151.2	12.5			150.7				
6	N73°10'W	181.1	52.4			173.3				
7	N62°56'W	288.7	131.4			257.1				
8				9114.8		8261.3				
9			9115.2	9171.0	8260.9	8261.2				
10				9115.2		8260.9				
11				55.8		0.5				
12				0.4		1.4				
13										
14										
15										
16										
17										
18										
19										
20										
21										
22										
23										
24										
25										
26										
27										

Sta. T₂-58-59-etc.-91-Z₂

L O FORM 25

Sh. 2 of 2

Station	Bearing	Distance	LATITUDE		DEPARTURE		D. M. D.	DOUBLE AREAS		REMARKS
			North	South	East	West		North	South	
			190.4	3609.9	936.3	3355.0				
1	546°36'E	108.2		74.3	78.6					
2	533°28'E	110.8		92.4	61.1					
3	532°42'E	98.9		83.2	53.4					
4	562°11'E	166.4		77.6	147.2					
5	51°29'E	61.2		61.2	1.6					
6	539°35'E	144.9		111.7	92.3					
7	557°47'E	91.1		48.5	77.1					
8	524°08'E	35.7		32.6	14.6					
9	N25°E	4480.1	4060.3		1893.4					
10										
11			4250.7	4191.4	3355.6	3355.0				
12			4191.4							
13			59.3							
14										
15										
16										
17										
18										
19										
20										
21										
22										
23										
24										
25										
26										
27										

counter 43958

S¹⁵

760

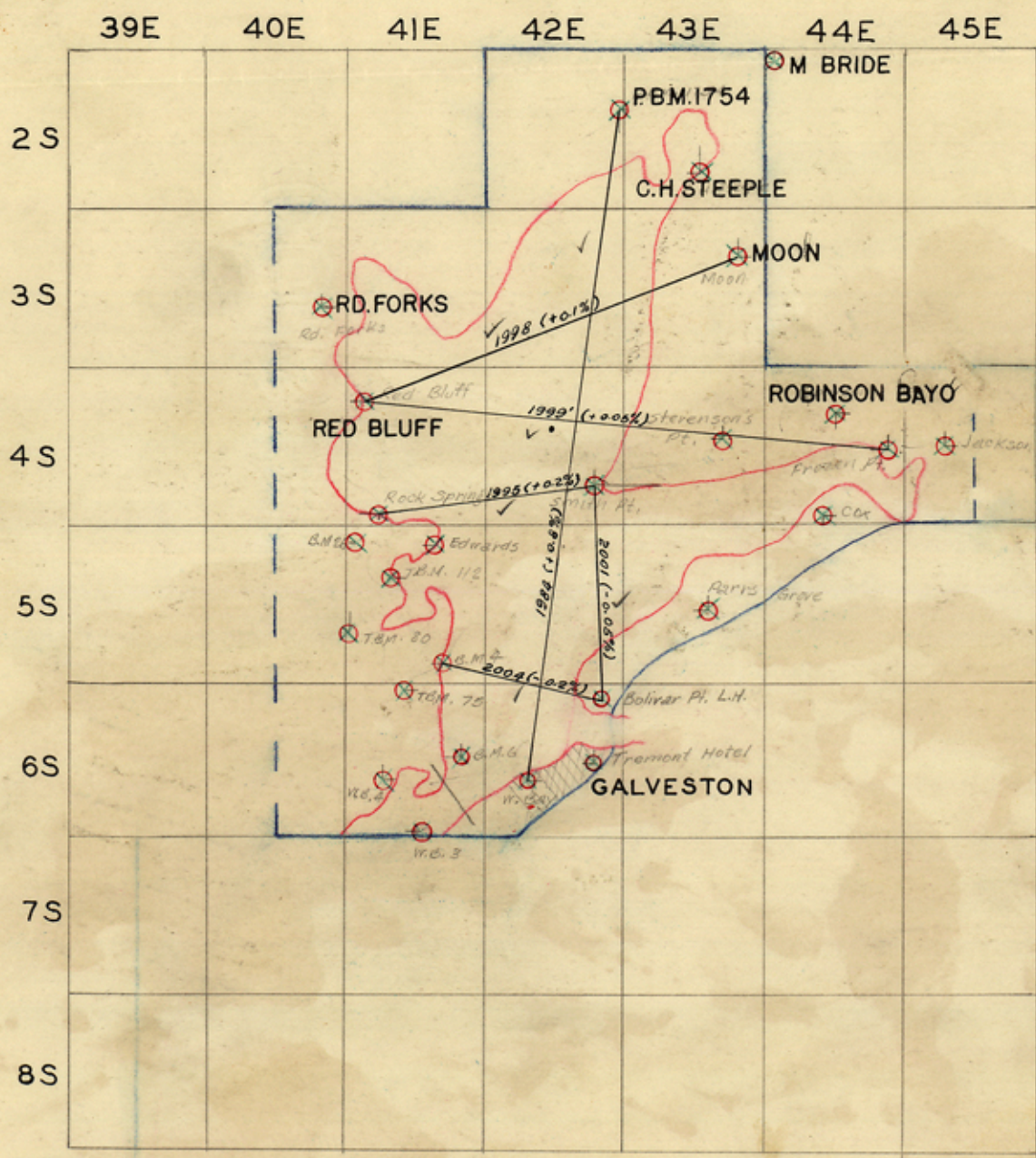

Computed Dist. ft.
 Scaled (Map) Dist. inches
 Map scale

BOLIVAR POINT B.M. 4	44511' - 22.21" = 2004
SMITH POINT BOLIVAR POINT	58010' - 28.99" = 2001
RED BLUFF MOON	11909' - 59.09" = 1998.4
FROZEN POINT RED BLUFF	148014' - 7403" = 1999
1754 WEST BAY	197883' - 99.75" = 1984
SMITH POINT ROCK SPRINGS	65607' - 32.89" = 1995

From Tobin in
 connection with
 large aerial photo
 of Galveston Bay Area
 P.M. Gale Jr.
 G.J. Groos

counter 43959

516

35+32.813 (2) end (10)

HOWE & WISE
CIVIL ENGINEERS
MEMBERS AM. SOC. C. E.

*Place with
Howe's Tracing
of Galveston Bay
Municipal Area*

5025
RECEIVED

JAN 11 1936

REFERRED TO MAP

SCANLAN BUILDING
HOUSTON, TEXAS
January 10, 1936

State Land Commissioner
Austin, Texas

Re: Galveston Bay Lease Map
Attention: Mr. Blucher

Dear Sir:

We lost the first three days of the week on account of the weather making distant observations impossible.

We have checked the relative geographical positions of the Red Bluff and Parr's Grove Beacons and find that they are 113460 feet apart on a course of South 55 degrees 58 minutes 59.17 seconds East. That the scaled distance between these monuments on the 1500 varas map is considerably less than this.

Scaling the Lease Map for course shows that the line running from the Southwest corner of Section 216 Southeast toward Parr's Grove has a bearing of South 57 degrees 28 minutes East.

The above is based upon using Parr's Grove Beacon as the origin and converting geographical positions into plane coordinates.

We assume that you desire to follow the Lease Map as closely as possible so we are using the line from Red Bluff to just North of Parr's Grove as a base line with a course of South 57 degrees 28 minutes East and placing the line between Sections 222 and 223 at right angles thereto. This will place the Northeast line of the Galveston Bay Sections out of parallel with the Southwest line of the Trinity Bay Sections. Just how much out of parallel it will be we can not tell until the field work at Anahuac is completed which should be to-night.

The lease map on which the Trinity Bay Leases were made calls for the middle line to be North 25 degrees 25 Minutes East. This is so palpably in error that we assume that it will be corrected as being a magnetic course and the line given a course of North 33 degrees 30 minutes East. If this is done then the Southwest line of these Trinity Bay Sections would have a course of South 56 $\frac{1}{2}$ East against the Galveston Bay sections with South 57 degrees 28 minutes East.

A difference of one degree in the course of a line 21 miles long will move the far end of it 1900 feet, so, if we hold to the Southwest corner of Section 216 and swing what is

A

counter 43960

S17

Page #2

now the South 57 degrees 28 minutes East line to South 56 $\frac{1}{2}$ East we will be about 1900 feet out of scale on the Lease Map at the Parr Grove Beacon.

We are laying the Galveston Bay Sections parallel and perpendicular to the South 57 degrees 28 minutes East line and also tying Smith Point and Red Fish Light to this grid.

If this does not conform to your ideas as to how it should be handled we would appreciate a letter of instructions by return mail.

Yours very truly,

Howe & Main

JMH/cbw

*Please send me another copy of
the 1500 scale map of Galveston Bay*

*Received in General Land Office
on January 11th, 1936.
C.F. Blucher*

A'

counter 43961

S¹⁸

November 15, 1935

Humble Oil & Refining Co.,
Houston, Texas

Attn: Civil Engineering department

Gentlemen:

Mr A L Young of your department was in the office today looking into the matter of areas in Turtle Bay in Chambers county, which have been leased for mineral purposes. He requested that I write you in reference to the plan adopted by this department in determining the positions of these tidal areas covered by mineral leases.

Mr Young has ordered copies of the reports and sketch by Mr W O Work, county surveyor of Chambers county, who made a survey of the premises. I believe that this data will show clearly the procedure followed for the location of the boundaries of these tidal areas.

Tract 40, which was leased to the Stanolind Oil & Gas Company, lies next to the North shore line of Turtle Bay, is the Northernmost of this group of areas, and the area was computed to contain approximately 770 acres.

each
The next ²⁴ 5 tracts Southward were given a width of half a mile ~~each~~; the next 2 South of that were made three-fourths of a mile wide each. The next 2 tracts South, being 33 and 32, were given half a mile width each.

It was computed that this line will cross the Delta of the Trinity River very close to its mouth, and that point was arbitrarily fixed as a point of origin or beginning for all tidal areas offered for mineral development.

The Stanolind Oil & Gas Company employed Mr Work to do considerable surveying to locate their leases. The point of origin above referred to was located near the mouth of the river at the correct distance from the South line of tract 40 to conform with the construction given by this department. On Mr Work's sketch and reports this point of origin is referred to as the point P₂, and a line projected therefrom South 25° West.

F
Chambers Co. R.R. & 150

counter 43962

S19

I believe this will give you all the information which you desire. If it does not, you should feel free to call upon me for further data.

Very truly yours,

Commissioner

Blucher:eb

-1
†

Chambers Co. 519 SR #12C

counter 43963

520

1927
140

April 5, 1935

The Stanolind Oil & Gas Co.,
Fair Bldg., Fort Worth, Texas.

Attn: Mr Phil Wilkerson

Gentlemen:

Under date of April 3rd this department received from Mr W O Work, county surveyor of Chambers county, Texas a map and field notes of meanders and connections along Turtle Bay in that county.

The purpose in submitting this map and field notes is to determine the positions of certain areas in Turtle Bay on which mineral leases were recently issued. A point on the delta at the mouth of the Trinity River was arbitrarily chosen from which to locate these tracts, as shown on the sketch accompanying the advertisement for lease of these areas. This point was determined from a reference to information taken from the U. S. Coast & Geodetic chart showing the area in question.

Mr Phil Wilkerson and Mr Seelig of your Company were in the office on March 3rd and this matter was discussed with them. After considering Mr Work's map, it is concluded that the point P-2 shown thereon, conforms to the position intended for the common corner of tracts 29-30-31-32, as shown on the General Land Office map accompanying advertisement of these areas for lease.

Very truly yours,

Commissioner

Blucher:eb

F² Chambers Co. 219 SK #15C

counter 43964

S²¹

1934
255-

May 30, 1935

Stanolind Oil & Gas Co.,
Fair Bldg., Dallas, Texas

Attn: Mr Phil Wilkerson

Gentlemen:

I am sending you copy of office traverses of the meanders and lines run along the shore and thru the waters of Tuttle Bay in Chambers county, in connection with the 4 mineral leases, which the Stanolind acquired in that area.

It appears that there may be a few errors in this work, and in order that you may check the calculations, I send these copies. Inasmuch as the purpose of calculations here was merely to check the work already done, the computations were not worked out any closer than the nearest minute, or the nearest tenth of a vara. I would like to ask that you check these computations against your own, in order that we may determine where the difference is.

If it becomes necessary to make any changes in the field notes, or in the position of the point P-2, this may be done since the point P-2 is an arbitrarily chosen point, and its position may vary slightly within certain limits, of course, to fit the conditions on the ground, the main point being that the South line of the "770" acre tract be the correct distance from the point of origin: P-2.

Very truly yours,

Commissioner

Blucher:eb
oncs

counter 43965 S²²

4294

STANOLIND OIL AND GAS COMPANY

FAIR BUILDING
FORT WORTH, TEXAS

May 6, 1935.

RECEIVED

MAY 7 - 1935

REFERRED TO *M. M. M. M.*

The Commissioner,
General Land Office,
Austin, Texas.

Dear Sir:

We are furnishing you herewith field notes of those tracts in Turtle Bay, Chambers County, numbered 37, 38, 39, and 40 which, according to your files are known as State Leases numbered 18904, 18903, 18905 and 18906 respectively.

These surveys were made and the field notes were prepared by Mr. W. O. Work, County Surveyor of Chambers County, who was commissioned to make the surveys by this company, as lessee, upon your recommendation.

The tracts were laid out in accordance with the map accompanying the advertisement of these tracts and your letter of instructions dated April 5th, 1935, wherein you authorized the use of point "P-2", previously established by Mr. Work, as the common corner of tracts numbered 29, 30, 31 and 32 and shown on the map above mentioned.

The notes being furnished contain such calls and references as will definitely locate them and tie them to the work previously submitted by Mr. Work, by which he established the meanders of Turtle Bay, the point "P-2" and the relationship between them.

At the same time that the tract lines were established the point "P-2" was more permanently marked and referenced and we are requesting Mr. Work to furnish you a description of this point to supplement the information that has gone before.

We trust you will find this information sufficient and in accordance with your requirements, and we will appreciate your advice to that effect. We will also be pleased to supplement or correct it, in any way you deem necessary, upon your request.

Very truly yours,

STANOLIND OIL AND GAS COMPANY

By

Phil T. Wilkinson
Phil T. Wilkinson

PTW/s

F4

counter 43966

S23



Va. Pt.

From Taken in connection
with large aerial photo
of Galveston Bay Area

G U L F O F M E X

Survey No 37

L O FORM 25

FORM 2439A-E752-429-2M

Station	Bearing	Distance	LATITUDE		DEPARTURE		D. M. D.	DOUBLE AREAS		REMARKS
			North	South	East	West		North	South	
1	S30°44'W	193.1 -		166.0		98.7	98.7		16384	
2	S36°27'W	85.0		68.4		50.5	247.9		16956	
3	S34°14'W	77.0		63.7		43.3	341.7		21766	
4	S28°46'W	131.4		115.2		63.2	448.2		51633	
5	S31°35'W	81.0		69.0		42.4	553.8		38212	
6	S35°02'W	219.2		179.5		125.8	722.0		129599	
7	S43°09'W	129.7		94.6		88.6	936A		88583	
8	S24°57'W	48.2 -		43.7		20.3	1045.3		45680	
9	N65°00'W	5366.4 -	2267.9			4863.6	5929.2	13446833		
10	N2°28'E	113.8 -	113.7		4.9		10787.9	1226584		
11	N6°50'W	252.0	250.2			30.0	10813.0	2705413		
12	N43°12'E	501.7	365.7		343.4		10499.6	3839704		
13	N0°06'E	132.7	132.7		0.2		10156.0	1347701		
14	N44°13'E	36.3	26.0		25.3		10130.5	263393		
15	S65°00'E	5575.1		2356.1	5052.7		5052.6		11904431	
16										
17			3156.2	3156.2	5426.5	5426.4		22829628	12313244	
18					4			12313244		
19								2110516384		
20								5645.415258192		
21								931.41		
22										
23										
24										
25										
26										
27										

Chambers Co. Ed. 84-15C

Counter 43968

S²⁵

Survey No 38

Station	Bearing	Distance	LATITUDE		DEPARTURE		D. M. D.	DOUBLE AREAS		REMARKS
			North	South	East	West		North	South	
1	5.25°00'W	110.0		99.7		46.5	46.5		4636	
2	5.23°56'W	83.2		76.0		33.8	126.8		9637	
3	5.33°38'W	304.9		233.9		168.9	329.5		83660	
4	554°02'W	88.2		51.8		71.4	569.8		29516	
5	520°46'W	160.2		149.8		56.8	698.0		104560	
6	533°06'W	190.8		159.8		104.2	859.0		137268	
7	530°44'W	30.1		25.9		15.4	978.6		25346	
8	N65°00'W	5575.1	2356.1			5052.7	6046.7	14246630		
9	N44°13'E	69.9	50.1		48.8		11050.6	553625		
10	N14°25'E	295.6	286.3		73.6		10928.2	3128744		
11	N41°56'W	432.0	321.4			288.7	11143.3	3581457		
12	N3°45'W	357.5	356.7			23.4	11455.4	4086141		
13	N24°34'E	111.2	101.1		46.2		11432.6	1155836		
14	565°00'E	6281.7		2654.8	5693.2		5693.2		15114307	
15										
16			3471.7	3471.7	5861.8	5861.8		26752443	15508930	
17								15508930		
18								211243513		
19								5645.4 5621756		
20								99581		
21										
22										
23										
24										
25										
26										
27										

Crawford Co. 150 210 210 210

counter 43969

S26

Survey No. 39

L O FORM 25

FORM 2439A-E752-429-2M

Station	Bearing	Distance	LATITUDE		DEPARTURE		D. M. D.	DOUBLE AREAS		REMARKS
			North	South	East	West		North	South	
1	57°54'W	217.4		215.3		29.9	29.9		6437	
2	523°51'W	260.3		238.1		105.2	165.0		39286	
3	511°42'E	242.6		237.6	49.2		221.0		52510	
4	57°06'W	160.9		159.7		19.9	191.7		30614	
5	525°00'W	134.7		122.1		56.9	268.5		32757	
6	N65°00'W	6281.7	2654.8			5693.0	6018.4	15977648		
7	N24°34'E	113.4	103.2		47.0		11664.4	1203766		
8	N62°21'E	781.2	362.5		692.0		10925.4	3960457		
9	N73°44'E	327.5	91.7		314.4		9919.0	909570		
10	565°00'E	5298.8		2239.4	4802.3		4802.3		10754271	
11										
12			3212.2	3212.2	5904.9	5904.9		22051441	10915875	
13								10915875		
14								2 11135566		
15								5645.4 5567783		
16								986.25		
17										
18										
19										
20										
21										
22										
23										
24										
25										
26										
27										

counter 43970

527

STANOLIND OIL AND GAS COMPANY

FAIR BUILDING
FORT WORTH, TEXAS

June 19, 1935.

RECEIVED

JUN 21 1935

Honorable J. H. Walker, Commissioner,
General Land Office
Austin, Texas.

REFERRED TO MAP

Attention: Mr. Blucher

Dear Sir:

We beg to acknowledge receipt of your letter of the 30th ultimo in which you sent us copies of your office traverses of the meanders run on Turtle Bay for us in Chambers County, Texas, by Mr. W. O. Work, County Surveyor in connection with the four mineral leases acquired by the company in that area.

We have to advise that we have checked your computations referred to against our own and find that there was an error in the total distance T₁-P₂, as calculated and as referred to in the general field notes filed in your office of the Turtle Bay Survey and in those of the topmost tract No. 40, requiring the corrections following:

(The notes of Tract No. 40, last call, page one) should read:
" N 62 deg. 56' W 288.74 varas to a 1-1/4" iron pipe in the ground from which the southwest corner of Tract No. 32 known as Point P₂ bears S 25 deg. 09' W 9455.94 varas and a cypress tree 15 inches in dia. marked "Z" bears N 68 deg. 50' W 38.2" varas".

(The notes of Tract No. 40, first call at top of page two) should read:
"N 62 deg. 56' W at 24.8 varas passing the extremity of a line N 25 deg 00' E from the said point P₂ and 9456.78 varas distant therefrom and 83.21 varas, all told, to station No. 58 of these meanders,"

(The notes " showing the location and description of Point P₂", last clause, fourth paragraph, page one) should read:
", known as Point T₁ of this survey bears N 25 deg. 09' E 9455.94 varas;"

6 2 7 5
6 1 1

y

6-29-35

counter 43971

S28

-2-

We also have to advise that we have discovered another error, requiring the corrections following:

(On the map filed and in the general notes)

The bearing of the Anahuac Base Line A-B should read "S1 deg. 33' E and likewise the same bearing where given in line four third paragraph of the general notes of the meanders of the shore line should read "S 1 deg. 33' E (instead of S 1 deg. 33' W as given in error in both instances.)

Our check of your computations and recheck of our own reassures us that there was nothing fundamentally wrong with the work that was done on the ground. We find also that the south lines of tracts 37, 38, 39 and 40, are the proper distance from point P2 along a line N 25° 0' East within very reasonable limits.

We regret that these errors have crept into this work and thank you for your check in calling our attention to them. It occurs to us that you may wish a certificate of correction from Mr. W. O. Work in order to clear your records and if you will advise us that such certificate is desired, we will arrange with Mr. Work to have it furnished you. If, after you review, you find this information sufficient, we would greatly appreciate your advice to that effect.

Very truly yours,

STANOLIND OIL AND GAS COMPANY

By

Phil T. Wilkinson
Phil T. Wilkinson

PTW:t

Y'
+

counter 43972

S 29

Re: Map of Galveston and East Bays and Gulf of Mexico for mineral leasings to be made on January 22, 1936.

Gentlemen:

The copy of the above map which I sent you did not show the course of the line that extends from the Southwest corner of Survey No. 216 across Galveston Bay. Starting from the Southwest corner of Survey No. 216, this line runs a course South $57^{\circ} 30'$ East. The other lines constructed for the surveys offered for leasing are parallel or perpendicular (as the case may be) to this line. The tier of surveys numbered which make connection with the South line of the outstanding Trinity Bay leases will contain more or less the acreage shown for them.

Very truly yours,

Proposed circular letter by Judge Wharton in connection with Galveston Bay Area - Municipal Development
Was not used.
Blushes

STANOLIND OIL AND GAS COMPANY

2416

FAIR BUILDING
FORT WORTH, TEXAS

May 21, 1935.

Commissioner,
General Land Office,
Austin, Texas.

Dear Sir:

We are furnishing you herewith field notes covering the ties and references surrounding the point P2 from which tracts Nos. 37, 38, 39 and 40 of Turtle Bay were fixed in accordance with field notes furnished you under date of May 6th.

These notes were furnished us by Mr. W. O. Work in accordance with our request and as outlined in the next to the last paragraph of our letter addressed to you forwarding the notes above described.

We trust that the information furnished herewith will complete the necessary surveys covering those tracts leased to this Company by the State, and we will appreciate your advice that this information and what has gone before will be sufficient.

Yours very truly,

STANOLIND OIL AND GAS COMPANY

By

Phil T. Wilkinson
Phil T. Wilkinson

encl
PTW/s

RECEIVED

MAY 22 1935

REFERRED TO MINERALS

Accompanies report filed 4/3/35

counter 43974

531

1936
426

June 29, 1935

Stanolind Oil & Gas Co.,
Fair Bldg.,
Fort Worth, Texas

Attn: Mr Phil T Wilkinson

Gentlemen:

In reply to your letter of June 19th reciting corrections to be made in field notes and sketches of meanders along and across Turtle Bay in Chambers county, I shall state that I have checked these corrections and find them all right.

Before they can be applied to the field notes and sketch by Mr Work of these meanders, as well as to the field notes of the four tidal areas upon which the Stanolind Oil & Gas Company has received mineral leases, it will be necessary to have the surveyor's certificate of correction, authorizing this department to make the necessary alterations, said certificate reciting also that the records of the surveyor's office of Chambers county have been corrected to conform.

If you will have this done, I shall be glad to go into the matter and give it my attention as soon as this certificate is received.

Very truly yours,

Commissioner

Blucher:eb

Counter 43975

532

September 27, 1938

Stanolind Oil & Gas Company
P. O. Box 3092
Houston, Texas

Attention: Mr. Phil T. Wilkinson

Gentlemen:

We were finally able to locate
our correspondence and information concern-
ing point P 2, and the tracts in Turtle and
Trinity Bays.

Thank you very much for your kind
assistance in this matter.

Very truly yours

Commissioner

JOB :lm

STANOLIND OIL AND GAS COMPANY

P. O. Box 3092
Houston, Texas

September 26, 1938

257
RECEIVED

SEP 27 1938

Commissioner
General Land Office,
AUSTIN, T e x a s.

REFERRED TO MAP

Dear Sir:

We have your letter of September 22nd, relative to your correspondence concerning the point P-2, being the origin of the tracts in Turtle and Trinity Bays.

The letter from your office accepting the point P-2, as established by Mr. W. O. Work and designating it as the common corner of Tracts 29, 30, 31, and 32, was addressed to Stanolind Oil and Gas Company, attention: P. T. Wilkinson, and dated April 5, 1935. We find that the original of this letter was transmitted to our Tulsa Office for their files, and should you be unable to locate your copy, we will be pleased to furnish you a photostat of the original if necessary and desired.

Relative also to this point and of interest to all parties having tracts based on this origin, you were furnished under date of May 21, 1935, field note description of the point P-2 made by W. O. Work and dated May 7, 1935. Also, on August 20, 1935, we forwarded the Certificate of Correction made by W. O. Work and dated August 8, 1935, covering necessary corrections in the description of Tract 40 and in the description of the point P-2.

Our correspondence from you on this subject does not bear any file number, and aside from the data furnished above, we are unable to furnish further definite clue as to where the information may be found. We suggest, however, that, since the point P-2 was in a measure dependent upon the location of Tract 40 in the northern extremity of Turtle Bay, you might find the information in the lease file on that tract.

Should you still be unable to locate the desired information, we will be pleased to assist further in any other way that you might wish.

Very truly yours,

STANOLIND OIL AND GAS COMPANY

By:

Phil. T. Wilkinson
Phil. T. Wilkinson

PTW:BJ

counter 43977

534

5237

STANOLIND OIL AND GAS COMPANY

Houston, Texas
August 20, 1935

RECEIVED

AUG 22 1935

REFERRED TO *Hammer*

The Commissioner
General Land Office
Austin, Texas

Dear Sir:

I am returning herewith the field notes of Tracts 37-38-39 & 40, being respectively State Leases Nos. 18904-18903-18905-18906.

Those notes covering Tract No. 40 were the only ones in this group requiring correction and I have caused these corrections to be made.

I am also furnishing herewith Mr. Work's certificate of correction properly executed and recorded in his office, showing not only the correction made in the field notes of Tract 40 but also the correction to be made in those field notes showing the location and description of point P2 which he recorded in Book L, Pgs. 2 and 3, and the field notes of the meanders of the shoreline of Turtle Bay which he recorded in Book 2, Pg. 462 of his records.

You have previously been furnished the last two named sets of field notes although you did not return them to me for correction, and I trust that Mr. Work's certificate of correction furnished herewith will permit you to make the necessary corrections and to advise us that the information you now have is sufficient and proper.

Very truly yours,

STANOLIND OIL AND GAS COMPANY

By

Phil. T. Wilkinson
Phil. T. Wilkinson

PTW:rb

*Wannum filed
8/22/35
Blush*

counter 43978

S 35

2464

Chambers County Officials

County Judge—Guy C. Jackson, Jr.
 County and District Clerk—A. L. Scherer
 Sheriff and Tax Collector—W. R. Sherman
 Tax Assessor—C. G. Mendenhall
 County Treasurer—Grover C. Willcox
 County Attorney—Geo. B. Darden
 County Surveyor—W. O. Work
 Commissioner Precinct No. 1—Dale LaFour
 Commissioner Precinct No. 2—W. L. Evans
 Commissioner Precinct No. 3—E. A. Wilborn
 Commissioner Precinct No. 4—F. C. Matthews

OFFICE OF
W. O. WORK
 COUNTY SURVEYOR
 and
 Licensed State Land Surveyor
 CHAMBERS COUNTY



Anahuac, Texas

Apr. 24th '35

Meanders of Turtle Bay
Chambers Co., T e x a s.

Hon. J. H. Walker,
 Commr. General Ld. Office
 Austin, T e x a s.

Dear Sir:

I have noticed that the draftsman who traced the Turtle Bay map for me transposed some figures; that is he showed the distance from the Point P to X1 as 16726.90 ft (and 6021.68 varas) when it should have read 16,276.90 ft. (and 5859.68 varas) instead.

Will you please make this correction on the map of this Survey filed with you a few weeks ago?

Yours truly,

Corrections applied.

W. O. Work
 County Surveyor and
 Licensed State Land
 Surveyor Chambers Co., Tex.

RECEIVED

APR 25 1935

REFERRED TO MAP

Acknowledged

4-26-35

Blucher

counters 43979

536

1940
581

General Land Office

State of Texas

Austin



J. H. WALKER, COMMISSIONER
S. S. SAYERS, CHIEF CLERK
J. W. HAWKINS

August 15, 1935

Stanoling Oil & Gas Co.,
712 Main Street,
Houston,
Texas.

Dear Sirs:

Your letter of August 9th asking for a copy of the J. A. Greene sketch No. 19, Chambers County sketch file has had my attention and blue print thereof sent to you under date of August 13th.

I might state for your information that there is a reported connecting line by Greene showing connections run by him. These connections show in light colors on the print as they appear in red ink on the original.

I also acknowledge receipt of your letter of August 10th referring to the matter of corrected field notes for mineral leases of Tidal areas in Turtle Bay, Chambers County which field notes have been before this department for some time and about which I wrote you some time ago.

It appears that the court house records were burned in a recent fire and that Mr. W. O. Work, the surveyor, would like references to the county surveyor's records where these field notes are recorded. These field notes were received May 7, 1935 but have not as yet been filed. They are four tracts, Nos. 37, 38, 39 and 40 comprised respectively in State leases Nos. 18904, 18903, 18905 and 18906. It will probably be more convenient for Mr. Work if he makes the changes referred to on these field notes as well as in his records. I am therefore, enclosing them herewith.

Yours very truly

Commissioner

Blucher/k

counter 43980

537

Station	Bearing	Distance	LATITUDE		DEPARTURE		D. M. D.	DOUBLE AREAS		REMARKS
			North	South	East	West		North	South	
1	N45°21'E	92.9	65.3		66.1					Start at Sta. A
2	N89°51'E	396.0	1.0		396.0					
3	N88°07'E	396.0	13.0		395.8					
4	N88°18'E	464.4	13.8		464.2					
5	N1°53'W	876.2	875.7			28.8				
6	S89°49'E	383.4		1.2	383.4					
7	N38°53'E	545.4	424.6		342.4					
8	N69°53'W	252.0	86.7			236.6				
9	N88°19'W	113.3	3.3			113.2				
10	N32°41'E	33.8	28.4		18.2					
11	N79°20'E	58.0	10.7		57.0					
12	N49°17'E	108.0	70.4		81.8					
13	N35°06'E	65.2	53.3		37.4					
14	N26°10'E	94.0	84.4		41.4					
15	N30°26'E	175.0	150.9		88.6					
16	N24°57'E	96.8	87.8		40.8					
17	N43°09'E	129.7	94.6		88.6					
18	N35°02'E	219.2	179.5		125.8					
19	N31°35'E	81.0	69.0		42.4					
20	N28°46'E	131.4	115.2		63.2					
21	N34°14'E	77.0	63.7		43.3					
22	N36°27'E	85.0	68.4		50.5					
23	N30°44'E	223.2	191.8		114.1					
24	N33°06'E	190.8	159.8		104.2					
25	N20°46'E	160.2	149.8		56.8					
26	N54°02'E	88.2	51.8		71.4					
27	N33°38'E	304.9	253.9		168.9					
			3366.8	1.2	3342.3	378.6				

All the way around Turtle Bay

L O FORM 25

Sh. 2 of 4

FORM 2439A-E752-429-2M

Station	Bearing	Distance	LATITUDE		DEPARTURE		D. M. D.	DOUBLE AREAS		REMARKS
			North	South	East	West		North	South	
			3366.8	1.2	3342.3	378.6				
1	N23°56'E	83.2	76.0		33.8					
2	N25°E	244.7	221.8		103.4					
3	N7°06'E	160.9	159.7		19.9					
4	N11°42'W	242.6	237.6			49.2				
5	N23°51'E	260.3	238.1		105.2					
6	N7°54'E	335.2	332.0		46.1					
7	N3°27'W	234.7	234.3			14.1				
8	N15°15'W	310.0	299.1			81.5				
9	N34°40'W	277.9	228.6			158.1				
10	N35°45'W	363.2	294.8			212.2				
11	N47°17'W	370.1	251.1			271.9				
12	N40°51'W	177.8	134.5			116.3				
13	N53°36'W	139.3	82.7			112.1				
14	N44°03'W	101.9	73.2			70.8				
15	N63°08'W	289.9	131.0			258.6				
16	N63°59'W	115.3	50.6			103.6				
17	N61°14'W	136.8	65.8			119.9				
18	N76°29'W	119.5	27.9			116.2				
19	N66°40'W	132.5	52.5			121.7				
20	S75°07'W	169.9		49.6		164.2				
21	N6°57'E	94.3	93.6		11.4					
22	N6°36'W	116.2	115.4			13.3				
23	N4°13'W	45.0	44.9			3.3				
24	N47°09'W	86.4	58.8			63.3				
25	S73°40'W	139.0		34.4		134.7				
26	S84°22'W	179.6		17.6		178.7				
27	S83°03'W	146.9		17.7		145.8				
			6870.8	114.5	3622.1	2888.1				

Station 28 NB ad midland

counter 43982

S³⁹

All the way around Turtle Bay

L O FORM 25

Sh 3 of 4

FORM 2439A-E752-429-2M

Station	Bearing	Distance	LATITUDE		DEPARTURE		D. M. D.	DOUBLE AREAS		REMARKS
			North	South	East	West		North	South	
			6870.8	114.5	3622.1	2888.1				
1	N78°57'W · 146.5		28.1			143.8				
2	N85°15'W · 151.2		12.5			150.7				
3	N73°10'W · 181.1		52.4			173.3				
4	N62°56'W · 372.0		169.3			331.2				
5	S80°50'W · 190.1			30.3		187.7				
6	N50°45'W · 52.2		33.0			40.4				
7	S80°10'W · 124.9			21.3		123.1				
8	S12°20'W · 81.4			79.5		17.4				
9	N45°50'W · 127.1		88.6			91.2				
10	S87°10'W · 206.7			10.2		206.4				
11	S75°18'W · 657.0			166.7		635.5				
12	S73°44'W · 607.7			170.3		583.4				
13	S62°21'W · 781.2			362.5		692.0				
14	S24°34'W · 224.6			204.4		93.4				
15	S3°45'E · 357.5			356.7	23.4					
16	S41°36'E · 432.0			321.4	288.7					
17	S14°25'W · 295.6			286.3		73.6				
18	S44°13'W · 106.2			76.1		74.1				
19	S0°06'W · 132.7			132.7		0.2				
20	S43°12'W · 501.7			365.7		343.4				
21	S6°50'E · 252.0			250.2	30.0					
22	S2°28'W · 211.3			211.1		9.1				
23	S45°34'E · 105.0			73.1	75.4					
24	S61°40'E · 108.6			51.5	95.6					
25	S83°14'E · 145.1			17.1	144.1					
26	S25°40'E · 176.0			158.6	76.2					
27	S63°48'E · 182.9			80.8	164.1					
			7254.7	3541.0	4359.6	6858.0				

CS1* 32 119 03 21/09/03

counter 43983

540

All the way around Turtle Bay

L O FORM 25

Sh. 4 of 4

FORM 2439A-E752-429-2M

Station	Bearing	Distance	LATITUDE		DEPARTURE		D. M. D.	DOUBLE AREAS		REMARKS
			North	South	East	West		North	South	
			7254.7	3541.0	4559.6	6858.0				
1	535°11'E · 67.3			55.0	38.8					
2	542°11'W · 61.9			45.9		41.6				
3	55°27'W · 82.9			82.5		7.9				
4	546°36'E · 108.2			74.3	78.6					
5	533°28'E · 110.8			92.4	61.1					
6	532°42'E · 98.9			83.2	53.4					
7	562°11'E · 166.4			77.6	147.2					
8	81°29'E · 61.2			61.2	1.6					
9	539°35'E · 144.9			111.7	92.3					
10	557°47'E · 91.1			48.5	77.1					
11	524°08'E · 55.1			50.3	22.5					
12	531°21'W · 48.1			41.1		25.0				
13	533°37'E · 182.4			151.9	101.0					
14	577°06'E · 69.8			15.6	68.0					
15	550°50'W · 988.4			624.3		766.3				
16	552°25'E · 272.9			166.1	215.9					
17	541°44'E · 501.1			374.0	333.6					
18	529°21'E · 53.3			46.5	26.1					
19	551°46'E · 68.4			42.3	53.7					
20	542°18'E · 490.7			362.9	330.2					
21	541°58'E · 504.0			374.7	337.0					
22	546°22'E · 153.7			106.1	111.2					
23	542°17'E · 128.7			95.2	86.6					
24	556°E · 246.6			137.9	204.4					
25	558°36'E · 347.8			181.2	296.9					
26	562°16'E · 453.7			211.1	401.6					
27			7254.7	7254.5	7692.1	7698.8				

Checked by [unclear]

counter 43984

S41

January 3, 1936

The Stanolind Oil & Gas Co.,
712 Main St.,
Houston, Texas

Attn: Mr Phil Wilkerson

Gentlemen:

This is in connection with the Turtle Bay mineral leases in Chambers county, recently awarded you.

These leases were based on the map accompanying literature sent to prospective bidders. It has only recently come to my attention that the courses of lines as indicated on that map are magnetic instead of true. As a consequence, if true bearings are used, the different areas, when surveyed, will not occupy the positions indicated on the map.

This may possibly affect the four leases awarded you, for which field notes have been filed. If you are contemplating a visit to the General Land Office in the near future, I shall be glad to discuss this matter with you.

Very truly yours,

Commissioner

Blucher:eb

counter 43985

543

List of letters, etc. with W. O. Work's
Sketch & Report of Survey, Tuttle Bay
Cherokee County

1. Surveyor's Report - filed 4-3-35.
2. Surveyor's Report - filed 5-22-35.
3. Letter from W. O. Work, dated 3/27/35 Recd 4-3-35
4. ^{Copy} Letter to Standard Oil & Gas Co. dated 4/5/35
5. Letter from W. O. Work dated 4/24/35 Recd 4/25/35
6. Letter from Standard Oil & Gas Co dated 5/6/35 Recd 5/7/35
7. Letter from Standard Oil & Gas Co dated 5/21/35 Recd 5/22/35
8. Copy letter to Standard Oil & Gas Co dated 5/30/35
9. Letter from Standard Oil & Gas Co dated 6/19/35 Recd 6/21/35
10. Copy letter to Standard Oil & Gas Co dated 6/29/35
11. Letter from Standard Oil & Gas Co dated 8/10/35 Recd 8/12/35
12. Copy letter to Standard Oil & Gas Co dated 8/15/35
13. Letter from Standard Oil & Gas Co dated 8/20/35 Recd 8/22/35
14. ^{Copy} Letter to Humble Oil & Refining Co dated 11/15/35