

NUECES CO. RLD. SK. NO. 33

(IN FLAT FOLDER)

LETTER, & MAP OF MUSTANG ISLAND
RECEIVED FROM THE TEXAS CO.
RELATIVE TO STATE TRACTS IN
CORPUS CHRISTI BAY & 4 TRACTS
ON N. PART OF MUSTANG ISLAND
LETTER DATED MAR. 5, 1953
FILED IN G.L.O. MAR. 7, 1953

counter 47612

MUSTANG ISLAND NUECES COUNTY

GENERAL LAND OFFICE—AUSTIN TEXAS.

—BASCOM GILES—COMMISSIONER—

Scale: 1 inch = 200 Varas Sept. 19, 1952. O.G.K.

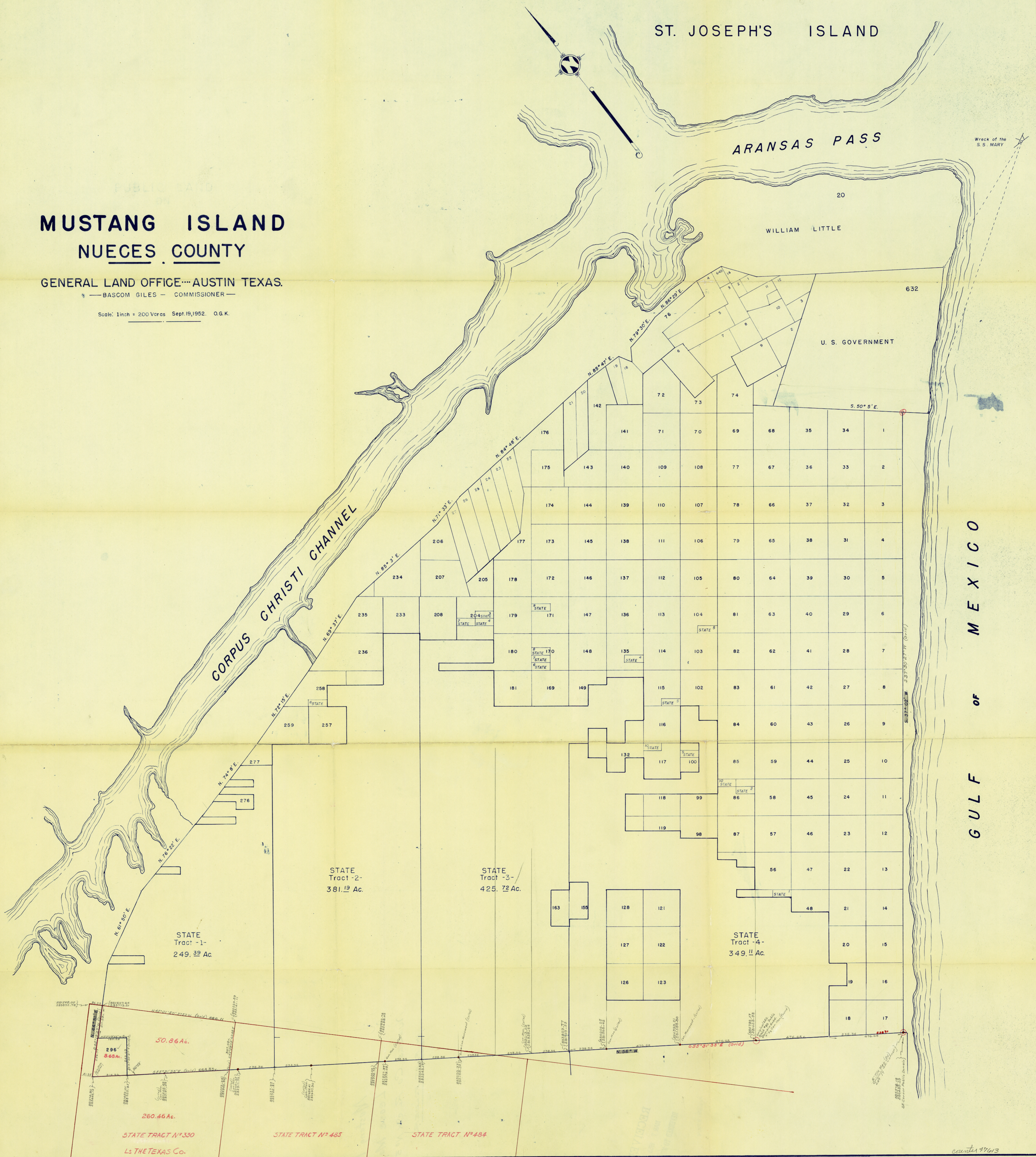

ST. JOSEPH'S ISLAND

ARANSAS PASS

WILLIAM LITTLE

U. S. GOVERNMENT

CORPUS CHRISTI CHANNEL

GULF OF MEXICO

STATE Tract -1-
249.39 Ac

STATE Tract -2-
381.19 Ac

STATE Tract -3-
425.72 Ac

STATE Tract -4-
349.11 Ac

50.86 Ac.
296
8.65 Ac.
260.46 Ac.
STATE TRACT N°330
Ls THE TEXAS Co.

STATE TRACT N°485

STATE TRACT N°484

MUSTANG ISLAND
NUECES COUNTY

GENERAL LAND OFFICE, DALLAS, TEXAS

Scale 1 inch = 1 mile

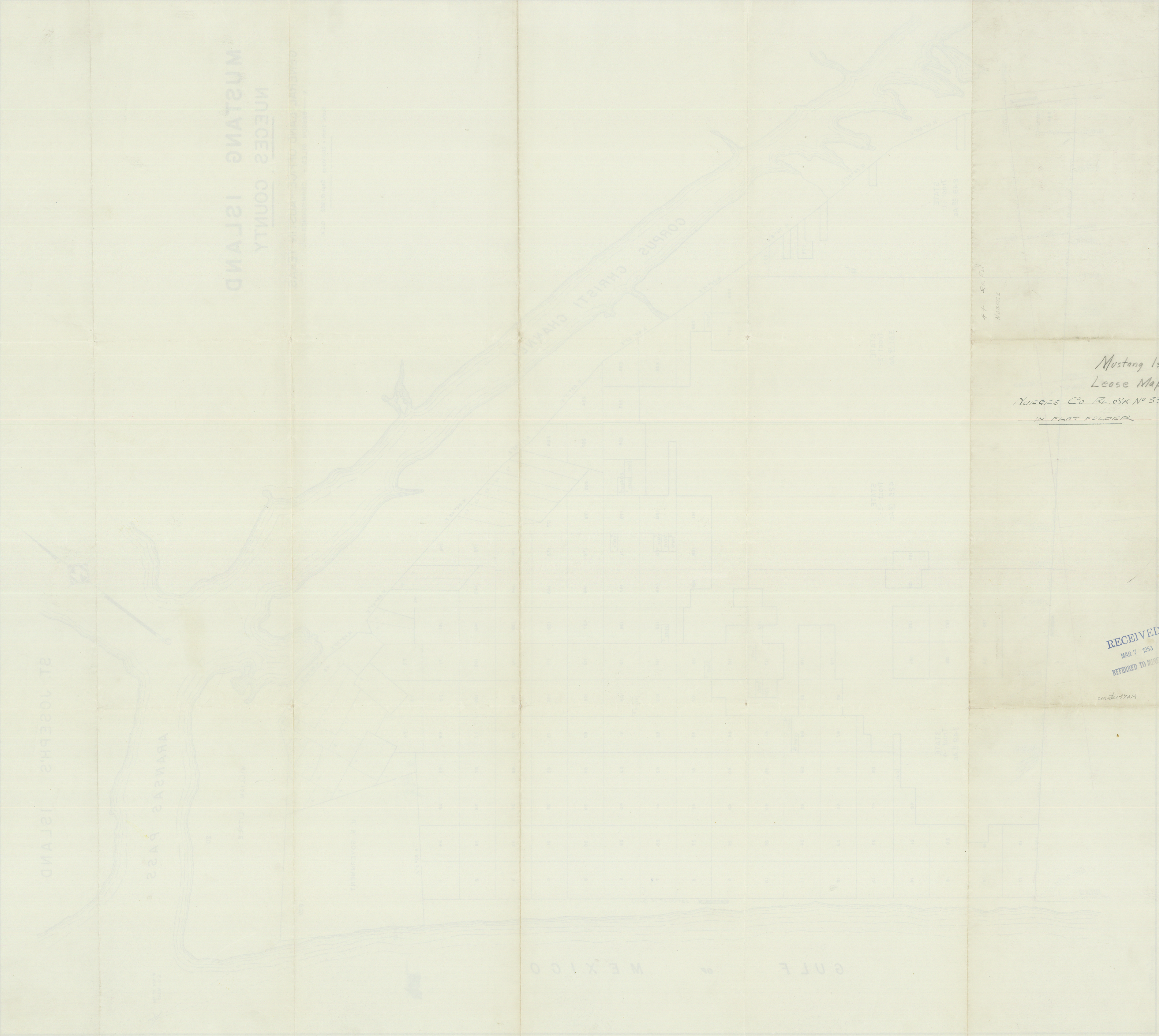

47-56-Frd
Nueces

Mustang Is.
Lease Map
NUECES CO. R.L.S.N. NO 33
IN FLAT FOLDER

RECEIVED
MAR 7 1953
REFERRED TO MINERALS

number 47614

THE TEXAS COMPANY

TEXACO PETROLEUM PRODUCTS



PRODUCING DEPARTMENT
SOUTH TEXAS DIVISION
R. E. MILLS, DIVISION CIVIL ENGINEER

RECEIVED

MAR 7 1953

REFERRED TO MINERALS
HOUSTON 1, TEXAS

March 5, 1953

STATE LEASE #35553
THE TEXAS COMPANY'S LEASE #139175

Mr. Bascom Giles
Commissioner General Land Office
Austin, Texas

M.F. 35553
37696
39670

Dear Sir:

Under #35553 you leased to The Texas Company State Tract #330 in Corpus Christi Bay as containing 320 acres. Your map of Corpus Christi Bay shows the north end of this tract to be in conflict with tracts in the subdivision of Mustang Island; namely, State Tract #1, and Survey #296 which was sold and patented by the State.

In 1937, I made a third order survey of Mustang Island, at which time I found the original northeast corner of Survey #1 on the south line of the U. S. Government tract and the southeast corner of Tract #17 and the southeast corner of Survey #92 of the Mustang Island Subdivision. I also tied my transit line to U. S. Coast & Geodetic monuments KNOLL and HERD. From my tie to these monuments, the south line of the Mustang Island Subdivision was found to have a grid bearing of N 55° 31' 33" W, as compared to a call of N 56° W on your map of Mustang Island. Extending this line the called distance to the northwest, we have calculated Lambert grid coordinates for the called position of the corners of the original subdivision and the corners of State Tracts #1, #2, #3, and #4 which are superimposed on the original subdivision; also coordinates for the corners of Survey #296.

I am enclosing herewith a copy of your map of Mustang Island on which we have shown this information and on which we have shown, in red, the amount of the conflict between Corpus Christi Bay Tract #330 and the Mustang Island tract. Survey #296 contains 8.68 acres and the conflict between Tract #330 and Tract #1 was found to be 50.86 acres.

I presume that if you have not leased State Tract #1 on Mustang Island, you will consider State Tract #3 to cover

G¹

counter 47615

Mr. Bascom Giles

-2-

3-5-53

the area in conflict and that this area will be deducted from State Tract #1. In any event, Survey #296 must be deducted from State Tract #330.

Will you please advise us what you propose to do about this conflict.

Yours very truly,

THE TEXAS COMPANY
Producing Department
South Texas Division

By

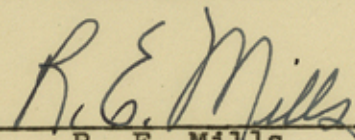
R. E. Mills

REM-RS

Encl.

RECEIVED
MAR 10 1953
#22

RECEIVED
MAR 10 1953

G²

counter 77614