

Subject: see

CERTIFICATE

I, BASCOM GILES, Commissioner of the General Land Office of the State of Texas, do hereby certify that there has been filed in the General Land Office on April 7, 1952, a certified copy of a Compact heretofore entered into on December 10, 1951, between the County Courts and Commissioners Courts of Aransas and Refugio Counties, Texas, fixing that part of the county line of Aransas and Refugio Counties extending through Copano Bay, together with certified copy of field notes of joint survey of said line made by the County Surveyors of said respective counties with the map accompanying said field notes, together with a transcript of all other proceedings had by said courts of said counties duly certified by the respective clerks thereof; and that I have examined all of said proceedings and find same in accordance with law and in particular with Chapter 4 of Title 33, Revised Statutes, and have approved the same and that I have marked on the official maps of Aransas and Refugio Counties the said portion of said boundary line as so fixed and established by said tribunals and said line as so determined and demarked is hereby officially recognized by me as the true, correct and lawful boundary line in said Bay of said counties.

IN TESTIMONY WHEREOF I have hereunto subscribed my name and affixed my official seal of office in the City of Austin, on this the 7th day of April, A. D. 1952.

Bascom Giles
 Commissioner of General Land Office
 of the State of Texas.

counter 49804

CERTIFICATE OF CLERK OF REFUGIO COUNTY

I, Bettie Adkins, the duly elected and qualified County Clerk of Refugio County, Texas, and being, by virtue of my said office, Clerk of the County Court of Refugio County and Clerk of the Commissioners Court of Refugio County, do hereby certify in each of my said official capacities to the Commissioner of the General Land Office of the State of Texas that the attached and within map and proceedings comprise a full, complete and correct transcript of all proceedings had in my county in the County Court and in the Commissioners Court in the matter of the designation of the boundary line between Aransas and Refugio Counties, Texas, in so far as the same extends through Copano Bay, as determined and agreed upon by the County Courts and the Commissioners Courts of the two counties, as set forth in the respective certified copies of proceedings hereto attached and made part of this record and transcript. This transcript contains the following instruments, to-wit:

1. Certified copy of field notes of survey of said portion of said county boundary line as surveyed and marked by Honorable Fred T. Percival, County Surveyor of Aransas County, Texas, and Honorable Phillip G. Young, County Surveyor of Refugio County, Texas, in pursuance to directives of the County Court and Commissioners Court of said two counties, which said field notes are recorded in Volume 10, page 117, of the Minutes of the Commissioners Court of Refugio County, Texas.
2. Certified copy of map of Copano Bay showing the subdivision thereof and the mineral development units as made by Commissioner of the General Land Office and the location of such part of said division line extending there-through, made and prepared by the County Surveyors of said respective counties, which said map is recorded in Volume 2, page 60, of the Map and Plat Records of Refugio County, Texas.
3. Certified copies of the Minutes of the Commissioners Court of Refugio County, Texas, showing proceedings had on September 25, 1950, wherein the location of said portion of said county line was indicated at the joint meeting, which said minutes are recorded in Volume 10, page 126, of the Minutes of the Commissioners Court of Refugio County, Texas.

counter 49807

4. Certified copy of Compact between the County Courts and the County Commissioners Courts of Aransas and Refugio Counties, Texas, made and entered into on December 10, 1951, at Rockport, Texas, which said Compact is recorded in Volume 10, page 110 et seq, of the Minutes of the Commissioners Court of Refugio County, Texas.

5. Certified copy of order of the County Court of Refugio County approving the Compact and said Surveyors map and field notes entered on December 10, 1951, and entered in Volume 3, page 602, of the Minutes of the County Court of Refugio County, Texas.

6. Certified copy of order of the Commissioners Court of Refugio County, Texas, authorizing and approving said Compact and said Surveyors map and field notes entered on December 10, 1951, and duly entered in Volume 10, page 114, of the Minutes of the Commissioners Court of Refugio County, Texas.

7. Certified copy of copy of order of County Court of Aransas County, Texas, approving and adopting said Compact and said Surveyors field notes and map entered on December 10, 1951, in Volume 14, pages 168 et seq, of the Minutes of the County Court of Aransas County, Texas, as duly certified by the Clerk of said court and certified copy of which being recorded in Volume 10, pages 118 et seq, of the Commissioners Court records of Refugio County, Texas.

8. Certified copy of copy of order of the Commissioners Court of Aransas County, Texas, adopting and approving said Compact and approving said Surveyors field notes and map entered on December 10, 1951, in Volume 10, pages 96 et seq, of the Commissioners Court Minutes of Aransas County, Texas, copy of which certified by the Clerk of said Court being recorded in Volume 10, pages 120 et seq, of the Minutes of the Commissioners Court of Refugio County, Texas.

IN TESTIMONY WHEREOF, Witness my hand and official seals of office in each such designated capacity, at office, in Refugio, Texas, on this the 29 day of Jan., A. D. 1952.

Bettie Adkins
Clerk of the County Court of
Refugio County, Texas.

Bettie Adkins
Clerk of the Commissioners Court of
Refugio County, Texas.

Bettie Adkins
County Clerk of Refugio County, Texas.

By Margaret W. Shires, Deputy
counter 49808

THE STATE OF TEXAS
COUNTIES OF ARANSAS
AND REFUGIO



Field notes of a survey of the Aransas-Refugio County Line through Copano Bay made for Aransas and Refugio Counties, Texas.

Said survey is situated within the South Central Zone, Texas Co-ordinate System, is made to conform with said Texas Co-ordinate System as authorized by Article 5300, Revised Civil Statutes of Texas, and is more particularly described by metes and bounds as follows, to-wit:

Beginning at a point in Copano Bay at the mouth of the Aransas River mid-way between the banks of said river, said beginning point is situated at X-925, 076.3 varas and Y-31, 492.6 varas, Texas Co-ordinate System, South Central Zone, from whence U. S. C. & G. Triangulation Station "Bayside" in Refugio County bears N. $32^{\circ} 00' 24''$ E., 4274.96 varas, and U. S. C. & G. Triangulation Station "Star" in Aransas County Bears S. $86^{\circ} 41' 50''$ E., 6651.77 varas;

Thence, N. $42^{\circ} 49'$ E., along said county line 2175 varas to the center of the Causeway across Copano Bay on Texas Farm Road 136, midway between the N and S ends of said Causeway, for a corner of this survey, at X-926, 554.5 varas and Y-33, 088.0 varas, Texas Co-ordinate System, South Central Zone;

Thence, N. $66^{\circ} 26'$ E., along said county line, 9620 varas to a corner of this survey at X-935, 372.2 varas and Y-36, 934.3 varas, Texas Co-ordinate System, South Central Zone;

Thence, N. $50^{\circ} 47'$ E., along said county line, 17,950 varas to a corner of this survey off Shell Point at X-949, 279.1 varas and Y-48, 283.2 varas, Texas Co-ordinate System, South Central Zone;

Thence, N. $17^{\circ} 46'$ E., along said county line, 2100 varas to a corner of this survey off Turtle Point at X-949, 919.9 varas and Y-50, 283.1 varas, Texas Co-ordinate System, South Central Zone;

Thence, N. $88^{\circ} 36'$ W., along said County line, 1270 varas to a corner of this survey in Copano Lake at X-948, 650.3 varas and Y-50, 314.1 varas, Texas Co-ordinate System, South Central Zone;

Thence, S. $75^{\circ} 07'$ W., along said County line, 1069 varas to a corner of this survey at the mouth of Copano Creek, midway between its banks at X-947, 617.2 varas and Y-50, 039.5 varas, Texas Co-ordinate System, South Central Zone, from whence U. S. C. & G. Triangulation Station "Lap" in Refugio County Bears S. $46^{\circ} 04' 22''$ W., 4448.88 varas and U. S. C. & G. Triangulation Station "Pete" in Aransas County Bears S. $62^{\circ} 29' 55''$ E., 4294.79 varas.

Phillip G. Young
PHILLIP G. YOUNG
County Surveyor
Refugio County, Texas

counter 49809

THE STATE OF TEXAS 0
COUNTY OF REFUGIO 0

I, BETTIE ADKINS, Clerk of the County Court and Ex Officio Clerk of the Commissioners' Court of Refugio County, Texas, do hereby certify that the above and foregoing is a true and correct executed copy of the FIELD NOTES BY THE COUNTY SURVEYOR OF REFUGIO COUNTY, TEXAS RELATING TO BOUNDARY IN COPANO BAY BETWEEN ARANSAS AND REFUGIO COUNTIES, as the same appears of record in Volume 10, Page 117, Minutes of Commissioners' Court of Refugio County, Texas.

TO CERTIFY, Witness my hand and seal of office, this the 28th day of January, A. D. 1952.

BETTIE ADKINS,

Clerk, County Court and Ex Officio Clerk,
Commissioners' Court, Refugio County, Texas.

By Margaret W. Shire, Deputy.

3

NUNC PRO TUNC ORDER

BE IT REMEMBERED that on Monday, September 25, 1950, at 9 A. M. the Commissioners Court of Refugio County, Texas, met in joint session with the Commissioners Court of Aransas County, Texas, at Rockport, Texas, in the District Court Room there, for the purpose of determining whether or not an agreement could be reached with reference to the location of the part of the boundary line of the two counties lying in Copano Bay. Attending said meeting from Refugio County were Hon. T. G. Jeter, County Judge, Hon. T. J. Heard, Hon. Hugo Geistman, Hon. Francis West and Hon. Clarke Adkins, County Commissioners, Hon. Phillip G. Young, County Surveyor, Hobart Huson and Gerald T. Bissett, Esqs., special counsel for Refugio County and Messrs. George Dahse and Howard DeViney, Business manager and superintendent, respectively, of the Woodsboro Independent School District, of Refugio County.

Representing Aransas County in attendance were County Judge D. R. Simmons, and all of the County Commissioners, together with Hon. Weldon Cabaniss, County Attorney of Aransas County and Hon. Emory M. Spencer, special counsel for Aransas County and Hon. Fred T. Percival, County Surveyor of Aransas County. There were present also representatives of the Rockport Independent School District of Aransas County, including Mr. Jess Harbin.

This was the third joint meeting of the two Commissioners Courts since 1947.

A tentative agreement of settlement of said division line was made by the members of the two courts, subject to ratifications at legal meetings thereof to be held within their own counties after Engineer's field notes of said division line have been prepared by or under the supervision of the County Surveyors of the two counties, and suitable orders have been drafted and agreed upon by counsel for the respective counties.

- - - - -

counter 49811

THE STATE OF TEXAS |

COUNTY OF REFUGIO |

I, BETTIE ADKINS, Clerk of the County Court and Ex Officio Clerk of the Commissioners' Court of Refugio County, Texas, do hereby certify that the above and foregoing is a true and correct copy of the NUNC PRO TUNC ORDER RELATING TO THE BOUNDARY IN COPANO BAY BETWEEN ARANSAS AND REFUGIO COUNTIES, as the same appears of record in Volume 10, Page 126, Minutes of Commissioners' Court Records of Refugio County, Texas.

TO CERTIFY, Witness my hand and seal of office at office in Refugio, Texas, this the 29th day of January, A. D. 1952.

BETTIE ADKINS,
Clerk, County Court, and Ex Officio
Clerk, Commissioners' Court, Refugio
County, Texas.

By Margaret W. Shires, Deputy.

COMPACT AND AGREEMENT
BETWEEN ARANSAS COUNTY AND REFUGIO COUNTY
RELATING TO BOUNDARY IN COPANO BAY

THIS COMPACT AND AGREEMENT OF COMPROMISE made and entered into on this 10th day of December, 1951, by and on behalf of ARANSAS COUNTY and REFUGIO COUNTY, duly established and constituted counties and bodies corporate and politic of the State of Texas, represented hereunto and acting by and through their respective County Courts and Commissioners' Courts, pursuant to Orders of each such respective Courts, made and entered at a meeting of such Court legally and duly held within its own County and jurisdiction in the manner prescribed by law, certified copies of such respective Orders being hereto attached and hereby referred to, and attested by the respective Clerks of such Courts under their respective several Official Seals,

WITNESSETH: -

WHEREAS, Aransas County was created from territory embraced within the limits of Refugio County, by Act of the Twelfth Legislature of the State of Texas, Adjourned Session, approved September 18, 1871, as shown by Acts of 1871, Second Session, page 1 (Gammel's Laws, Volume VII, page 3), the first two sections of said Act being in words and figures, as follows, to-wit:

"Section 1. Be it enacted by the Legislature of the State of Texas, That all territory comprised within the following limits, to-wit:

"Beginning at the boundary of the State on the Gulf of Mexico, opposite the center of the channel of Aransas Pass, between the islands of St. Joseph and Mustang;

"Thence, with the line between the counties of San Patricio and Refugio, to the center of Aransas River;

"Thence, down the center of said stream to Copano Bay;

"Thence, with the channel of said bay parallel with the shore, to the east end of the same at the mouth of Copano creek;

"Thence, up said creek to the mouth of Alamita creek;

"Thence, in a direct line to the southeast corner of J. C. Stolberg survey on Esperitu Santo Bay;

"Thence, in a direct line, to Cedar Bayou;

"Thence, through said bayou, to the boundary of the State, on the Gulf of Mexico;

"Thence, with said boundary of the State, to the place of beginning,

be and the same is hereby created a county, to be called the county of Aransas, and the town of Rockport is hereby declared the county seat of said county.

Sec. 2. That the remaining portion of the county of Refugio shall constitute and be called Refugio county, and the town of Refugio shall be the county seat of said Refugio County;" and

WHEREAS, the portion of the boundary line between said two counties extending through Copano Bay from the mouth of Aransas River to the mouth of Copano Creek, never has been defined, established, surveyed, or marked, and the true location of the same is undefined, uncertain, and disputed at the present time; in that there appears to be two mouths of Aransas River, and there are three or more well-known and well-defined channels through said bay; one being the Smith channel lying off and approximately paralleling the shore of Aransas County; one, the name of which, if any, is now unknown, lying off and approximately paralleling the shore of Refugio County; and one being the old main navigation channel, which parallels neither shore but zigzags back and forth between the two shores; and that a bona fide dispute has arisen and now exists between the two counties as to the location of such portion of said common boundary line; and

WHEREAS, oil, gas, and other minerals have been discovered to exist in said Copano Bay, and the Commissioner of the General Land Office of the State of Texas, pursuant to law, has had said bay, and other submerged lands belonging to the State of Texas, surveyed and platted into mineral subdivisions for mineral exploration and development purposes, as evidenced by a map or plat of such Subdivision established and promulgated by said Land Office Commissioner, and to which reference is here made; and said Commissioner has made numerous mineral leases to private persons and concerns of tracts or blocks of said mineral subdivision of the submerged lands of said bay, and in all probability in like manner will lease all of the submerged lands of said bay for such purposes; whereby the lessee's working interests and estates created by such mineral lease contracts, being privately owned property, are and will be subject to ad valorem taxation by the county and taxing units thereof in which such tracts may be located; and numerous producing wells for oil and gas have been and are being drilled in said bay, thereby creating large taxable values which heretofore were non-existent; and

WHEREAS, notice has been given by the Commissioner of the General Land Office to each the County Courts of Aransas County and Refugio County that the aforesaid part of said boundary line is not sufficiently definite and well defined; such notice being in the form of a letter dated April 15, 1947; and

WHEREAS, said part of said boundary line is indefinite, as aforesaid, and also because of its peculiar nature, it is impracticable to survey and mark same in the manner prescribed by Chapter Four of Title 33, Revised Civil Statutes; and

WHEREAS, in order to avoid more confusion and uncertainty in the rendition and assessment of submerged lands and interests therein for ad valorem taxation, and in the exercise of civil and criminal jurisdiction, and in the conduct of private business with reference thereto, it is thought desirable that the line to be agreed upon should be as practically regular as possible, and that unusual and practically undefinable contours and contortions should be avoided as much as possible, to the end that public officials, citizens, and private property owners may be able to readily recognize and ascertain the approximate location of such boundary line with the least difficulty, uncertainty, and expense; and

WHEREAS, after due mutual notices the County Courts and Commissioners Courts of the two counties have held a series of joint meetings for the purpose of arriving at a legal, just, and practicable solution of their common problem, and of a practical means and method of defining, locating, establishing, and marking said part of said boundary line; and at the third of said series of joint meetings, held at Rockport, Texas, on September 25, 1950, said courts mutually agreed that the said part of said line should be surveyed, marked, and due returns made, permanently establishing such part of said line, in accordance with a location and course then and there

indicated by the contracting parties upon the map of Copano Bay, the correct field notes to be determined afterwards by actual survey made by Honorable Fred T. Percival, County Surveyor of Aransas County, and Honorable Phillip G. Young, County Surveyor of Refugio County, they being the duly elected, qualified, and acting County Surveyors of said counties, and having taken the oaths of office and having given official bond; all of which appears from orders of such respective Courts dated September 25, 1950, to which reference is here made; and

WHEREAS, said County Surveyors have run the boundary line agreed upon, as aforesaid, and have made the required return of the field notes and maps to a joint meeting of the County and Commissioners Courts of Aransas and Refugio Counties, called and held after due mutual notice, at Rockport, Texas, on December 10, 1951, at which said surveyors' field notes, maps, reports, and engineering data were received, inspected, examined, and approved by all of the said Courts and the members thereof, and by their legal counsel; and

WHEREAS, said County and Commissioners Courts of said two respective counties, at said joint meeting of December 10, 1951, agreed that all matters of dispute and controversy between the two counties be amicably compromised, settled, and adjusted, by declaring, fixing, and establishing the part of said line as so run, surveyed, and returned by said County Surveyors, as the true and permanent boundary line extending through said Copano Bay, and that said line as surveyed and as agreed upon be suitably and permanently marked as such part of said boundary line;

NOW, THEREFORE, it is agreed by and between the said high contracting parties hereto:

FIRST: That the part of the boundary line of Aransas and Refugio Counties extending through Copano Bay, from the mouth of Aransas River to the mouth of Copano Creek, be and is hereby permanently located, fixed, and established, in accordance with said actual survey made by the County Surveyors of said Counties, as follows:

Field notes of a survey of the Aransas-Refugio County Line through Copano Bay made for Aransas and Refugio Counties, Texas.

Said survey is situated within the South Central Zone, Texas Co-ordinate System, is made to conform with said Texas Co-ordinate System as authorized by Article 5300, Revised Civil Statutes of Texas, and is more particularly described by metes and bounds as follows, to-wit:

Beginning at a point in Copano Bay at the mouth of the Aransas River mid-way between the banks of said river, said beginning point is situated at X-925,076.3 varas and Y-31,492.6 varas, Texas Co-ordinate System, South Central Zone, from whence U.S.C. & G. Triangulation Station "Bayside" in Refugio County bears N. $32^{\circ} 00' 24''$ E., 4274.96 varas, and U.S.C. & G. Triangulation Station "Star" in Aransas County Bears S. $86^{\circ} 41' 50''$ E., 6651.77 varas;

Thence, N. $42^{\circ} 49'$ E., along said county line 2175 varas to the center of the Causeway across Copano Bay on Texas Farm Road 136, midway between the N and S ends of said Causeway, for a corner of this survey, at X-926,554.5 varas and Y-33,088.0 varas, Texas Co-ordinate System, South Central Zone;

Thence, N. $66^{\circ} 26'$ E., along said county line, 9620 varas to a corner of this survey at X-935,372.2 varas and Y-36,934.3 varas, Texas Co-ordinate System, South Central Zone;

Thence, N. $50^{\circ} 47'$ E., along said county line, 17,950 varas to a corner of this survey off Shell Point at X-949,279.1 varas and Y-48,283.2 varas, Texas Co-ordinate System, South Central Zone;

Thence, N. $17^{\circ} 46'$ E., along said county line, 2100 varas to a corner of this survey off Turtle Point at X-949,919.9 varas and Y-50,283.1 varas, Texas Co-ordinate System, South Central Zone;

Thence, N. $88^{\circ} 36'$ W., along said County line, 1270 varas to a corner of this survey in Copano Lake at X-948,650.3 varas and Y-50,314.1 varas, Texas Co-ordinate System, South Central Zone;

Thence, S. $75^{\circ} 07'$ W., along said County line, 1069 varas to a corner of this survey at the mouth of Copano Creek, midway between its banks at X-947,617.2 varas and Y-50,039.5 varas, Texas Co-ordinate System, South Central Zone, from whence U.S.C. & G. Triangulation Station "Lap" in Refugio County Bears S. $46^{\circ} 04' 22''$ W., 4448.88 varas and U.S.C. & G. Triangulation Station "Pete" in Aransas County Bears S. $62^{\circ} 29' 55''$ E., 4294.79 varas.

counter 19816

and that said line, as so surveyed, be regarded ab initio as the true boundary of said counties within Copano Bay; and that all of the area of Copano Bay lying Eastwardly of said line shall be within Aransas County, and all lands, or appurtenances, therein shall be assessed in Aransas County; and that all of the area of said Bay lying Westwardly of said line shall be within Refugio County, and all lands, or appurtenances therein shall be assessed in Refugio County.

SECOND: That said line as so run, surveyed, and established, be suitably and permanently marked under the supervision of the County Surveyors of the two counties; the cost and expense of the markers and erection thereof to be shared equally by the two counties.

THIRD: That a copy of this compact or agreement, together with all orders of all courts authorizing same and all surveyors' field notes and maps, be filed by each county for record and recorded in the office of the County Clerk of its own County, at the expense of the County filing same; and that certified copies of same be returned to the General Land Office, as required by statute; and that the expense of such certified copies for the General Land Office be borne equally by the two counties. The Commissioner of the General Land Office is authorized to mark the official Land Office maps of the counties in accordance with this agreement.

FOURTH: That the County Surveyors of the two counties forthwith make calculations of quantities of acreage lying within the territories of the respective counties in all cases where the boundary line herein agreed upon crosses or divides tracts or blocks of the State Mineral Development Subdivision of Copano Bay as platted aforesaid, by the General Land Office; and that such calculations be certified under their official seals to the Commissioners Courts of the two counties.

IN TESTIMONY WHEREOF witness the official hands and seals of the high contracting parties in Quintuplicate original copies, at Rockport, Texas, on this the 10th day of December, 1951.

FOR ARANSAS COUNTY

John D. Wendell
Judge of the County Court of Aransas
County, Texas.

FOR REFUGIO COUNTY

G. S. Jeter
Judge of the County Court of Refugio
County, Texas.

ATTEST:

Jan C. Sherrington
Clerk of the County Court of Aransas
County, Texas.

ATTEST:

Bettie Robbins
Clerk of the County Court of Refugio
County, Texas.

COMMISSIONERS COURT OF
ARANSAS COUNTY, TEXAS

BY

John D. Wendell
County Judge of Aransas County
M. B. Allen
Commissioner, Precinct No. 1 of
Aransas County
J. M. Spahr
Commissioner, Precinct No. 2 of
Aransas County

COMMISSIONERS COURT OF
REFUGIO COUNTY, TEXAS

BY

G. S. Jeter
County Judge of Refugio County
D. Heard
Commissioner, Precinct No. 1 of
Refugio County
Hugo Leishman
Commissioner, Precinct No. 2 of
Refugio County

W L Dawie
Commissioner, Precinct No. 3 of
Aransas County

Francis West
Commissioner, Precinct No. 3 of
Refugio County

Joe Mills
Commissioner, Precinct No. 4 of
Aransas County

Clarke Adkins
Commissioner, Precinct No. 4 of
Refugio County

ATTEST:

James C. Harvinsky
County Clerk of Aransas County, and
Ex-Officio Clerk of the Commissioner's
Court of Aransas County, Texas

ATTEST:

Bettie Adkins
County Clerk of Refugio County, and
Ex-Officio Clerk of the Commissioner's
Court of Refugio County, Texas

THE STATE OF TEXAS,)
COUNTY OF REFUGIO.)

I, BETTIE ADKINS, Clerk of the County Court and Ex Officio Clerk of the Commissioners' Court of Refugio County, Texas, do hereby certify that the above and foregoing is a true and correct executed copy of COMPACT AND AGREEMENT BETWEEN ARANSAS COUNTY AND REFUGIO COUNTY RELATING TO BOUNDARY IN COPANO BAY, as the same appears of record in Volume 10, Pages 110-114, Minutes of Commissioners' Court of Refugio County, Texas.

TO CERTIFY, Witness my hand and seal of office, this the 26th day of January, A.D. 1952,

Bettie Adkins
Clerk, County Court and Ex Officio
Clerk, Commissioners' Court, Refugio
County, Texas.

ORDER OF THE COUNTY COURT OF REFUGIO COUNTY

In the Matter of
Boundaries of Aransas and Refugio
County through Copano Bay

¶
¶
¶

In the County Court of Refugio
County, Texas

On this the 10th day of December, A. D. 1951, it appearing to the County Court of Refugio County, Texas, that the part of the boundary line between Aransas County and Refugio County extending through Copano Bay has been settled and determined by agreements reached at four joint meetings of the County Courts and County Commissioners Courts of Aransas and Refugio Counties, and that the line so agreed upon has been actually surveyed by the County Surveyors of the respective counties, viz: Hon. Fred T. Percival, County Surveyor of Aransas County, and Hon. Phillip G. Young, County Surveyor of Refugio County, pursuant to authorization and direction of the joint meeting of said Courts held in Rockport, Texas, on September 25, 1950, and that said surveyors have made due return of the field notes and map of such actual survey to the joint meeting of said County and Commissioners Courts of the two counties held at Rockport, Texas, heretofore on December 10, 1951, at which such field notes, maps and reports were duly inspected, examined, received and approved, and the line evidenced by said field notes and map was agreed upon by all of said Courts to be the true boundary line between Aransas County and Refugio County extending through Copano Bay from the mouth of Aransas River to the mouth of Copano Creek, such action of such last joint meeting being memorialized and evidenced by a written Compact or Agreement of settlement and compromise between and on behalf of said two counties, dated December 10, 1951, a copy of which is to be duly entered in the Minutes of the Commissioners Court of Refugio County, Texas, is hereby referred to, and made a part of this order without necessity recopying the same herein or in the Minutes of the County Court;

NOW, THEREFORE, IT IS ORDERED, ADJUDGED AND DECREED BY THE COUNTY COURT OF REFUGIO COUNTY, TEXAS, sitting in Refugio County, Texas, that said Compact and Agreement of compromise and settlement, promulgated the said joint meeting of said Courts at Rockport, Texas, on December 10, 1951, and bearing said date, and hereinbefore described and referred to, be, and the same is hereby, affirmed, adopted, ratified and confirmed in all respects as the act and deed of Refugio County, Texas, and that the same be executed by the Judge of this Court and the Commissioners Court of Refugio County for and on behalf of Refugio County, and that the Clerk of this Court duly attest the same; and that the return of the field notes and map of said survey made by the said county surveyors of said counties, as aforesaid, be, and the same are hereby received, approved and accepted by and on behalf of the County of Refugio, and the same shall be recorded by the Clerk of this Court, as provided by statute, together with certified copies supporting orders of the County and Commissioners Courts of Refugio County, and a certified copy thereof be returned to the Commissioner of the General Land Office as required by the statute and said Compact and Agreement;

IT IS FURTHER ORDERED, ADJUDGED AND DECREED BY THE COURT that the portion of the boundary line between Aransas and Refugio County which extends in and across Copano Bay, be, and the same is hereby, fixed and established and same shall be regarded hereafter as the true boundary line between said counties in accordance with said Compact and Agreement as follows, to-wit:

counter 49819

Field notes of a survey of the Aransas-Refugio County Line through Copano Bay made for Aransas and Refugio Counties, Texas.

Said survey is situated within the South Central Zone, Texas Co-ordinate System, is made to conform with said Texas Co-ordinate System as authorized by Article 5300, Revised Civil Statutes of Texas, and is more particularly described by metes and bounds as follows, to-wit:

Beginning at a point in Copano Bay at the mouth of the Aransas River mid-way between the banks of said river, said beginning point is situated at X-925, 076.3 varas and Y-31, 492.6 varas, Texas Co-ordinate System, South Central Zone, from whence U. S. C. & G. Triangulation Station "Bayside" in Refugio County bears N. $32^{\circ} 00' 24''$ E., 4274.96 varas, and U. S. C. & G. Triangulation Station "Star" in Aransas County Bears S. $86^{\circ} 41' 50''$ E., 6651.77 varas;

Thence, N. $42^{\circ} 49'$ E., along said county line 2175 varas to the center of the Causeway across Copano Bay on Texas Farm Road 136, midway between the N and S ends of said Causeway, for a corner of this survey, at X-926, 554.5 varas and Y-33, 088.0 varas, Texas Co-ordinate System, South Central Zone;

Thence, N. $66^{\circ} 26'$ E., along said county line, 9620 varas to a corner of this survey at X-935, 372.2 varas and Y-36, 934.3 varas, Texas Co-ordinate System, South Central Zone;

Thence, N. $50^{\circ} 47'$ E., along said county line, 17,950 varas to a corner of this survey off Shell Point at X-949, 279.1 varas and Y-48, 283.2 varas, Texas Co-ordinate System, South Central Zone;

Thence, N. $17^{\circ} 46'$ E., along said county line, 2100 varas to a corner of this survey off Turtle Point at X-949, 919.9 varas and Y-50, 283.1 varas, Texas Co-ordinate System, South Central Zone;

Thence, N. $88^{\circ} 36'$ W., along said County line, 1270 varas to a corner of this survey in Copano Lake at X-948, 650.3 varas and Y-50, 314.1 varas, Texas Co-ordinate System, South Central Zone;

Thence, S. $75^{\circ} 07'$ W., along said County line, 1069 varas to a corner of this survey at the mouth of Copano Creek, midway between its banks at X-947, 617.2 varas and Y-50, 039.5 varas, Texas Co-ordinate System, South Central Zone, from whence U. S. C. & G. Triangulation Station "Lap" in Refugio County Bears S. $46^{\circ} 04' 22''$ W., 4448.88 varas and U. S. C. & G. Triangulation Station "Pete" in Aransas County Bears S. $62^{\circ} 29' 55''$ E., 4294.79 varas.

IT IS FURTHER ORDERED, ADJUDGED AND DECREED BY THE COURT that said boundary line, as hereinbefore fixed, established and surveyed, be suitably and permanently marked as provided by statute and by said compact and agreement, under the supervision of said county surveyors, at the joint expense of said counties; and that said Surveyors make due report to this Court when such marking has been completed.

IT IS FURTHER ORDERED, ADJUDGED AND DECREED BY THE COURT that each and every act heretofore done by the County Court of Refugio County and the Commissioners Court of Refugio County and by the County Courts and Commissioners Courts of the said two counties at the joint meetings of said Courts in agreeing upon the true location of said part of said boundary line, and in directing the actual survey thereof, and in receiving and approving the returns of such survey and the field notes and map thereof, and in fixing and establishing such line as the true and permanent boundary line of said counties insofar as same traverses said Copano Bay, and in ordering said line to be suitably and permanently marked, and in agreeing upon each and all of the matters contained in said written Compact and Agreement of settlement and compromise, be, and the same are hereby in all things affirmed, adopted, approved, ratified, and confirmed as the act and deed of Refugio County, Texas.

IT IS FURTHER ORDERED, ADJUDGED AND DECREED BY THE COURT that special public notice be given of the establishment of such part of said boundary line by the publication of the field notes of such line one time in each newspaper published in Refugio County, Texas, so that the public generally may be informed with reference thereto.

ATTEST:

Bettie Adkins
Clerk of the County Court of

Refugio County, Texas.

J. B. [Signature]
Judge of the County Court of
Refugio County, Texas.

THE STATE OF TEXAS,)
COUNTY OF REFUGIO.)

I, BETTIE ADKINS, Clerk of the County Court of Refugio County, Texas, do hereby certify that the above and foregoing is a true and correct executed copy of an ORDER OF THE COUNTY COURT OF REFUGIO COUNTY, Relating to the Boundary of Aransas and Refugio Counties, passed December 10, 1951, as the same appears of record in Vol. 3, Pages 602-604, Minutes of the County Court of Refugio County, Texas.

TO CERTIFY, Witness my hand and seal of office, at office in Refugio, Texas, this the 26th day of January, A.D. 1952.

Bettie Adkins
Clerk, County Court, Refugio
County, Texas.

counter 99821

ORDER OF COMMISSIONERS COURT

On this the 10th day of December, A.D., 1951, the Commissioners Court of Refugio County, Texas, convened in its own courtroom, in the courthouse of its own county, at Refugio, Texas, all members being present and participating, following adjournment of the joint meeting of the County and Commissioners Courts of Aransas and Refugio Counties, held at Rockport, Texas, earlier the same day, whereat an agreement was reached between the two counties defining and establishing the location of that part of the boundary of said counties extending through Copano Bay; whereupon, said Commissioners Court sitting separately and within its own jurisdiction took up and duly considered the matter of the understanding and agreement reached at said joint meeting, which agreement is evidenced, set forth, and contained in an instrument in writing prepared by legal counsel of both counties, and denominated a Compact and Agreement between Aransas County and Refugio County relating to boundary in Copano Bay, a copy of which is hereto attached, made a part of this Order, and hereby referred to; and this Commissioners Court being of opinion, and so finding, that the portion of the boundary line of Aransas and Refugio County traversing Copano Bay never has been defined, surveyed, and marked in accordance with law, and that it is impracticable at this time to designate or locate the channel described in the Acts of Twelfth Legislature of Texas, Adjourned Session, page 1, (Gammel's Laws of Texas, Vol. VII, page 3), and that litigation concerning same would be to no particular purpose, but would be expensive and time-consuming, and that an imperative public necessity exists that such part of said boundary line be fixed and established without delay, in view of mineral development activities in said Bay, and the existent uncertainty and confusion as to jurisdiction of the respective counties and the public authorities thereof over the area within said Bay, especially with regard to matters of ad valorem taxation; and that the courts of both counties have made a bona fide effort to determine the true location of such portion of said boundary as defined by said Act of the Twelfth Legislature, without practical result; and that the line heretofore agreed upon at such joint meetings, and as actually surveyed by the County Surveyors of the two counties, approximates as closely as practicable the line intended by the Legislature; and that said line agreed upon and surveyed does not deprive either county of any area thereof to which it is legally entitled, but, on the other hand, is just, fair and equitable, preserving to each county all of its legitimate and legal territories, and is in the public interest, and in the interest of each county; that said compromise and settlement has been fairly and maturely arrived at and should be ratified and confirmed; and this Court having examined the field notes and maps of said survey returned by said County Surveyors, and finding same to be correct and in order; and having examined the form of the proposed Compact and Agreement, hereinbefore described, and finding that same correctly evidences the understanding and agreements reached at said joint meetings, and a proper disposition of said matter, and that the same should be formally and solemnly executed and mutually delivered by the contracting parties;

IT IS, THEREFORE, ORDERED BY THE COMMISSIONERS COURT OF REFUGIO COUNTY, that said proposed settlement of the controversy heretofore existing between Aransas County and Refugio County as to the true location of the part of their boundary line lying within Copano Bay, be and the same is hereby accepted and approved upon the terms and conditions set forth and contained in said instrument in writing, entitled a Compact and Agreement between Aransas County and Refugio County relating to boundary in Copano Bay, dated December 10, 1951, hereto attached, and made a part hereof, as aforesaid, and that the same be duly and formally executed, and mutually delivered, on behalf of Refugio County, by this Commissioners Court, acting through its members, and by the County Court of Refugio County;

counter 19822

IT IS FURTHER ORDERED that the part of the boundary line of Aransas County and Refugio County traversing Copano Bay be and the same is hereby defined and permanently fixed and established, in accordance with the terms and provisions of said Compact and Agreement, and as surveyed by the County Surveyors of the two counties, viz: Honorable Fred T. Percival, for Aransas County, and Honorable Phillip G. Young, for Refugio County, as set forth in the field notes and map returned by them, as follows, to-wit:

counter 49823

Field notes of a survey of the Aransas-Refugio County Line through Copano Bay made for Aransas and Refugio Counties, Texas.

Said survey is situated within the South Central Zone, Texas Co-ordinate System, is made to conform with said Texas Co-ordinate System as authorized by Article 5300, Revised Civil Statutes of Texas, and is more particularly described by metes and bounds as follows, to-wit:

Beginning at a point in Copano Bay at the mouth of the Aransas River mid-way between the banks of said river, said beginning point is situated at X-925,076.3 varas and Y-31,492.6 varas, Texas Co-ordinate System, South Central Zone, from whence U.S.C. & G. Triangulation Station "Bayside" in Refugio County bears N. $32^{\circ} 00' 24''$ E., 4274.96 varas, and U.S.C. & G. Triangulation Station "Star" in Aransas County Bears S. $86^{\circ} 41' 50''$ E., 6651.77 varas;

Thence, N. $42^{\circ} 49'$ E., along said county line 2175 varas to the center of the Causeway across Copano Bay on Texas Farm Road 136, midway between the N and S ends of said Causeway, for a corner of this survey, at X-926,554.5 varas and Y-33,088.0 varas, Texas Co-ordinate System, South Central Zone;

Thence, N. $66^{\circ} 26'$ E., along said county line, 9620 varas to a corner of this survey at X-935,372.2 varas and Y-36,934.3 varas, Texas Co-ordinate System, South Central Zone;

Thence, N. $50^{\circ} 47'$ E., along said county line, 17,950 varas to a corner of this survey off Shell Point at X-949,279.1 varas and Y-48,283.2 varas, Texas Co-ordinate System, South Central Zone;

Thence, N. $17^{\circ} 46'$ E., along said county line, 2100 varas to a corner of this survey off Turtle Point at X-949,919.9 varas and Y-50,283.1 varas, Texas Co-ordinate System, South Central Zone;

Thence, N. $88^{\circ} 36'$ W., along said County line, 1270 varas to a corner of this survey in Copano Lake at X-948,650.3 varas and Y-50,314.1 varas, Texas Co-ordinate System, South Central Zone;

Thence, S. $75^{\circ} 07'$ W., along said County line, 1069 varas to a corner of this survey at the mouth of Copano Creek, midway between its banks at X-947,617.2 varas and Y-50,039.5 varas, Texas Co-ordinate System, South Central Zone, from whence U.S.C. & G. Triangulation Station "Lap" in Refugio County Bears S. $46^{\circ} 04' 22''$ W., 4448.88 varas and U.S.C. & G. Triangulation Station "Pete" in Aransas County Bears S. $62^{\circ} 29' 55''$ E., 4294.79 varas.

counter 49824

Aransas & Refugio Counties

and that said line as so surveyed and established be regarded as the true boundary of said counties within said Copano Bay; and that line be suitably and permanently marked under the supervision of said County Surveyors, as provided in said Compact.

IT IS FURTHER ORDERED that each and every act and thing heretofore done by this Commissioners Court and the members thereof, and the County Court of Refugio County, and by the joint meetings of the County Courts and Commissioners Courts of Aransas and Refugio Counties, at the joint meetings of said courts, and particularly at the meetings held on September 25, 1950, and December 10, 1951, in agreeing upon the location of said part of said boundary line, and in directing the actual survey thereof by the County Surveyors of the two counties, and in receiving and approving the returns of such survey, and the field notes and map thereof, and in defining, fixing, and establishing such line as the true and permanent boundary line of said counties insofar as same traverses said Copano Bay, and in ordering said line to be suitably and permanently marked, and in agreeing upon each and all of the matters contained in said written Compact and Agreement, fully and finally defining said boundary and settling said dispute, be, and the same are hereby in all things affirmed, adopted, approved, ratified, and confirmed as the act and deed of Refugio County.

COMMISSIONERS COURT OF REFUGIO
COUNTY

BY

J. B. Juhn
County Judge

J. H. Head
Commissioner, Precinct No. 1

Hugh Christian
Commissioner, Precinct No. 2

Francis West
Commissioner, Precinct No. 3

Clarke Adkins
Commissioner, Precinct No. 4

THE STATE OF TEXAS,)
COUNTY OF REFUGIO.)

I, BETTIE ADKINS, Clerk of the County Court and Ex Officio Clerk of the Commissioners' Court of Refugio County, Texas, do hereby certify that the above and foregoing is a true and correct executed copy of an ORDER OF COMMISSIONERS' COURT, passed December 10, 1951, as the same appears of record in Vol. 10, Pages 114-116, Commissioners' Court Minutes of Refugio County, Texas.

TO CERTIFY, Witness my hand and seal of office, at office in Refugio, Texas, this the 26th day of January, A.D. 1952.

Bettie Adkins
Clerk, County Court, and Ex Officio
Clerk, Commissioners' Court,
Refugio County, Texas.

counter 49825

ORDER OF THE COUNTY COURT OF ARANSAS COUNTY

In the Matter of
Boundaries of Aransas and Refugio
County through Copano Bay

¶
¶
¶

In the County Court of Aransas
County, Texas

On this the 10th day of December, A. D. 1951, it appearing to the County Court of Aransas County, Texas, that the part of the boundary line between Aransas County and Refugio County extending through Copano Bay has been settled and determined by agreements reached at four joint meetings of the County Courts and County Commissioners Courts of Aransas and Refugio Counties, and that the line so agreed upon has been actually surveyed by the County Surveyors of the respective counties, viz: Hon. Fred T. Percival, County Surveyor of Aransas County, and Hon. Phillip G. Young, County Surveyor of Refugio County, pursuant to authorization and direction of the joint meeting of said Courts held in Rockport, Texas, on September 25, 1950, and that said surveyors have made due return of the field notes and map of such actual survey to the joint meeting of said County and Commissioners Courts of the two counties held at Rockport, Texas, heretofore on December 10, 1951, at which such field notes, maps and reports were duly inspected, examined, received and approved, and the line evidenced by said field notes and map was agreed upon by all of said Courts to be the true boundary line between Aransas County and Refugio County extending through Copano Bay from the mouth of Aransas River to the mouth of Copano Creek, such action of such last joint meeting being memorialized and evidenced by a written Compact or Agreement of settlement and compromise between and on behalf of said two counties, dated December 10, 1951, a copy of which is to be duly entered in the Minutes of the Commissioners Court of Aransas County, Texas, is hereby referred to, and made a part of this order without necessity recopying the same herein or in the Minutes of the County Court;

NOW, THEREFORE, IT IS ORDERED, ADJUDGED AND DECREED BY THE COUNTY COURT OF ARANSAS COUNTY, TEXAS, sitting in Aransas County, Texas, that said Compact and Agreement of compromise and settlement, promulgated the said joint meeting of said Courts at Rockport, Texas, on December 10, 1951, and bearing said date, and hereinbefore described and referred to, be, and the same is hereby, affirmed, adopted, ratified and confirmed in all respects as the act and deed of Aransas County, Texas, and that the same be executed by the Judge of this Court and the Commissioners Court of Aransas County for and on behalf of Aransas County, and that the Clerk of this Court duly attest the same; and that the return of the field notes and map of said survey made by the said county surveyors of said counties, as aforesaid, be, and the same are hereby received, approved and accepted by and on behalf of the County of Aransas, and the same shall be recorded by the Clerk of this Court, as provided by statute, together with certified copies supporting orders of the County and Commissioners Courts of Aransas County, and a certified copy thereof be returned to the Commissioner of the General Land Office as required by the statute and said Compact and Agreement;

IT IS FURTHER ORDERED, ADJUDGED AND DECREED BY THE COURT that the portion of the boundary line between Aransas and Refugio County which extends in and across Copano Bay, be, and the same is hereby, fixed and established and same shall be regarded hereafter as the true boundary line between said counties in accordance with said Compact and Agreement as follows, to-wit:

counter 49824

Field notes of a survey of the Aransas-Refugio County Line through Copano Bay made for Aransas and Refugio Counties, Texas.

Said survey is situated within the South Central Zone, Texas Co-ordinate System, is made to conform with said Texas Co-ordinate System as authorized by Article 5300, Revised Civil Statutes of Texas, and is more particularly described by metes and bounds as follows, to-wit:

Beginning at a point in Copano Bay at the mouth of the Aransas River mid-way between the banks of said river, said beginning point is situated at X-925, 076.3 varas and Y-31, 492.6 varas, Texas Co-ordinate System, South Central Zone, from whence U.S.C. & G. Triangulation Station "Bayside" in Refugio County bears N. $32^{\circ} 00' 24''$ E., 4274.96 varas, and U.S.C. & G. Triangulation Station "Star" in Aransas County Bears S. $86^{\circ} 41' 50''$ E., 6651.77 varas;

Thence, N. $42^{\circ} 49'$ E., along said county line 2175 varas to the center of the Causeway across Copano Bay on Texas Farm Road 136, midway between the N and S ends of said Causeway, for a corner of this survey, at X-926, 554.5 varas and Y-33, 088.0 varas, Texas Co-ordinate System, South Central Zone;

Thence, N. $66^{\circ} 26'$ E., along said county line, 9620 varas to a corner of this survey at X-935, 372.2 varas and Y-36, 934.3 varas, Texas Co-ordinate System, South Central Zone;

Thence, N. $50^{\circ} 47'$ E., along said county line, 17,950 varas to a corner of this survey off Shell Point at X-949, 279.1 varas and Y-48, 283.2 varas, Texas Co-ordinate System, South Central Zone;

Thence, N. $17^{\circ} 46'$ E., along said county line, 2100 varas to a corner of this survey off Turtle Point at X-949, 919.9 varas and Y-50, 283.1 varas, Texas Co-ordinate System, South Central Zone;

Thence, N. $88^{\circ} 36'$ W., along said County line, 1270 varas to a corner of this survey in Copano Lake at X-948, 650.3 varas and Y-50, 314.1 varas, Texas Co-ordinate System, South Central Zone;

Thence, S. $75^{\circ} 07'$ W., along said County line, 1069 varas to a corner of this survey at the mouth of Copano Creek, midway between its banks at X-947, 617.2 varas and Y-50, 039.5 varas, Texas Co-ordinate System, South Central Zone, from whence U.S.C. & G. Triangulation Station "Lap" in Refugio County Bears S. $46^{\circ} 04' 22''$ W., 4448.88 varas and U.S.C. & G. Triangulation Station "Pete" in Aransas County Bears S. $62^{\circ} 29' 55''$ E., 4294.79 varas.

IT IS FURTHER ORDERED, ADJUDGED AND DECREED BY THE COURT that said boundary line, as hereinbefore fixed, established and surveyed, be suitably and permanently marked as provided by statute and by said compact and agreement, under the supervision of said county surveyors, at the joint expense of said counties; and that said Surveyors make due report to this Court when such marking has been completed.

IT IS FURTHER ORDERED, ADJUDGED AND DECREED BY THE COURT that each and every act heretofore done by the County Court of Aransas County and the Commissioners Court of Aransas County and by the County Courts and Commissioners Courts of the said two counties at the joint meetings of said Courts in agreeing upon the true location of said part of said boundary line, and in directing the actual survey thereof, and in receiving and approving the returns of such survey and the field notes and map thereof, and in fixing and establishing such line as the true and permanent boundary line of said counties insofar as same traverses said Copano Bay, and in ordering said line to be suitably and permanently marked, and in agreeing upon each and all of the matters contained in said written Compact and Agreement of settlement and compromise, be, and the same are hereby in all things affirmed, adopted, approved, ratified, and confirmed as the act and deed of Aransas County, Texas.

IT IS FURTHER ORDERED, ADJUDGED AND DECREED BY THE COURT that special public notice be given of the establishment of such part of said boundary line by the publication of the field notes of such line one time in each newspaper published in Aransas County, Texas, so that the public generally may be informed with reference thereto.

ATTEST: (Seal)

Wes C Herring

Clerk of the County Court of

Aransas County, Texas.

John D. Wendell
Judge of the County Court of
County, Texas.

- - - -

Counter 19828

THE STATE OF TEXAS)
COUNTY OF ARANSAS)

I, JAS. C. HERRING, Clerk of the County Court in and for said County and State, do hereby certify that the within and foregoing is a true and correct copy of ORDER OF THE COUNTY COURT OF ARANSAS COUNTY, now on file in this office and recorded in Volume 4, pages 168-170, Minutes of County Court of Aransas County, Texas.

GIVEN under my hand and seal of office, this the 11th day of December, A. D. 1951.

JAS C. HERRING
County Court, Aransas Co., Texas.

(Seal)

By Wreath B. Johnson Deputy

- - - -

THE STATE OF TEXAS,)
COUNTY OF REFUGIO.)

I, BETTIE ADKINS, Clerk of the County Court and Ex Officio Clerk of the Commissioners' Court of Refugio County, Texas, do hereby certify that the above and foregoing is a true and correct executed copy of CERTIFIED COPY OF ORDER OF THE COUNTY COURT OF ARANSAS COUNTY RELATING TO BOUNDARY IN COPANO BAY BETWEEN ARANSAS COUNTY AND REFUGIO COUNTY, as the same appears of record in Volume 10, Pages 118-120, Minutes of Commissioners' Court of Refugio County, Texas.

TO CERTIFY, Witness my hand and seal of office, this 28th day of January, A. D. 1952.

BETTIE ADKINS,
Clerk, County Court and Ex Officio
Clerk, Commissioners' Court, Refugio
County, Texas.

By Margaret W. Shires, Deputy.

counter 49829

ORDER OF COMMISSIONERS COURT

On this the 10th day of December, A. D., 1951, the Commissioners Court of Aransas County, Texas, convened in its own courtroom, in the courthouse of its own county, at Rockport, Texas, all members being present and participating, following adjournment of the joint meeting of the County and Commissioners Courts of Aransas and Refugio Counties, held at Rockport, Texas, earlier the same day, whereat an agreement was reached between the two counties defining and establishing the location of that part of the boundary of said counties extending through Copano Bay; whereupon, said Commissioners Court sitting separately and within its own jurisdiction took up and duly considered the matter of the understanding and agreement reached at said joint meeting, which agreement is evidenced, set forth, and contained in an instrument in writing prepared by legal counsel of both counties, and denominated a Compact and Agreement between Aransas County and Refugio County relating to boundary in Copano Bay, a copy of which is hereto attached, made a part of this Order, and hereby referred to; and this Commissioners Court being of opinion, and so finding, that the portion of the boundary line of Aransas and Refugio County traversing Copano Bay never has been defined, surveyed, and marked in accordance with law, and that it is impracticable at this time to designate or locate the channel described in the Acts of Twelfth Legislature of Texas, Adjourned Session, page 1, (Gammel's Laws of Texas, Vol. VII, page 3), and that litigation concerning same would be to no particular purpose, but would be expensive and time-consuming, and that an imperative public necessity exists that such part of said boundary line be fixed and established without delay, in view of mineral development activities in said Bay, and the existent uncertainty and confusion as to jurisdiction of the respective counties and the public authorities thereof over the area within said Bay, especially with regard to matters of ad valorem taxation; and that the courts of both counties have made a bona fide effort to determine the true location of such portion of said boundary as defined by said Act of the Twelfth Legislature, without practical result; and that the line heretofore agreed upon at such joint meetings, and as actually surveyed by the County Surveyors of the two counties, approximates as closely as practicable the line intended by the Legislature; and that said line agreed upon and surveyed does not deprive either county of any area thereof to which it is legally entitled, but, on the other hand, is just, fair and equitable, preserving to each county all of its legitimate and legal territories, and is in the public interest, and in the interest of each county; that said compromise and settlement has been fairly and maturely arrived at and should be ratified and confirmed; and this Court having examined the field notes and maps of said survey returned by said County Surveyors, and finding same to be correct and in order; and having examined the form of the proposed Compact and Agreement, hereinbefore described, and finding that same correctly evidences the understanding and agreements reached at said joint meetings, and a proper disposition of said matter, and that the same should be formally and solemnly executed and mutually delivered by the contracting parties;

IT IS, THEREFORE, ORDERED BY THE COMMISSIONERS COURT OF ARANSAS COUNTY, that said proposed settlement of the controversy heretofore existing between Aransas County and Refugio County as to the true location of the part of their boundary line lying within Copano Bay, be and the same is hereby accepted and approved upon the terms and conditions set forth and contained in said instrument in writing, entitled a Compact and Agreement between Aransas County and Refugio County relating to boundary in Copano Bay, dated December 10, 1951, hereto attached, and made a part hereof, as aforesaid, and that the same be duly and formally executed, and mutually delivered, on behalf of Aransas County, by this Commissioners Court, acting through its members, and by the County Court of Aransas County;

counter 49830

IT IS FURTHER ORDERED that the part of the boundary line of Aransas County and Refugio County traversing Copano Bay be and the same is hereby defined and permanently fixed and established, in accordance with the terms and provisions of said Compact and Agreement, and as surveyed by the County Surveyors of the two counties, viz: Honorable Fred T. Percival, for Aransas County, and Honorable Phillip G. Young, for Refugio County, as set forth in the field notes and map returned by them, as follows, to-wit:

counter 49831

Aransas & Refugio Counties

Field notes of a survey of the Aransas-Refugio County Line through Copano Bay made for Aransas and Refugio Counties, Texas.

Said survey is situated within the South Central Zone, Texas Co-ordinate System, is made to conform with said Texas Co-ordinate System as authorized by Article 5300, Revised Civil Statutes of Texas, and is more particularly described by metes and bounds as follows, to-wit:

Beginning at a point in Copano Bay at the mouth of the Aransas River mid-way between the banks of said river, said beginning point is situated at X-925, 076.3 varas and Y-31, 492.6 varas, Texas Co-ordinate System, South Central Zone, from whence U. S. C. & G. Triangulation Station "Bayside" in Refugio County bears N. $32^{\circ} 00' 24''$ E., 4274.96 varas, and U. S. C. & G. Triangulation Station "Star" in Aransas County Bears S. $86^{\circ} 41' 50''$ E., 6651.77 varas;

Thence, N. $42^{\circ} 49'$ E., along said county line 2175 varas to the center of the Causeway across Copano Bay on Texas Farm Road 136, midway between the N and S ends of said Causeway, for a corner of this survey, at X-926, 554.5 varas and Y-33, 088.0 varas, Texas Co-ordinate System, South Central Zone;

Thence, N. $66^{\circ} 26'$ E., along said county line, 9620 varas to a corner of this survey at X-935, 372.2 varas and Y-36, 934.3 varas, Texas Co-ordinate System, South Central Zone;

Thence, N. $50^{\circ} 47'$ E., along said county line, 17,950 varas to a corner of this survey off Shell Point at X-949, 279.1 varas and Y-48, 283.2 varas, Texas Co-ordinate System, South Central Zone;

Thence, N. $17^{\circ} 46'$ E., along said county line, 2100 varas to a corner of this survey off Turtle Point at X-949, 919.9 varas and Y-50, 283.1 varas, Texas Co-ordinate System, South Central Zone;

Thence, N. $88^{\circ} 36'$ W., along said County line, 1270 varas to a corner of this survey in Copano Lake at X-948, 650.3 varas and Y-50, 314.1 varas, Texas Co-ordinate System, South Central Zone;

Thence, S. $75^{\circ} 07'$ W., along said County line, 1069 varas to a corner of this survey at the mouth of Copano Creek, midway between its banks at X-947, 617.2 varas and Y-50, 039.5 varas, Texas Co-ordinate System, South Central Zone, from whence U. S. C. & G. Triangulation Station "Lap" in Refugio County Bears S. $46^{\circ} 04' 22''$ W., 4448.88 varas and U. S. C. & G. Triangulation Station "Pete" in Aransas County Bears S. $62^{\circ} 29' 55''$ E., 4294.79 varas.

and that said line as so surveyed and established be regarded as the true boundary of said counties within said Copano Bay; and that line be suitably and permanently marked under the supervision of said County Surveyors, as provided in said Compact.

IT IS FURTHER ORDERED that each and every act and thing heretofore done by this Commissioners Court and the members thereof, and the County Court of Aransas County, and by the joint meetings of the County Courts and Commissioners Courts of Aransas and Refugio Counties, at the joint meetings of said courts, and particularly at the meetings held on September 25, 1950, and December 10, 1951, in agreeing upon the location of said part of said boundary line, and in directing the actual survey thereof by the County Surveyors of the two counties, and in receiving and approving the returns of such survey, and the field notes and map thereof, and in defining, fixing, and establishing such line as the true and permanent boundary line of said counties insofar as same traverses said Copano Bay, and in ordering said line to be suitably and permanently marked, and in agreeing upon each and all of the matters contained in said written Compact and Agreement, fully and finally defining said boundary and settling said dispute, be, and the same are hereby in all things affirmed, adopted, approved, ratified, and confirmed as the act and deed of Aransas County.

COMMISSIONERS COURT OF ARANSAS
COUNTY

BY

John D. Wendell

County Judge

W. B. Allen

Commissioner, Precinct No. 1

J. M. Sparks Jr.

Commissioner, Precinct No. 2

A. L. Davis

Commissioner, Precinct No. 3

J. H. Mills

Commissioner, Precinct No. 4

ATTEST: (Seal)

Jas C. Herring

JAS. C. HERRING, Clerk County Court
and Ex-Officio Clerk Commissioners
Court, Aransas County, Texas.

counter 49833

THE STATE OF TEXAS)

COUNTY OF ARANSAS)

I, JAS. C. HERRING, County Clerk and Ex-Officio Clerk of Commissioners' Court of Aransas County, do hereby certify that the within and foregoing is a true and correct copy of ORDER OF COMMISSIONERS' COURT now on file in this office, and recorded in Volume 10, pages 96, et seq. Minutes of Commissioners Court of Aransas County, Texas.

GIVEN under my hand and seal of office, this the 10th day of December, A. D. 1951.

(Seal) Jas. C. Herring
JAS. C. HERRING, Clerk County Court,
and Ex-Officio Clerk Commrs. Court,
Aransas County.

- - - -

THE STATE OF TEXAS)

COUNTY OF REFUGIO)

I, BETTIE ADKINS, Clerk of the County Court and Ex-Officio Clerk of the Commissioners' Court of Refugio County, Texas. do hereby certify that the above and foregoing is a true and correct executed copy of CERTIFIED COPY OF ORDER OF COMMISSIONERS COURT RELATING TO BOUNDARY IN COPANO BAY BETWEEN ARANSAS COUNTY AND REFUGIO COUNTY, as the same appears of record in Volume 10, Pages 120-122, 104-106 Minutes of Commissioners' Court of Refugio County, Texas.

TO CERTIFY, Witness my hand and seal of office, this the 28th day of January, A. D. 1952.

BETTIE ADKINS,
Clerk, County Court and Ex-Officio
Clerk, Commissioners' Court, Refugio
County, Texas.
By Margaret W. Shires, Deputy.

counter 49834

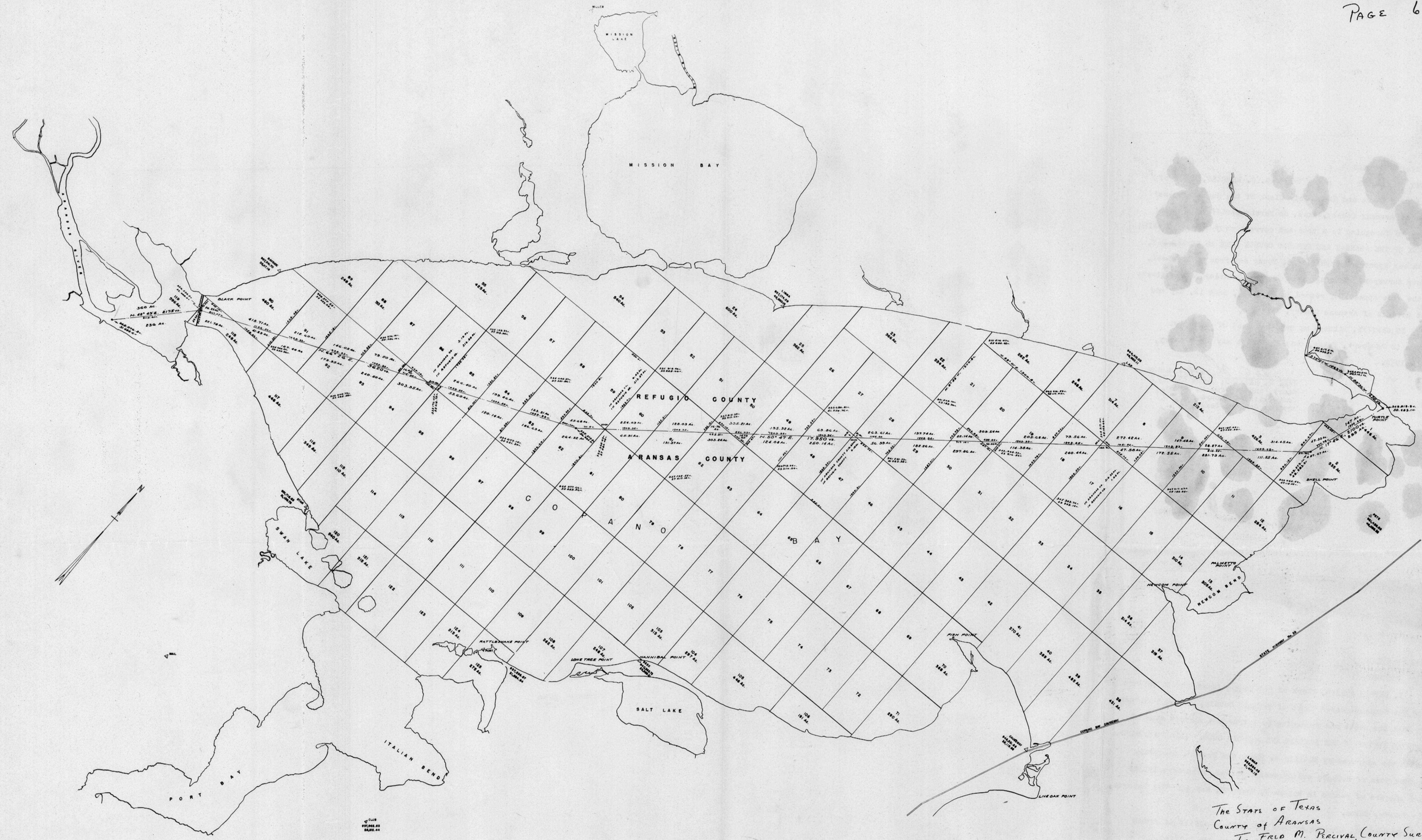

THE STATE OF TEXAS
 COUNTY OF REFUGIO
 PHILLIP G. YOUNG, County Surveyor of Refugio County, Texas, do hereby certify that the Aransas-Refugio County line is located in Copano Bay in accordance with instructions of the Commissioners' Court of Aransas and Refugio Counties, Texas, from an actual survey along the north shore of Copano Bay, made by me on the ground, surveyed November 15, 1881.

PHILLIP G. Young
 County Surveyor
 Refugio County, Texas

Surveyor's Note: This survey is made on Lambert Datum. Coordinates on Black Corners are taken from the General Land Office Map of Copano Bay dated December 15, 1849, or revised September 7, 1881. All full blocks are 800 x 1000 or 1000 x 1000 and contain 800 ACRES. Survey of 1881 shows the shore is approximately 1/2 mile from the General Land Office Map.

(ALSO RECORDED IN BOOK 2, PAGE 12, MAP AND PLAT RECORDS, ARANSAS COUNTY.)

PLAT SHOWING
 SURVEY OF THE ARANSAS-REFUGIO
 COUNTY LINE IN COPANO BAY
 SCALE: 1 INCH = 1200 VARAS

FIELD NOTES RECORDED IN:
 COMMISSIONERS' COURT MINUTES - VOLUME 10, PAGE 117
 COUNTY COURT MINUTES - VOLUME 3, PAGE 605
 OF REFUGIO COUNTY, TEXAS

The State of Texas
 County of Aransas
 I, FRED M. PERCIVAL, County Surveyor of Aransas County, Texas, do hereby certify that I have examined the hereinabove survey and find it to be correct, and I do hereby approve it, this the 23rd day of January, 1952.

FRED M. PERCIVAL
 County Surveyor of Aransas County, Texas

count 19835

FILE 2310-X

05 3297

THE STATE OF TEXAS :
 COUNTY OF ARANSAS : I, JAS. C. HERRING, Clerk of
 the County Court and Ex-officio Clerk of the Commissioners'
 Court of Aransas County, Texas, do hereby certify that the
 above and foregoing is a true and correct copy of PLAT SHOWING
 SURVEY OF THE ARANSAS AND REFUGIO COUNTY LINE IN COPANO BAY,
 which was approved by Phillip G. Young and Fred M. Percival,
 County Surveyors of Refugio and Aransas Counties, respectively
 as the same appears of record in Volume 2, page 12, Map and
 Plat Records of Aransas County, Texas.

TO CERTIFY, Witness my hand and seal of office at
 office in Rockport, Texas, this the First day of February,
 A. D. 1952.

Jas C Herring
 JAS. C. HERRING, Clerk County
 Court, and Ex-officio Clerk,
 Commissioners' Court, of
 Aransas County, Texas.

THE STATE OF TEXAS)
 COUNTY OF REFUGIO)

I, BETTIE ADKINS, Clerk of the County Court and Ex Officio
 Clerk of the Commissioners' Court of Refugio County, Texas, do hereby
 certify that the above and foregoing is a true and correct copy of
 PLAT SHOWING SURVEY OF THE ARANSAS AND REFUGIO COUNTY LINE IN COPANO
 BAY, which was approved by Phillip G. Young and Fred M. Percival,
 County Surveyors of Refugio and Aransas Counties, respectively, as
 the same appears of record in Volume 2, Page 60, Map and Plat Records,
 Refugio County, Texas.

TO CERTIFY, Witness my hand and seal of office at office
 in Refugio, Texas, this the 29th day of January, A. D. 1952.

BETTIE ADKINS,
 Clerk, County Court, and Ex Officio Clerk,
 Commissioners' Court, of Refugio County,
 Texas.

Marquet W. Adkins, Deputy.

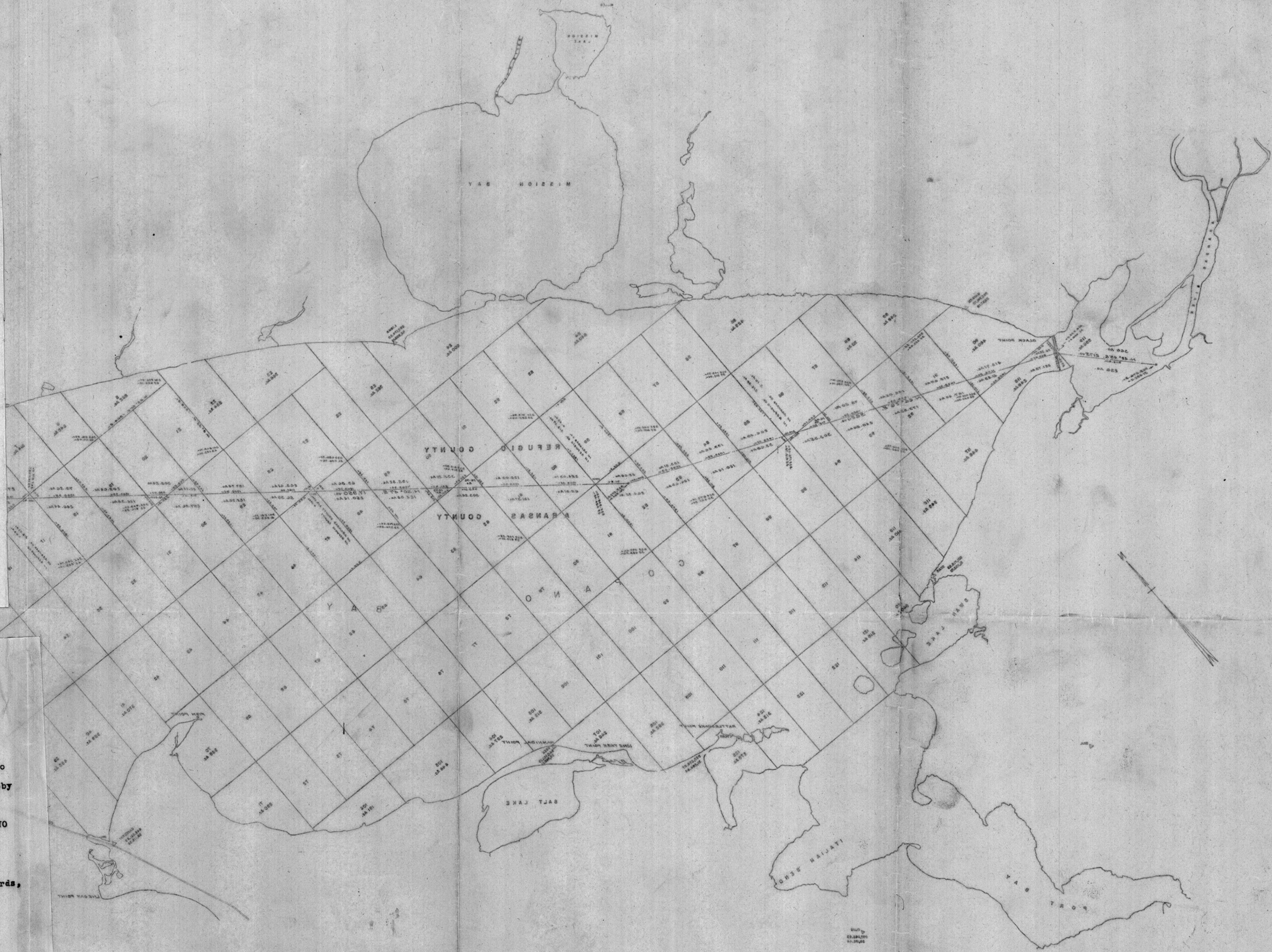

PLAT SHOWING
 SURVEY OF THE ARANSAS-REFUGIO
 COUNTY LINE IN COPANO BAY
 SCALE: 1 INCH = 1000 YARDS

This plat is a true and correct copy of the original plat on file in the County Clerk's Office, Aransas County, Texas.

Also recorded in Book 2, Page 12, Map and Plat Records of Aransas County, Texas.

CERTIFICATE OF CLERK OF ARANSAS COUNTY

I, Jas. C. Herring, the duly elected and qualified County Clerk of Aransas County, Texas, and being, by virtue of my said office, Clerk of the County Court of Aransas County and Clerk of the Commissioners Court of Aransas County, do hereby certify in each of my said official capacities to the Commissioner of the General Land Office of the State of Texas, that the attached and within map and proceedings comprise a full, complete and correct transcript of all proceedings had in my county in the County Court and the Commissioners Court in the matter of the designation of the boundary line between Aransas and Refugio Counties, Texas, in so far as the same extends through Copano Bay, as compromised and agreed upon by the County Courts and the Commissioners Courts of the two counties, as set forth in the respective certified copies of proceedings hereto attached and made part of this record and transcript. This transcript contains the following instruments, to-wit:

1. Certified copy of field notes of survey of said portion of said county boundary line as surveyed and marked by Honorable Fred T. Percival, County Surveyor of Aransas County, Texas, and Honorable Phillip G. Young, County Surveyor of Refugio County, Texas, in pursuance to directives of the County Court and Commissioners Court of said two counties, which said field notes are recorded in Volume 10, page 98, of the Minutes of the Commissioners Court of Aransas County, Texas.
2. Certified copy of map of Copano Bay showing the subdivision thereof and the mineral development units as made by Commissioner of the General Land Office and the location of such part of said division line extending there-through, made and prepared by the County Surveyors of said respective counties, which said map is recorded in Volume 2, page 12, of the Map and Plat Records of Aransas County, Texas.
3. Certified copies of the Minutes of the Commissioners Court of Aransas County, Texas, showing proceedings had on September 25, 1950, wherein the location of the said portion of said county line was indicated at the joint meeting, which said minutes are recorded in Volume 9, page 583, of the Minutes of the Commissioners Court of Aransas County, Texas.
4. Certified copy of Compact between the County Courts and the County

counter 49837

Commissioners Court of Aransas and Refugio Counties, Texas, made and entered into on December 10, 1951, at Rockport, Texas, which said Compact is recorded in Volume 10, pages 96 et seq, of the Minutes of the Commissioners Court of Aransas County, Texas.

5. Certified copy of order of the County Court of Aransas County approving the Compact and said Surveyors map and field notes entered on December 10, 1951, and entered in Volume 4, pages 168 et seq, of the Minutes of the County Court of Aransas County, Texas.

6. Certified copy of order of the Commissioners Court of Aransas County, Texas, authorizing and approving said Compact and said Surveyors map and field notes entered on December 10, 1951, and duly entered in Volume 10, pages 96 et seq, of the Minutes of the Commissioners Court of Aransas County, Texas.

7. Certified copy of copy of order of County Court of Refugio County, Texas, approving and adopting said Compact and said Surveyors field notes and map entered on December 10, 1951, in Volume 3, page 602, of the Minutes of the County Court of Refugio County, Texas, as duly certified by the Clerk of said court and certified copy of which being recorded in Volume 10, page 102, of the Commissioners Court Records of Aransas County, Texas.

8. Certified copy of copy of order of the Commissioners Court of Refugio County, Texas, adopting and approving said Compact and approving said Surveyors field notes and map entered on December 10, 1951, in Volume 10, pages 118 et seq, of the Commissioners Court Minutes of Refugio County, Texas, copy of which certified by the Clerk of said Court being recorded in Volume 10, page 104, of the Minutes of the Commissioners Court of Aransas County, Texas.

IN TESTIMONY WHEREOF, witness my hand and official seals of office in each such designated capacity, at office, in Rockport, Texas, on this the 14 day of Feb., A. D. 1952.

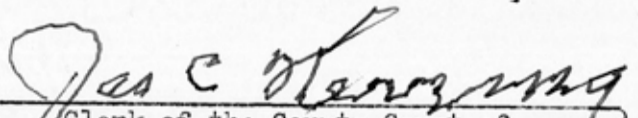
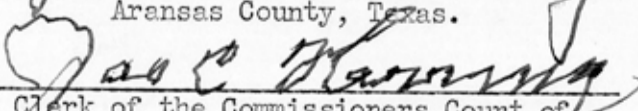
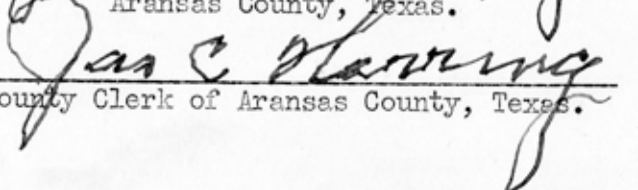
Clerk of the County Court of
Aransas County, Texas.

Clerk of the Commissioners Court of
Aransas County, Texas.

County Clerk of Aransas County, Texas.

THE STATE OF TEXAS :
COUNTIES OF ARANSAS :
AND REFUGIO

Field notes of a survey of the Aransas-Refugio County Line through Copano Bay made for Aransas and Refugio Counties, Texas.

Said survey is situated within the South Central Zone, Texas Co-ordinate System, is made to conform with said Texas Co-ordinate System as authorized by Article 5300, Revised Civil Statutes of Texas, and is more particularly described by metes and bounds as follows, to-wit:

Beginning at a point in Copano Bay at the mouth of the Aransas River mid-way between the banks of said river, said beginning point is situated at X-925, 076.3 varas and Y-31, 492.6 varas, Texas Co-ordinate System, South Central Zone, from whence U. S. C. & G. Triangulation Station "Bayside" in Refugio County bears N. $32^{\circ} 00' 24''$ E., 4274.96 varas, and U. S. C. & G. Triangulation Station "Star" in Aransas County Bears S. $86^{\circ} 41' 50''$ E., 6651.77 varas;

Thence, N. $42^{\circ} 49'$ E., along said county line 2175 varas to the center of the Causeway across Copano Bay on Texas Farm Road 136, midway between the N and S ends of said Causeway, for a corner of this survey, at X-926, 554.5 varas and Y-33, 088.0 varas, Texas Co-ordinate System, South Central Zone;

Thence, N. $66^{\circ} 26'$ E., along said county line, 9620 varas to a corner of this survey at X-935, 372.2 varas and Y-36, 934.3 varas, Texas Co-ordinate System, South Central Zone;

Thence, N. $50^{\circ} 47'$ E., along said county line, 17,950 varas to a corner of this survey off Shell Point at X-949, 279.1 varas and Y-48, 283.2 varas, Texas Co-ordinate System, South Central Zone;

Thence, N. $17^{\circ} 46'$ E., along said county line, 2100 varas to a corner of this survey off Turtle Point at X-949, 919.9 varas and Y-50, 283.1 varas, Texas Co-ordinate System, South Central Zone;

Thence, N. $88^{\circ} 36'$ W., along said County line, 1270 varas to a corner of this survey in Copano Lake at X-948, 650.3 varas and Y-50, 314.1 varas, Texas Co-ordinate System, South Central Zone;

Thence, S. $75^{\circ} 07'$ W., along said County line, 1069 varas to a corner of this survey at the mouth of Copano Creek, midway between its banks at X-947, 617.2 varas and Y-50, 039.5 varas, Texas Co-ordinate System, South Central Zone, from whence U. S. C. & G. Triangulation Station "Lap" in Refugio County Bears S. $46^{\circ} 04' 22''$ W., 4448.88 varas and U. S. C. & G. Triangulation Station "Pete" in Aransas County Bears S. $62^{\circ} 29' 55''$ E., 4294.79 varas.

THE STATE OF TEXAS :
COUNTY OF REFUGIO :

I, PHILLIP G. YOUNG, County Surveyor of Refugio County, Texas, do hereby certify that the Aransas-Refugio County line is located in Copano Bay in accordance with instructions of the Commissioners' Courts of Aransas and Refugio Counties, Texas, from an actual survey along the North shore of Copano Bay, made by me on the ground.

counter 49839

Surveyed November 15, 1951.

PHILLIP G. YOUNG
County Surveyor
Refugio County, Texas

ENDORSED: FIELD NOTE BY SURVEYOR ARANSAS-REFUGIO COUNTY LINE
THROUGH COPANO BAY: FILED DEC. 10, 1951 JAS. C. HERRING, COUNTY
CLERK, ARANSAS CO., TEXAS. BY WRETHA B. JOHNSON, DEPUTY

THE STATE OF TEXAS :

COUNTY OF ARANSAS :

I, JAS. C. HERRING, Clerk of the County Court and
Ex Officio Clerk of the Commissioners' Court of Aransas County,
Texas, do hereby certify that the above and foregoing is a true
and correct copy of the FIELD NOTES BY THE COUNTY SURVEYOR OF
REFUGIO COUNTY, TEXAS RELATING TO BOUNDARY IN COPANO BAY BETWEEN
ARANSAS AND REFUGIO COUNTIES, as the same appears of record in
Volume 10, pages 98-99, Minutes of Commissioners' Court of
Aransas County, Texas.

Given under my hand and seal of office, this the
4 day of February, 1952.

JAS. C. HERRING
Clerk, County Court and Ex Officio
Clerk, Commissioners' Court, Aransas
County, Texas

(Seal)

BY Wretha B. Johnson Deputy

3

NPTO

NUNC PRO TUNC ORDER

BE IT REMEMBERED that on Monday, September 25, 1950, at 9 A. M., the Commissioners Court of Refugio County, Texas, met in joint session with the Commissioners Court of Aransas County, Texas, at Rockport, Texas, in the District Court Room there, for the purpose of determining whether or not an agreement could be reached with reference to the location of the part of the boundary line of the two counties lying in Copano Bay. Attending said meeting from Refugio County were Hon. T. G. Jeter, County Judge, Hon. T. J. Heard, Hon. Hugo Geistman, Hon. Francis West and Hon. Clarke Adkins, County Commissioners, Hon. Phillip G. Young, County Surveyor, Hobart Huson and Gerald T. Bissetts, Esqs., special counsel for Refugio County and Messrs, George Dahse and Howard DeViney, Business manager and superintendent, respectively, of the Woodsboro Independent School District, of Refugio County.

Representing Aransas County in attendance was County Judge D. R. Simmons, and all of the County Commissioners, together with Hon. Weldon Cabaniss, County Attorney of Aransas County and Hon. Emory M. Spencer, special counsel for Aransas County and Hon. Fred T. Percival, County Surveyor of Aransas County. There were present also representatives of the Rockport Independent School District of Aransas County, including Mr. Jess Harbin.

This was the third joint meeting of the two Commissioners Courts since 1947.

A tentative agreement of settlement of said division line was made by the members of the two courts, subject to ratifications at legal meetings thereof to be held within their own counties after Engineer's field notes of said division line have been prepared by or under the supervision of the County Surveyors of the two counties, and suitable orders have been drafted and agreed upon by counsel for the respective counties.

THE STATE OF TEXAS,
COUNTY OF ARANSAS.

I, JAS. C. HERRING, CLERK OF THE COUNTY COURT AND EX-OFFICIO CLERK of the COMMISSIONERS' COURT of Aransas County, Texas, do hereby certify that the above and foregoing is a true and correct copy of the NUNC PRO TUNC ORDER RELATING TO THE BOUNDARY IN COPANO BAY BETWEEN ARANSAS AND REFUGIO COUNTIES, as the same appears of record in Volume 10, page 120, Minutes of the Commissioners' Court Records of Aransas County, Texas.

GIVEN UNDER MY HAND AND SEAL OF OFFICE at office in Aransas County, Texas, this the 4th. day of February, A. D. 1952.

JAS. C. HERRING
Clerk, County Court, and Ex-
Officio Clerk, Commissioners'
Court, Aransas County, Texas.

By Walter B. Johnson Deputy.

COMPACT AND AGREEMENT
BETWEEN ARANSAS COUNTY AND REFUGIO COUNTY
RELATING TO BOUNDARY IN COPANO BAY

THIS COMPACT AND AGREEMENT OF COMPROMISE made and entered into on this 10th day of December, 1951, by and on behalf of ARANSAS COUNTY and REFUGIO COUNTY, duly established and constituted counties and bodies corporate and politic of the State of Texas, represented hereunto and acting by and through their respective County Courts and Commissioners' Courts, pursuant to Orders of each such respective Courts, made and entered at a meeting of such Court legally and duly held within its own County and jurisdiction in the manner prescribed by law, certified copies of such respective Orders being hereto attached and hereby referred to, and attested by the respective Clerks of such Courts under their respective several Official Seals,

W I T N E S S E T H: -

WHEREAS, Aransas County was created from territory embraced within the limits of Refugio County, by Act of the Twelfth Legislature of the State of Texas, Adjourned Session, approved September 18, 1871, as shown by Acts of 1871, Second Session, page 1 (Gammel's Laws, Volume VII, page 3), the first two section of said Act being in words and figures, as follows, to-wit:

"Section 1. Be it enacted by the Legislature of the State of Texas, That all territory comprised within the following limits, to-wit:

"Beginning at the boundary of the State on the Gulf of Mexico, opposite the center of the channel of Aransas Pass, between the islands of St. Joseph and Mustang;

"Thence, with the line between the counties of San Patricio and Refugio, to the center of Aransas River;

"Thence, down the center of said stream to Copano Bay;

"Thence, with the channel of said bay parallel with the shore, to the east end of the same at the mouth of Copano creek;

"Thence, up said creek to the mouth of Alamita creek;

"Thence, in a direct line to the southeast corner of J. C. Stolberg survey on Esperitu Santo Bay;

"Thence, in a direct line, to Cedar Bayou;

"Thence, through said bayou, to the boundary of the State, on the Gulf of Mexico;

"Thence, with said boundary of the State, to the place of beginning,

be and the same is hereby created a county, to be called the county of Aransas, and the town of Rockport is hereby declared the county seat of said county.

Sec. 2. That the remaining portion of the county of Refugio shall constitute and be called Refugio county, and the town of Refugio shall be the county seat of said Refugio County;" and

counter 49843

WHEREAS, the portion of the boundary line between said two counties extending through Copano Bay from the mouth of Aransas River to the mouth of Copano Creek, never has been defined, established, surveyed, or marked, and the true location of the same is undefined, uncertain, and disputed at the present time; in that there appears to be two mouths of Aransas River, and there are three or more well-known and well-defined channels through said bay; one being the Smith channel lying off and approximately paralleling the shore of Aransas County; one, the name of which, if any, is now unknown, lying off and approximately paralleling the shore of Refugio County; and one being the old main navigation channel, which parallels neither shore but zigzags back and forth between the two shores; and that a bona fide dispute has arisen and now exists between the two counties as to the location of such portion of said common boundary line; and

WHEREAS, oil, gas, and other minerals have been discovered to exist in said Copano Bay, and the Commissioner of the General Land Office of the State of Texas, pursuant to law, has had said bay, and other submerged lands belonging to the State of Texas, surveyed and platted into mineral subdivisions for mineral exploration and development purposes, as evidenced by a map or plat of such Subdivision established and promulgated by said Land Office Commissioner, and to which reference is here made; and said Commissioner has made numerous mineral leases to private persons and concerns of tracts or blocks of said mineral subdivision of the submerged lands of said bay, and in all probability in like manner will lease all of the submerged lands of said bay for such purposes; whereby the lessee's working interests and estates created by such mineral lease contracts, being privately owned property, are and will be subject to ad valorem taxation by the county and taxing units thereof in which such tracts may be located; and numerous producing wells for oil and gas have been and are being drilled in said bay, thereby creating large taxable values which heretofore were non-existent; and

WHEREAS, notice has been given by the Commissioner of the General Land Office to each the County Courts of Aransas County and Refugio County that the aforesaid part of said boundary line is not sufficiently definite and well defined; such notice being in the form of a letter dated April 15, 1947; and

WHEREAS, said part of said boundary line is indefinite, as aforesaid, and also because of its peculiar nature, it is impracticable to survey and mark same in the manner prescribed by Chapter Four of Title 33, Revised Civil Statutes; and

WHEREAS, in order to avoid more confusion and uncertainty in the rendition and assessment of submerged lands and interests therein for ad valorem taxation, and in the exercise of civil and criminal jurisdiction, and in the conduct of private business with reference thereto, it is thought desirable that the line to be agreed upon should be as practically regular as possible, and that unusual and practically undefinable contours and contortions should be avoided as much as possible, to the end that public officials, citizens, and private property owners may be able to readily recognize and ascertain the approximate location of such boundary line with the least difficulty, uncertainty, and expense; and

WHEREAS, after due mutual notices the County Courts and Commissioners Courts of the two counties have held a series of joint meetings for the purpose of arriving at a legal, just, and practicable solution of their common problem, and of a practical means and method of defining, locating, establishing, and marking said part of said boundary line; and at the third of said series of joint meetings, held at Rockport, Texas, on September 25, 1950, said courts mutually agreed that the said part of said line should be surveyed, marked, and due returns made, permanently establishing such part of said line, in accordance with a location and course then and there

indicated by the contracting parties upon the map of Copano Bay, the correct field notes to be determined afterwards by actual survey made by Honorable Fred T. Percival, County Surveyor of Aransas County, and Honorable Phillip G. Young, County Surveyor of Refugio County, they being the duly elected, qualified, and acting County Surveyors of said counties, and having taken the oaths of office and having given official bond; all of which appears from orders of such respective Courts dated September 25, 1950, to which reference is here made; and

WHEREAS, said County Surveyors have run the boundary line agreed upon, as aforesaid, and have made the required return of the field notes and maps to a joint meeting of the County and Commissioners Courts of Aransas and Refugio Counties, called and held after due mutual notice, at Rockport, Texas, on December 10, 1951, at which said surveyors' field notes, maps, reports, and engineering data were received, inspected, examined, and approved by all of the said Courts and the members thereof, and by their legal counsel; and

WHEREAS, said County and Commissioners Courts of said two respective counties, at said joint meeting of December 10, 1951, agreed that all matters of dispute and controversy between the two counties be amicably compromised, settled, and adjusted, by declaring, fixing, and establishing the part of said line as so run, surveyed, and returned by said County Surveyors, as the true and permanent boundary line extending through said Copano Bay, and that said line as surveyed and as agreed upon be suitably and permanently marked as such part of said boundary line;

NOW, THEREFORE, it is agreed by and between the said high contracting parties hereto:

FIRST: That the part of the boundary line of Aransas and Refugio Counties extending through Copano Bay, from the mouth of Aransas River to the mouth of Copano Creek, be and is hereby permanently located, fixed, and established, in accordance with said actual survey made by the County Surveyors of said Counties, as follows:

Field notes of a survey of the Aransas-Refugio County Line through Copano Bay made for Aransas and Refugio Counties, Texas.

Said survey is situated within the South Central Zone, Texas Co-ordinate System, is made to conform with said Texas Co-ordinate System as authorized by Article 5300, Revised Civil Statutes of Texas, and is more particularly described by metes and bounds as follows, to-wit:

Beginning at a point in Copano Bay at the mouth of the Aransas River mid-way between the banks of said river, said beginning point is situated at X-925,076.3 varas and Y-31,492.6 varas, Texas Co-ordinate System, South Central Zone, from whence U.S.C. & G. Triangulation Station "Bayside" in Refugio County bears N. $32^{\circ} 00' 24''$ E., 4274.96 varas, and U.S.C. & G. Triangulation Station "Star" in Aransas County Bears S. $86^{\circ} 41' 50''$ E., 6651.77 varas;

Thence, N. $42^{\circ} 49'$ E., along said county line 2175 varas to the center of the Causeway across Copano Bay on Texas Farm Road 136, midway between the N and S ends of said Causeway, for a corner of this survey, at X-926,554.5 varas and Y-33,088.0 varas, Texas Co-ordinate System, South Central Zone;

Thence, N. $66^{\circ} 26'$ E., along said county line, 9620 varas to a corner of this survey at X-935,372.2 varas and Y-36,934.3 varas, Texas Co-ordinate System, South Central Zone;

Thence, N. $50^{\circ} 47'$ E., along said county line, 17,950 varas to a corner of this survey off Shell Point at X-949,279.1 varas and Y-48,283.2 varas, Texas Co-ordinate System, South Central Zone;

Thence, N. $17^{\circ} 46'$ E., along said county line, 2100 varas to a corner of this survey off Turtle Point at X-949,919.9 varas and Y-50,283.1 varas, Texas Co-ordinate System, South Central Zone;

Thence, N. $88^{\circ} 36'$ W., along said County line, 1270 varas to a corner of this survey in Copano Lake at X-948,650.3 varas and Y-50,314.1 varas, Texas Co-ordinate System, South Central Zone;

Thence, S. $75^{\circ} 07'$ W., along said County line, 1069 varas to a corner of this survey at the mouth of Copano Creek, midway between its banks at X-947,617.2 varas and Y-50,039.5 varas, Texas Co-ordinate System, South Central Zone, from whence U.S.C. & G. Triangulation Station "Lap" in Refugio County Bears S. $46^{\circ} 04' 22''$ W., 4448.88 varas and U.S.C. & G. Triangulation Station "Pete" in Aransas County Bears S. $62^{\circ} 29' 55''$ E., 4294.79 varas.

counter 19846

and that said line, as so surveyed, be regarded ab initio as the true boundary of said counties within Copano Bay; and that all of the area of Copano Bay lying Eastwardly of said line shall be within Aransas County, and all lands, or appurtenances, therein shall be assessed in Aransas County; and that all of the area of said Bay lying Westwardly of said line shall be within Refugio County, and all lands, or appurtenances therein shall be assessed in Refugio County.

SECOND: That said line as so run, surveyed, and established, be suitably and permanently marked under the supervision of the County Surveyors of the two counties; the cost and expense of the markers and erection thereof to be shared equally by the two counties.

THIRD: That a copy of this compact or agreement, together with all orders of all courts authorizing same and all surveyors' field notes and maps, be filed by each county for record and recorded in the office of the County Clerk of its own County, at the expense of the County filing same; and that certified copies of same be returned to the General Land Office, as required by statute; and that the expense of such certified copies for the General Land Office be borne equally by the two counties. The Commissioner of the General Land Office is authorized to mark the official Land Office maps of the counties in accordance with this agreement.

FOURTH: That the County Surveyors of the two counties forthwith make calculations of quantities of acreage lying within the territories of the respective counties in all cases where the boundary line herein agreed upon crosses or divides tracts or blocks of the State Mineral Development Subdivision of Copano Bay as platted aforesaid, by the General Land Office; and that such calculations be certified under their official seals to the Commissioners Courts of the two counties.

IN TESTIMONY WHEREOF witness the official hands and seals of the high contracting parties in Quintuplicate original copies, at Rockport, Texas, on this the 10th day of December, 1951.

FOR ARANSAS COUNTY

John D. Wendell

Judge of the County Court of Aransas
County, Texas.

ATTEST: (Seal)

Jas. C. Herring

Clerk of the County Court of Aransas
County, Texas.

COMMISSIONERS COURT OF
ARANSAS COUNTY, TEXAS
BY

John D. Wendell

County Judge of Aransas County

W. B. Allen

Commissioner, Precinct No. 1 of
Aransas County

J. M. Sparks, Jr.

Commissioner, Precinct No. 2 of
Aransas County

FOR REFUGIO COUNTY

T. G. Jeter

Judge of the County Court of Refugio
County, Texas.

ATTEST: (Seal)

Bettie Adkins

Clerk of the County Court of Refugio
County, Texas.

COMMISSIONERS COURT OF
REFUGIO COUNTY, TEXAS
BY

T. G. Jeter

County Judge of Refugio County

T. J. Heard

Commissioner, Precinct No. 1 of
Refugio County

Hugo Geistman

Commissioner, Precinct No. 2 of
Refugio County

A. L. Davis
Commissioner, Precinct No. 3 of
Aransas County

Francis West
Commissioner, Precinct No. 3 of
Refugio County

J. H. Wells
Commissioner, Precinct No. 4 of
Aransas County

Clarke Adkins
Commissioner, Precinct No. 4 of
Refugio County

ATTEST:
(Seal)

ATTEST:
(Seal)

Jas. C. Herring
County Clerk of Aransas County, and
Ex-Officio Clerk of the Commissioner's
Court of Aransas County, Texas

Bettie Adking
County Clerk of Refugio County, and
Ex-Officio Clerk of the Commissioner's
Court of Refugio County, Texas

THE STATE OF TEXAS

COUNTY OF REFUGIO

cut
I, JAS. C. HERRING, Clerk of the County Court and Ex
Officio Clerk of the Commissioners' Court of Aransas County,
Texas, do hereby certify that the above and foregoing is a true
and correct copy of COMPACT AND AGREEMENT BETWEEN ARANSAS COUNTY
AND REFUGIO COUNTY RELATING TO BOUNDARY IN COPANO BAY, as the
same appears of record in Volume 10, pages 117 et seq., Minutes
of the Commissioners' Court of Aransas County, Texas.

Given under my hand and seal of office, this the 4 day
of February, 1952.

JAS. C. HERRING,
Clerk, County Court and Ex Officio
Clerk, Commissioners' Court, Aransas
County, Texas

(Seal)

By Walter B. Johnson, Deputy

ORDER OF THE COUNTY COURT OF ARANSAS COUNTY

In the Matter of
Boundaries of Aransas and Refugio
County through Copano Bay

§ In the County Court of
§
§ Aransas County, Texas

On this the 10th day of December, A. D. 1951, it appearing to the County Court of Aransas County, Texas, that the part of the boundary line between Aransas County and Refugio County extending through Copano Bay has been settled and determined by agreements reached at four joint meetings of the County Courts and County Commissioners Courts of Aransas and Refugio Counties, and that the line so agreed upon has been actually surveyed by the County Surveyors of the respective counties, viz: Hon. Fred T. Percival, County Surveyor of Aransas County, and Hon. Phillip G. Young, County Surveyor of Refugio County, pursuant to authorization and direction of the joint meeting of said Courts held in Rockport, Texas, on September 25, 1950, and that said surveyors have made due return of the field notes and map of such actual survey to the joint meeting of said County and Commissioners Courts of the two counties held at Rockport, Texas, heretofore on December 10, 1951, at which such field notes, maps and reports were duly inspected, examined, received and approved, and the line evidenced by said field notes and map was agreed upon by all of said Courts to be the true boundary line between Aransas County and Refugio County extending through Copano Bay from the mouth of Aransas River to the mouth of Copano Creek, such action of such last joint meeting being memorialized and evidenced by a written Compact or Agreement of settlement and compromise between and on behalf of said two counties, dated December 10, 1951, a copy of which is to be duly entered in the Minutes of the Commissioners Court of Aransas County, Texas, is hereby referred to, and made a part of this order without necessity recopying the same herein or in the Minutes of the County Court;

NOW, THEREFORE, IT IS ORDERED, ADJUDGED AND DECREED BY THE COUNTY COURT OF ARANSAS COUNTY, TEXAS, sitting in Aransas County, Texas, that said Compact and Agreement of compromise and settlement, promulgated the said joint meeting of said Courts at Rockport, Texas, on December 10, 1951, and bearing said date, and hereinbefore described and referred to, be, and the same is hereby, affirmed, adopted, ratified and confirmed in all respects as the act and deed of Aransas County, Texas, and that the same be executed by the Judge of this Court and the Commissioners Court of Aransas County for and on behalf of Aransas County, and that the Clerk of this Court duly attest the same; and that the return of the field notes and map of said survey made by the said county surveyors of said counties, as aforesaid, be, and the same are hereby received, approved and accepted by and on behalf of the County of Aransas, and the same shall be recorded by the Clerk of this Court, as provided by statute, together with certified copies supporting orders of the County and Commissioners Courts of Aransas County, and a certified copy thereof be returned to the Commissioner of the General Land Office as required by the statute and said Compact and Agreement;

IT IS FURTHER ORDERED, ADJUDGED AND DECREED BY THE COURT that the portion of the boundary line between Aransas and Refugio County which extends in and across Copano Bay, be, and the same is hereby, fixed and established and same shall be regarded hereafter as the true boundary line between said counties in accordance with said Compact and Agreement as follows, to-wit:

Field notes of a survey of the Aransas-Refugio County Line through Copano Bay made for Aransas and Refugio Counties, Texas.

Said survey is situated within the South Central Zone, Texas Co-ordinate System, is made to conform with said Texas Co-ordinate System as authorized by Article 5300, Revised Civil Statutes of Texas, and is more particularly described by metes and bounds as follows, to-wit:

Beginning at a point in Copano Bay at the mouth of the Aransas River mid-way between the banks of said river, said beginning point is situated at X-925, 076.3 varas and Y-31, 492.6 varas, Texas Co-ordinate System, South Central Zone, from whence U.S.C. & G. Triangulation Station "Bayside" in Refugio County bears N. $32^{\circ} 00' 24''$ E., 4274.96 varas, and U.S.C. & G. Triangulation Station "Star" in Aransas County Bears S. $86^{\circ} 41' 50''$ E., 6651.77 varas;

Thence, N. $42^{\circ} 49'$ E., along said county line 2175 varas to the center of the Causeway across Copano Bay on Texas Farm Road 136, midway between the N and S ends of said Causeway, for a corner of this survey, at X-926, 554.5 varas and Y-33, 088.0 varas, Texas Co-ordinate System, South Central Zone;

Thence, N. $66^{\circ} 26'$ E., along said county line, 9620 varas to a corner of this survey at X-935, 372.2 varas and Y-36, 934.3 varas, Texas Co-ordinate System, South Central Zone;

Thence, N. $50^{\circ} 47'$ E., along said county line, 17,950 varas to a corner of this survey off Shell Point at X-949, 279.1 varas and Y-48, 283.2 varas, Texas Co-ordinate System, South Central Zone;

Thence, N. $17^{\circ} 46'$ E., along said county line, 2100 varas to a corner of this survey off Turtle Point at X-949, 919.9 varas and Y-50, 283.1 varas, Texas Co-ordinate System, South Central Zone;

Thence, N. $88^{\circ} 36'$ W., along said County line, 1270 varas to a corner of this survey in Copano Lake at X-948, 650.3 varas and Y-50, 314.1 varas, Texas Co-ordinate System, South Central Zone;

Thence, S. $75^{\circ} 07'$ W., along said County line, 1069 varas to a corner of this survey at the mouth of Copano Creek, midway between its banks at X-947, 617.2 varas and Y-50, 039.5 varas, Texas Co-ordinate System, South Central Zone, from whence U.S.C. & G. Triangulation Station "Lap" in Refugio County Bears S. $46^{\circ} 04' 22''$ W., 4448.88 varas and U.S.C. & G. Triangulation Station "Pete" in Aransas County Bears S. $62^{\circ} 29' 55''$ E., 4294.79 varas.

counter 79850

IT IS FURTHER ORDERED, ADJUDGED AND DECREED BY THE COURT that said boundary line, as hereinbefore fixed, established and surveyed, be suitably and permanently marked as provided by statute and by said compact and agreement, under the supervision of said county surveyors, at the joint expense of said counties; and that said Surveyors make due report to this Court when such marking has been completed.

IT IS FURTHER ORDERED, ADJUDGED AND DECREED BY THE COURT that each and every act heretofore done by the County Court of Aransas County and the Commissioners Court of Aransas County and by the County Courts and Commissioners Courts of the said two counties at the joint meetings of said Courts in agreeing upon the true location of said part of said boundary line, and in directing the actual survey thereof, and in receiving and approving the returns of such survey and the field notes and map thereof, and in fixing and establishing such line as the true and permanent boundary line of said counties insofar as same traverses said Copano Bay, and in ordering said line to be suitably and permanently marked, and in agreeing upon each and all of the matters contained in said written Compact and Agreement of settlement and compromise, be, and the same are hereby in all things affirmed, adopted, approved, ratified, and confirmed as the act and deed of Aransas County, Texas.

IT IS FURTHER ORDERED, ADJUDGED AND DECREED BY THE COURT that special public notice be given of the establishment of such part of said boundary line by the publication of the field notes of such line one time in each newspaper published in Aransas County, Texas, so that the public generally may be informed with reference thereto.

ATTEST:

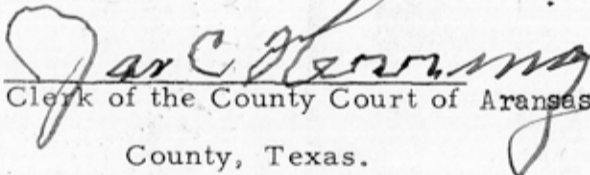

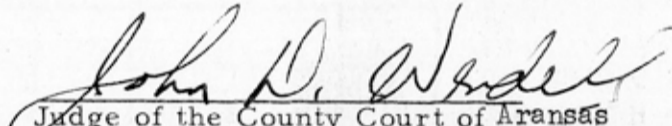
Clerk of the County Court of Aransas
County, Texas.

Judge of the County Court of Aransas
County, Texas.

THE STATE OF TEXAS :
COUNTY OF ARANSAS : I, JAS. C. HERRING, Clerk of
the County Court in and for said County and State, do hereby certify
that the within and foregoing is a true and correct copy of ORDER
OF THE COUNTY COURT OF ARANSAS COUNTY, now on file in this office
and recorded in Volume 4, pages 168-170, Minutes of County Court of
Aransas County, Texas.

GIVEN under my hand and seal of office, this the 11th day
of December, A. D. 1951.

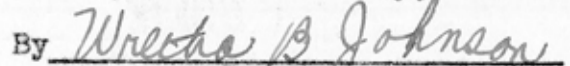
JAS. C. HERRING, Clerk County
Court, Aransas County, Texas.

By 
Deputy

counter 19851

6

ORDER OF COMMISSIONERS COURT

On this the 10th day of December, A.D., 1951, the Commissioners Court of Aransas County, Texas, convened in its own courtroom, in the courthouse of its own county, at Rockport, Texas, all members being present and participating, following adjournment of the joint meeting of the County and Commissioners Courts of Aransas and Refugio Counties, held at Rockport, Texas, earlier the same day, whereat an agreement was reached between the two counties defining and establishing the location of that part of the boundary of said counties extending through Copano Bay; whereupon, said Commissioners Court sitting separately and within its own jurisdiction took up and duly considered the matter of the understanding and agreement reached at said joint meeting, which agreement is evidenced, set forth, and contained in an instrument in writing prepared by legal counsel of both counties, and denominated a Compact and Agreement between Aransas County and Refugio County relating to boundary in Copano Bay, a copy of which is hereto attached, made a part of this Order, and hereby referred to; and this Commissioners Court being of opinion, and so finding, that the portion of the boundary line of Aransas and Refugio County traversing Copano Bay never has been defined, surveyed, and marked in accordance with law, and that it is impracticable at this time to designate or locate the channel described in the Acts of Twelfth Legislature of Texas, Adjourned Session, page 1, (Gammel's Laws of Texas, Vol. VII, page 3), and that litigation concerning same would be to no particular purpose, but would be expensive and time-consuming, and that an imperative public necessity exists that such part of said boundary line be fixed and established without delay, in view of mineral development activities in said Bay, and the existent uncertainty and confusion as to jurisdiction of the respective counties and the public authorities thereof over the area within said Bay, especially with regard to matters of ad valorem taxation; and that the courts of both counties have made a bona fide effort to determine the true location of such portion of said boundary as defined by said Act of the Twelfth Legislature, without practical result; and that the line heretofore agreed upon at such joint meetings, and as actually surveyed by the County Surveyors of the two counties, approximates as closely as practicable the line intended by the Legislature; and that said line agreed upon and surveyed does not deprive either county of any area thereof to which it is legally entitled, but, on the other hand, is just, fair and equitable, preserving to each county all of its legitimate and legal territories, and is in the public interest, and in the interest of each county; that said compromise and settlement has been fairly and maturely arrived at and should be ratified and confirmed; and this Court having examined the field notes and maps of said survey returned by said County Surveyors, and finding same to be correct and in order; and having examined the form of the proposed Compact and Agreement, hereinbefore described, and finding that same correctly evidences the understanding and agreements reached at said joint meetings, and a proper disposition of said matter, and that the same should be formally and solemnly executed and mutually delivered by the contracting parties;

IT IS, THEREFORE, ORDERED BY THE COMMISSIONERS COURT OF ARANSAS COUNTY, that said proposed settlement of the controversy heretofore existing between Aransas County and Refugio County as to the true location of the part of their boundary line lying within Copano Bay, be and the same is hereby accepted and approved upon the terms and conditions set forth and contained in said instrument in writing, entitled a Compact and Agreement between Aransas County and Refugio County relating to boundary in Copano Bay, dated December 10, 1951, hereto attached, and made a part hereof, as aforesaid, and that the same be duly and formally executed, and mutually delivered, on behalf of Aransas County, by this Commissioners Court, acting through its members, and by the County Court of Aransas County;

counter 49852

IT IS FURTHER ORDERED that the part of the boundary line of Aransas County and Refugio County traversing Copano Bay be and the same is hereby defined and permanently fixed and established, in accordance with the terms and provisions of said Compact and Agreement, and as surveyed by the County Surveyors of the two counties, viz: Honorable Fred T. Percival, for Aransas County, and Honorable Phillip G. Young, for Refugio County, as set forth in the field notes and map returned by them, as follows, to-wit:

Field notes of a survey of the Aransas-Refugio County Line through Copano Bay made for Aransas and Refugio Counties, Texas.

Said survey is situated within the South Central Zone, Texas Co-ordinate System, is made to conform with said Texas Co-ordinate System as authorized by Article 5300, Revised Civil Statutes of Texas, and is more particularly described by metes and bounds as follows, to-wit:

Beginning at a point in Copano Bay at the mouth of the Aransas River mid-way between the banks of said river, said beginning point is situated at X-925,076.3 varas and Y-31,492.6 varas, Texas Co-ordinate System, South Central Zone, from whence U. S. C. & G. Triangulation Station "Bayside" in Refugio County bears N. $32^{\circ} 00' 24''$ E., 4274.96 varas, and U. S. C. & G. Triangulation Station "Star" in Aransas County Bears S. $86^{\circ} 41' 50''$ E., 6651.77 varas;

Thence, N. $42^{\circ} 49'$ E., along said county line 2175 varas to the center of the Causeway across Copano Bay on Texas Farm Road 136, midway between the N and S ends of said Causeway, for a corner of this survey, at X-926,554.5 varas and Y-33,088.0 varas, Texas Co-ordinate System, South Central Zone;

Thence, N. $66^{\circ} 26'$ E., along said county line, 9620 varas to a corner of this survey at X-935,372.2 varas and Y-36,934.3 varas, Texas Co-ordinate System, South Central Zone;

Thence, N. $50^{\circ} 47'$ E., along said county line, 17,950 varas to a corner of this survey off Shell Point at X-949,279.1 varas and Y-48,283.2 varas, Texas Co-ordinate System, South Central Zone;

Thence, N. $17^{\circ} 46'$ E., along said county line, 2100 varas to a corner of this survey off Turtle Point at X-949,919.9 varas and Y-50,283.1 varas, Texas Co-ordinate System, South Central Zone;

Thence, N. $88^{\circ} 36'$ W., along said County line, 1270 varas to a corner of this survey in Copano Lake at X-948,650.3 varas and Y-50,314.1 varas, Texas Co-ordinate System, South Central Zone;

Thence, S. $75^{\circ} 07'$ W., along said County line, 1069 varas to a corner of this survey at the mouth of Copano Creek, midway between its banks at X-947,617.2 varas and Y-50,039.5 varas, Texas Co-ordinate System, South Central Zone, from whence U. S. C. & G. Triangulation Station "Lap" in Refugio County Bears S. $46^{\circ} 04' 22''$ W., 4448.88 varas and U. S. C. & G. Triangulation Station "Pete" in Aransas County Bears S. $62^{\circ} 29' 55''$ E., 4294.79 varas.

counter 49854

and that said line as so surveyed and established be regarded as the true boundary of said counties within said Copano Bay; and that line be suitably and permanently marked under the supervision of said County Surveyors, as provided in said Compact.

IT IS FURTHER ORDERED that each and every act and thing heretofore done by this Commissioners Court and the members thereof, and the County Court of Aransas County, and by the joint meetings of the County Courts and Commissioners Courts of Aransas and Refugio Counties, at the joint meetings of said courts, and particularly at the meetings held on September 25, 1950, and December 10, 1951, in agreeing upon the location of said part of said boundary line, and in directing the actual survey thereof by the County Surveyors of the two counties, and in receiving and approving the returns of such survey, and the field notes and map thereof, and in defining, fixing, and establishing such line as the true and permanent boundary line of said counties insofar as same traverses said Copano Bay, and in ordering said line to be suitably and permanently marked, and in agreeing upon each and all of the matters contained in said written Compact and Agreement, fully and finally defining said boundary and settling said dispute, be, and the same are hereby in all things affirmed, adopted, approved, ratified, and confirmed as the act and deed of Aransas County.

COMMISSIONERS COURT OF ARANSAS
COUNTY

BY

John D. Wendell
County Judge

M. B. Allen
Commissioner, Precinct No. 1

J. M. Park
Commissioner, Precinct No. 2

A. L. Davis
Commissioner, Precinct No. 3

J. H. Mills
Commissioner, Precinct No. 4

ATTEST:

Jas C Herring
JAS. C. HERRING, Clerk County Court
and Ex-officio Clerk Commissioners
Court, Aransas County, Texas.

THE STATE OF TEXAS :
COUNTY OF ARANSAS : I, JAS. C. HERRING, County Clerk
and Ex-officio Clerk of Commissioners' Court of Aransas County, do
hereby certify that the within and foregoing is a true and correct
copy of ORDER OF COMMISSIONERS' COURT now on file in this office,
and recorded in Volume 10, pages 96, et seq. Minutes of Commissioners
Court of Aransas County, Texas.

GIVEN under my hand and seal of office, this the 10th
day of December, A. D. 1951.

Jas C Herring
JAS. C. HERRING, Clerk County
Court, and Ex-officio Clerk
Commrs. Court, Aransas County.

ORDER OF THE COUNTY COURT OF REFUGIO COUNTY

In the Matter of
Boundaries of Aransas and Refugio
County through Copano Bay

§
§
§

In the County Court of Refugio
County, Texas

On this the 10th day of December, A. D. 1951, it appearing to the County Court of Refugio County, Texas, that the part of the boundary line between Aransas County and Refugio County extending through Copano Bay has been settled and determined by agreements reached at four joint meetings of the County Courts and County Commissioners Courts of Aransas and Refugio Counties, and that the line so agreed upon has been actually surveyed by the County Surveyors of the respective counties, viz: Hon. Fred T. Percival, County Surveyor of Aransas County, and Hon. Phillip G. Young, County Surveyor of Refugio County, pursuant to authorization and direction of the joint meeting of said Courts held in Rockport, Texas, on September 25, 1950, and that said surveyors have made due return of the field notes and map of such actual survey to the joint meeting of said County and Commissioners Courts of the two counties held at Rockport, Texas, heretofore on December 10, 1951, at which such field notes, maps and reports were duly inspected, examined, received and approved, and the line evidenced by said field notes and map was agreed upon by all of said Courts to be the true boundary line between Aransas County and Refugio County extending through Copano Bay from the mouth of Aransas River to the mouth of Copano Creek, such action of such last joint meeting being memorialized and evidenced by a written Compact or Agreement of settlement and compromise between and on behalf of said two counties, dated December 10, 1951, a copy of which is to be duly entered in the Minutes of the Commissioners Court of Refugio County, Texas, is hereby referred to, and made a part of this order without necessity recopying the same herein or in the Minutes of the County Court;

NOW, THEREFORE, IT IS ORDERED, ADJUDGED AND DECREED BY THE COUNTY COURT OF REFUGIO COUNTY, TEXAS, sitting in Refugio County, Texas, that said Compact and Agreement of compromise and settlement, promulgated the said joint meeting of said Courts at Rockport, Texas, on December 10, 1951, and bearing said date, and hereinbefore described and referred to, be, and the same is hereby, affirmed, adopted, ratified and confirmed in all respects as the act and deed of Refugio County, Texas, and that the same be executed by the Judge of this Court and the Commissioners Court of Refugio County for and on behalf of Refugio County, and that the Clerk of this Court duly attest the same; and that the return of the field notes and map of said survey made by the said county surveyors of said counties, as aforesaid, be, and the same are hereby received, approved and accepted by and on behalf of the County of Refugio, and the same shall be recorded by the Clerk of this Court, as provided by statute, together with certified copies supporting orders of the County and Commissioners Courts of Refugio County, and a certified copy thereof be returned to the Commissioner of the General Land Office as required by the statute and said Compact and Agreement;

IT IS FURTHER ORDERED, ADJUDGED AND DECREED BY THE COURT that the portion of the boundary line between Aransas and Refugio County which extends in and across Copano Bay, be, and the same is hereby, fixed and established and same shall be regarded hereafter as the true boundary line between said counties in accordance with said Compact and Agreement as follows, to-wit:

counter 49856

Field notes of a survey of the Aransas-Refugio County Line through Copano Bay made for Aransas and Refugio Counties, Texas.

Said survey is situated within the South Central Zone, Texas Co-ordinate System, is made to conform with said Texas Co-ordinate System as authorized by Article 5300, Revised Civil Statutes of Texas, and is more particularly described by metes and bounds as follows, to-wit:

Beginning at a point in Copano Bay at the mouth of the Aransas River mid-way between the banks of said river, said beginning point is situated at X-925, 076.3 varas and Y-31, 492.6 varas, Texas Co-ordinate System, South Central Zone, from whence U. S. C. & G. Triangulation Station "Bayside" in Refugio County bears N. $32^{\circ} 00' 24''$ E., 4274.96 varas, and U. S. C. & G. Triangulation Station "Star" in Aransas County Bears S. $86^{\circ} 41' 50''$ E., 6651.77 varas;

Thence, N. $42^{\circ} 49'$ E., along said county line 2175 varas to the center of the Causeway across Copano Bay on Texas Farm Road 136, midway between the N and S ends of said Causeway, for a corner of this survey, at X-926, 554.5 varas and Y-33, 088.0 varas, Texas Co-ordinate System, South Central Zone;

Thence, N. $66^{\circ} 26'$ E., along said county line, 9620 varas to a corner of this survey at X-935, 372.2 varas and Y-36, 934.3 varas, Texas Co-ordinate System, South Central Zone;

Thence, N. $50^{\circ} 47'$ E., along said county line, 17,950 varas to a corner of this survey off Shell Point at X-949, 279.1 varas and Y-48, 283.2 varas, Texas Co-ordinate System, South Central Zone;

Thence, N. $17^{\circ} 46'$ E., along said county line, 2100 varas to a corner of this survey off Turtle Point at X-949, 919.9 varas and Y-50, 283.1 varas, Texas Co-ordinate System, South Central Zone;

Thence, N. $88^{\circ} 36'$ W., along said County line, 1270 varas to a corner of this survey in Copano Lake at X-948, 650.3 varas and Y-50, 314.1 varas, Texas Co-ordinate System, South Central Zone;

Thence, S. $75^{\circ} 07'$ W., along said County line, 1069 varas to a corner of this survey at the mouth of Copano Creek, midway between its banks at X-947, 617.2 varas and Y-50, 039.5 varas, Texas Co-ordinate System, South Central Zone, from whence U. S. C. & G. Triangulation Station "Lap" in Refugio County Bears S. $46^{\circ} 04' 22''$ W., 4448.88 varas and U. S. C. & G. Triangulation Station "Pete" in Aransas County Bears S. $62^{\circ} 29' 55''$ E., 4294.79 varas.

IT IS FURTHER ORDERED, ADJUDGED AND DECREED BY THE COURT that said boundary line, as hereinbefore fixed, established and surveyed, be suitably and permanently marked as provided by statute and by said compact and agreement, under the supervision of said county surveyors, at the joint expense of said counties; and that said Surveyors make due report to this Court when such marking has been completed.

IT IS FURTHER ORDERED, ADJUDGED AND DECREED BY THE COURT that each and every act heretofore done by the County Court of Refugio County and the Commissioners Court of Refugio County and by the County Courts and Commissioners Courts of the said two counties at the joint meetings of said Courts in agreeing upon the true location of said part of said boundary line, and in directing the actual survey thereof, and in receiving and approving the returns of such survey and the field notes and map thereof, and in fixing and establishing such line as the true and permanent boundary line of said counties insofar as same traverses said Copano Bay, and in ordering said line to be suitably and permanently marked, and in agreeing upon each and all of the matters contained in said written Compact and Agreement of settlement and compromise, be, and the same are hereby in all things affirmed, adopted, approved, ratified, and confirmed as the act and deed of Refugio County, Texas.

IT IS FURTHER ORDERED, ADJUDGED AND DECREED BY THE COURT that special public notice be given of the establishment of such part of said boundary line by the publication of the field notes of such line one time in each newspaper published in Refugio County, Texas, so that the public generally may be informed with reference thereto.

ATTEST:

T. G. Jeter
Judge of the County Court of Refugio
County, Texas.

Bettie Adkins (Seal)
Clerk of the County Court of
Refugio County, Texas.

THE STATE OF TEXAS :

COUNTY OF REFUGIO :

I, BETTIE ADKINS, Clerk of the County Court in and for said County and State, do hereby certify that the anove and foregoing is a true and correct executed copy of an ORDER OF THE COUNTY COURT OF REFUGIO COUNTY, dated December 10, 1951, as the same appears of record in Volume 3, pages 602-604, County Court Minutes of Refugio County, Texas.

TO CERTIFY, Witness my hand and seal of office, at office in Refugio, Texas, this the 12th day of December, A. D. 1951.

SEAL

BETTIE ADKINS,
Clerk County Court,
Refugio County, Texas.

ENDORSED: ORDER OF THE COUNTY COURT OF REFUGIO COUNTY * FILED DEC 17 1951 JAS. C. HERRING, CLERK COUNTY COURT, ARANSAS CO., TEXAS. BY WRETHA B. JOHNSON DEPUTY.

counter 49858

THE STATE OF TEXAS :

COUNTY OF ARANSAS : I, JAS. C. HERRING, Clerk of the County Court and Ex-officio Clerk of Aransas County, Texas, do hereby certify that the above and foregoing is a true and correct copy of CERTIFIED COPY OF ORDER OF THE COUNTY COURT OF REFUGIO COUNTY RELATING TO THE BOUNDARY IN COPANO BAY BETWEEN ARANSAS COUNTY AND REFUGIO COUNTY, as the same appears of record in Volume 10, pages 102-104, Minutes of the Commissioners' Court of Aransas County.

GIVEN under my hand and seal of office, this the 4th day of February, A. D. 1952.

JAS. C. HERRING,
Clerk County Court and
Ex-officio Clerk Comms. Court,
Aransas County, Texas.

By Walter B. Johnson
Deputy

ORDER OF COMMISSIONERS COURT

On this the 10th day of December, A. D., 1951, the Commissioners Court of Refugio County, Texas, convened in its own courtroom, in the courthouse of its own county, at Refugio, Texas, all members being present and participating, following adjournment of the joint meeting of the County and Commissioners Courts of Aransas and Refugio Counties, held at Rockport, Texas, earlier the same day, whereat an agreement was reached between the two counties defining and establishing the location of that part of the boundary of said counties extending through Copano Bay; whereupon, said Commissioners Court sitting separately and within its own jurisdiction took up and duly considered the matter of the understanding and agreement reached at said joint meeting, which agreement is evidenced, set forth, and contained in an instrument in writing prepared by legal counsel of both counties, and denominated a Compact and Agreement between Aransas County and Refugio County relating to boundary in Copano Bay, a copy of which is hereto attached, made a part of this Order, and hereby referred to; and this Commissioners Court being of opinion, and so finding, that the portion of the boundary line of Aransas and Refugio County traversing Copano Bay never has been defined, surveyed, and marked in accordance with law, and that it is impracticable at this time to designate or locate the channel described in the Acts of Twelfth Legislature of Texas, Adjourned Session, page 1, (Gammel's Laws of Texas, Vol. VII, page 3), and that litigation concerning same would be to no particular purpose, but would be expensive and time-consuming, and that an imperative public necessity exists that such part of said boundary line be fixed and established without delay, in view of mineral development activities in said Bay, and the existent uncertainty and confusion as to jurisdiction of the respective counties and the public authorities thereof over the area within said Bay, especially with regard to matters of ad valorem taxation; and that the courts of both counties have made a bona fide effort to determine the true location of such portion of said boundary as defined by said Act of the Twelfth Legislature, without practical result; and that the line heretofore agreed upon at such joint meetings, and as actually surveyed by the County Surveyors of the two counties, approximates as closely as practicable the line intended by the Legislature; and that said line agreed upon and surveyed does not deprive either county of any area thereof to which it is legally entitled, but, on the other hand, is just, fair and equitable, preserving to each county all of its legitimate and legal territories, and is in the public interest, and in the interest of each county; that said compromise and settlement has been fairly and maturely arrived at and should be ratified and confirmed; and this Court having examined the field notes and maps of said survey returned by said County Surveyors, and finding same to be correct and in order; and having examined the form of the proposed Compact and Agreement, hereinbefore described, and finding that same correctly evidences the understanding and agreements reached at said joint meetings, and a proper disposition of said matter, and that the same should be formally and solemnly executed and mutually delivered by the contracting parties;

IT IS, THEREFORE, ORDERED BY THE COMMISSIONERS COURT OF REFUGIO COUNTY, that said proposed settlement of the controversy heretofore existing between Aransas County and Refugio County as to the true location of the part of their boundary line lying within Copano Bay, be and the same is hereby accepted and approved upon the terms and conditions set forth and contained in said instrument in writing, entitled a Compact and Agreement between Aransas County and Refugio County relating to boundary in Copano Bay, dated December 10, 1951, hereto attached, and made a part hereof, as aforesaid, and that the same be duly and formally executed, and mutually delivered, on behalf of Refugio County, by this Commissioners Court, acting through its members, and by the County Court of Refugio County;

counter 49860

IT IS FURTHER ORDERED that the part of the boundary line of Aransas County and Refugio County traversing Copano Bay be and the same is hereby defined and permanently fixed and established, in accordance with the terms and provisions of said Compact and Agreement, and as surveyed by the County Surveyors of the two counties, viz: Honorable Fred T. Percival, for Aransas County, and Honorable Phillip G. Young, for Refugio County, as set forth in the field notes and map returned by them, as follows, to-wit:

Field notes of a survey of the Aransas-Refugio County Line through Copano Bay made for Aransas and Refugio Counties, Texas.

Said survey is situated within the South Central Zone, Texas Co-ordinate System, is made to conform with said Texas Co-ordinate System as authorized by Article 5300, Revised Civil Statutes of Texas, and is more particularly described by metes and bounds as follows, to-wit:

Beginning at a point in Copano Bay at the mouth of the Aransas River mid-way between the banks of said river, said beginning point is situated at X-925,076.3 varas and Y-31,492.6 varas, Texas Co-ordinate System, South Central Zone, from whence U. S. C. & G. Triangulation Station "Bayside" in Refugio County bears N. $32^{\circ} 00' 24''$ E., 4274.96 varas, and U. S. C. & G. Triangulation Station "Star" in Aransas County Bears S. $86^{\circ} 41' 50''$ E., 6651.77 varas;

Thence, N. $42^{\circ} 49'$ E., along said county line 2175 varas to the center of the Causeway across Copano Bay on Texas Farm Road 136, midway between the N and S ends of said Causeway, for a corner of this survey, at X-926,554.5 varas and Y-33,088.0 varas, Texas Co-ordinate System, South Central Zone;

Thence, N. $66^{\circ} 26'$ E., along said county line, 9620 varas to a corner of this survey at X-935,372.2 varas and Y-36,934.3 varas, Texas Co-ordinate System, South Central Zone;

Thence, N. $50^{\circ} 47'$ E., along said county line, 17,950 varas to a corner of this survey off Shell Point at X-949,279.1 varas and Y-48,283.2 varas, Texas Co-ordinate System, South Central Zone;

Thence, N. $17^{\circ} 46'$ E., along said county line, 2100 varas to a corner of this survey off Turtle Point at X-949,919.9 varas and Y-50,283.1 varas, Texas Co-ordinate System, South Central Zone;

Thence, N. $88^{\circ} 36'$ W., along said County line, 1270 varas to a corner of this survey in Copano Lake at X-948,650.3 varas and Y-50,314.1 varas, Texas Co-ordinate System, South Central Zone;

Thence, S. $75^{\circ} 07'$ W., along said County line, 1069 varas to a corner of this survey at the mouth of Copano Creek, midway between its banks at X-947,617.2 varas and Y-50,039.5 varas, Texas Co-ordinate System, South Central Zone, from whence U. S. C. & G. Triangulation Station "Lap" in Refugio County Bears S. $46^{\circ} 04' 22''$ W., 4448.88 varas and U. S. C. & G. Triangulation Station "Pete" in Aransas County Bears S. $62^{\circ} 29' 55''$ E., 4294.79 varas.

and that said line as so surveyed and established be regarded as the true boundary of said counties within said Copano Bay; and that line be suitably and permanently marked under the supervision of said County Surveyors, as provided in said Compact.

IT IS FURTHER ORDERED that each and every act and thing heretofore done by this Commissioners Court and the members thereof, and the County Court of Refugio County, and by the joint meetings of the County Courts and Commissioners Courts of Aransas and Refugio Counties, at the joint meetings of said courts, and particularly at the meetings held on September 25, 1950, and December 10, 1951, in agreeing upon the location of said part of said boundary line, and in directing the actual survey thereof by the County Surveyors of the two counties, and in receiving and approving the returns of such survey, and the field notes and map thereof, and in defining, fixing, and establishing such line as the true and permanent boundary line of said counties insofar as same traverses said Copano Bay, and in ordering said line to be suitably and permanently marked, and in agreeing upon each and all of the matters contained in said written Compact and Agreement, fully and finally defining said boundary and settling said dispute, be, and the same are hereby in all things affirmed, adopted, approved, ratified, and confirmed as the act and deed of Refugio County.

COMMISSIONERS COURT OF REFUGIO
COUNTY

BY

T. G. Jeter

County Judge

T. J. Heard

Commissioner, Precinct No. 1

Hugh Geistman

Commissioner, Precinct No. 2

Francis West

Commissioner, Precinct No. 3

Clarke Adkins

Commissioner, Precinct No. 4

THE STATE OF TEXAS :

COUNTY OF REFUGIO : I, BETTIE ADKINS, Clerk of the County Court in and for said County and State, do hereby certify that the above and foregoing is a true and correct executed copy of an ORDER OF THE COMMISSIONERS' COURT, passed on December 10, 1951, as the same appears on record in Volume 10, pages 114-116, Commissioners' Court Records of Refugio County, Texas.
TO CERTIFY, Witness my hand and seal of office, at office in

Refugio, Texas, this the 12th day of December, A. D. 1951.

SEAL

BETTIE ADKINS, Clerk, County Court
and Ex-officio Clerk of the
Commissioners' Court, Refugio
County, Texas

ENDORSED: ORDER OF COMMISSIONERS COURT * FILED FOR RECORD DEC 17 1951
JAS. C. HERRING, CLERK COUNTY COURT, ARANSAS CO., TEXAS. BY WRETHA B. JOHNSON, DEPUTY

counter 49863

THE STATE OF TEXAS :
COUNTY OF ARANSAS : I, JAS. C. HERRING, Clerk of the County
Court and Ex-officio Clerk of Commissioners Court of Aransas County,
Texas, do hereby certify that the attached and foregoing is a true
and correct copy of ORDER OF COMMISSIONERS COURT, as the same
appears of record in Volume 10, pages 104-106, Minutes of Commissioners
Court of Aransas County, Texas.

GIVEN under my hand and seal of office, this the 4th day
of February, A. D. 1952.

JAS. C. HERRING, Clerk County Court
and Ex-officio Clerk Commrs. Court
Aransas County, Texas.

By Wretha B. Johnson
Deputy