

THE STATE OF TEXAS: : : : :

COUNTIES OF CLAY AND ARCHER: :

FIELD NOTES OF COUNTY LINE ESTABLISHED BETWEEN CLAY AND  
ARCHER COUNTIES BY AN ORDER OF THE COMMISSIONERS COURT  
OF SAID COUNTIES : : : : : BEGINING AT THE N. E. CORNER OF  
YOUNG COUNTY: CORNER ON POST OAK MARKED, XXX, ON NORTH  
AND BLAZED ON WEST SOUTH AND EAST SIDE AND STONE MOUND  
ON WEST SIDE THE SAME BEING ESTABLISHED BY R. H. MATTHEWS  
SPECIAL SURVEYOR OF YOUNG COUNTY AND THE FIELD NOTES  
OF THE SAME WAS FILED IN THE GENERAL LANDS

OFFICE JANUARY 12, 1857, : : : : : THENCE NORTH AT 2916 VS BRUSHY  
CREEK AT 4886 VS WEST FORK OF TINEY RIVER, AT 5600 VS

SAYLORS CREEK, AT 7600 VS A LARGE STONE MOUND ON THE TOP

OF GAP MOUNTAIN FROM WHICH A POST OAK <sup>ε</sup> BARS EAST 5 VS  
MARKED I. V. : : : : : THENCE NORTH AT 1900 VS POST 5;

THENCE NORTH AT 923 VS A POINT 51 VS EAST OF THE N. W.

CORNER OF SURVEY NO. 2646, T. E. & L. CO. : : : : : AT 1900 VS POST 6;

THENCE NORTH AT 1900 VS POST 7;

THENCE NORTH 1900 VS POST 8;

THENCE NORTH 1900 VS POST 9;

THENCE NORTH AT 1396 VS A POINT 1360 VS WEST OF THE

S. W. CORNER OF J. K. PARKER 640 ACRE <sup>Sur.</sup> AT 1900 VS POST 10;

THENCE NORTH 1900 VS POST 11;

THENCE NORTH 1900 VS POST 12;

THENCE NORTH 1900 VS POST 13;

THENCE NORTH 1900 VS POST 14;

THENCE NORTH 1900 VS POST 15;

THENCE NORTH 1900 VS POST 16;

THENCE NORTH AT 1718 VS A POINT 2201 VS WEST OF THE

S. W. CORNER OF CALHOUN COUNTY SCHOOL LAND, AT 1900 VS

counter 50082

N



POST 17:::THENCE NORTH 1900 VS POST 18, 22 VS SOUTH  
 AND 912 VS EAST FROM THE S.W. CORNER OF JOHN M RIN E  
 SURVEY:::THENCE NORTH 1900 VS POST 19;  
 THENCE NORTH AT 1000 VS LITTLE WICHITA RIVER  
 THENCE NORTH 1900 VS POST 20;  
 THENCE NORTH 1900 VS POST 21;  
 THENCE NORTH 1900 VS POST 22;  
 THENCE NORTH 1900 VS POST 23;  
 THENCE NORTH ~~1000~~ VS POST 24;  
 THENCE NORTH AT 1288 VS A POINT 14143 VS EAST OF THE  
 S.W. CORNER OF THE JOHN MENTER SURVEY AT 1900 VS POST 25;  
 THENCE NORTH AT 900 VS LAKE CREEK, AT 1900 VS POST 26;  
 THENCE NORTH AT 286 VS A POINT 924 VS WEST OF THE N.E.  
 CORNER OF NO. 3, B. B. B. & C, RR CO:::AT 1900 VS POST 27;  
 THENCE NORTH 1900 VS POST 28;  
 THENCE NORTH 1900 VS POST 29;  
 THENCE NORTH 1900 VS POST 30,  
 SURVEYED JUNE 15 TO 20 THE 1891.

THE STATE OF TEXAS:::COUNTIES OF CLAY & ARCHER  
 WE THE UNDERSIGNED HAVING BEEN APPOINTED BY THE COMMI  
 SSIONERS COURT OF CLAY AND ARCHER COUNTIES TO ESTAB  
 LISH AND MARK THE LINE BETWEEN SAID COUNTIES AND IN  
 ACCORDANCE WITH THE PROVISION OF CHAPTER CXXIX REVISED  
 STATUTES APPROVED APRIL, 22, 1879, OF THE STATE OF TEXAS  
 DO HERE BY CERTIFY THAT IN COMPLIANCE WITH SAID  
 APPOINTMENT WE HAVE SURVEYED SAID LINE AND THAT THE FORE  
 GOING IS A TRUE AND CORRECT COPY OF THE FIELD NOTES  
 OF SAID LINE AS RUN AND MARKED BY US ON THE GROUND,  
 THIS JULY 1 ST 1891,

*R W Watkins* COUNTY SURVEYOR OF CLAY COUNTY  
*J. Mosell* COUNTY SURVEYOR OF ARCHER COUNTY  
*J. C. Chesnut* County Judge  
*J. H. Bridges* Precinct 1  
*Geo. H. Dunn* Precinct 2  
*Chas. W. Baker* Precinct 3  
*A. J. Farmer* Precinct 4  
*W. H. Barnes* Precinct 4  
 counter 50083



The State of Texas }  
County of Archer } I W W Duren Clerk County Court  
in and for Archer County do hereby certify that  
the foregoing is a true and correct copy of the field notes  
and plat of the boundary line between Cloy and  
Archer Counties as furnished by J. M. Cecil the  
County Surveyor of Archer County and R. H. Watkins  
the County Surveyor of Cloy County, and as the same  
appears of record in the minutes of the County  
Court in ~~pages~~ Book pages 166-167 & 168.

Given under my hand and Seal of office  
on this 25<sup>th</sup> day of Aug 1891

W W Duren Clerk  
County Court Archer Co Tex

County Body  
between  
Archer Co  
Cloy Co.

Filed Aug 28/91

Examined and repeated  
for want of completion  
with surveys through  
which the line runs.

Sept. 11<sup>th</sup> /91 Beaumont

N

counters 50084

Archer Co. Body. List #1



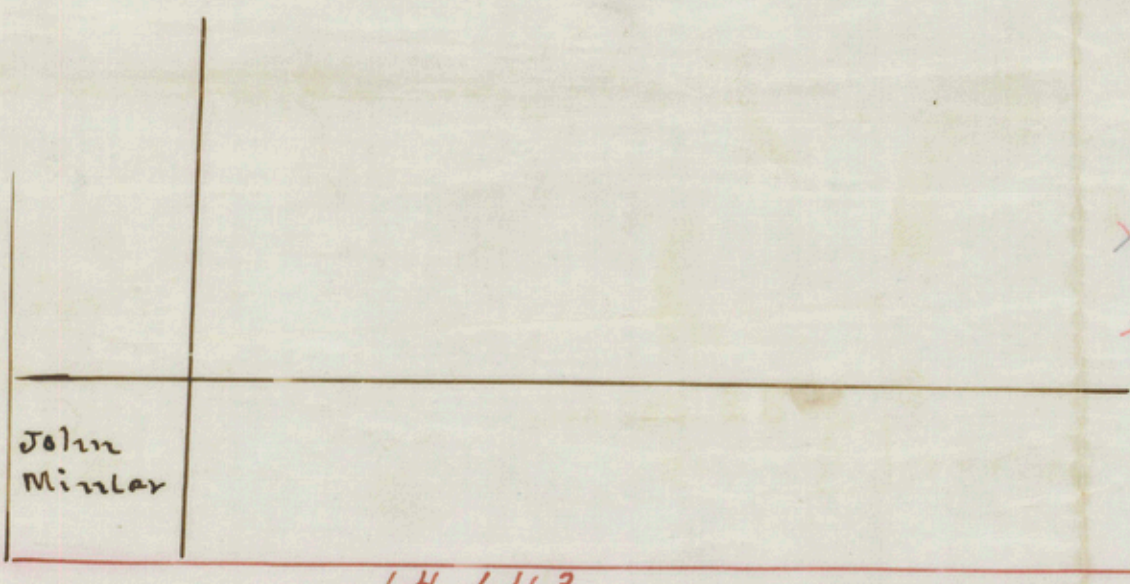

14 143

xol  
↓

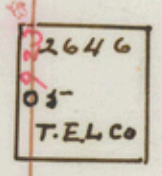
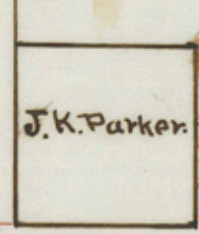
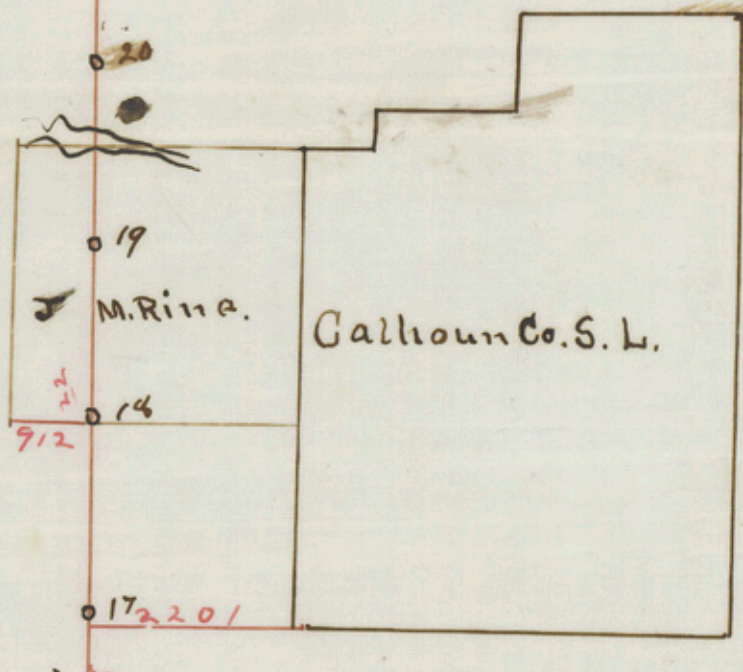
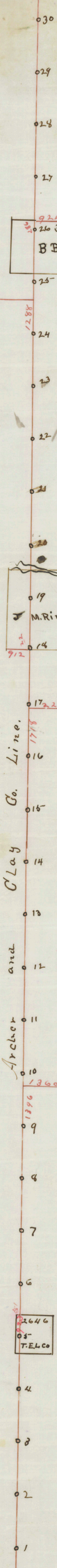
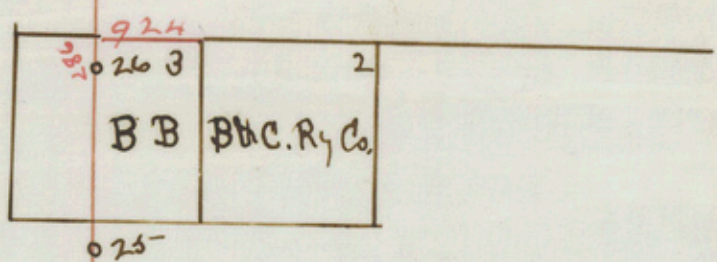

R W Watkins & Co  
L. M. Cecil, C. S. Archer Co.  
Texas,

Post-oak  
N.E. Cor. Young Co.

counter 50085