

49
Archer Co

Boundaries

South Line Filed Feb'y
26.th 1894.

see endorsement
on S ldy line

4/2/94 Endorsement

Approved by

Sep L. Dist

5/23/94

Letter Book

361
431

counter 50103

South line Abstracted Apr



Office



2607

Archer City, Texas, Feb. 22 1894

Hon. W. L. McGaughey,
G. L. O. Austin,

Dear Sir,

I forwarded to your address,
by yesterday's post, Sketch & Field notes of South County line,
approved by Comrs. Courts of Archer & Young Cos. If
You find them all right please so inform me. The
Sketch & fd notes of The West-Co. line will be forwarded you
from Baylor Co, Perhaps you have already rec'd them.

Respectfully,

T. M. Cecil

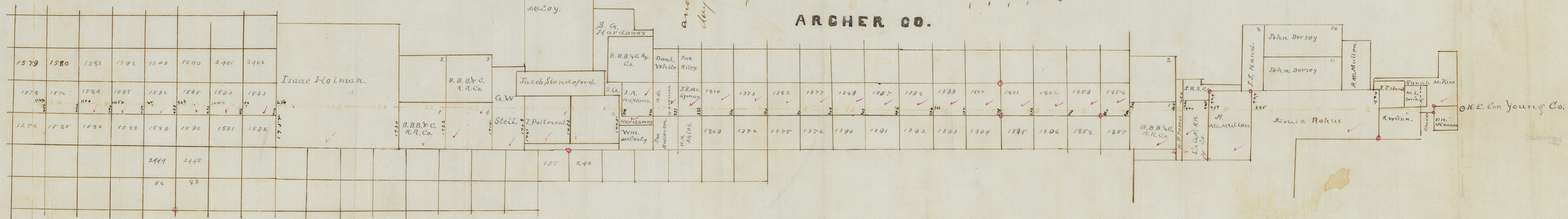

State of Texas,
 Counties of Archer and Young,
 We, J. M. Cecil, Co. Surveyor of Archer County and
 C. P. Benson, Co. Surveyor of Young Co., Texas,
 hereby certify that the accompanying sketch
 shows truly and correctly the position of
 the surveys bordering on the South County
 line of Archer County and the North boundary
 line of Young County as determined by
 careful and actual survey made by us on
 the ground according to law, as returns
 on official signatures, this the 12
 day of February 1894
 J. M. Cecil
 Co. Surveyor of Archer Co., Texas
 C. P. Benson
 Co. Surveyor of Young Co., Texas,
 Surveyed December 4, 5, 6, 7, 8, 9, 1893

Comers marked this \circ indicate
 original bearing, well identified,
 and with which we connected the
 aforesaid Co. Line.

State of Texas,
 County of Archer
 This sketch has been examined
 and approved in open Court, this the 12th
 day of February 1894

Adellevellyn County Judge,
 J. M. Coulson, Com. Precinct No. 1
 C. R. Comer " " " 2
 J. D. Neal " " " 3
 W. M. Biffle " " " 4

State of Texas,
 County of Young,
 This sketch has been examined and
 approved in open Court, this the
 day of 1894

J. J. Dismont, County Judge,
 J. J. Dismont, Com. Precinct No. 1
 A. J. Baber " " " 2
 W. F. Williams " " " 3
 J. W. Colston " " " 4

Var. of Co Line 9 20 E
 " to Survey 11 23 E

Young
 County

county 50110

Archer Young ⁴
Boundary

Filed Feb 26/94

Length of North line of
Young & South line of Archer
as ~~set~~ ^{set} ~~forth~~ ^{represented}
is 30 mi 1314 vs. the Statute
makes it 30 mi, and the
distance should be no
greater unless the West
body line can be iden-
tified on the ground
as having been estab-
lished here south
from the point at
30 miles and 1314 vs
and also recognized
by the late Ebody of
Throckmorton Co.

By Beaumont
4/2/94

written to
4/3/94 19-

0

State of Texas
County of Young

foregoing field notes

examined and approved in open
court this 17th day of February 1894

J. H. Johnson, Com. Prec. 1

J. E. Baker " " 2

W. H. Williams " " 3

J. W. Corbett " " 4

10999 227

in rock mound, identified as the north west corner of Young County, established by George Spiller Surveyor of Young Co, March 25, 22, 23, 1876 which is located on the north line of Young Co.

At the end of every mile is erected a Stone mound two feet high, marked in Roman notation to denote the number of the miles counting from the East. The bearings are marked V, N, L, & apt as otherwise indicated in these field notes. Surveyed December 4, 5, 6, 7, 8 & 9, 1893.

E. C. Ricketts
Richard Waggoner } Chainmen

State of Texas,
County of Archer & Young

Var. 9° 22' E.

W. J. McNeil, Co. Surveyor of Archer Co,

and C. P. Benson, Co. Surveyor of Young Co, Texas, hereby certify that the foregoing described survey was actually made by us on the ground, according to law, on the dates & with the chain carriers aforesaid, duly qualified, and that all the marks & bearings of the same, natural and artificial, are truly and correctly described and set forth in the foregoing field notes & accompanying Plat.

J. McNeil, C. S. A. Co.
C. P. Benson, S. Y. Co.

The State of Texas }
County of Archer }

The above field notes examined and approved in open Commissioners Court, this 12th day Febry 1894

Alf Wellyn County Judge
J. M. Manson Court Prot #1

- C. R. Romer # 2
- A. P. Neal # 3
- W. M. Biffle # 4

17; Thence West at 384 vs. East line of J. A. Hop-
 kinsens, 342 vs, from his S.E. Cor., 1728 vs East-
 line of S. G. Handawayden, 348 vs, north of his S.E.
 Ell cor., 1860 vs, East-line of sec#2. Cont. 1/29 for J.
 Poitevent-1445 vs. North of his S.E. Cor., 1900 vs, post
 # 18; Thence West at 1860 vs. East-line of sec#1 for J.
 Poitevent, 1453 vs, from his S.E. Cor., cross Archer and
 Horners Road, 1900 vs. post #19; Thence West at 1860 vs,
 West-line of G. W. Stell 1708 vs, from his S.E. Cor., and
 1466 vs, from S.W. Cor, of said # 1 for Poitevent, 1900 vs
 post #20; Thence West at 1257 vs. East-line of sec.
 #4. Cont. 692, for B.B.R. & Co, Ry, Co, 1714 vs from its S.E.
 Cor., 1900 vs. post # 21; Thence West at 880 vs. Bernhardt's
 Water Tank, 1257 vs, East line of sec. #1 cont. 691 for
 B.B.R. & Co, Ry, Co, 1722 vs, from its S.E. Cor., 1900 vs.
 post # 22; Thence West at 1257 vs. East line of Isaac
 Holman's Sur., 1730 vs, from its S.E. Cor., 1900 vs,
 post # 23; Thence West at 1520 vs. large horizontal
 Stone mkd A. Y. L. 1900 vs. post # 24 in prairie; Thence
 West Through prairie 1900 vs. post # 25; Thence
 West at 656 vs. West-line of Holman Sur., 1754 vs from
 his S. W. Cor., East line of Col. Sec. 1593, 410 vs, from
 its S.E. Cor., 1900 vs, post # 26; Thence West, at 100 vs,
 East line of Col. Sec. 1594, 416 vs, from its S.E. Cor. at
 140 vs East Spring of Bitter Cr. at 1140 vs Bitter Creek,
 1444 vs, East line of Col. Sec. 1595, 422 vs, from its
 S.E. Cor., 1900 vs, post # 27 on prairie ridge; Thence
 West at 868 vs, East line of Col. Sec. 1596, 428 vs,
 from its S.E. Cor., 1900 vs, post #28 on prairie ridge;
 Thence West at 312 vs, East-line of Col. Sec. 1597, 434
 vs, from its S.E. Cor., at 1656 vs. East line of Col. Sec.
 1584, 440 vs, from its S.E. Cor, 1900 vs, post # 29;
 Thence West 1100 vs, East-line of Col. Sec. 1576, 446 vs
 from its S.E. Cor. at 1880 vs. E. Spring Cr. 1900 vs post #30;
 Thence West at 544 vs, East-line of Col. Sec. # 1578,
 452 vs from its S.E. Cor., 1198 vs, large Stone set on edge
 counter 50107

0

1920 vs, old mile post # 6, MKd. VI, M. whence Post
Oak MKd Y, N.L. brs. S. 41° W. 12 vs.; Thence West at 145-
vs. East line of Sec. #1 Cert. 686 for B.B.B. Ry. Co. 302
vs. S. of its N.E. cor., 1900 vs, mile post # VII; Thence West
at 145 vs, west line of said Sec. #1, 302 vs, S. of its
N.W. Cor. and 254 vs, North of the S.E. Cor. of Colony
Sec. 1856, at 1480 vs, East line of Colony Sec 1859, 260
vs, North of its S.E. cor., 1900 vs, post # VIII, whence
a P.O. brs. N. 85° W. 2 vs.; Thence West at 924 vs, East
line of Col. Sec. 1802, 266 vs, North of its S.E. Cor. at 1020
vs, Cross Archer & Graham East road, 1900 vs, post #
9, a P.O. brs. S. $80\frac{1}{2}^{\circ}$ W. 33 vs.; Thence West at 368 vs,
East line of Col. Sec. 1801, 272 vs, North of its S.E.
Cor., at 1480 vs, East line of Col. Sec. 1400, 278 vs,
N. of its S.E. Cor., 1900 post # 10 on East point of ridge;
Thence West at 900 vs, Cross Graham & Archer Road,
924 vs, East line of Col. Sec. 1399, 284 vs, from
its S.E. Cor., 1900 vs, large Stone in meadow, Valley MKd
A XI Y for post # 11; Thence West at 368 vs, East line
of Col. Sec. 1398, 290 vs, from its S.E. Cor., at 1712 vs,
East line of Col. Sec. 1397, 296 vs, from its S.E. Cor.,
1900 vs, Stone Md. MKd A XII Y, for post # 12, on S. point
of a ridge; Thence West at 560 vs a Creek, at 1156 vs,
East line of Col. Sec. 1389, 302 vs, from its S.E. Cor.,
1900 vs post # 13, MKd A XIII Y; Thence West Crossing
branch several times at 600 vs, East line of Col.
Sec. 1377, 308 vs, from its S.E. cor. 1900 vs, post #
14 on S bank of small Creek; Thence West at 44 vs
East line of Col. Sec. 1383, 314 vs from its S.E. Cor.,
at 1388 vs, East line of #1373, 320 vs, from its
S.E. Cor., 1900 vs post # 15 in prairie; Thence West
at 832 vs, East line of 1810, 326 vs, from its S.
E. Cor. 1900 vs, post # 16 in prairie; Thence West
at 276 vs, East line of J. B. McLyman's Sur., 332 vs
from its S.E. Cor., at 1275 vs, East line of H. D. New-
man Sur., 337 vs, from its S.E. Cor., 1900 vs, post

State of Texas
Counties of Archer and Young, \approx Var 9 22 E

Field Notes of County Line retraced between Archer and Young Counties, by J. M. Cecil and C. P. Benson, County Surveyors of the Counties respectively, acting under authority of the Hon Commissioners Courts of said Counties: Beginning at the North East Corner of Young County, as established by R. H. Mathews, Special Surveyor of Young Co., Texas, a Post Oak marked $\frac{X}{2}$ on the north side and blazed on the South, East and West sides; Thence west at 80 varas a small branch, at 200 varas East line of P. H. O'Connor's 160 acre Pre., 103 varas South of his N. E. Corner, at 1150 varas his west line & East line of Sarah McKimsur, 103 vrs. South of O's N. W. Cor, and 146 varas North of McKims S. E. Cor, at 1300 vrs. top of P. O. Knoll, at 1706 vrs. West line of McKimsur, 146 varas N. of S. W. Cor, of same and 17 varas S. of the N. E. Cor, of Robt. Wilson Sur, at 1913 vrs. Old mile Stone # I whence a P. O. mkd Y N L brs. N. $87\frac{1}{2}^{\circ}$ W. 28 vrs.; Thence West, at 240 vrs. a Creek, 1470 vrs. West line of Robt. Wilson (North) Survey, 17 vrs. South of his N. W. Corner, and 797 vrs. S. of the N. E. Cor, of A. Rohus Sur, at 1640 vrs. Brush Cr., 1925 vrs. Old Mile Stone # II, whence a P. O. mkd. Y N L bears N. 74° W. 14 vrs.; Thence West at 55 varas a bluff, 1915 vrs. Old Mile Stone # III whence P. O. mkd Y N L brs. N. 43° W. 4 vrs.; Thence West 1923 vrs. Old Mile Stone # IV, whence P. O. mkd. Y N L brs S. 80° W. 4 vrs.; Thence West at 885 vrs. West line of A. Rohus Sur, and East line of A. McMullen Sur, 652 vrs. S. of his N. E. Corner, 1920 vrs. Large Stone set on edge in valley, Mkd. Y, N, C, L, V, for fifth mile post; Thence West at 757 vrs. West line of A. McMullen Sur, 652 vrs. South of his N. W. Cor. and 264 vrs. South of the N. E. Cor, of J. & G. A. Sur, Cert. $\frac{33}{177}$, at 1784 vrs. West line of same 264 vrs South from its N. W. Cor, and 1064 vrs. South of the N. E. Cor, of H. F. Peters Presumptive

counter 50105

