

Boundary lines of
Baylor Co.

Filed June 26th 1874
" " 3rd 1880

1
Only signed by Surveyor
of Baylor County.

approved June 3/90

JB -

The base line run by
Ira Wellington, West,
was commenced from
the identified NW
corner of this
County

See Letter Book

No 361 P. 431

also

No 1296 Page 326

1435 " 241

Baylor
Plat^{ts} + Feb. mts. of
line of Baylor

Filed June 9-1880

~~21~~
—

only signed by Baylor
attorney

1) Plat. Mr F. W. W. W.

L. B. Lins

Dayton Co. Gen

Filed June 3^d 1880.

Rhoads Fisher
Ch. Clerk

Only signed by Dayton
Geo. Burroughs -

See letter Book

N^o 361 P. 431

also

N^o 1296 Page 326

+ 1435 " 241

Baylor Co., Baylor Co. #1

State of Texas
Baylor County

I, J. Woodyear, clerk
of the County Court in and
for said County of Baylor do here-
by certify that the foregoing is a
Correct & True Copy of the Original Plat
and G. & notes of Survey of the South
Boundary Line of said County of
Baylor. Now on File in my Office
Ginn under my Official Signa-
ture and Seal of Office this the 20th
day of May, 1880 at Office in the
Town of Seymour

J. Woodyear Clerk of
County Court
Baylor Co. Texas



South Boundary Line of Baylor
County Texas, by the Hon Commissioners
Court of said County, by order Dated
February 9th 1880 and in compliance
with an order of same Date do here-
by certify that the above and foregoing
Survey was made in accordance
with Larr and the Mile Stones and the
corners Natural and artificial are
truly and correctly described. As to
old Surveys as well as could be
ascertained and Identified. Said
Survey was made on March 29th
30th and April 1st + 2^d 1880

Calvin Harris }
B. F. Earp } Chainmen
J. P. Ruder } Flagman

D. H. Jones
Surveyor of
Baylor Co Tex

Endorsed in

Approved by order of the
Commissioners Court of Baylor Co
Texas This 10th day of May 1880
E. R. Morris Co Judge
Baylor Co Texas

Mile Stone Thence West 1900.8. 1^m
to Stone in Earth M^d MK^d B+T as
before and XXVII for the Trinity Survey
Mile Stone Thence West 1000. 1^m Cross
a creek Course S. 85° E. ¹²⁰⁰ pass Elm
Grove 1320. 1^m Cross creek again. 1900.8.
1^m to Stone in Earth M^d MK^d B+T
as before and XXVIII for the Trinity
Eighth mile Stone, from which an
Elm Grove on N. 87° E. 400. 1^m Thence West
1900.8. 1^m to Stone in Earth M^d MK^d
B+T as before and XXIX for the Trinity
Ninth mile Stone, Thence West 1900.8. 1^m
to Four Stones in Earth M^d MK^d
as follows in The one fronting S.E.
MK^d T XXX The one fronting N.E.
MK^d B The one fronting N.W. MK^d
K The one fronting S.W. MK^d H
The Said Stones marking the N.W.
Corner of Troock Morrow County and
The S.W. Corner of Baylor County

State of Texas
Baylor County } D. D. H. Jones Surveyor
of Baylor County Texas
appointed to run and mark the

in Rock Pile MK^d B+T as before and
XX for the Trustee's mile Stone said
Stone being about 300 m N of Colorado
Co School Lands and 4160 m N of the
S.W. Corner of the Same, Thence West
1900^s. m to Stone in Earth MK^d MK^d
B+T as before and XXI for the Trustee
first mile Stone, Thence West 810 m Cross
Drainage, Course N 10° W, 1900^s. m to
Stone in Earth MK^d MK^d B+T as before
and XXII for the Trustee second mile
Stone, Thence West 1740 m Cross Antelope
Creek Course N 10° W, 1900^s. m to Stone
in Earth MK^d MK^d B+T as before
and XXIII for the Trustee third mile
Stone Thence West 1600 m Cross Small
Stream Course N, 1900^s. m to Stone in
Earth MK^d MK^d B+T as before and
XXIV for the Trustee fourth mile Stone
Thence West 1900^s. m to Stone in Earth
MK^d MK^d B+T as before and XXV
on S. Side for the Trustee fifth mile
Stone, Thence West 475 m Cross Drainage
Course N, 960 m Cross Miller's Creek
1900^s. m to Stone in Earth MK^d near
the, and S of the N.E. Corner of the
Ramsey Family's Sur, MK^d B+T as before
and XXVI for the Trustee sixth mile

Thence West 130 m Cross Brauch, Course
S. E. 1900.8 m to Stone in Rock Pile MK^d.
B + T as before and XIV for the Fourteenth
Mile Stone. Thence West 1900.8 m to
Stone in Earth MK^d MK^d. B + T as
before and XV on S. side for the Fifteenth
Mile Stone. Said Stone being on Colorado
Co. School Lands 840 m S and 800 m
W of the N. W. Cor of the Travis Co.
School Lands. Thence West 1900.8 m to
Stone in Earth MK^d MK^d. B + T as before
and XVI for the Sixteenth Mile Stone
Thence West 375 m Cross Ft. Hill Trail
1340 m Cross a creek Course N., 1900.8
m to Stone in Earth MK^d MK^d. B + T
as before and XVII for Seventeenth Mile
Stone. Thence West 1900.8 m to Stone in
Rock Pile MK^d. B + T as before and
XVIII for the Eighteenth Mile Stone
Said Stone being on S. point of High
Rocky Hill. Thence West 1280 m Cross
Creek Course N. 30° W., 1900.8 m to Stone
in Rock Pile on W. Slope of a Hill MK^d.
B + T as before and XIX for the Nineteenth
Mile Stone. Thence West 275 m Cross
Brauch Course N. 10° E., 1900.8 m to Stone

Sixth mile Stone, Thence West 1000^m
reach the E BK of the Brazos River
Course S 35° E 1220^m N. BK, 1900^s^m
to a Stone in Rock Pile MK^d B + T as
before and VII on S. Side for the Seventh
mile Stone, Thence West 1340^m across
Small Streams, 1900^s^m to Stone in Rock
Pile MK^d B + T as before and VIII for
The Eighth mile Stone, Thence West 1900^s^m
to Stone in Rock Pile MK^d B + T
as before and IX for the Ninth mile
Stone being about 1100^m W of the S Line
of a 1/3 League Sur in name of Calvin
Farmer, Thence West 1600^m Cross Magow
Creek, Course N E, 1900^s^m to Stone in
Rock Pile MK^d B + T as before and X
on S. Side for the 10th mile Stone, Thence
West 1900^s^m to Stone in Rock Pile
about 120^m W of High Rocky Hill
MK^d B + T as before and XI on S side
for the Eleventh mile Stone, Thence
West 1621^m across Magow Creek, 1640^m
Cross same, 1720^m Cross same, 1900^s^m
to Stone in Rock Pile, in Valley MK^d B
+ T as before and XII on S. Side for the
Twelfth mile Stone, Thence West 1900^s^m
to Stone in Rock Pile MK^d B + T as before
and XIII for the Thirteenth mile Stone

Side

Side for Second Mile Stow. Said
mile Stow is 605 ¹/₂ m N. and 475 ¹/₂ m
N of the N E Cor of a Sur in name of
Milton Garrett. Thence West passing through
the W¹/₂ B Logan Sur, Crossing his N Line
at about 740 ¹/₂ m from S^d Second mile
Stow 1900.8 ¹/₂ m to Stow in Rock Pile
MK^d B + T on N. + S. Sides respectively
and MK^d 111 for Third mile Stow
being 845 ¹/₂ m S of the N. Line of a Sur.
in name of Michael Watson. Thence West
passing through the W¹/₂ Bateman Sur
1900.8 ¹/₂ m to Stow in Rock Pile MK^d B +
T as before and IV on S. Side for the
Fourth mile Stow from which a P. O.
2 feet Dia MK^d TNL br N. 67° E
64 ¹/₂ ¹/₂ m Thence West passing through
Samuel Beckman Sur at about 460 ¹/₂ m
N of the S Line, 1900.8 ¹/₂ m to a Stow in
Rock Pile MK^d B + T as before and V
on S. Side for the Fifth mile Stow —
Thence West 1080 ¹/₂ m across Mill's Drapel
1677 ¹/₂ m Crossing N. Line of Jullirach
Sur 520 ¹/₂ m N of his S. W. Corner, 1900.8 ¹/₂ m
a Stow in Rock Pile in Dragos Valley
MK^d B + T as before and VI for the

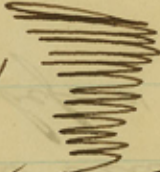
The State of Texas
Baylor County  Field Notes of a
Survey, The South Boundary
Line of Baylor County Texas, made
in compliance with an order from
The Hon. Commissioners Court. of said
County of Baylor Dated February
9th 1880

Beginning at the N. W. Corner
of Chung County at Large Stone in Rock
Pile N^o 1 ABTY 507 4/4 m N and 607
7/4 m of J. E. Corner of Tex. Em^o and
Lant Co half Section No 1578 found
which a Forked Mesq^o 14 in Dia (D^o)
N^o 1 NWYC Trs. S. 8 1/2" N 12 4/4 m
a Double Mesq^o 6 1/4 in Dia N^o 1
B. C. Trs. N 52° W 33 1/2", a Mesq^o 10
in Dia N^o 1 YC Trs. S. 31° E 125 1/2
and a P. O. Grove on Bluff Trs. S. 43 1/2
E about 800 4/4 m. Thence West 900 4/4 m
across Spring Creek, Course S. 1900 4/4 m
to Stone in Rock Pile N^o 1 B on W
Side and T on S Side and 1 on E
Side for first Mile Stone from which
a Mesq^o 14 in Dia N^o 1 X Trs. N
9° E 128 1/2", Thence West 1900 8/4 m to
Stone in Rock Pile N^o 1 B + T on W
and S Sides respectively and 11 on S

Sample of 100 ft. 1/2

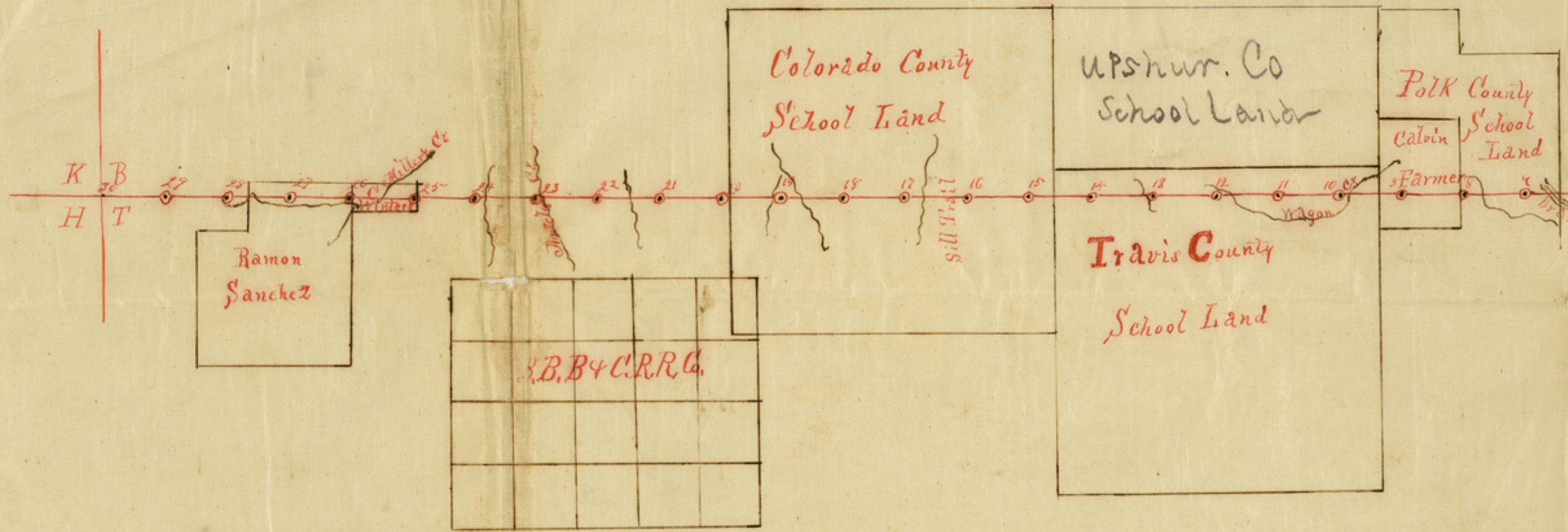

James	Saml	Wm	Wm	Wm	Wm	Wm	Wm	Wm	Wm
Wm	Wm	Wm	Wm	Wm	Wm	Wm	Wm	Wm	Wm
1272	1273	1274	1275	1276	1277	1278	1279	1280	1281
1272	1273	1274	1275	1276	1277	1278	1279	1280	1281

county 50358