

Wilbarger Co

Wichita Co.

Baylor Co.

Archer Co

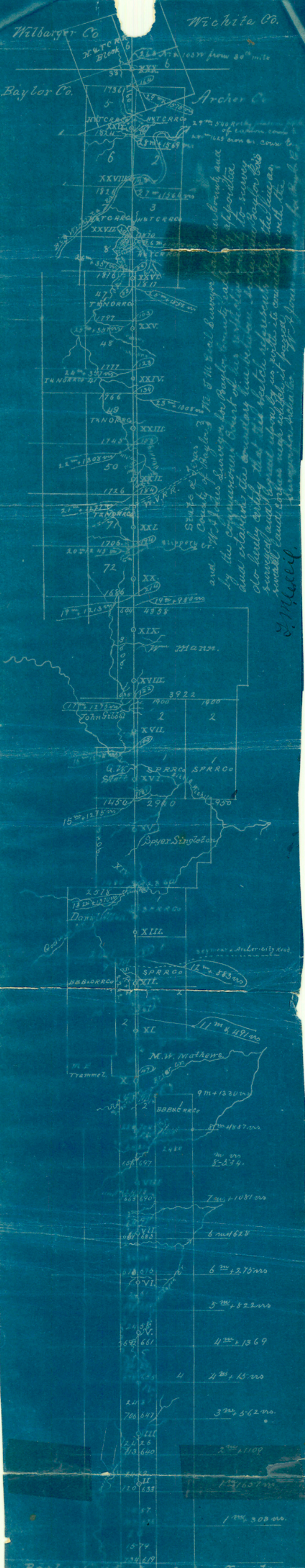

State of Texas
County of Baylor
and
County of Archer
The J.M. Cecil Survey for the barbour and
by the Commissioners Court of his jurisdiction
and containing the boundary line between Baylor Co
do hereby certify that this sketch represents
surveyed and by great upon by us with its corners
small land corners near which it passed
Surveyor's Returns
J. M. Cecil.

Baylor County

Archer County

Young County

AR 3

county 2002

State of Texas,
County of Baylor }

Jan 23rd 1894.

Field notes of a Survey of the East line
of Baylor and the West line of Archer
Counties.

B — Beginning at the North West
corner of Young county, a large stone
in a pile of rock marked A. B. S. by
about 930 varas east of Spring Creek
503 varas North of the South line
615 varas West of the East line 850
varas South of the North line and
738 varas E. of the West line of 1/2 Sec-
tion No. 15-78, for T. E. & L. Co. a stump
of a forked mesquite tree S. 8 1/2 E. 12
varas, another mesquite stump
br. N. 5-2° E. 33 varas, another br. S.
31° E. 125 varas, and a P. O. tree stand-
ing on rocky bluff bears S. 43 1/2 E.
about 800 varas.

I — Thence North, a variation
of 9° 25' E. at 850, varas, cross the
common line of Colony 1/2 Sec-
tions No. 15-78 and 15-79 at a point
734 varas east of their West corner
and 619 varas West of their East cor-
ner, and at 1900 3/10 varas a stone mon-
ument 2 ft. high, marked A. on
the east side and B. on the west
side, also numbered I for the
first mile stone.

7681

AR

1 its passes, and that the corners
2 with the marks and bearings, both
3 natural and artificial are truly
4 and correctly set forth herein.

5 I witness my official signature
6 this 15 day of February A.D. 1894,

7 J. W. Cecil,
8 C. S. A. C.

9 State of Texas

10 County of Baylor & J. L. A. Jones, ap-
11 pointed Special Surveyor by the
12 Commissioner's court of Baylor
13 county, in connection with the
14 Surveyor appointed by Archer county
15 to survey and establish the East bound-
16 ary line of Baylor county, and the
17 West boundary line of Archer co
18 and to begin at the Northwest corner
19 of Young county, and run North
20 30 miles to the S. W. corner of Kilbarger
21 Co, and E corner of Baylor Co. do hereby
22 certify that I have made the Survey
23 in compliance with the order of
24 the Court and in accordance with
25 the law, and that the foregoing
26 field notes and the plat thereto at-
27 tached represents the true position
28 of said line as established by us
29 in relation to the several surveys
30 through which it passes, and
31 that the corners with the marks and
32 bearings, both natural and artifi-

red bank at head of hollow bearing S. 87 1/2
E. 155 Varas, and a cottonwood tree
in a hollow course South (not visi-
ble from corner) bearing about S. 15° N.
about 700 Varas and the most West-
ern corner of Survey No. 6, Block 6, as
established by Mr. Kinney bears
N. 21° 28' N. 787 Vrs Survey completed
on the 9th day of January, 1894.

Jeff Scott, Chain.
B. L. Rickett, meas.

State of Texas
County of Archer & I. T. W. Cecil, County
Surveyors of Archer County, Texas, ap-
pointed by the Hon. Commissioners
Court of said County, in connection
with the Surveyors appointed by the
Comis Court of Baylor County, to
retrace and establish the common
boundary line between Archer &
Baylor Counties beginning
at the N. W. corner of Young Co. Do
hereby certify that I have made the
survey in compliance with the
order of the court, and according
to law on the date and with Chain-
men aforesaid duly qualified, and
that the foregoing field notes and
Plat attached thereto represent the
true position of that line as es-
tablished by us, relatively to the
several surveys through which

at 1900 $\frac{8}{10}$ varas a stone monument on high rocky hill marked on the East side and on the West side and numbered XXIX for the 29 $\frac{1}{2}$ mile stone.

XXX — Thence north at a variation of $10^{\circ}41'E$ at 459 varas cross the South east line of Survey No. 33 of Block 6, for the H & T. C. R. R. Co. 508 varas S. 72° Pt. from its east corner and 1392 varas N. 72° E. from its South corner at 540 varas cross a rocky place in the forks of a cañon at 1575 varas cross the S. line of Section No. 5 H & T. C. R. R. Co. 164 varas West of its S. E. corner at 2104 varas cross the N. E. line of said Survey No. 33 at a point 335 varas S. 18° E. from its North corner and 1565 varas N. 18° Pt. of its East corner at 2160 varas a stone monument set as the S. E. corner of Baylon and the N. Pt. of Archa, the S. Pt. of Kichita and S. E. of Kibbarger counties, said Stone is 18 x 24 x 3 inches set on side of hill south of a ravine course N. Pt. it is marked on N. Pt. side ^{S. Pt. Co.} S. Pt. cor, on its S. E. side ^{B. 130 A.} N. Pt. cor. another stone facing S. Pt. is marked ^{S. E.} B. C. XXX, another marked SEWC a dead double mesquite tree S. $27\frac{1}{2}$ Pt. 138 $\frac{1}{2}$ do S. 35° 50 Pt. 118 end of branch N. 100 varas, a

1 at 1900 $\frac{8}{10}$ varas a stone monument
2 on the South bank of the creek in
3 fork, said stone is marked on
4 the east side and on the West side
5 and numbered XXVII for the twenty
6 seventh mile stone,

7 XXVIII — Thence North at 50 varas
8 cross creek second time at 737
9 varas cross the line of Sect. No. 7
10 and Section No. 3 for H & T. C. R. R.
11 co. and cross the Pennon and
12 Archer City road course N. N. and
13 S. E. at 1494 varas pass 121 varas
14 West of a stone set in Valley at
15 1564 varas cross the line of
16 Surveys No 7 and 6 for H & T. C. R. R.
17 co. 23 varas N. of their east corner
18 at 1900 $\frac{8}{10}$ varas an earth mound
19 on South bank of River in sand
20 but a wild china brs S. 46 E. 43
21 varas.

22 XXIX — Thence North crossing
23 the Big Wichita River course east
24 at 122 varas the sud bluff bank
25 on the North side of River at 1615
26 varas pass 57 varas West of the
27 cottonwood bearing tree for the
28 N. E. of Sect. 6, H. & T. C. R. R. co. at 1569
29 varas cross the line of Sections
30 6 and 5 for the H & T. C. R. R. co. 76
31 varas N. of their east cor. at 1685
32 varas cross creek course S. 80 E.

co. 1766 Varas East of their West corner and 134 Varas West of their East corner and at 1900 $\frac{8}{10}$ Varas an earth mound 2 ft. high in a field for the twenty fourth mile,

XXV — Thence North at 1296 Varas a creek, course N. 80° E. at 1357 Varas cross line of 41 and 48 S. & A. O. R. R. Co. Survey 123 Varas West of their East corner and 1777 Varas East of the S. E. cor. of said 48 at 1900 $\frac{9}{10}$ Varas a stone monument 2 ft. high marked A on the east side and B on the West side and numbered XXV for the twenty fifth mile stone.

XXVI — Thence North at 250 Varas pass old Stone No. 25 at 357 Varas cross the line of 48 and 47, S. & A. O. R. R. Co. at a point 1797 Varas east of their west corner and 103 Varas West of their East corner and at 1552 Varas cross the S. line of Section No. 1 for the H. & T. L. R. R. Co. 83 Varas east of its S. E. cor. and at 1900 $\frac{8}{10}$ Varas a stone monument 2 ft. high marked A on the east side and B on West side and numbered XXVI for the twenty sixth mile stone

XXVII — Thence North at 1558 Varas cross the line of Sect. No. 1 and Sect No. 3 for H & T. L. R. R. Co. 30 Varas E of their S. E. corner at 1850 Varas a slough

1 102 Varas West of a cor. at 1277 Varas
2 cross the line of Sections 71 and 50
3 T. & A. O. R. R. Co. 1726 Varas east of their
4 West corner and 174 Varas N. of their
5 East corner and 1900⁹/₁₀ Varas a stone
6 monument in a small rocky
7 ravine two ft. high marked A on
8 the East side and B. on the West
9 side marked on one side 22, on
10 the other XXII as the twenty second
11 mile stone.

12 XXIII - Thence North at 200 Varas
13 branch course N. E. at 417 Varas from
14 103 Varas N. of a corner at 1121 Varas
15 a branch course N. 10° N. at 1308 Varas
16 cross the line of sections Nos. 50 and
17 49, T. & A. O. R. R. Co. 1745 Varas E. of
18 their West corner and 155 Varas
19 West of their east corner at 1430 Varas
20 from 105 Varas West of a corner the
21 N. N. of S, T. & C. R. R. Co. and at 1900⁹/₁₀
22 Varas a stone monument 2 ft
23 high in a valley between breaks
24 marked A on the East side and B on
25 the West side and numbered XXIII
26 for the twenty third mile stone.

27 XXIV - Thence North at 200 Varas
28 a branch course N. at 275 Varas
29 from 12 Varas east of the old 23⁷/₁₀
30 mile stone at 1540 branch course
31 N. N. at 1308 Varas cross the line of
32 sections 49 and 41 for T. & A. O. R. R.

of the G. L. Stoll Survey and the
South line of the John Gibbs survey
105 Varas west of their common
East corner at 1900 $\frac{8}{10}$ Varas a Stone
monument in break 2 ft. high
marked A on the east side and B on
the West side and numbered XVII
for the seventeenth mile Stone.
XVIII - Thence North at 1350 Varas
frass 40 Varas N. of a Stone corner
on S. slope of rocky hill at 1275
Varas cross the N. line of the John
Gibbs survey 122 Varas West of its
North east corner and cross the
South line of the G. L. Stoll Survey
635 Varas east of its S. E. corner
at 1540 Varas top of break and at
1900 $\frac{8}{10}$ Varas a Stone monument
2 ft. high in open prairie marked
A on its east side and B on its
West side and numbered XVIII for
the eighteenth mile Stone.
XIX - Thence North cross level
mesquite prairie at 1409 Varas
frass 42 Varas west of a bois d'arc
stake and 4 futs at 1842 Varas frass
42 Varas west of another bois d'arc
stake and 4 futs at 1900 $\frac{8}{10}$ Varas an
Earth mound 2 ft. high among
4 futs for the nineteenth mile.
XX - Thence North at 250 Varas
frass 42 Varas east of a large Stone

1 Varas E. of its S. Pt. cor. and 2360 Varas
 2 West of its South east corner at
 3 1444 Varas top of a round mound
 4 at 1650 Varas a Slough at 1720 cross
 5 Godwyn Creek at 1900 $\frac{8}{10}$ Varas
 6 a stone monument in a field
 7 2 ft. high marked A on the East
 8 side and B on the West side and
 9 numbered XIV for the 14th mile
 10 stone.

11 XV - Thence North at 1270 Varas
 12 cross a branch course S. E. at 1900 $\frac{8}{10}$
 13 Varas a stone monument marked
 14 A on the East side and B on the
 15 west side and numbered XV for
 16 the 15th mile Stone.

17 XVI - Thence North at 1275 Varas
 18 cross the North line of the Singleton
 19 1450 Varas E. of its N. Pt. corner and the
 20 South line of the D. Pt. Steel survey
 21 89 Varas West of its South east cor-
 22 ner at 1350 Varas cross a branch
 23 course N. E. at 1750 Varas cross a
 24 creek course S. E. at 1900 $\frac{8}{10}$ Varas
 25 a stone monument in overflow
 26 Valley 2 ft. high marked A on its
 27 east side and B on its west side and
 28 numbered XVI for the Sixteenth
 29 mile Stone.

30 XVII - Thence North at 500 Varas
 31 cross the little Kichita River course
 32 S. E. at 1274 Varas cross the North line

1 + C. R. R. Co, 650 Varas east of their
 2 West corner and 704 Varas west of
 3 their East corner and at $1900 \frac{8}{10}$
 4 Varas a stone monument 2 ft.
 5 high marked A on the East ~~side~~
 6 and B on the West side and numbered
 7 IX for the ninth mile stone.

8 X - Thence North at 1330 Varas
 9 cross the N. line of half Section 20.
 10 2, for B. B. B. & C. R. R. Co. and the line
 11 of the W. E. Trammell survey at
 12 a point 642 Varas E. of their com-
 13 mon cor. and 711 Varas west of the
 14 N. E. corner of said $\frac{1}{2}$ Section 20. 2,
 15 at 1490 Varas cross Brian creek
 16 course S. 80 E. and at $1900 \frac{8}{10}$ Varas
 17 a stone monument 2 ft. high
 18 marked A on the East side and B,
 19 on the West side and numbered
 20 X for the tenth mile stone.

21 XI - Thence North at 177 Varas
 22 cross the North line of W. E. Trammell
 23 survey and the extreme
 24 South line of Section 20. 2 for Stone
 25 Kyle & Kyle 47 Varas west of their
 26 common east corner at $1900 \frac{8}{10}$
 27 Varas a stone monument in
 28 edge of a field marked A on the
 29 East side and B on the West side
 30 and numbered XI for the eleventh
 31 mile stone.

32 XII - Thence North at 491 Varas

1 cross the line of No. 1 and No. 2, S.K.
2 & K at a point 67 Varas west of their
3 common East corner at 1050
4 Varas the South edge of breaks of
5 Godwyn creek at 1900 $\frac{3}{10}$ Varas a
6 stone monument in breaks
7 2 ft. high, marked A. on E. side and
8 B. on West side and numbered
9 XII for the twelfth mile stone,
10 XIII - Thence North at 650 Varas
11 cross the Seymour & Archer City
12 road, course East and West at 883
13 Varas cross the North line of Sur-
14 vey No. 1 for Stone, Kyle & Kyle, and
15 the South line of the Daniel Allen
16 survey 87 Varas west of their com-
17 mon East corner at 1900 $\frac{3}{10}$ Varas
18 a stone monument 2 ft high
19 marked A on the east side and
20 B on the West side and num-
21 bered XIII for the 13th mile stone,
22 XIV - Thence North at 570 Varas cross
23 the top of a round mound, at 464
24 Varas, a pile of stone on the top of
25 a round topped hill, thence a pile
26 of stone on a sharp peak bears N.
27 28 E. and another round topped
28 hill bears N. 83 $\frac{1}{4}$ E. at 1670 Varas
29 cross the North line of the Daniel
30 Allen survey 110 Varas N. of its North
31 East corner and the South line of
32 the Spyer Singleton survey 1480

East of their West corner and 676
 Varas West of their East corner at
 1370 Varas cross a branch, course
 east at 1628 Varas cross the line of
 2468 and 2471 at a point 669 Varas
 East of their West corner and 683 Varas
 West of their East corner, and at 1900⁸/₁₀
 Varas a stone monument marked
 A on the east side and B on the west
 side, and numbered VII for the
 seventh mile stone,

VIII— Thence North at 700 Varas
 the top of breaks at 1081 Varas cross
 the line of half sections No. 2471
 and 2478 at a point 663 Varas
 East of their West corner and 690
 Varas West of their East corner, at
 1500 the South edge of the breaks
 at 1900⁵/₁₀ Varas a stone monument
 2 ft. high marked A on the East side
 and B on its West side and num-
 bered VIII for the eighth mile stone,

IX— Thence North at 534 Varas
 cross the line of half sections Nos.
 2478 and 2481 at a point 656 Varas
 East of their West corner and 697 Varas
 West of their East corner at 800 Varas
 cross bear branch at 968 Varas
 cross the same branch the fifth
 time at 1887 Varas cross the line of
¹/₂ sections No. 2481 for the T. E. & L
 Co. and ¹/₂ section 2 for the B. B. B.

1 marked A. on the East side and B. on
2 the West side, and numbered IV for
3 the fourth mile stone,

4 V— Thence North at 15 Varas cross
5 the line of half sections Nos. 2431
6 and 2451 at a point 698 Varas
7 East of their West corner and 655
8 Varas West of their East corner and
9 at 1369 Varas cross the line of half
10 sections 2451 and 2458, at a point
11 692 Varas East of their West corner
12 and 661 Varas West of their East cor-
13 ner and at 1800 Varas cross Kichka
14 from creek course S. E. and at 1900^{8/10}
15 Varas, a stone monument 2 ft. high
16 marked A. on the East side and B. on
17 the West side and numbered V for
18 the fifth mile stone

19 VI— Thence North at 822 Varas
20 cross the line of half sections No.
21 2458 and 2461 at a point 684 Varas
22 East of their West corner and 669
23 Varas West of their East corner at
24 1200 Varas pass a stone mound
25 on a rocky point and at 1900^{8/10}
26 Varas a stone monument 2 ft.
27 high, marked A. on its East side and
28 B. on its West side, and numbered
29 VI for the sixth mile stone,

30 VII— Thence North at 275 Varas
31 cross the line of half sections
32 2461 and 2468 at a point 677 Varas

1 **II** — Thence North at 303 Varas
 2 cross the common line of $\frac{1}{2}$
 3 sections Nos. 1579 and 1587 at a
 4 point 727 E. of their common
 5 west corner and 626 Varas West
 6 of their east corner and at 1657 Varas
 7 cross the common line of $\frac{1}{2}$
 8 sections Nos. 1587 and 2412 at a
 9 point 720 Varas east of their com-
 10 mon west corner and 633 Varas
 11 West of their east corner and at 1900 $\frac{8}{10}$
 12 Varas, a stone monument 2 ft.
 13 high, marked A. on the east side
 14 and B. on the west side, and num-
 15 bered II for the second mile stone,

16 **III** — Thence North at 1109 Varas
 17 cross the common line of $\frac{1}{2}$ Sec-
 18 tions Nos. 2412 and 2426 at a point
 19 713 Varas East of their west corner
 20 and 640 Varas West of their East corner
 21 at 1800 Varas cross Spring creek
 22 course S. N. and at 1900 $\frac{6}{10}$ Varas, a
 23 stone monument 2 ft. high
 24 marked A. on the East side and B.
 25 on the West side, and numbered
 26 III for the third mile stone,

27 **IV** — Thence North at 562 Varas
 28 cross the line of half sections Nos.
 29 2426, and 2431, at a point 706 Varas
 30 East of the West corner and 647 Varas
 31 West of their East corner, and at 1900 $\frac{8}{10}$
 32 Varas a stone monument 2 ft. high,

cial as & truly described herein, and that the chainmen were legally qualified,

Given under my hand, at Seymour Texas, this 31st day of January A.D. 1894,
H. A. Jones,
Special Surveyor.

The State of Texas }
County of Baylor } D. D. Henan, clerk of the County Court of Baylor
County, Texas, hereby certify that the above and foregoing is a true and correct copy of the original filed notes of the East line of Baylor County & the West line of Archer County as approved by the Commissioners' Court of Baylor County, Texas, on the 12th day of Feb'y. 1894 and entered on the minutes of said court of the Feb'y. term thereof, 1894, in Vol. 2 at pages 176 to 185 inclusive - and that the plat hereto attached is a true copy of the original plat attached to said original filed notes. Given under my hand and seal of office this 18th day of May, A. D. 1894.

D. D. Henan, C. C. C.
Baylor Co. Tex.

Field Notes of
East line of Baylor
County

*3

Filed Jan'y 31, 1894,
D. D. Henan, C. C. C.
Baylor Co. Tex.

Examined in open
commissioners court
& approved this 12th
day of Feb'y 1894,
by Henan,
Clerk of Baylor Co. Tex.

Examined & approved
in open commis-
sioners court on this
15th day of Feb'y A.D. 1894,
A. D. Jewell, Jr.,
Co. Judge Archer Co. Tex.

1894
Baylor & Archer
Boundary

Filed May 21st 1894
[Signature]
Examined and approved
May 23rd 1894
G. W. Beaumont