

2
1

1877

Field notes
of
County Line
between
Kendall & Blanco Co.

no account - see in
documents on field
notes

Blanco May 8 - 1877.

Hon. J. J. Gross
Comr. Gen. L. O.
Austin Texas

Dear Sir -

Herewith enclosed you
will please find Certified Copy of The Field notes
of Preemption Survey made for James Campbell -
when in L. O. a few days since, the Original could not be
found - You will also find Land Scrip No 1422 -
together with field notes of Surveys made by virtue of
The same, and transfer to Theodore Gersfers.

From the
Maps in the Land Office a portion of this work
appears to be in in Kinross County, but such is
not the case. - "See Genl Laws of 1862, page 33. - Changing
the boundaries of Blanco - which reads as follows. -
"Beginning at S.E. Corner of Gillespie Co -
Thence S 27° E. to the line of Comal County -
You will observe - That the line on the Maps, at
the L. O. is represented as running S 37° E - which
is certainly, not in conformity with the Laws

defining or Changing the boundaries of Blanco
 County. About 12 Months since our County made
 an effort to have this line established, but from some
 informality in the notice to Kendall County, they failed
 to send a Commissioner to meet us, I however, proceeded
 to run the line, and know exactly where it runs,
 on a course $S 27^{\circ} E$. - at your earliest convenience
 you will give me your ruling in this matter

(See diagram below)

Very Respectfully
 John M. Watson
 Surveyor of Blanco County

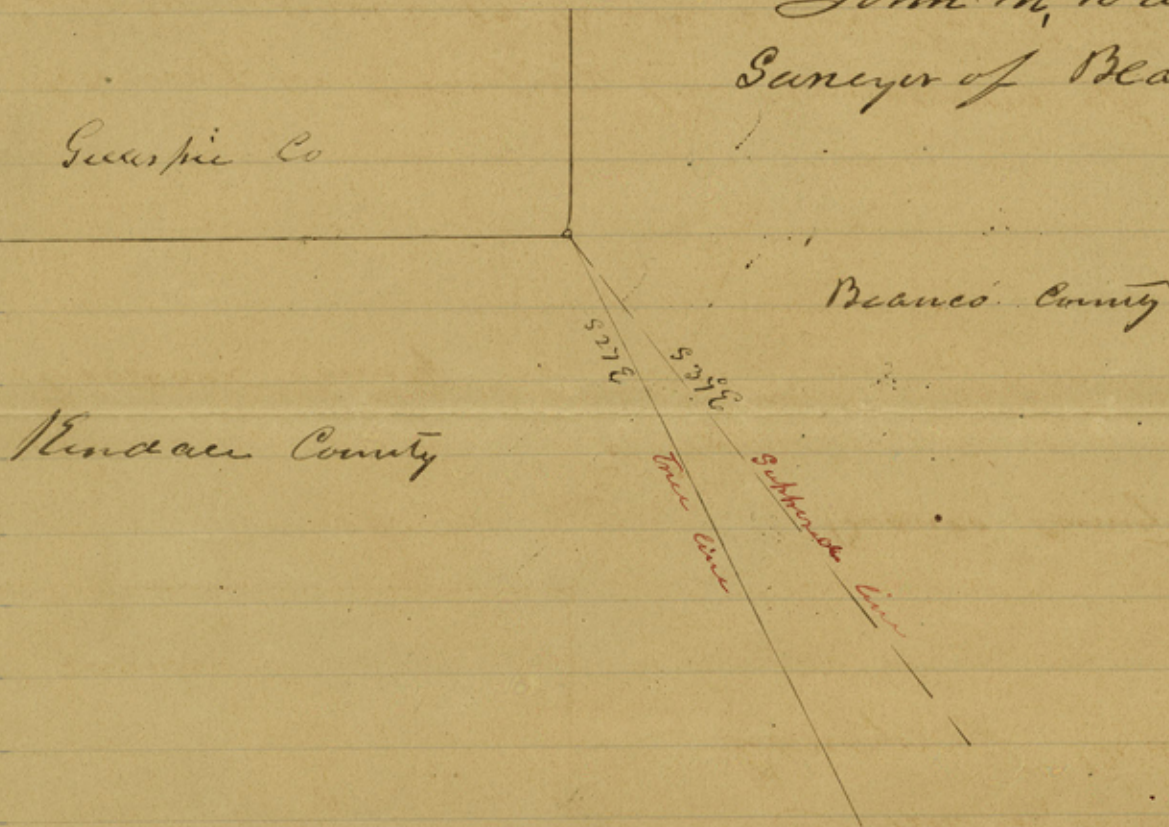

Blanco Co. Bdry. Line #2