

4/5 Briscoe Co

2-7-1879

Boundaries

Approved

+

Abstract Corrected

Feb 7/79

Be it remembered, that on Monday the 14th, day of August A.D. 1893; there came on and was held a regular session of the Honorable Commissioners Court of Briscoe County at the Court House of said County, in the town of Silverton, Present, Honorable, J. M. Stallard, County Judge, presiding; S. P. Husa, Commissioner of Precinct No. one; John Gady Commissioner of Precinct No. Two; Vernon Wilkinson Commissioner of Precinct No. Three; M. L. Malone Commissioner of Precinct No. Four; J. L. Anderson, County Clerk and Minor Crawford Sheriff.

Tuesday 15th of Aug. 1893.

It appearing to the Court that the boundary line of Briscoe County between the Counties of Donley and Armstrong is not sufficiently definite, and well defined. It is therefore ordered by the court that Nat G. Walker County surveyor of Briscoe County, Texas, be and is hereby appointed to ascertain by actual survey, the boundary of said Briscoe County said boundary being the line between Briscoe County and the Counties of Donley and Armstrong and also to establish and mark the N. E. and N. W. corners of Briscoe County in the manner prescribed by law, and it is further ordered that said County surveyor proceed to the N. E. corner of Briscoe County on the 1st day of Dec. 1893 for the commencement of said survey, and it is ^{further} ordered by the Court that a copy of this order be sent by the County Clerk of Briscoe County to each of the Courts of Donley and Armstrong in time prescribed by law.

OFFICE OF
NAT. G. WALLER, COUNTY SURVEYOR,
BRISCOE COUNTY.

2178

SILVERTON, TEXAS, February 9, 1894

Hon W. L. Mc Gaushey

Dear Sir
Yours of recent date to the Co Clerk
concerning the N. Co. lines did not
get in before the Court at its
regular term but they meet soon
again and the matter will go before
them then.

The position of Sur. No 11 A + G
I am satisfied is correct - I found
its S. corner of 11 & to be true
that it was correct & made connec-
tion with the W corner of Sur No 23
from which a stone mound on hill bet
Nos 6 & 22 was

The NW corner of 1 A + G & the
SE corner of Sur No 49. I found
on a bluff of River
To more fully satisfy myself

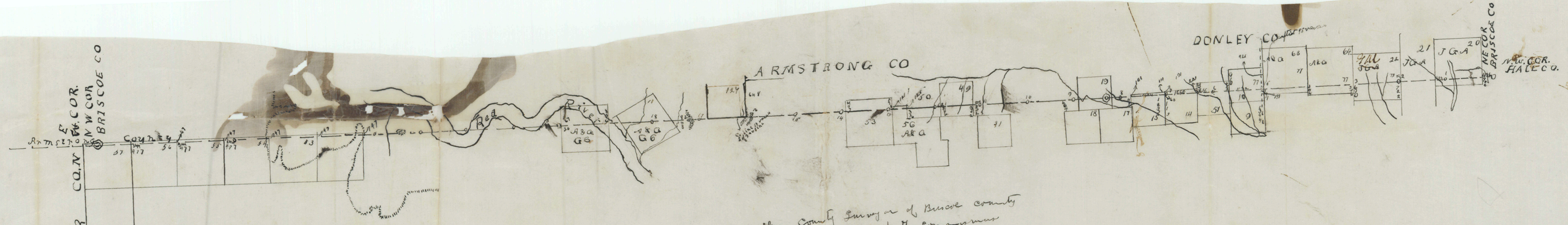

The State of Texas,
 County of Briscoe | J. J. L. Anderson Clerk of the
 County Court of Briscoe County, Texas, do hereby
 certify that the foregoing is a true and correct
 copy of the original plot of the north boundary
 line of Briscoe County, Texas now on file in
 my office.
 Given under my hand and seal of said
 Court, at office in Silverton Tex. this the
 15th day of July A.D., 1894.
 J. J. L. Anderson Clerk.

I, Mary Walker County Surveyor of Briscoe County
 duly appointed and qualified by the common
 court of Briscoe County to locate survey and
 mark the north boundary line of Briscoe Co
 do hereby certify that the above map is a
 true & correct map of the North Boundary line
 of Briscoe County whereof witness my hand at
 Silverton Texas this the 15th day of
 July 1894

Handwritten signature

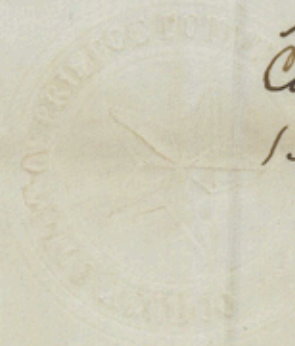

Handwritten initials

Handwritten mark

Small printed text

4/ North Boundary
Line of
Briscoe Co

Filed in Gen Land
Office Feb 7th 94

Chief Clerk

separate land part
from date of filing

From that point I produced
the ~~said~~ said line to the West
ward making due deflection
for the curvature of the Earth and
by so doing located a true Parallel
of Latitude and the same for
the Boundary lines between
Prescoe Donley and Armstrong
counties.

Great care was given to course
and measurement and the lines
were well and permanently marked
as will appear from the accom-
panying Maps & Field notes

In testimony whereof I hereunto
set my hand at Silverton Texas
this the 2nd day of January 1894

Nat'l Walker DePue Surveyor

I Nat'l Walker County Surveyor
of Prescoe duly appointed and qual-
ified to ascertain the relative posi-
tion of the survey lines along the
North Boundary line of Prescoe County
do hereby certify that all calls
for course and distances for points
in the County line from surveyor-
men were either made or computed
from actual measurements in
the field.

In testimony whereof witnesses my hand
at Silverton Texas this the 2nd day
of January 1894

Nat'l Walker County Surveyor
of Prescoe County
T. J. T.

Briscoe Co Edwuy Linc #4

17
P.C.
JH

THE STATE OF TEXAS,

County of Briscoe } I, J. L. Anderson
Clerk of the County Court of Briscoe County, Texas, do hereby certify that

the foregoing is a true and correct copy of the original field notes of the north
boundary line of Briscoe Co. Tex

now on file in my office.

Given under my hand and the seal of said Court, at Office in Silverton Tex.
this the 15th day of July A. D. 1894

ATTEST: J. L. Anderson Clerk.

By _____ Deputy.

1 actually made on the ground
2 according to law on the dates and
3 with chain men afore said duly
4 sworn and that all the corners
5 lines and boundaries and marks
6 of the same whether natural or
7 artificial are truly set forth in
8 the foregoing Map & Field Notes.

9 In testimony whereof witness my
10 hand at Selwinton this the 21st
11 day of January 1894

12 Nat G Waller

13 Deputy Surveyor of
14 Beaslee & Special

15 Surveyor for said work

17
18 I Nat G Waller duly appointed
19 and qualified by the Commissioners
20 Court of Beaslee County to locate
21 the County Boundary lines
22 between Beaslee Louber and
23 Assiniboia Counties did on
24 the 1st day of December 1893
25 proceed to locate the same in
26 the following manner

27 At the North West corner
28 of Hall, having established
29 a meridian and laid off an
30 angle of 90° deg to the West for
31 a true East and West ^{line} at that
32 point

30th
mile

Thence West at 548 varas pass
earth mound and spot ^{at trench}
1851 varas a mound of earth 11 feet
in diameter ^{at} for the N.W. corner of
Buscove county also the established
North East corner of Swisher
County in the South Boundary
line of Armstrong County
from which a stone marked
(N.W.) (S.E.) (A) set in circular
trench and earth
mound 15 feet in diameter and
4 feet high bears North 53 West
78 varas

Surveying beginning on Dec 1st and
continued until the 15th of December 1892

Magnetic variation varies from $10^{\circ} 12'$
East to $10^{\circ} 36'$ East.

Thomas Cooper } chain
Fred Biffle } men

I Natl Waller Surveyor duly
appointed and qualified by the Com-
missioners Court of Buscove
County to locate mark and survey
the boundaries lines between Donby
Armstrong and Buscove counties
do hereby certify that the fore
going survey as shown in the
field notes attached hereto was

24th
mile

Thence West at 858 varas a
point 35 varas South of cap stone of
high red peak, cap stone marked
X at 1420 varas cross Turkey
Creek 1902 varas a point 36 varas
South of a stone marked (BXXIVCA)

25th 26th
+ parts of
27th
mile

Thence West at 524 varas a
rock monument 5 feet high at 545 varas
a rock mound on high hill
at 4379 varas a rock mound on edge
of Plains one marked (ACI) from
which another mound bears
(N6° 1' E) 38½ varas

27th
mile

Thence West at 1324 varas a
point 39 varas South of stone set in
earth mound + 2 pits (XXVII BA)

28th
mile

Thence West at 477 varas a
point 47 varas South of the NW corner
of survey No 55. Block M10 B.S + F.
at 543 varas a gas pipe set in earth
mound + 2 pits from which a stone
marked (XXVIII) bears N85° 46' E
543½ varas 1900 varas a point

29th
mile

Thence West at 543 varas pass
earth mound + 2 pits 1900 varas
a point

19th
mile

Trend West - at 425 varas cross
creek at 564 varas a stone set in
in earth mound & 2 pits marked
(+C.I.) on West bank of creek at
1800 varas enter Red river 1901 varas
a point in Red river

20th
mile

Trend West - at 735 varas pass
out of river 1902 varas a point 32 varas
South of a stone and earth mound and
2 pits

21st
mile

Trend West - at 67 varas a point
836 varas South of the NW corner of
Survey No 1 R6. at 430 varas cross
branch at 551 varas a rock in earth
mound marked X on East hill side
at 1901 varas a point in Red river

22nd
mile

Trend West - passing out of river
at 1070^{vra} a point 33 $\frac{1}{2}$ varas South of a
gyp rock mound on River bluff at
1400 varas channel of Red river
1902 varas a point in sandy valley

23rd
mile

Trend West - crossing Red river
1901^{vra} to a point 35 varas South of stone
& earth mound in mesquite valley
on South bank of Red River.

15th
mile

Thence West at 474 varas pass
a stone mound and 2 pits in draw
at 890 varas a point about one vara
South of a stone mound on top of ridge
1900 varas a point 23 varas South
of earth mound + 2 pits

16th
mile

Thence West at 558 varas a stake
in earth mound and 2 pits from which
mouth of Tule Cañon bears SW S44½W
1901 varas a point in cañon between
two rocky bluffs.

17th
mile

Thence West at 559 varas
pass well in rock mound on West
bank of gulch at 648 varas a point
13 varas South of a stone set in stone
mound marked X which is in South
boundary line of survey No 129
Block C6 and about 1000 varas East
of the S.W. corner of survey No 129 C6
1902 varas a point 27 varas South
of a stone set in earth mound
and 2 pits marked (XVII).

18th
mile

Thence West at 555 varas
pass a stone mound West of rocky
bluff and North of gulch at 924 varas
a point 440 varas North of the most
eastern corner of survey No 11, Block
C6 at 960 varas pass Campbell creek
1901 varas a point 29 varas South
of earth mound + 2 pits.

12th
mile

Thence West at 134 varas a point
392 varas North of N.W. corner of survey
No 31 Block C 5. at 339 varas a
point 356 varas n. of the S.E. corner of
survey No 49 Block C 5. at 765 varas
cross draw (course North) at 1119 varas
a point about 15 varas South of a large
stone marked (67/1592). (Co I. B.A) at 1581 varas
cross branch 1902 varas a point 18 varas
South of earth mound and 2 pits in
a draw.

13th
mile

Thence West at 1682 varas
a point 531 varas South of the N.E. corner
of survey No 53 Block C 6 1902 varas a
point 20 varas South of an earth
mound and 2 pits from which earth
mound + 2 pits The cap rock of mountain
marked X bears S 78 1/4 W and a
small natural mound at foot of plains
bears N 11° 50' West

14th
mile

Thence West from said point
476 varas pass an earth mound and
at 1683^{mm} a point 519 varas South of the
N.W. corner of survey, No 53 Block C 6.
1902 varas a point 22 varas South of
a stone set in stone mound on East
hill side and marked (XIV) (B.A)

8th
mile

Thence West at 60 varas a point-
1163 varas North of the S.W. Corner
of Survey No 14 Block C 5. 1902 1/2 varas
a point 10 varas South of stone mound
marked (B. VIII. D) on North Bank of
creek.

9th
mile

Thence West at 165 varas
cross creek course S.E. at 571 varas
pass a stone in stone and earth
mound on bank of creek one marked
(S.W. B.C.) on North side (B.C.T.) South
side and (A.C.) on West side
at 1225 varas cross and at 1520 varas
re-cross and at 1690 varas cross ^{same} creek
again. 1902 varas a point 13 varas
South of a stone and earth mound.

10th
mile

Thence West at 292 varas
a point 464 varas North of the N.W.
Corner of Survey No 18 Block C 5. at 569
varas pass earth and stone mound
and pits 1902 varas a point 15 varas
South of a rock set in earth mound
and pits marked (B) (A)

11th
mile

Thence West at 567 varas pass
earth ^{and stone} mound at 911 varas cross
draw at 1834 varas cross another
1902 varas a point 16 varas South
of a large stone marked (X. B. A.)
set in earth mound + 2 pits

3rd
mile

Thence West at 241 varas a draw
at 867 varas enter a creek 1224 varas
pass out, at 1823 varas a point - 690
varas North of the S.W. corner of survey
No 22. 1902 1/2 varas a point - 3 varas South
of a stone set in an earth mound
and 2 pits

4th
mile

Thence West at 1902 1/2 varas a
point - 4 varas South of an earth mound
and 2 pits

5th
mile

Thence West - at 1728 varas
a point - 1768 varas North of the S.E. corner
of survey No 9 Block C 5 at 1823 varas
a point - 191 varas North of the S.W.
corner of survey No 63 Block A J & Adams
1902 1/2 varas a point - 5 varas South of a
stone + 2 pits marked (V. B. D).

6th
mile

Thence West - at 610 varas cross
branch 1902 1/2 varas a point - 5 varas
South of a stone marked (B. V. I. D)
set in earth mound
and 2 pits

7th
mile

Thence West - at 31 varas ^{cross} branch
at 591 varas ^{cross} branch 1902 1/2 varas a point -
9 varas South of an earth mound capped
with gravel and 2 pits.

The State of Texas
County of Biscoe

Field Notes of the
North Boundary line of Biscoe
County

1st
mile

Beginning at a stone set in
ground (between the heads of two
gulches courses N.W.) and marked
(N.W. COR. H) (N.E. COR. B.) & (D.C).

Thence West at 11.85. 250 varas
cross gulches at 436 varas a point 1600 varas
South of the N.E. corner of survey No 20
J.C. Adair Block A at 802. varas cross
a gulch at 1560 varas enter creek (Sandy)
1700 varas pass out. 1902 1/2 varas an earth
mound and 2 pits in smooth grassy valley
from which a bluff bears S 28 3/4 E.

The foot of a hill on West bank
of creek bears S 45 W.

2nd
mile

Thence West - at 360 varas cross
a gulch at 436 varas a point 1632 varas
South of the N.W. corner of said survey
No 20. 1902 1/2 varas a point 2 varas South
of an earth and stone mound and
2 pits, from which mound and 2 pits
a cotton wood 18 in in dia X bears
S. 77 1/4 W. 265 varas an other so marked
bears S 87 1/4 W. 238 varas, which mound
is 722 varas N of and 77 varas West
of the S.E. corner of survey No 22
J.C. Adair. Gunter & Munson

T. L. ANDERSON.

DISTRICT AND COUNTY CLERK.

BRISCOE COUNTY.

And

Silverton, Texas, _____ 189

The distance to the county line ^{was} was carefully & accurately measured

The N.W. corner of 13 & the SW. corner of 14 being identical and the corner of 13 being witnessed a distance from that point locate 14. and the distance as given is correct

All other distance from ~~so~~ witnessed ~~to~~ run near the line was actually measured and are correct. I retraced the line run for the South line of ~~Amstrong~~ and connected ~~the~~ for that line

Respectfully

John A. Waller
Surveyor of
Briscoe Co

T. L. ANDERSON.

DISTRICT AND COUNTY CLERK.

BRISCOE COUNTY.

Silverton, Texas, Feb 8 1894

M. E. Moore

Dear Sir

Yours of recent date to hand.
 The proposition to draw a
 line from the N.W. corner of
 Hall to the N.E. corner of
 Swisher and take for granted
 that the survey cut by such
 line is the true position of
 of the land line is incorrect.
 The surveys have been plotted
 too far South.

There seems to be a discrepancy
 in the plat sent and the field
 notes of surveys No 9 & 14 in Block
 95.

The original monument at S.E.
 corner of survey No 9. P. 65. is on
 the ground and I have measured

Sworn to and subscribed before me
this Feby 3rd 1894.

J. L. Anderson, County
Clerk Bricor Co. Tex.

Filed in Good
Land Office
Feby. 8th 1894.

BRICOR, TEXAS

189

J. L. ANDERSON

counter 50786

T. L. ANDERSON.

DISTRICT AND COUNTY CLERK.

BRISCOE COUNTY.

Silverton, Texas, Feb 3 1897

I Nat O Waller Surveyor of
 Briscoe Co being duly appointed and
 qualified by the Commissioners Court
 of Briscoe County to survey establish
 and mark the North boundary line
 of Briscoe County did on the day
 ordered by the Court proceed to the
 N.W. corner of Hall & also the S.E.
 corner of Armstrong and there being
 no one present to represent either of
 the above Counties I commenced at
 the N.W. corner of Hall and run
 the line according to the accompanying
 map & field notes

Nat O Waller Surveyor of
 Briscoe Co

Special County line
 surveyor

4/

Ans by Warren
Feb 8th 94

counter 50784

Burke Co. Bkug. line #4

T. L. ANDERSON,

DISTRICT AND COUNTY CLERK,

BRISCOE COUNTY.

276

Silverton, Texas, Feb 3 1894Hon. W. L. M^o Gaughey,

Wesley, Texas.

Dear Sir,

Enclosed please find
field notes map ect. ~~also~~ of north
boundary line.

Yours truly,
T. L. Anderson

The State of Texas,
 County of Briscoe } J. L. Anderson County
 Clerk of Briscoe County, Texas, hereby
 certify that the foregoing is a true and correct
 copy of an order passed by the County
 Commissioners Court of Briscoe County,
 Texas, on the 15th day of August A.D. 1893,
 at a regular term of said Court, all the
 members thereof being present, which
 order is of Record on pages 75 & 76 of Book
 one (1) of the minutes of said Court, which
 said minutes have been duly signed by
 the County Judge and further certify that
 a copy of the same were certified to and
 mailed to the County Judges of Armstrong
 and Doney Counties in time proscribed
 by law.

Witness my hand and seal of office,
 this the 3rd day of February A.D. 1894.

J. L. Anderson County
 Clerk Briscoe County, Texas.

J. J. N. Stalbird, ^{County Judge} hereby certify that the
 within order was sent to counties of Doney
 and Armstrong as above stated.

J. N. Stalbird
 County Judge
 Briscoe Co.

Filed in Grant Land
 Office at Austin
 Feby 8th 1894

2nd

SILVERTON, TEXAS,

189

That it was the correct corner
I measured to its SW corner
^{hook} with mound in Mesquite flat one etc
marked X from which I run to PK
to S 89° W Goodnight PK to S 72° W
+ High PK to S 70° W. and the dis-
tance called for in the field notes
with the cor. line is ~~correct~~ correct
I am confident

When the Field note of the N
boundary line was returned there
was nothing said about the con-
nections not having been made from
all the corners of survey through
which the Co line passed

When surveys had no established
corners which could be identified
I did not give the distances from their
corners for they would have to be filled
in by course & distance

Yours respectfully,
W. A. Waller, Co. Sur.