

OFFICE OF
NAT. G. WALLER, COUNTY SURVEYOR,
BRISCOE COUNTY.

2048

SILVERTON, TEXAS, 3/5 1894

Hon. W. L. McConkey Sir

The Court ordered the lines
run as required by the
Land Office

Is the lines referred to in your
letter of Feb 9 all that will be
required

Please send me the false
notes of the N. E. corner of Swisher Co.
also the distance to the nearest
Army Camp

Yours respectfully
Nat G Waller

N E Cor Danvers W Bussell Co
Stone mark (N W) (N E) A in Edm trench 15 ft dia
4 ft high br no 3 or 78 no, North 1832 no + E 52.6 no
from Sw cor no 57 B L M 10 B 874

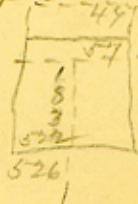

~~6~~ Bussell Co. Edm. line

Ans by Warrin
Mch 10 to 94.

crunter 50005