

7 1931 ⊖

Carson-Hutchinson  
Counties.

---

Sketch and Statements  
by Morris Browning,  
Licensed Land Surveyor,  
Showing a re-trace of the County  
line & connections to land  
surveys - filed for the purpose  
of correcting the abstracts of the  
surveys crossed by said line -  
11/13/31  
Clark

Abstracted 12-8-1931  
Vol. 55.

Counter 51157

1.00

HUTCHINSON COUNTY

CARSON COUNTY

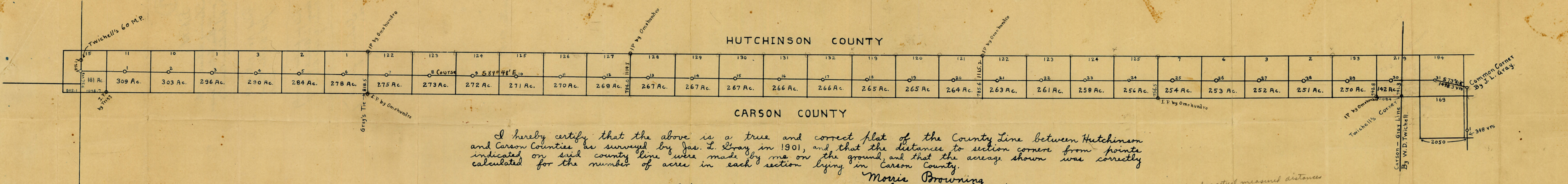

I hereby certify that the above is a true and correct plat of the County Line between Hutchinson and Carson Counties as surveyed by Jas. L. Gray in 1901, and that the distances to section corners from points indicated on said county line were made by me on the ground, and that the acreage shown was correctly calculated for the number of acres in each section lying in Carson County.

Morris Browning  
Licensed State Land Surveyor.

October 24, 1931.

Counter 51158

A

7

Sketch  
Showing retracement of the  
County line between Carson  
& Hutchinson Counties

Filed Nov. 12<sup>th</sup> 1931  
J. H. Walker, Clerk -  
Clark

Filed for purpose of correcting  
errors in Abstracts of Survey  
Crossed by said line -

Statements filed with  
this -

A'

Counter 51159

Oct 5 54 1931



**MORRIS BROWNING**  
LICENSED STATE LAND SURVEYOR

~~806 1/2 RULDE BUILDING~~  
1412 Hughes St.

AMARILLO, TEXAS      November 9, 1931.

1026

Hon. J. H. Walker,  
Land Commissioner,  
Austin, Texas,

Dear Sir:

Enclosed am returning my sketch of the resurvey of the North Line of Carson County together with two written reports on same. On this sketch and papers, I have affixed the seal of my office, as requested in your letter of November 6th,

Thanking you for calling my attention to this detail, which I overlooked, I am

Yours very truly,

*Morris Browning*  
Morris Browning.

ack. receipt of  
pk. + 2 reports. 11/14/31  
RBM.

RECEIVED

NOV 12 1931

REFERRED TO MAP

MORRIS BROWNING  
LICENSED STATE LAND SURVEYOR

50304 RATE BUILDING  
1412 Hughes St.

AMARILLO, TEXAS  
November 9, 1931.

Hon. J. M. Walker,  
Land Commissioner,  
Austin, Texas,

Dear Sir:

Enclosed am returning my sketch of the survey of the North line of Carson County together with two written reports on same. On this sketch and papers, I have affixed the seal of my office, as requested in your letter of November 6th.

Thanking you for calling my attention to this detail, which I overlooked, I am

Yours very truly,

Morris Browning  
Morris Browning.

1931

7

Counter 5/161

copy of  
pk. 1, 2, 3, 4, 5, 6, 7, 8, 9, 10, 11, 12, 13, 14, 15, 16, 17, 18, 19, 20, 21, 22, 23, 24, 25, 26, 27, 28, 29, 30, 31, 32, 33, 34, 35, 36, 37, 38, 39, 40, 41, 42, 43, 44, 45, 46, 47, 48, 49, 50, 51, 52, 53, 54, 55, 56, 57, 58, 59, 60, 61, 62, 63, 64, 65, 66, 67, 68, 69, 70, 71, 72, 73, 74, 75, 76, 77, 78, 79, 80, 81, 82, 83, 84, 85, 86, 87, 88, 89, 90, 91, 92, 93, 94, 95, 96, 97, 98, 99, 100

RECEIVED  
NOV 13 1931  
REFERRED TO MAP

**MORRIS BROWNING**  
LICENSED STATE LAND SURVEYOR

~~60807/ROCK BUILDING~~  
1412 Hughes St.

AMARILLO, TEXAS

October 24, 1931.

920

Hon. J. H. Walker,  
Land Commissioner,  
Austin, Texas,  
Dear Sir:

OCT 23 1931  
REFERRED TO MAP

I have been ordered by the County Court of Carson County to make an investigation to determine if the amount of acreage allotted to Carson County in those certain sections of land intersected by northern boundary line of Carson County as shown in the State Abstract is correct; and, if the acreage as shown in the State Abstract is not correct, to report to you all such discrepancies with the request of Carson County that the said State Abstract be duly corrected by your office. The action of the County Court in this matter was later approved by the Commissioners Court of Carson County meeting in regular session.

With the view of assisting your office in making these calculations as accurate as possible, I searched the county records for connections from points along the county line to section corners. I find Mr. Gray made only one connection to a section corner from his North line of Carson County, that being at a point 1088 varas east of his sixth mile post, from which point the "iron pipe at the northwest corner of section 121 Block 5 I & G N R R Co. bears S 2° W. 818½ varas". This connection I checked on the ground and is all right.

Continuing in his field notes for the North line of Carson County, Mr. Gray says: From 30th mile post "east 665 varas large ravine, 1150 varas head of canon, 1900.8 varas earth mound two feet high and two pits and iron pipe marked 31 C H for 31st mile, from which point an iron pipe 2 inches diameter is S 81° E -924 varas, said pipe being marked NWG, MEC, SWR, SEH, and identified as marking the common corner to Roberts, Gray, Carson and Hutchinson by the following bearings, etc." The facts on the ground do not agree with Mr. Gray's notes at this place. From the common corner, which I found and identified, I ran the reverse call, N 81° W - 924 varas, and did not find the 31st mile post which he described, nor did I find it anywhere. But in running East from Mr. Gray's 30th mile post a distance of one mile we would arrive at a point, from whence the common corner would bear S 73° 41' E - 1478.3 varas.

In his field notes for the East line of Carson County, Mr. Gray gives a connection going South from the Northeast corner as follows: At a point 348 varas South of mile post No. 1, he found himself to be 2050 varas East of an iron pipe marking the corner to sections 169-170-191-192. I checked this connection on the ground and found

C  
counter 51162

**MORRIS BROWNING**  
**LICENSED STATE LAND SURVEYOR**

1608:02 RULE BUILDING  
 1412 Hughes St.

AMARILLO, TEXAS

Hon. J. H. Walker, Page 2.

it to be correct.

In addition to checking on the ground the connections of Mr. Gray as recorded in his field notes which we have just mentioned, I also made other connections from points on the County Line to section corners. In each instance, I had the line double chained, using first a 100 foot chain and checking the distance obtained by a 100 vara chain.

In the accompanying plat I show the county line as originally run by Mr. Gray in 1901, with his connections to section corners, and the additional connections made by myself, also the acreage in each section lying in Carson County. I used the Twichell line as the dividing line between Carson and Gray.

I am also enclosing herein a certified copy of the order passed by the County Court of Carson County authorizing me to make this investigation and report. The order also respectfully requests your office to make correction of any discrepancies you may find in the State Abstract affected by this line.

Yours very truly,

*Morris Browning*  
 Morris Browning.

I hereby certify that this report is true and correct.

*Morris Browning*  
 \_\_\_\_\_  
 Licensed State Land Surveyor.





976

**MORRIS BROWNING**  
LICENSED STATE LAND SURVEYOR

~~1608-07 RULE BUILDING~~  
1412 Hughes St.

AMARILLO, TEXAS      November 3, 1931.

Hon. J. H. Walker,  
Land Commissioner,  
Austin, Texas,

RECEIVED  
NOV 5 - 1931

Dear Sir:

Your letter of October 29th at hand, and have noted the additional items of information that you desire in connection with my report on the Carson-Hutchinson boundary matter. I shall endeavor to give you a detailed report on the field work which is as follows:

I began at the 60th mile on Twichell's line running south from the northwest corner of Hansford County, which is marked at this time by an iron pin in the center of four pits, which I identified by the following bearings: John Ray's Peak S 77°12' W; Point of bluff north of John Ray's Peak S 79°30' W and round knoll at end of bluff N 87° W.

From this point I ran South 476.1 varas to an iron pipe in the center of a rock mound. This is Mr. Gray's N W Corner of Carson and the Southwest Corner of Hutchinson Counties which he used in beginning his survey. The corner was originally marked by Mr. Twichell with a zinc cone marked N E Potter, N W Carson, S W Hutch and S E Moore. The cone has been destroyed in recent years, sometime later than the year 1916, so I was told by other surveyors.

Running eastward from this corner I found and identified every mile called for by Mr. Gray in his field notes except the 3rd and 31st. I verified these markers by course and distance from the beginning corner and also by the markings on the pipe. The pipe were in at every mile except the 3rd, 30th and 31st. Mile post No. 1 was marked 1 on the west side, 29 on the east, C on the south and H on the north. I found all the other pipe marked in the same order, the number on the west being the number of miles from the beginning, the C on the south side to denote Carson to the South, and the H on the north side to denote Hutchinson to the North. All pipe were 1½ inches in diameter and were about 12 inches out of the ground. I checked the course of the line at various places, using a declination of 11°35' E and found the course to be S 89°48' E.

As stated above, I checked each mile in the order run by Mr. Gray up to and including mile No. 29. From this mile marker I continued on the same course, S 89°48' E and checked Mr. Gray's calls "east 790 and 1175 varas cross ravines (North), 1172 varas deep ravine," at 1899 varas to a stone mound.

B

Counter 51165

**MORRIS BROWNING**  
 LICENSED STATE LAND SURVEYOR  
~~806-6770000~~  
 1412 Hughes St.  
 AMARILLO, TEXAS

Page 2.

Please note, Mr. Gray described his 30th mile with an earth and stone mound two pits and an iron pipe on the west side of small divide. The pipe was not there, and I could see no evidence on one ever being there; however, I am positive this stone mound, which is on the west slope of a small divide, is Mr. Gray's original marker for the 30th mile.

Continuing on the same course, I checked Mr. Gray's calls, "East 665 large ravine, 1150 head of canon" but at 1900.8 varas did not find any marker for the 31st mile. As stated in my previous report the common County corner which I found and identified bears S.  $73^{\circ} 41'$  E. 1478.3 varas from this point.

CONNECTIONS TO SECTION CORNERS.

As stated in my previous report and shown on my plat, I made connections from points on the county line as retraced to section corners as follows:

I found the northwest corner of Carson County to be 1098.7 varas west and 936 varas north of an iron pipe for the S. E. Corner of section 15, Block Y 2. This iron pipe is called for in Howard T. Trigg's corrected field notes of section No. 16 Block Y 2, said iron pipe having been set for the S E Cor of Section 15 and the N E Corner of section 16, Trigg's field notes having been filed in the surveyors records of Carson County in 1923.

From the intersection of the county line with the west line of section 122 Block 5, I & G N R R Co., I chained South to Omohundro's iron pipe marking the S W corner of 122 and the N W of 121 Block 5. This distance I found to be 829.7 varas. However, Mr. Omohundro shows the length of the west line of section 122 to be 1930 varas, an excess of 29.2 varas. I shortened my distance obtained to 818.5 varas to agree with Mr. Gray call, which would allow Carson County to consume her proportion of the excess, which I assume is what Mr. Gray did.

At the intersection of the county line with the east line of section 127, which is also the west line of section 128 Block 5, I chained North to Mr. Omohundro's iron pipe marking the northeast corner of section 127 and the northwest corner of section 128. I found the distance to be 1120.1 varas. But taking into consideration the excess of 26.2 varas in the length of the section line, based on the Omohundro notes, I distributed the excess in proportion to the distance each way north or south to section corners from the county line, and

B'

**MORRIS BROWNING**  
**LICENSED STATE LAND SURVEYOR**  
~~606-07-RULE-BUILDING~~  
1412 Hughes St.  
**AMARILLO, TEXAS**

Page 3.

allowed Hutchinson County to consume 15.3 varas and Carson County 10.9 varas of the excess. Therefore I deducted 15.3 varas from 1120.1 leaving 1104.8 varas for the distance north, and subtracting 1104.8 varas from 1900.8 leaves 796.0 varas for the distance to be used in computing the acreage south of the county line.

At the intersection of the county line with the east line of section 121, which is also the west line of section 122 Block 4, I & G N, I chained North to Omohundro's pipe marking the Northeast corner of section 121 and the Northwest corner of section 122, and found the distance to be 1127.0 vrs. Calculating from Omohundro's notes, the east line of section 121 is 1920.7 varas in length, an excess of 19.9 varas. Proportioning the excess as to the distance above and below the county line to the respective section corners, Hutchinson County would have to consume 11.8 varas and Carson County 8.1 varas. That would leave 1115.2 varas North of the line and 785.6 varas south of the line to section corners.

At the intersection of the County Line with the west line of section 7, block 9, which is also the eastline of section 125, block 4, I ran south to the iron pipe set by Mr. Omohundro for the Southeast corner of section 125 and the Southwest of section 7, and obtained a distance of 762.3 varas. This section line has a total length of 1915.6 varas or an excess of 14.8 varas. I proportioned this excess 5.8 varas to Carson and 9.0 varas to Hutchinson County, and have shown the distance to be 756.5 varas south of the county line and 1143.3 varas north of same to section corners.

From the intersection of the County Line with the East line of section 193 Block 3, which is also the West line of section 219 Block 2, I ran South to an iron pipe set by Omohundro for the corners to sections 193-194-192-219. The actual chained distance was 746.6 varas. The length of the section line according to Omohundro is 1910.55 varas. I proportioned the excess of 9.7 varas on the same basis and gave Carson County 3.8 varas and Hutchinson County 5.7 varas, and showed the distance to be 742.8 varas South to the corner and 1158.0 varas north.

I am returning another plat of the County Line as retraced, the other sketch having been returned to me.

Hoping this will supply the additional information required for the approval of my work, I am

Yours very truly,

*Morris Browning*

I hereby certify that this report is true and correct.

*Morris Browning*  
Licensed State Land Surveyor.

B2

Counter 51167

I hereby certify that this report is true and correct.

Carson Co. Bdrg. Ling #7

Yours very truly,

Morris Browning

required for the approval of my work, I am

replaced, the other sketch having been returned to me.

I am returning another plat of the County line as

1188.0 varies north.

showed the distance to be 748.8 varies south to the corner and Carson County 2.8 varies and Hutchinson County 2.7 varies, and portioned the excess of 9.7 varies on the same basis and gave section line according to Omohundro is 1910.39 varies. I proportioned for the corners to sections 123-124-128-213. The East line of section 123 Block 2, which is also the West line

from the intersection of the County line with the varies north of same to section corners.

distance to be 758.3 varies south of the County line and 1143.3 Carson and 9.0 varies to Hutchinson County, and have shown the excess of 14.8 varies. I proportioned this excess 2.8 varies to this section line has a total length of 1912.6 varies or an Southwest of section 7, and obtained a distance of 782.2 varies. Omohundro for the Southeast corner of section 123 and the section 123, block 4, I ran south to the iron pipe set by Mr. line of section 7, block 2, which is also the east line of

At the intersection of the County line with the west the line to section corners.

leave 1113.8 varies north of the line and 782.6 varies south of to consume 11.8 varies and Carson County 8.1 varies. That would be the respective section corners, Hutchinson County would have the excess as to the distance above and below the county line is 1230.7 varies in length, an excess of 19.3 varies. Proportioning Calculating from Omohundro's notes, the east line of section 121 corner of section 123, and found the distance to be 1125.0 varies marking the Northwest corner of section 121 and the Northwest 123 Block 4, I & G. W. I chained north to Omohundro's pipe line of section 121, which is also the west line of section

At the intersection of the county line with the east the county line.

for the distance to be used in computing the acreage south of and intersecting 1104.8 varies from 1900.8 leaves 190.0 varies away from 1180.1 leaving 1104.9 varies for the distance north, County 10.3 varies of the excess. Therefore I deduced 12.3 allowed Hutchinson County to consume 12.3 varies and Carson

Carson-Hutchinson Cos.

Surveyor Statement

Filed Nov. 12<sup>th</sup> 1931  
J. H. Walker, Court Clerk

MARICELLO, TEXAS  
MORRIS BROWNING  
STATE LAND SURVEYOR

REG. PHONE 5-3148

counter 51168

1.00

Other papers returned  
to Morris Browning 11/6/31 -  
See letter -

THE STATE OF TEXAS    |        IN THE COUNTY COURT OF  
COUNTY OF CARSON     |        CARSON COUNTY, TEXAS.

On this the 21st day of October A. D. 1931 came on to be considered the matter of apparent discrepancies in the State Abstract along the Northern Boundary Line of Carson County and it appearing to the Court that the acreage should be calculated by a competent surveyor and duly reported to the General Land Office, and it further appearing to the Court that Morris Browning is a Licensed State Land Surveyor and a suitable person to make such calculations;

It is therefore ordered by the Court that the said Morris Browning make a calculation of the acreage lying and being in Carson County in the Sections intersected by the said Northern Boundary Line of Carson County and that he present said calculations to General Land office with the request of Carson County that any discrepancies in the State Abstract be duly corrected.

Frank Elston

\_\_\_\_\_  
County Judge, Carson County, Texas.

THE STATE OF TEXAS    |  
COUNTY OF CARSON     |

I, C. L. Upham, Clerk of the County Court of Carson County, Texas do hereby certify that the above and foregoing is a true and correct copy of Order now on file in my office and duly recorded in Volume 3 Page 244 of the Minutes of said Court.

C. L. Upham

\_\_\_\_\_  
Clerk County Court, Carson County, Texas.

④ Carson-Hutchinson  
1931

Carson Co. Bdry line

⑦