

CASTRO COUNTY

I, W. L. McLaughley, Commissioner of the General Land Office of the State of Texas, certify this map to be a true and correct copy of the map now in use in this office, and compiled from official data.

GENERAL LAND OFFICE
4000 Yards = 1 inch
JULY 8th 1891

BEXAR LAND DISTRICT.

W. L. McLaughley
Commissioner

Deaf Smith Co.

Randall Co.

Parmer Co.

Swisher Co.

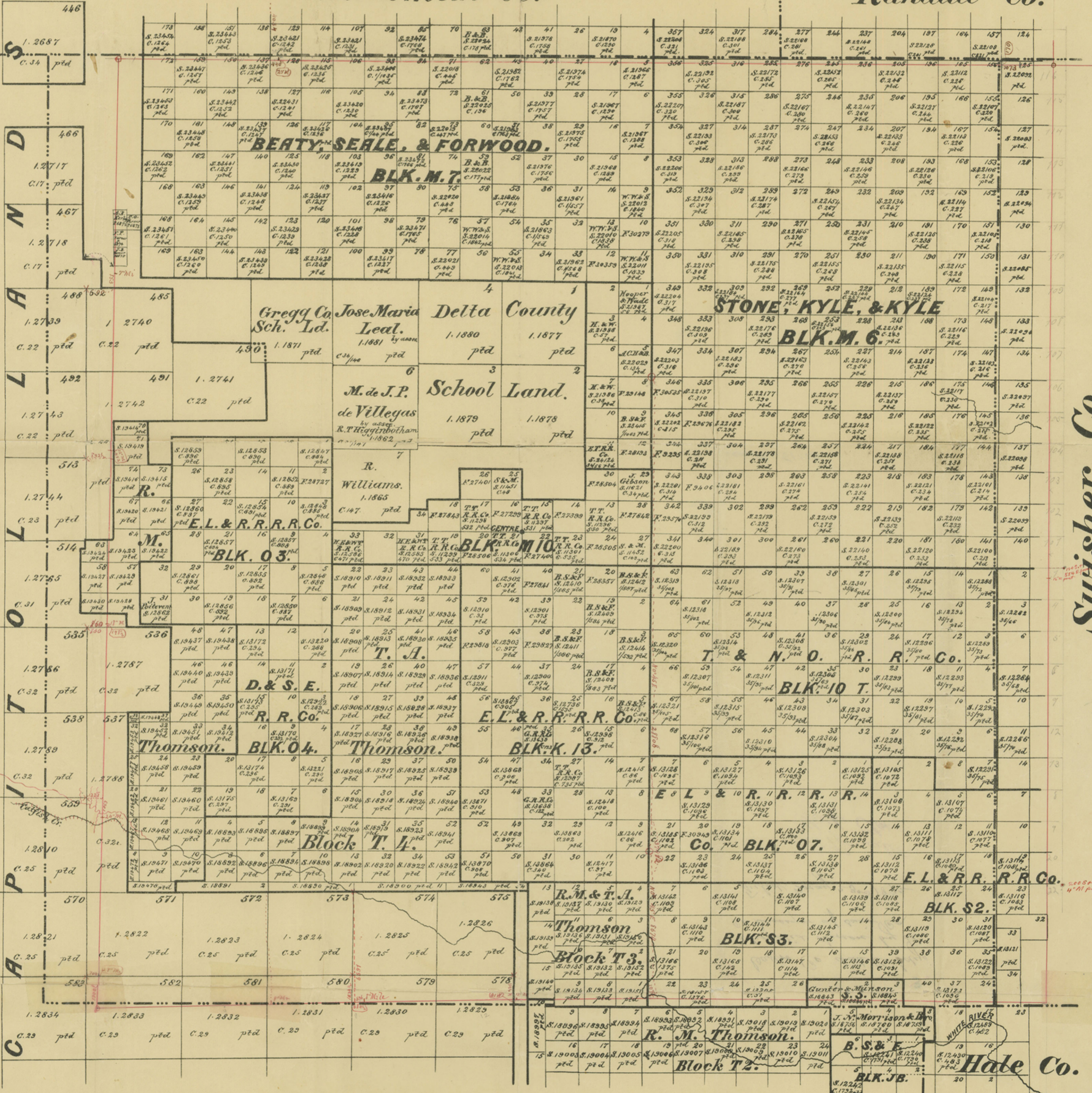

W. M. B. & Co.

20 1/2 1892

High Co.

3.
Castro Co with Co beds
delineated thereon by the
Co Surveyor of said Co.
Filed, May 23rd 1892

Dr. Beattie
High Co.

County 51225

Boomer Co.

Washburn Co.

Delta Canal
School Land
Delta Canal

W. M. B. & Co.
W. M. B. & Co.

Delta Canal Co.

Washburn Co.

W. M. B. & Co.

W. M. B. & Co.
W. M. B. & Co.

GENERAL LAND OFFICE
1891

WESTERN DISTRICT

CASTRO COUNTY